

241

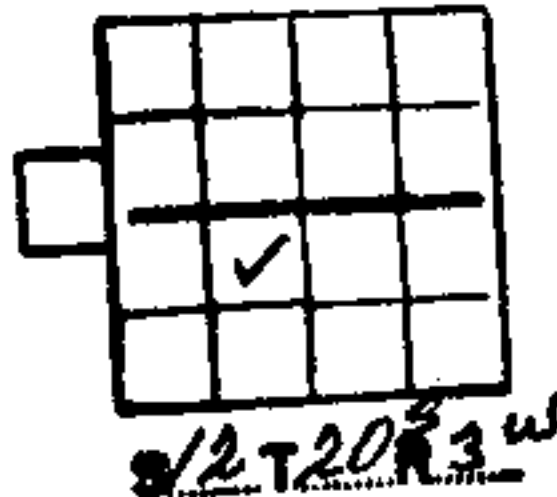

510824

WE # 61700-40-0041-7-00

STATE OF ALABAMA,

County of SHELBY

KNOWN ALL MEN BY THESE PRESENTS, that the undersigned,

EDDIE LUMPKIN, A MARRIED MAN & SOLE OWNER

182 PAGE 667
BOOK 182
in consideration of the sum of One and No/100 Dollars (\$1.00), to ME in had paid by Alabama Power Company, a corporation, the receipt whereof is acknowledged, DOES hereby grants to said Alabama Power Company, its successors and assigns, the right to construct, install, operate and maintain, and the right to permit other corporations and persons to construct, install operate and maintain, along routes to be selected by the grantee, (generally shown crosshatched on the attached drawing) its successors or assigns, all poles, wires, conduits, cables, trans closures and other appliances and facilities useful or necessary in connection therewith for the overhead and underground transmission and distribution of electric power and for the overhead and underground communication service, upon, over, and under and across the following described land, situated in SHELBY County, Alabama.

A TRACT OF LAND IN THE NORTHEAST QUARTER OF THE SOUTHWEST QUARTER OF SECTION 12, TOWNSHIP 20 SOUTH, RANGE 3 WEST DESCRIBED AS FOLLOWS: ALL THAT PART OF THE EAST FIFTY FEET LYING WEST OF U.S. HIGHWAY # 31 AND NORTH OF BELLE VISTA DRIVE.

This instrument prepared in
the Corporate Real Estate
Dept. of Alabama Power Co.
Birmingham, Ala.

By R. L. CAGGIN

GRANTEE'S ADDRESS
ALABAMA POWER CO.
P. O. BOX 2641
BIRMINGHAM, AL 35291
ATT: CORP. REAL ESTATE

Together with all the rights and privileges necessary or convenient for the full enjoyment or use thereof, including the right of ingress and egress to and from said facilities and the right to excavate for installation, replacement, repair and removal thereof; and also the right to cut and keep clear all trees, underbrush, shrubbery, roots and other growth, and to keep clear any and all obstructions or obstacles of whatever character on, under or above said facilities.

TO HAVE AND TO HOLD the same to the said Company, its successors and assigns, forever.

IN WITNESS WHEREOF, we have hereunto set our hands and seals, this the

4th day of FEBRUARY, 1988.

WITNESS:

Eddie Lumpkin (Seal)

(Seal)

BOOK 182 PAGE 668
STATE OF ALABAMA

COUNTY OF SHELBY

I, DON D. BAILEY, a Notary Public, in and for said County in said State, hereby certify that EDDIE LUMPKIN, A MARRIED MAN & SOLE OWNER whose name IS signed to the foregoing instrument and who IS known to me, acknowledged before me on this day that being informed of the contents of the instruments HE executed the same voluntarily on the day the same bears date.

Given under my hand and official seal, this the 4th day of FEBRUARY, 1988.

Don D. Bailey
Notary Public

SKETCH OF PROPOSED WORK

Alabama Power

WE No. 61700-40-00417-00		Customer METRO MINI STORAGE		Estimate No.	
Division BIRMINGHAM		District NORTH SHELBY		Town PELHAM	
Scale 1" = 100' Ft. Per Inch		Section 12		Map Reference 3W-20-12-3	
Township 20-S		Range 3W		Date 1-21-88	
Drawn By J. SCHIFANO					

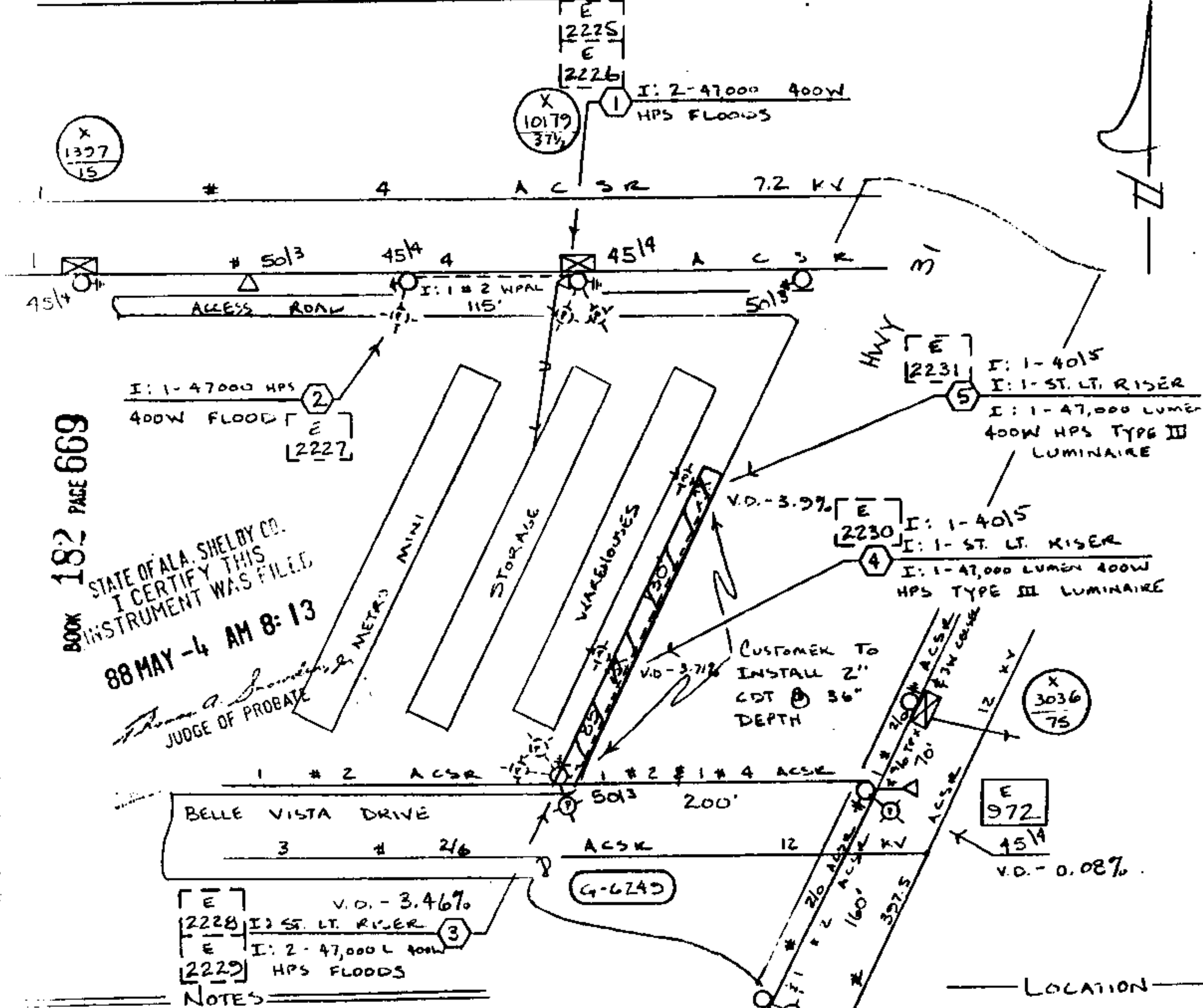

BOOK 182 PAGE 669

STATE OF ALA. SHELBY CO.
I CERTIFY THIS
INSTRUMENT WAS FILED
88 MAY -4 AM 8:13
JUDGE OF PROBATE

NOTES

1. CUSTOMER TO INSTALL 2" COT (SCH. 40) @ 36" DEPTH FROM LOC ③ TO ⑤
2. 2# 6 AL XLP CONDUCTOR TO BE INSTALLED FROM LOC ③ TO ⑤
3. ALL LIGHTS 400W HPS FLOOD EXCEPT LOCATION 3 & 5 WHICH WILL HAVE 400W HPS COBRA-HEAD

1. Deed Tax \$.50
 2. Mtg. Tax
 3. Recording Fee 7.50
 4. Indexing Fee 1.00
- TOTAL 9.00