

240

510822

STATE OF ALABAMA

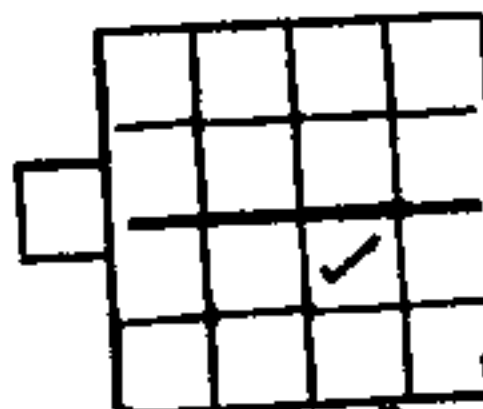

WE # 61700-00-0233-7-00

County of Shelby

S30T/2N3W

KNOW ALL MEN BY THESE PRESENTS, that the undersigned,

First National Bank of Columbiana

for and in consideration of the sum of One and No/100 Dollars (\$1.00), to it in hand paid by Alabama Power Company, a corporation, the receipt whereof is acknowledged, doeshereby grant to said Alabama Power Company, its successors and assigned, the right to construct, install, operate and maintain, and the right to permit other corporations and persons to construct, install, operate and maintain along a route to be selected by the grantee, (generally shown crosshatched on the attached drawing) its successors and assigns, all conduits, cables, trans closures and other appliances and facilities useful or necessary in connection therewith, for the underground transmission and distribution of electric power and for underground communication service, upon, under and across the following described land situated in Shelby County, Alabama:

A TRACT OF LAND IN THE NORTHWEST QUARTER OF THE SOUTHEAST QUARTER OF SECTION 30, TOWNSHIP 19 SOUTH, RANGE 3 WEST DESCRIBED AS FOLLOWS:  
COMMENCE FOR A POINT OF BEGINNING AT THE INTERSECTION OF RIVER-CHASE PARKWAY EAST AND SHELBY COUNTY HIGHWAY # 17, THENCE RUN NORTHWESTERLY ALONG THE SOUTHWEST LINE OF SAID PARKWAY 300 FEET; THENCE LEFT 107°10' AND RUN 300 FEET; THENCE LEFT 74°30' AND RUN 300 FEET TO THE NORTHWEST LINE OF SHELBY COUNTY HIGHWAY # 17; THENCE LEFT AND NORTHEASTERLY ALONG SAID HIGHWAY # 17 TO THE POINT OF BEGINNING.

This instrument prepared by  
the Corporate Real Estate  
Dept. of Alabama Power Co.  
Birmingham, Ala.

By R.L. Coggins

GRANTEE'S ADDRESS  
ALABAMA POWER CO.  
P. O. BOX 2641  
BIRMINGHAM, AL 35291  
ATT: CORP. REAL ESTATE

BOX 182 REC 664

Together with all the rights and privileges necessary or convenient for the full enjoyment or use thereof, including the right of ingress and egress to and from said facilities and the right to excavate for installation, replacement, repair, and removal thereof; and also the right to cut and keep clear all trees, underbrush, shrubbery, roots and other growth, and to keep clear any and all obstructions or obstacles of whatever character on, under or above said facilities.

TO HAVE AND TO HOLD the same to the said Alabama Power Company, its successors and assigns forever.

IN WITNESS WHEREOF, the said First National Bank of Columbiana has caused this instrument to be executed in its name by Billy R. Jones as its Vice President, and attested by Vicki N. Smith as its Asst. Cashier, and its corporate seal to be hereto affixed, on this the 19 day of February, 1988.

Attest:

Vicki N. Smith  
Vicki N. Smith  
STATE OF Alabama

COUNTY OF Shelby

First National Bank of Columbiana  
Billy R. Jones, V. P.  
Billy R. Jones, V. P.

I, Patricia L. Dove, a Notary Public, in and for said County in said State, hereby certify that Billy R. Jones whose name as Vice President of First National Bank of Columbiana a corporation, is signed to the foregoing instrument, and who is known to me, acknowledged before me on this day that, being informed of the contents of this instrument, he as such officer and with full authority executed the same voluntarily for and as the act of said corporation.

Given under my hand and official seal, this the 19 day of February, 1988.

Patricia L. Dove  
Notary Public

My Commission Expires June 2, 1991

# SKETCH OF PROPOSED WORK

Alabama Power

WE No. 61700-00-02337-00		Customer 1 <sup>ST</sup> NATIONAL BANK OF COLUMBIANA		Estimate No.	
Division BHAM		District NORTH SHELBY		Town FELHAM	
Scale NONE R. Per Inch		Section 30		Township 19S	
		Range 3W		Map Reference 3W-19-30-4	
				Date 2-9-88	
				Drawn By E. BIDEZ	

FAULT CURRENT AMPERES  
 4196A  
 3809A  
 758A

SECTIONALIZING

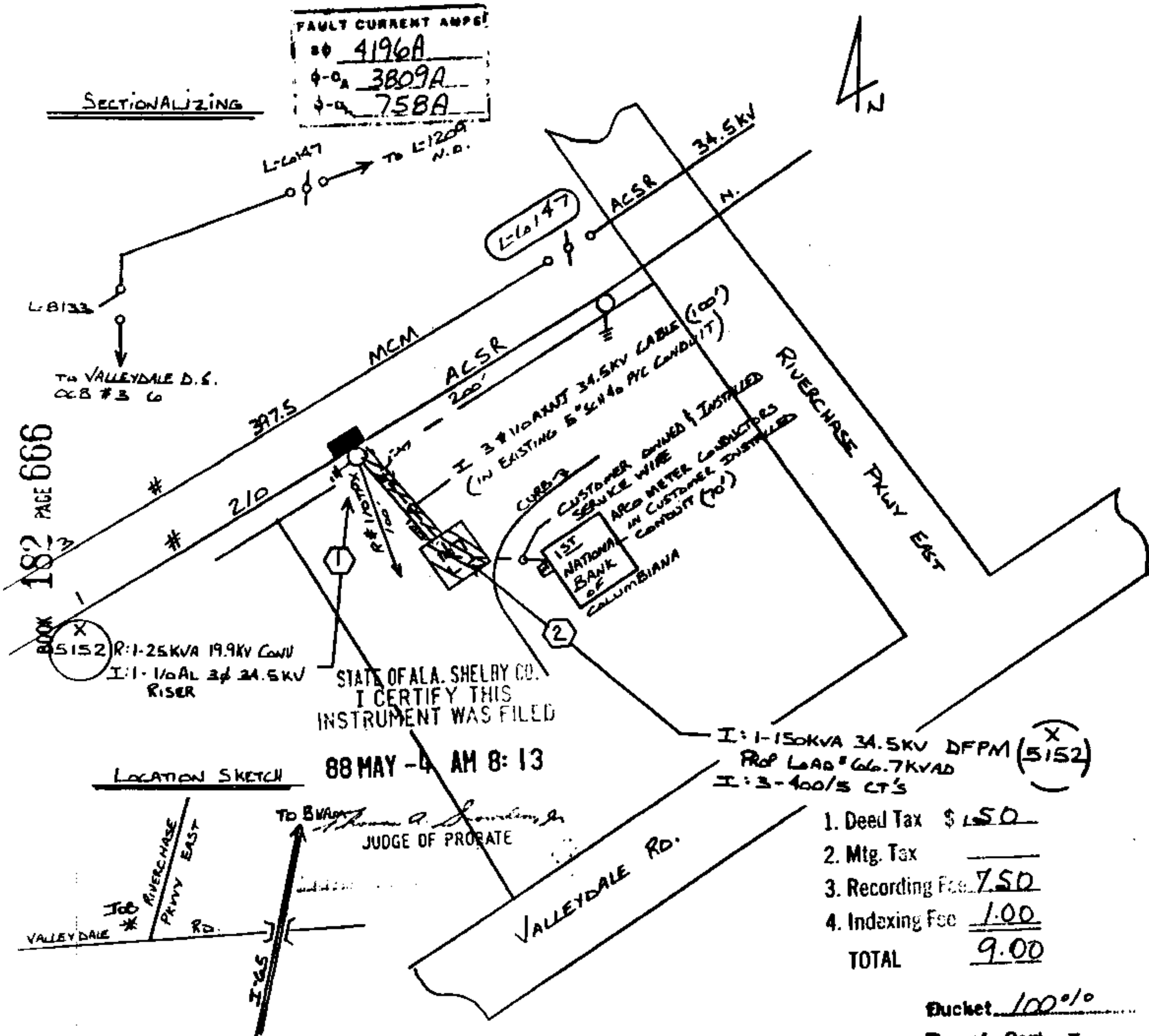

1. Deed Tax \$ 1.50
  2. Mtg. Tax
  3. Recording Fee 7.50
  4. Indexing Fee 1.00
- TOTAL 9.00

Bucket 100%  
 Transf. Cert. -  
 Hand Hole. -  
 Rock -  
 Tree Crew -  
 Staked -  
 Permit RW, Sub  
 Work with -

NOTES:  
 1. BILLING TO THE CUSTOMER IS WAIVED BY NORTH SHELBY DISTRICT MANAGER DUE TO FUTURE LOAD CONSIDERATIONS.