



South Central Bell

A BELL SOUTH Company

Right Of Way & Easement

B416-A-SC
(9-88)

South Central Bell Telephone Company Use Only		SCB ROW #	C-0814	ZWW
Authority	734-7355RB	Classification	R1C	Area Birmingham South
Approved		Title Operations Manager Engineering & Construction		

For and in consideration of One Dollar (\$ 1.00) dollars and other good and valuable consideration, the receipt of which is hereby acknowledged, the undersigned, its successors, heirs and assigns do hereby grant to South Central Bell Telephone Company, its licensees, successors, and assigns (hereinafter referred to as Grantee), a right of way and easement to construct, operate, maintain, add and/or remove such lines or systems of communications or related services as the Grantee may require from time to time consisting of:

- A. Poles, guys, anchors, aerial cables and wires;
- B. Buried cables, wires, terminals, markers, splicing boxes, pedestals;
- C. Conduit, manholes, markers, underground cables and wires;
- D. Other amplifiers, boxes, appurtenances or devices; and
- E. Repeater stations, buildings, shelters, and structures for the protection and containment of the aforesaid and their appurtenances, including but not limited to _____

Upon, over and under a strip of land 30' feet wide across the following lands in Shelby County, State of Alabama, Section 12, Township 22S, Range 3W, described as follows:
SE 1/4 of Section 12, Township 22S, Range 3W Parcel ID # 27-01-12-000-16 owned
by Thomas W. Brock, Jr. A 30' easement (15' each side of pole line) as
indicated on sketch on reverse side of document.

and to the fullest extent the undersigned has the power to grant, if at all, along and under the roads, streets, or highways adjoining or through said property.

The following rights are also granted: to allow any other person, firm or corporation to attach wires or lay cable or conduit or other appurtenances upon, over and under said easement for communications or electric power transmission or distribution; ingress and egress to said easement at all times; to clear the easement and keep it cleared of all trees, undergrowth or other obstructions; to trim and cut and keep trimmed and cut all dead, weak, leaning or dangerous trees or limbs outside of the easement which might interfere with or fall upon the lines or systems of communications or power transmission or distribution; and the right to relocate said facilities on said lands to conform to any future highway relocation, widening or improvements.

To have and to hold the above granted easement unto South Central Bell Telephone Company, its successors and assigns forever and in perpetuity.

Grantor(s) warrant(s) that he/she/they is/are the true owner(s) of record of the above described land on which the aforesaid easement is granted.

In witness whereof, the undersigned has/have caused this instrument to be executed on the 23RD day of November, 1987.

Witness	<u>[Signature]</u>	Owner	<u>Jesse Grady Brock</u>	L.S.
Witness	<u>[Signature]</u>	Owner	<u>Thomas W Brock Jr</u>	L.S.
Name Of Corporation		Title		

Sketch

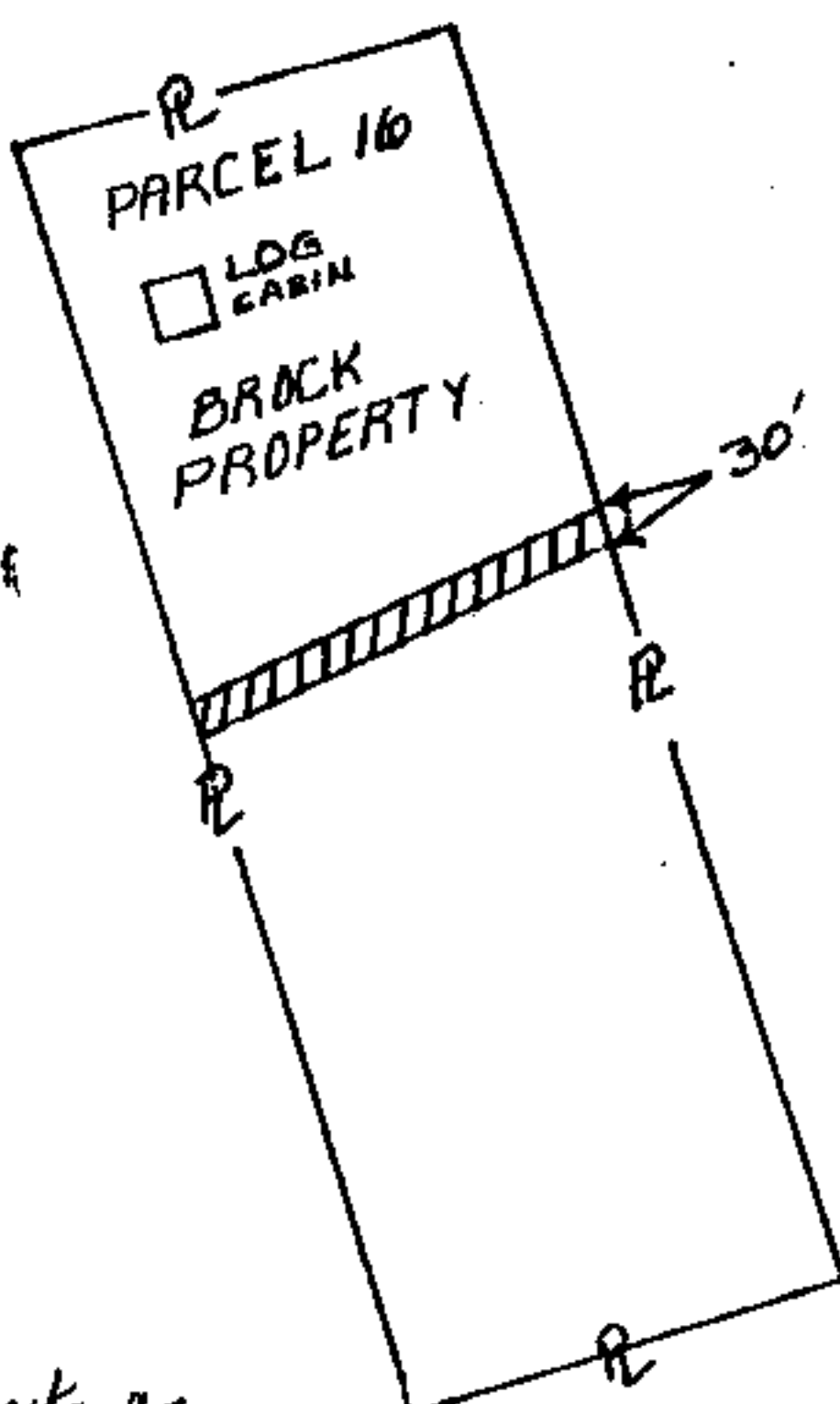

Acknowledgements

Individual

State of Alabama

County of Jefferson

Personally appeared before me Joan Grady Brock & Thomas W. Brock, Jr., the within named grantor(s) with whom I am personally acquainted, who acknowledged that, being informed of the contents of the within named instrument he/she/they executed and delivered the same voluntarily as his/her/their act and deed for the purposes therein contained.

Witness my hand and seal this 23 day of November 1987

Notary Public

Corporation Form

State of Alabama

County of _____

STATE OF ALA. SHELBY CO.
I CERTIFY THIS
INSTRUMENT WAS FILED

88 JAN 15 AM 10:05

Before me Thomas A. Snowling Jr. of the state and county aforesaid, appeared _____ with whom I am personally acquainted, and who, being duly sworn, acknowledged himself/herself to be _____ of the _____, the within named bargainer, a corporation, and further acknowledged that he/she as such _____, being authorized by the Board of Directors of said corporation, so to do, executed the foregoing instrument, and affixed the corporate seal thereto, for the purposes therein contained, by signing the name of the corporation by himself/herself as _____ And that the said _____ acknowledged the said writing to be the free act and deed of the said corporation.

Witness my hand and seal this _____ day of _____ 19____

Notary Public

This instrument prepared by:

Willie G. Bailey

Name
Engineer/Right of Way

Title
Room 102N
3196 Highway 280 South
Birmingham, Al. 35243

1. Deed Tax \$ 50
2. Mtg Tax _____
3. Recording Fee 5.00
4. Indexing Fee 1.00
TOTAL 6.50



BOOK 167 PAGE 663