

694
PLANTATION PIPE LINE COMPANY
Division Office
P. O. Box 1871
Baton Rouge, Louisiana 70821-1871

61700 08 00616 00
Plantation Reference
AL Main Line
Sec. 5A R/W NO. 247-1
492910

REQUEST FOR PERMIT TO CROSS RIGHT OF WAY AND FACILITIES OF PLANTATION PIPE LINE COMPANY

ALABAMA POWER COMPANY hereby requests a permit to cross the right of way and interstate pipeline facilities of Plantation Pipe Line Company (Plantation), a Delaware and Virginia Corporation, with 34.5 KV Underground Power Cables to Serve Mallard Pointe Subdivision, in the SW 1/4 of Section 18, Township 20 South, Range 2 West, in Shelby County, Alabama. The proposed crossing will be as shown on the attached sketches (Attach a sketch referencing the crossing point to known points; the sketch should include, among other things, the land lot or section number, township, range, county, and state). See Exhibit "A", APCo. DWG. A-61700-08-00616-00. If said permit is granted applicant agrees its foreign lines will be installed pursuant to the following specifications, unless they are installed in existing highway right of way or specific written waivers are granted by Plantation.

SPECIFICATIONS FOR PIPELINE CROSSINGS

1. The line crossing Plantation's line(s) will be laid under Plantation's line(s) with a minimum clearance of twenty-four (24) inches between the bottom of Plantation's pipe(s) and the top of the line(s) crossing under Plantation. The top of Plantation's line(s) is located approximately two (2) feet below the surface of the ground. This depth, of course, will vary at different points along Plantation's system; however, and regardless of the depth of said line(s), the line(s) crossing under Plantation must be installed at least two (2) feet below and as nearly as possible at right angles to Plantation's line(s). This depth below Plantation's line(s) is to be maintained for the full distance across the pipeline confinement strip.
2. Applicant, or its agent, will give a representative of Plantation's Division Office, at the above address, telephone number 504/775-0210, reasonable notice of the day on which the crossing(s) will be made, in order that arrangements can be made for necessary representatives of Plantation to be present. Plantation's representatives will establish the width of the confinement strip.
3. Applicant shall investigate, defend, indemnify, and hold Plantation, its officers, employees, agents, servants, and representatives, harmless from all claims, loss, liability, attorney fees, cost and expense, including death, personal injury, and property damage occurring to applicant or its Contractor, or its subcontractors or Plantation, their respective officers, employees, agents, servants, and representatives, or to third parties which arise out of, or in connection with, or by reason of, performance of the work herein contemplated or the existence of said installations thereafter, expressly excluding (when permitted by law) claims for property damages or for personal injuries or death which are caused by the sole or concurrent negligence of Plantation, its officers, employees, agents, servants, or representatives.
4. As soon as practicable after the crossing installation is completed, applicant will furnish Plantation with a plat showing the "as-in" location of its line(s) at each crossing in respect to Plantation's pipeline(s) as to angle, depth, station number, etc. Plantation's pipeline station number may be obtained from its representatives present at the time the crossing is made.
5. Applicant will not operate nor allow to be operated any excavating machinery upon, or within five (5) feet of Plantation's pipeline on either side thereof;
6. Applicant will mark the location of the underground crossing on each side of Plantation's right of way at the crossing;

This instrument prepared in
the Corporate Real Estate
Dept. of Alabama Power Co.
Birmingham, Ala.

By R.C. Coggin

GRANTEE'S ADDRESS
ALABAMA POWER CO.
P. O. BOX 5041
BIRMINGHAM, AL 35201
ATT: CORP. REAL ESTATE
Brenda Bowen

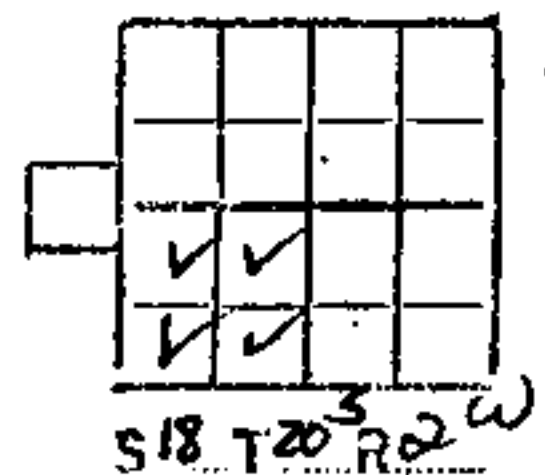

7. It is further understood and agreed between Applicant and Plantation:

- A. That Plantation does not, by consenting to the proposed installation of this underground facility across its pipeline confinement strip and underneath its facilities, assume any responsibility for the protection of its pipeline. Furthermore, all work performed in connection with this installation will be without expense, risk, or liability to Plantation or any of its directors, officers, agents, representatives, or employees, except as provided in Par. #3 hereof.
- B. That Plantation reserves the right to request the applicant to relocate its facilities located on the rights of way of Plantation at the expense of the applicant when necessary for Plantation to exercise its easement rights, including, but without being limited to, maintenance and repair of the existing pipelines or the construction of additional pipelines. In an emergency to ameliorate an imminent danger to life, health or property in which case Plantation reserves the right to cut the facility without liability for restoring the installation or for the interruption of service in the use of such installation. Recognizing the need for the continuity of applicant's facilities, in nonemergency situations, Plantation agrees to cooperate with applicant in finding a suitable alternative location for applicant's facilities within 50 feet of the existing location.
- C. That except to the extent made necessary by the construction and maintenance of such permitted crossings and encroachments, and the reasonable use thereof, the exercise of any rights permitted to applicant shall not interfere with or supersede the rights of Plantation under its easements.

Execution below by applicant acknowledges agreement and acceptance of the aforementioned conditions and applicant agrees not to begin any work within the confines of the confinement strip until this permit has been executed below by Plantation.

BOOK 114 PAGE 166

Alabama Power Company
Applicant's Name

600 North 18th Street
Street Address
Post Office Box 2641

Birmingham, AL 35291
City State

Print Signer's Name and Title

By: Jesse S. Vogtle
Signature of Signer
JESSE S. VOGTLE
EXECUTIVE VICE PRESIDENT AND COUNSEL

205/250-1000 11/7/86
Telephone Number Date

- ☒ To the extent of its rights or interest and without warranty Plantation hereby permits the crossing described on this and the obverse side hereof.
- ☐ Permit denied for the following reasons:
- ☐ The following are specifically waived:

APPROVED AS TO TERMS AND DESCRIPTION

By: Richard C. Cozzin
SUPERVISOR - DISTRIBUTION
By: [Signature]
MANAGER
CORPORATE REAL ESTATE

APPROVED AS TO FORM
BALCH & BINGHAM
By: Harold Williams

PLANTATION PIPE LINE COMPANY

By: G. H. Bethea
G. H. Bethea, Division Manager
Title

11/21/86

PPI-578-1

PLANTATION PIPELINE COMPANY CROSSING SW 1/4 OF SW 1/4 OF SECTION 18 TNSP 20S RNG 2W

PROFILE FACING NORTHWEST

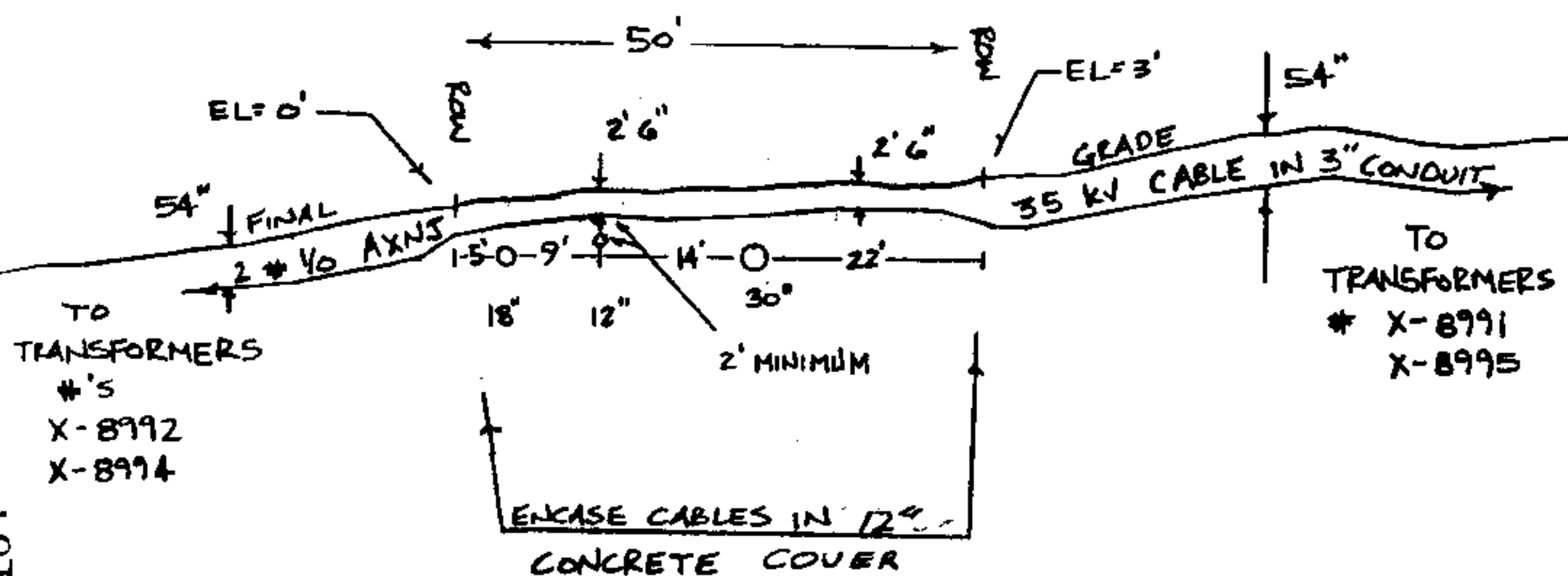

500' TO CENTERLINE OF SHELBY COUNTY # 35

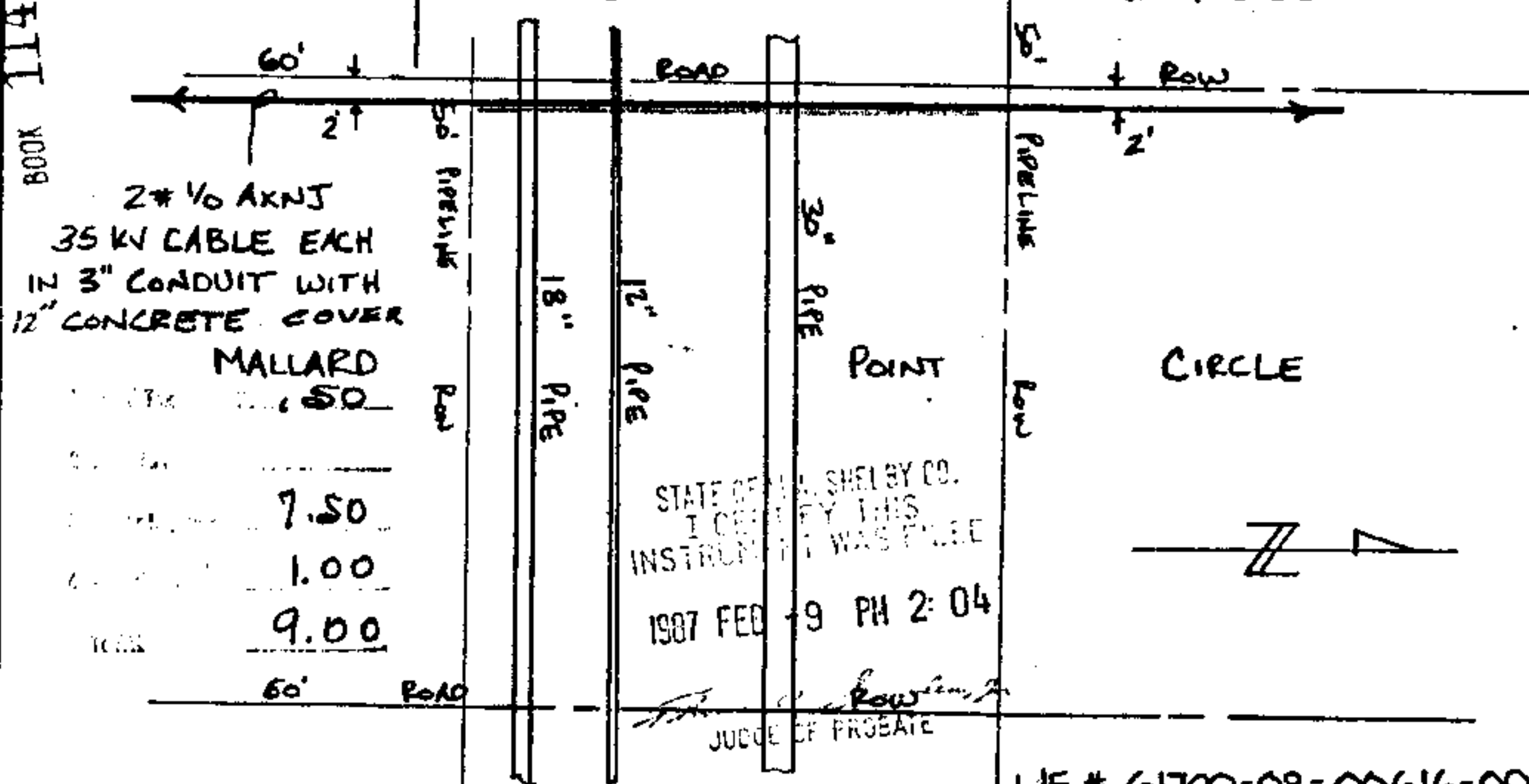

DR. G. SHIPP

NO. DATE

REVISION

ALABAMA POWER COMPANY

SUBJECT NORTH SHELBY 345KV DISTRIBUTION

DETAIL UNDERGROUND PIPELINE CROSSING
PLANTATION PIPELINE COMPANY

APP.

DATE

SUPERSEDES NONE

SCALE 1" = 20'

SH. 1 OF 1 SHEETS

A-61700-08-00616-00