

STATE OF ALABAMA,

WE # 61700-08-0034-6-00

County of Shelby

KNOW ALL MEN BY THESE PRESENTS, that the undersigned,

491001

South Jefferson Company, Inc.

for and in consideration of the sum of One and No/100 Dollars (\$1.00), to
it in hand paid by Alabama Power Company, a corporation, the receipt
whereof is acknowledged, does hereby grant to said Alabama Power Company,
its successors and assigned, the right to construct, install, operate and
maintain, and the right to permit other corporations and persons to construct,
install, operate and maintain along a route to be selected by the grantee,
(generally shown crosshatched on the attached drawing) its successors and
assigns, all conduits, cables, trans closures and other appliances and
facilities useful or necessary in connection therewith, for the underground
transmission and distribution of electric power and for underground communi-
cation service, upon, under and across the following described land situated
in Shelby County, Alabama:

Meadow Brook Townhomes as recorded in Map Book 16,
page 2 in the Office of the Judge of Probate.

BOOK 105 PAGE 844

This instrument prepared in
the Corporate Real Estate
Dept. of Alabama Power Co.
Birmingham, Ala.

By R. C. Leggin

GRANTEE'S ADDRESS
ALABAMA POWER CO.
P. O. BOX 2641
BIRMINGHAM, AL 35291
ATT: CORP. REAL ESTATE

Together with all the rights and privileges necessary or convenient for the full enjoyment or use thereof, including the right of ingress and egress to and from said facilities and the right to excavate for installation, replacement, repair, and removal thereof; and also the right to cut and keep clear all trees, underbrush, shrubbery, roots and other growth, and to keep clear any and all obstructions or obstacles of whatever character on, under or above said facilities.

TO HAVE AND TO HOLD the same to the said Alabama Power Company, its successors and assigns forever.

IN WITNESS WHEREOF, the said South Jefferson Company, Inc.

has caused this instrument to be executed in its name by John P. Baker

as its President, and attested by _____

as its _____, and its corporate seal to be

hereto affixed, on this the 23 day of October, 1986

Attest:

[Signature]

South Jefferson Company, Inc.

[Signature]

STATE OF Alabama

COUNTY OF Jefferson

I, Lura Ann Olson, a Notary Public, in and for said

County in said State, hereby certify that John P. Baker

whose name as President of South Jefferson Co.

_____ a corporation, is signed to the foregoing instrument, and who is known to me, acknowledged before me on this day that, being informed of the contents of this instrument, he as such officer and with full authority executed the same voluntarily for and as the act of said corporation.

Given under my hand and official seal, this the 23rd day of October



Lura Ann Olson
Notary Public

ALABAMA POWER COMPANY
WE NO. _____
DIVISION BIRMINGHAM SKETCH OF PROPOSED WORK ESTIMATE NO. _____
TOWN MEADOW BROOK DISTRICT NORTH SHELBY DRAWN BY G. HEARN DATE _____
SCALE 1" = 40' FT. PER INCH SECT. 6 TOWNSHIP 19 RANGE 1W MAP REFERENCE # 2

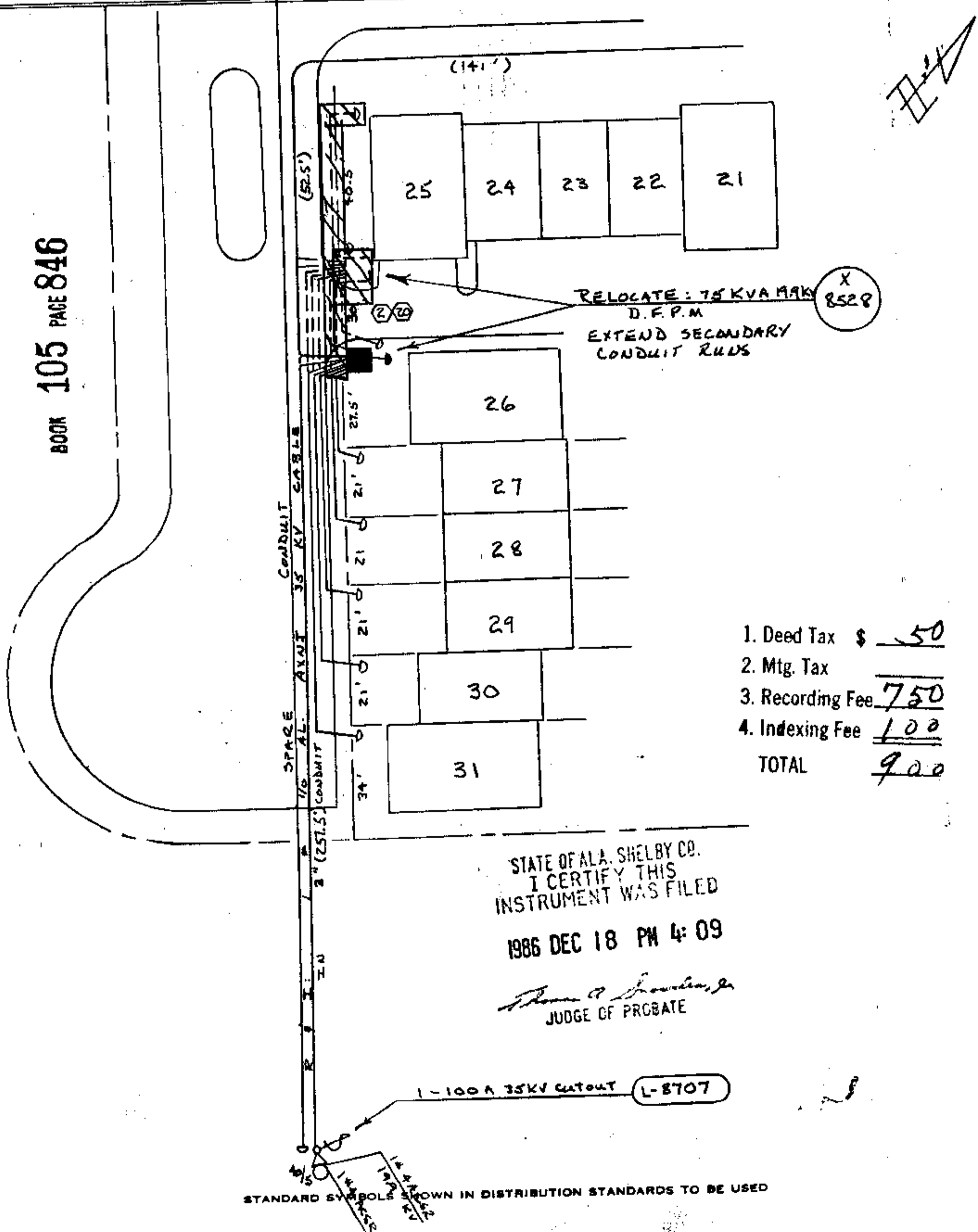

1. Deed Tax \$ 50
2. Mtg. Tax
3. Recording Fee 750
4. Indexing Fee 100
TOTAL 900

STATE OF ALA. SHELBY CO.
I CERTIFY THIS
INSTRUMENT WAS FILED
1986 DEC 18 PM 4:09
Thomas A. Fowler, Jr.
JUDGE OF PROBATE

1-100 A 35KV cutout L-8707

STANDARD SYMBOLS SHOWN IN DISTRIBUTION STANDARDS TO BE USED