

157

WE # 61700-00-0097-6-00
61700-00-0145-6-00

STATE OF ALABAMA,

County of Shelby

485300

KNOW ALL MEN BY THESE PRESENTS, that the undersigned,

City of Pelham, Ala., a Mun. Corp.

in consideration of the sum of One and No/100 Dollars (\$1.00), to it
in hand paid by Alabama Power Company, a corporation, the receipt whereof is
acknowledged, does hereby grants to said Alabama Power Company, its suc-
cessors and assigns, the right to construct, install, operate and maintain,
and the right to permit other corporations and persons to construct, install,
operate and maintain, along routes to be selected by the grantee, (generally
shown crosshatched on the attached drawing) its successors or assigns, all
poles, wires, conduits, cables, trans closures and other appliances and fac-
ilities useful or necessary in connection therewith for the overhead and
underground transmission and distribution of electric power and for the over-
head and underground communication service, upon, over, under and across the
following described land, situated in Shelby County, Alabama.

Parcel # 1

The West One Half of the Southeast Quarter of the Northwest Quarter of Section
14, Township 20 South, Range 3 West lying West of Buck Creek.

Parcel # 2

The South One Half of the West One Half of the Southwest Quarter of the South-
west Quarter of the Southwest Quarter of Section 12, Township 20 South, Range
3 West.

This instrument prepared in
the Corporate Real Estate
Dept. of Alabama Power Co.
Birmingham, Ala.

By R. C. Coggin

GRANTEE'S ADDRESS
ALABAMA POWER CO.
P. O. BOX 2641
BIRMINGHAM, AL 35291
ATT: CORP. REAL ESTATE

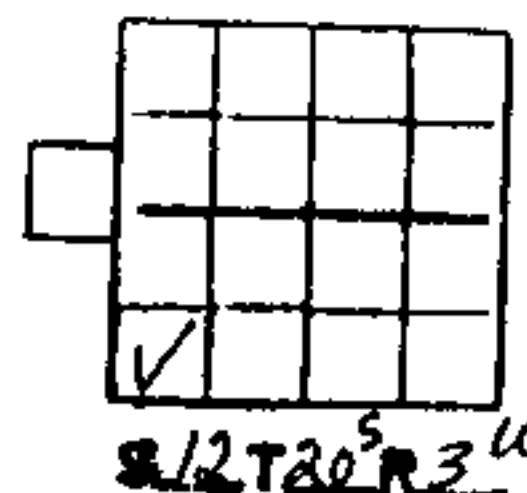
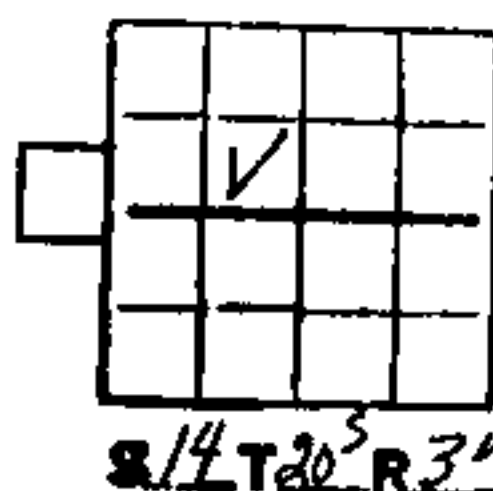

Together with all the rights and privileges necessary or convenient for the full enjoyment or use thereof, including the right of ingress and egress to and from said facilities and the right to excavate for installation, replacement, repair, and removal thereof; and also the right to cut and keep clear all trees, underbrush, shrubbery, roots and other growth, and to keep clear any and all obstructions or obstacles of whatever character on, under or above said facilities.

TO HAVE AND TO HOLD the same to the said Alabama Power Company, its successors and assigns forever.

IN WITNESS WHEREOF, the said City of Pelham, Ala., a Mun. Corp. has caused this instrument to be executed in its name by Bobby Hayes as its Mayor, and attested by Don De Haslop its City Clerk, and its corporate seal to be hereto affixed, on this the 24 day of June, 1986

Attest:

Don De Haslop
City Clerk

City of Pelham, Ala., a Mun. Corp.

Bobby Hayes
Mayor

STATE OF Alabama

COUNTY OF Shelby

I, Donna Little, a Notary Public, in and for said County in said State, hereby certify that Bobby Hayes whose name as Mayor of the City of Pelham, Alabama a corporation, is signed to the foregoing instrument, and who is known to me, acknowledged before me on this day that, being informed of the contents of this instrument, he as such officer and with full authority executed the same voluntarily for and as the act of said corporation.

Given under my hand and official seal, this the 24th day of June, 1986.

Donna Little
Notary Public

My Commission Expires May 30, 1989

BOOK 684 PAGE 174

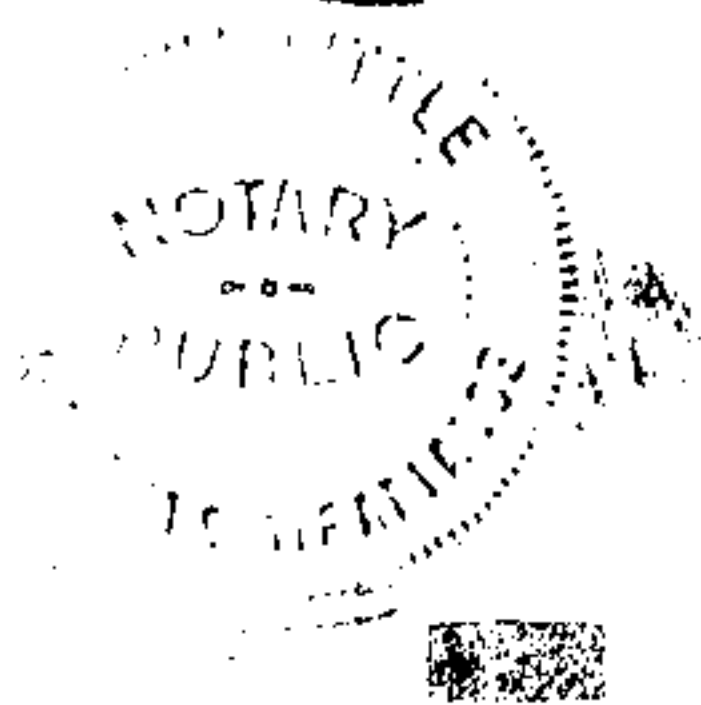

"BUILD TO 35KV SPEC."

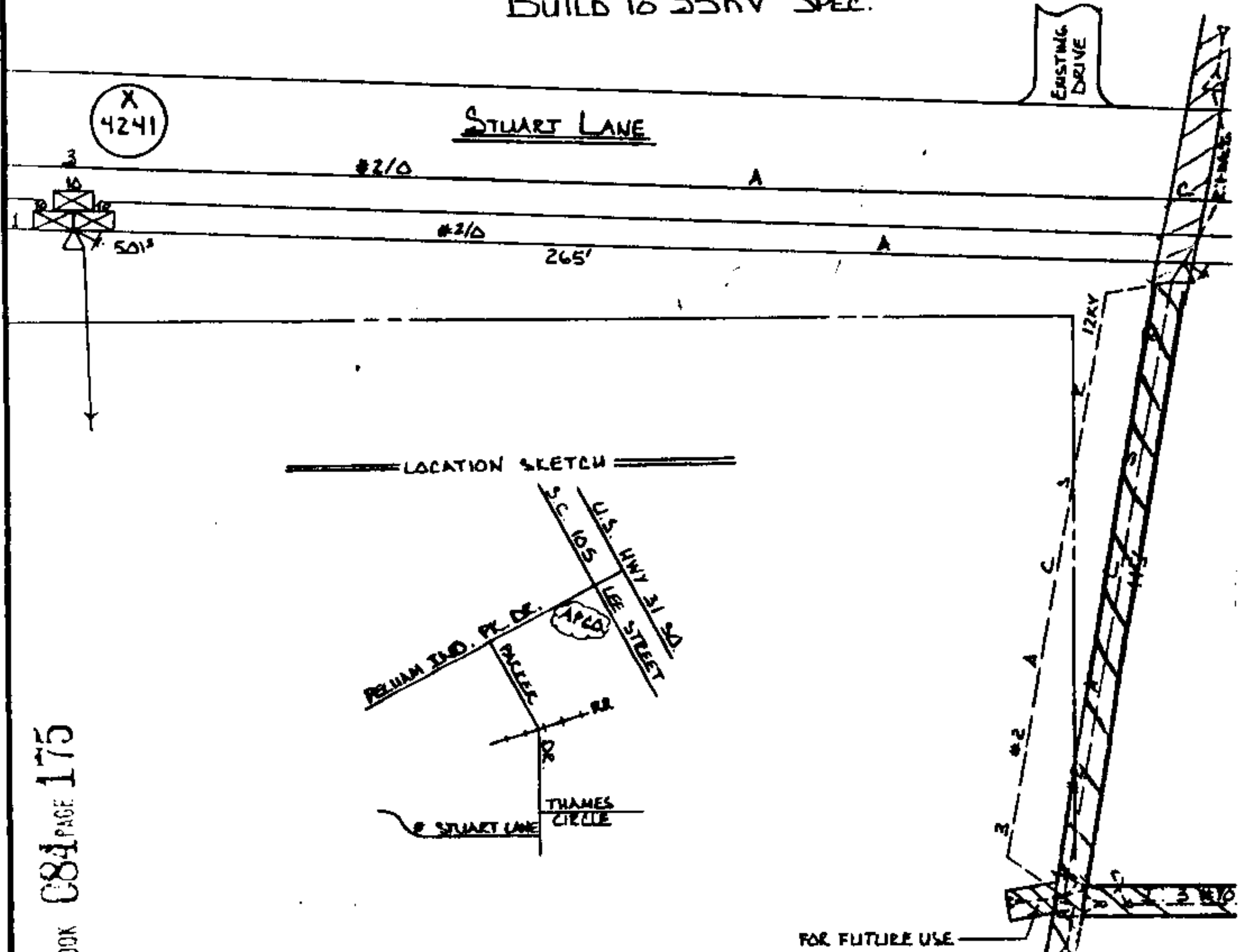

EXISTING DRIVE

BOOK 084 PAGE 175

3 SCB I. BILL APC
I: 18 1/2"
I: 2-5/16"

BOOK 084 PAGE 176

FAULT CURRENT: K.A.S	
ØØ	2999
Ø-Ø	2007
Ø-Ø	272

FOR HOTLINE WORK OPEN TAG 34536A, AND TAG 34536.

PULLING TENSION: 727LBS
SIDEWALL PRESSURE: 109LBS

MAP REF: 3W-20-14-2
SEC. - 14, TP-20S, R-3W

DRAWN L.D.
CHECKED

1 SCB I: 30' J-U POLE & 1-5/8" J-U ANG. 20' LD.
BILL APCD \$44.00 PER LINE 58A

I: 1-5/16" GUY STRAND

2 I: 50' J-U POLE
I: 1-20" STEEL X-ARM

NOTES

- 1) SCB TO BILL APCD \$456.00 FOR ALL WORK THIS W.E.
- 2) APPROVED MOTOR FLICKER ATTACHED.

BOOK 084 PAGE 176

35KV UCD CABLE IN 5" PVC SCHEDULE 40 CONDUIT

013 J-U POLE & 2-5/8" NON J-U ANG. 20' LD.
BILL APCD PER LINE 4 & 58A.

35KV PRIMARY RISER (FUSE @ 40A)

17 STRANDS

Bucket & DERRICK
Trencher, Comp.
Rope, Rope
T. Crow
YES
R/W, SCB

PELIHAM WASTE WATER
TREATMENT PLANT
ADMINISTRATION BUILDING
85.0KW - 3Ø (W)
LARGEST MOTOR: 100HP-3Ø

4 I: 1-300KVA 7.2KV 277/480V LEPM W/ATTACHED CABINET
PROPOSED LOAD: 100.0KVA @ .85 PF
CUSTOMER TO LEASE EXCESS TRANSFORMER CAPACITY
FOR ACROSS THE LINE STARTING ON THE 100HP MOTOR.

I: 3-20015A 600V CT'S

FUTURE PLANT ADDITIONS

RELL TRACED

DATE 5/28/86

DATE 6/2/86

SCALE NO
SHEET 1 OF 1 SHEETS

ALABAMA POWER COMPANY

SUBJECT NORTH SHELBY DISTRICT 12KV DISTRIBUTION SYSTEM

DETAIL PROVIDE 277/480V 3Ø 4W UCD SERVICE TO PELHAM
WASTE WATER TREATMENT PLANT - 85.0KW

D

SKETCH OF PROPOSED WORK

Alabama Power 

WE No. 61700-00-01456-01						Estimate No.	
Division BIRMINGHAM							
Town PELHAM		District NORTH SHELBY		Drawn By L. D. COCKRELL		Date 4/30/86	
Scale NONE		Ft. Per Inch 12		Township 20S		Range 3W	
						Map Reference 3W-20-12-3	

1. Deed Tax \$ 1.50
2. Mtg. Tax
3. Recording Fee 12.50
4. Indexing Fee 1.00
TOTAL 14.00

BOOK PAGE 177

