

WE # 61700-00-0088-6-00

647  
STATE OF ALABAMA,

482446

County of Shelby

KNOW ALL MEN BY THESE PRESENTS, that the undersigned,

Ginger Alred, a single woman and sole owner; Broce Brackim, a married  
man and sole owner.

BOOK 075 PAGE 691  
in consideration of the sum of One and No/100 Dollars (\$1.00), to us  
in hand paid by Alabama Power Company, a corporation, the receipt whereof is  
acknowledged, do hereby grants to said Alabama Power Company, its suc-  
cessors and assigns, the right to construct, install, operate and maintain,  
and the right to permit other corporations and persons to construct, install,  
operate and maintain, along routes to be selected by the grantee, (generally  
shown crosshatched on the attached drawing) its successors or assigns, all  
poles, wires, conduits, cables, trans closures and other appliances and fac-  
ilities useful or necessary in connection therewith for the overhead and  
underground transmission and distribution of electric power and for the over-  
head and underground communication service, upon, over, under and across the  
following described land, situated in Shelby County, Alabama.

Lot 17 and 18 of Block 4 of Nickerson-Scott  
Addition to Alabaster and recorded in Map Book  
3, Page 34 in the Office of the Judge of Probate.

This instrument prepared in  
the Corporate Real Estate  
Dept. of Alabama Power Co.  
Birmingham, Ala.

By R. C. Coggins

GRANTEE'S ADDRESS  
ALABAMA POWER CO.  
P. O. BOX 2641  
BIRMINGHAM, AL 35291  
ATT: CORP. REAL ESTATE

Together with all the rights and privileges necessary or convenient for the full enjoyment or use thereof, including the right of ingress and egress to and from said facilities and the right to excavate for installation, replacement, repair and removal thereof; and also the right to cut and keep clear all trees, underbrush, shrubbery, roots and other growth, and to keep clear any and all obstructions or obstacles of whatever character on, under or above said facilities.

TO HAVE AND TO HOLD the same to the said Company, its successors and assigns, forever.

IN WITNESS WHEREOF, we have hereunto set our hands and seals, this the 10<sup>th</sup> day of April, 1986.

WITNESS:

Kathy Howell  
Chas E. Reed

Ingemar Alund (Seal)  
Bruce Brock (Seal)

STATE OF Ala  
COUNTY OF Shelby

I, Ingemar Alund, a Notary Public, in and

for said County in said State, hereby certify that Ingemar Alund  
Bruce Brock whose name he signed to the foregoing  
instrument and who are known to me, acknowledged before me on this day that being  
informed of the contents of the instrument they executed the same voluntarily,  
on the day the same bears date.

Given under my hand and official seal, this the 10 day of

April, 1986.

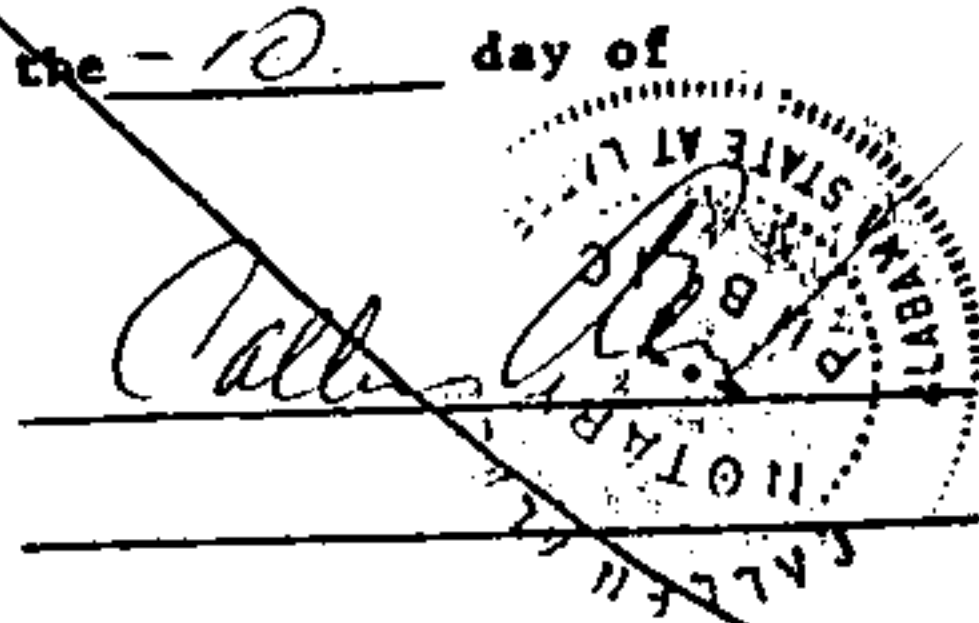

Exp 9/27/87

MR. ALRED & BRACKIN  
7th St ALABASTER

TING = 20KWD  
CING = 1KWD  
CUND = 29KWD  
ONA = 8KWD  
C = 1KWD  
59KWD SUMMER

BEST MOTOR 10HP

SHELBY  
MEDICAL  
CENTER

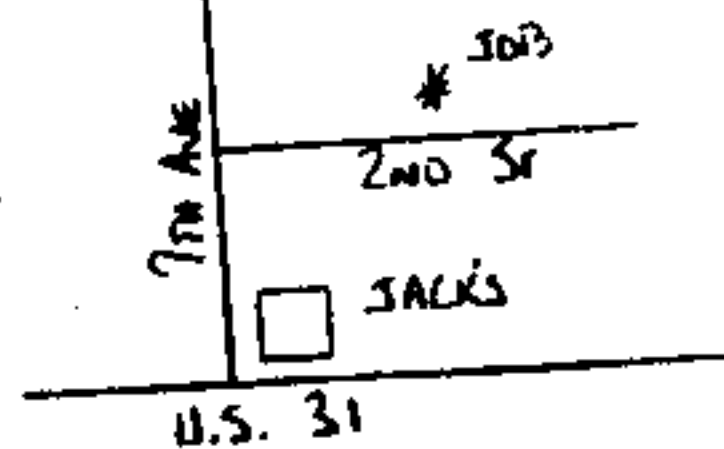

R-40<sup>15</sup> (1) 10  
I-45<sup>14</sup>  
I-318" STR IN EXISTING  
SCB 1" Rd. SCB TO  
BILL APLO #56"  
FOR 12000 JOANE.

② SCB 45<sup>14</sup> (176) L=17°  
I-PLP 12 2"x20" BKS  
AS 20 BKT.  
I-316" STR IN SCB AV  
SCB TO BILL APLO #44"  
HALF COST TO ALC.

③ 40<sup>16</sup>  
R-820 PLATE ALC. 518"  
5116" STR

X  
277  
315

NO  
# R-1020A 7.2KV  
ESP IDLE  
CONNECT STREET  
LIGHT TO MSLC

BOOK 075 PAGE 693

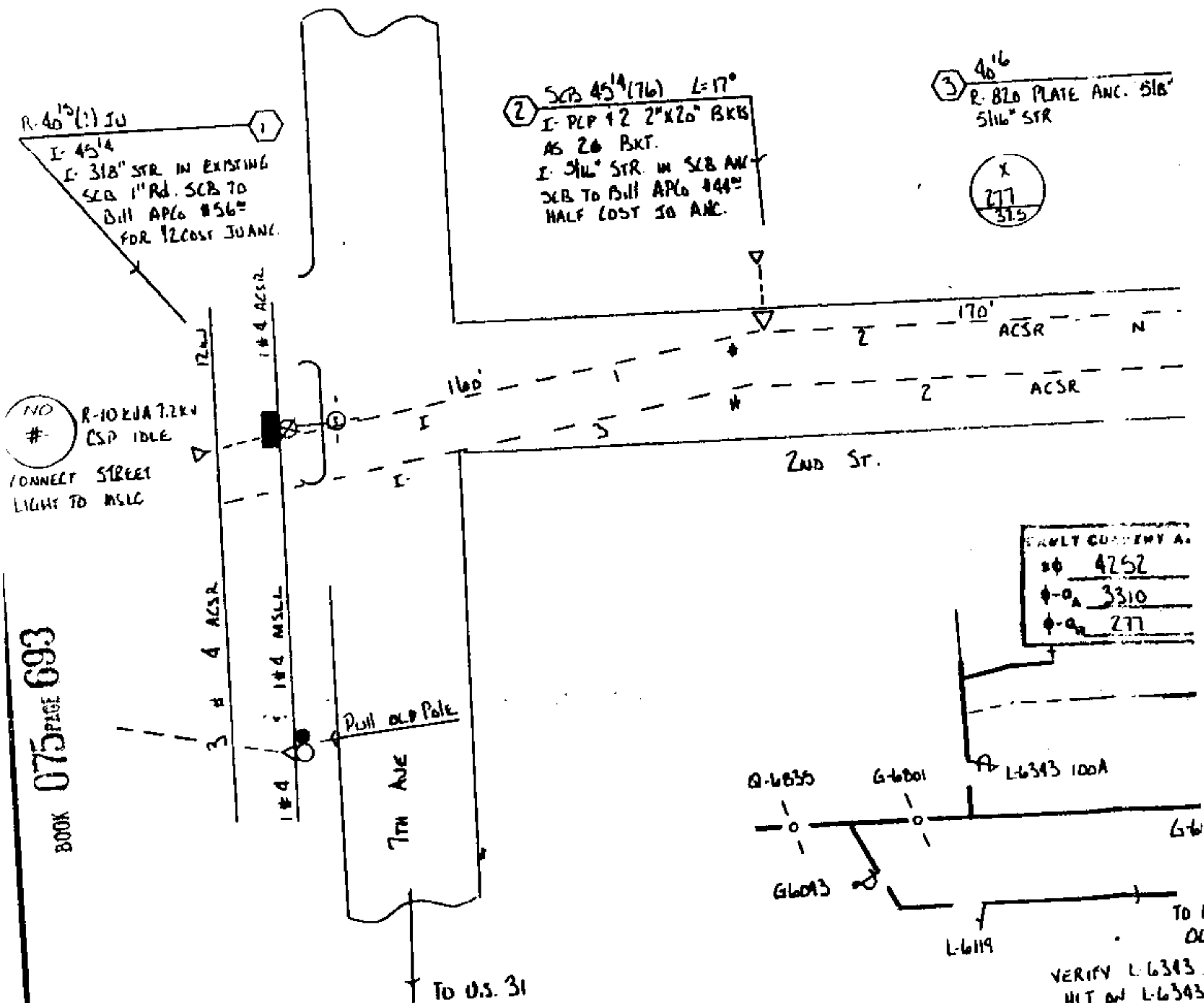

SAULT COUNTY A.  
# 4252  
#-A 3310  
#-A 277

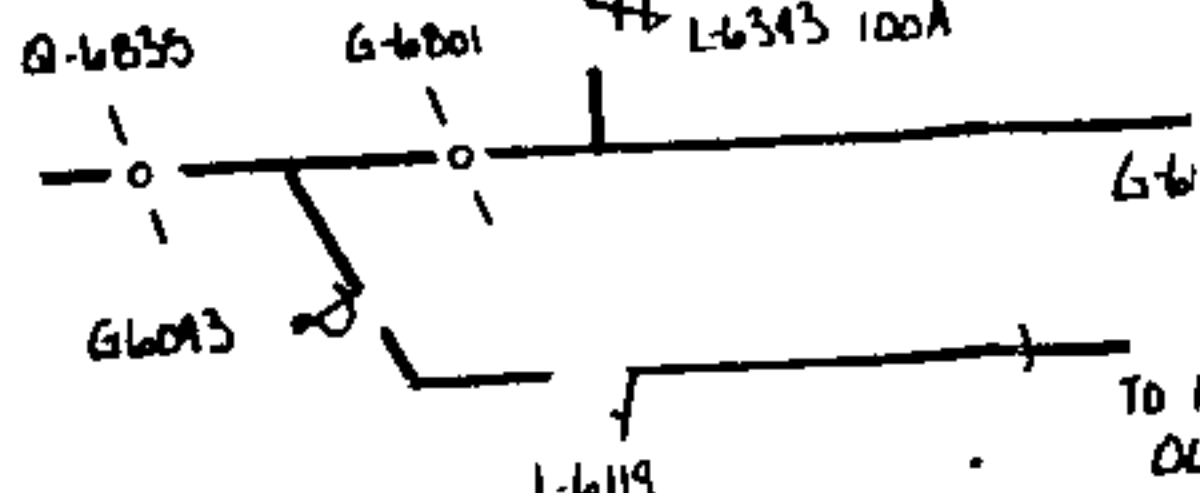

VERIFY L-6343  
HLT ON L-6343

DRAWN J FRE  
CHECKED *[Signature]*  
APPROVED

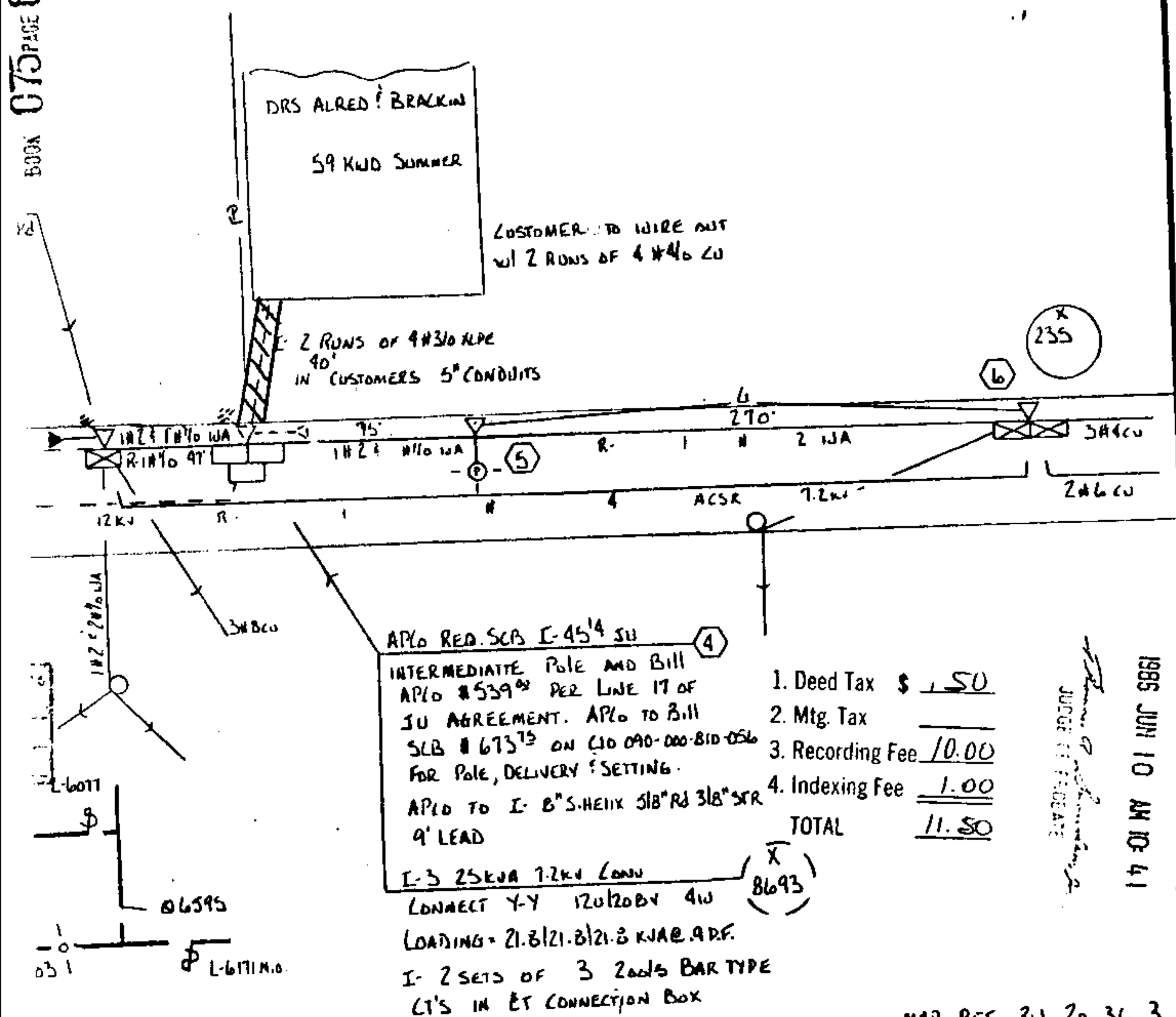

APLO RED. SCB E-45<sup>14</sup> SU  
 INTERMEDIATE POLE AND BILL  
 APLO #539<sup>00</sup> PER LINE 17 OF  
 SU AGREEMENT. APLO TO BILL  
 SCB #673<sup>73</sup> ON CIO 090-000-810-056  
 FOR POLE, DELIVERY & SETTING.  
 APLO TO E-8" S-HENK 518" RD 318" SR  
 9' LEAD

E-3 25KVA 7.2KV LOWV  
 CONNECT Y-Y 120/208V 4W  
 LOADING = 21.8/21.8/21.8 KVA @ 90%  
 E-2 SETS OF 3 200/5 BAR TYPE  
 CT'S IN ET CONNECTION BOX

1. Deed Tax \$ 1.50  
 2. Mtg. Tax \_\_\_\_\_  
 3. Recording Fee 10.00  
 4. Indexing Fee 1.00  
 TOTAL 11.50

*James G. [Signature]*  
 JUDGE OF PROBATE

1985 JUN 10 AM 10:41

STATE OF ALA. SUP. CO. CLERK  
 INST. BY THIS

MAP REF 3U 20 3L 3

LABASTER D.S.  
 5 24870 0-720 G-240  
 TO BE FUSED 100 A THEN PLACE  
 ALSO TAG NO 24870 & 24870 A

NO TRACED  
*7 L. Cooy*  
 DATE 3/13/86  
 DATE 3-29-86  
 DATE \_\_\_\_\_

ALABAMA POWER COMPANY	
SUBJECT NORTH SHELBY DISTRICT 12KV DISTRIBUTION	
DETAIL PROVIDE 120/208V 3PH 4W SERVICE TO DOCTORS OFFICE	
BLDG. 2ND ST ALABASTER	
SCALE 1"=50'	B-61700-00-00886-00
SHEET 1 OF 1 SHEETS	
SUPERSEDES _____	