

2691

475630

State of Alabama

WE # 1700-00-00184-5-00

County of Shelby

KNOW ALL MEN BY THESE PRESENTS, that the undersigned,

Key-Royal Automotive Company

for and in consideration of the sum of One and No/100 Dollars (\$1.00), to
it in hand paid by Alabama Power Company, a corporation, the receipt
whereof is acknowledged, does hereby grant to said Alabama Power Company,
its successors and assigned, the right to construct, install, operate and
maintain, and the right to permit other corporations and persons to construct,
install, operate and maintain along a route to be selected by the grantee,
(generally shown crosshatched on the attached drawing) its successors and
assigns, all conduits, cables, trans closures and other appliances and
facilities useful or necessary in connection therewith, for the underground
transmission and distribution of electric power and for underground communi-
cation service, upon, under and across the following described land situated
in Shelby County, Alabama:

All that part of the Northeast Quarter of the Southwest Quarter of the
Southwest Quarter of Section 31, Township 18 South, Range 1 West lying
South of U. S. Highway 280.

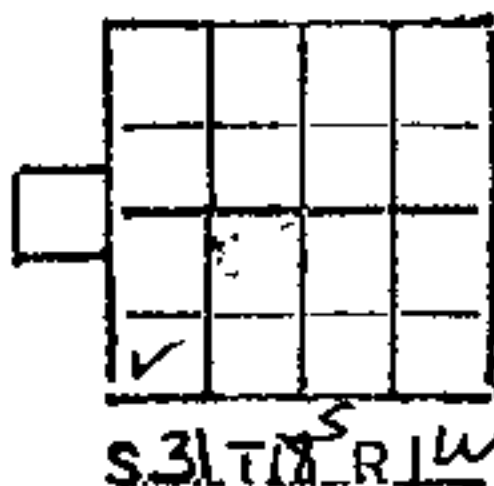

GRANTEE'S ADDRESS
ALABAMA POWER CO.
P. O. BOX 2641
BIRMINGHAM, AL. 35201
ATT: CORP. REAL ESTATE

This instrument prepared by
the Corporate Real Estate
Dept. of Alabama Power Co.
Birmingham, Ala.

By R.C. Coggins

BOOK 046 PAGE 61

Together with all the rights and privileges necessary or convenient for the full enjoyment or use thereof, including the right of ingress and egress to and from said facilities and the right to excavate for installation, replacement, repair, and removal thereof; and also the right to cut and keep clear all trees, underbrush, shrubbery, roots and other growth, and to keep clear any and all obstructions or obstacles of whatever character on, under or above said facilities.

TO HAVE AND TO HOLD the same to the said Alabama Power Company, its successors and assigns forever.

IN WITNESS WHEREOF, the said Key-Royal Automotive Company

has caused this instrument to be executed in its name by John B. Richardson

as its President, and attested by _____

as its Asst. Secretary, and its corporate seal to be

hereto attested on this the 8th day of October, 1985.

KEY-ROYAL AUTOMOTIVE COMPANY

Assistant Secretary

President

STATE OF Alabama

COUNTY OF Jefferson

I, Peggy McSweeney, a Notary Public, in and for said County in said State, hereby certify that John B. Richardson whose name as President of Key-Royal Automtoive Company a corporation, is signed to the foregoing instrument, and who is known to me, acknowledged before me on this day that, being informed of the contents of this instrument, he as such officer and with full authority executed the same voluntarily for and as the act of said corporation.

Given under my hand and official seal, this the 8th day of October 1985.

Peggy McSweeney
Notary Public
My Commission Expires Nov. 16, 1985

BOOK 046 PAGE 63

X
8343

I: 500 KVA LINE FRONT PAD MOUNT
277/480V, 3 ϕ , 19.1/34.5 KV WITH
ATTACHED CABINET
PROP. LB.- 384.4 KVA
90% P.F.
I: 3-600/5 C.T.'S 600V

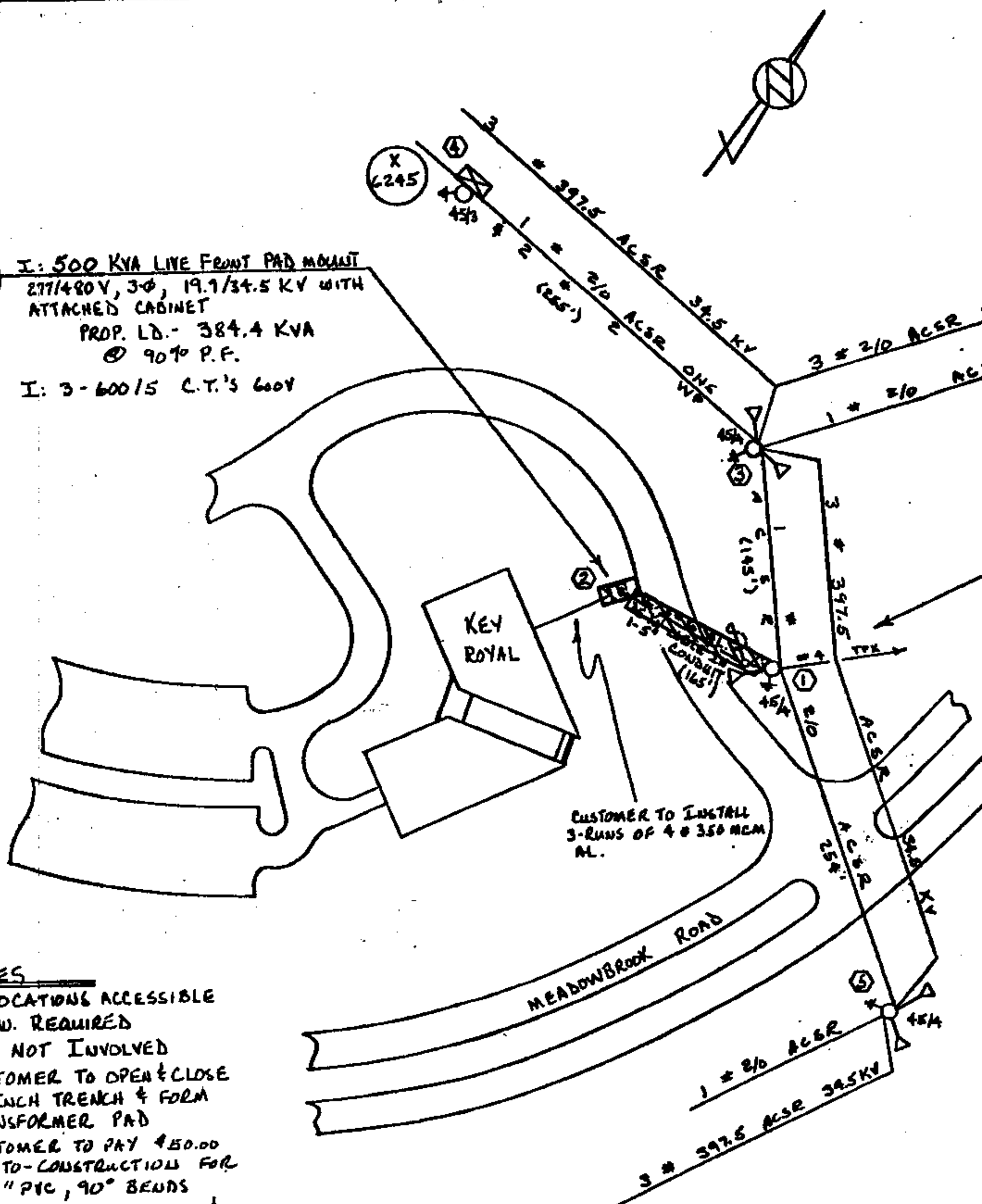

NOTES

- 1) ALL LOCATIONS ACCESSIBLE
- 2) R.O.W. REQUIRED
- 3) SCB NOT INVOLVED
- 4) CUSTOMER TO OPEN & CLOSE 48 INCH TRENCH & FORM TRANSFORMER PAD
- 5) CUSTOMER TO PAY \$50.00 AID-TO-CONSTRUCTION FOR 2-5" PVC, 90° BENDS
- 6) CUSTOMER TO PROVIDE & INSTALL 5" SCHEDULE 40 CONDUIT

PULLING TENSION

① TO ② - 837.2 LBS
SWP - 167.4 LBS/FT.

MAP REFERENCE

IW-185-31-3

DRAWN G. H.

CHECKED *[Signature]*

APPROVED *[Signature]*

LOAD DATA	
IND. LTG. -	53
OUT. LTG. -	3
COOKING (MAI) -	11
COOKING (MISC) -	4
WATER HTG. -	22
RES. HT. -	350
A/C HT. PUMP -	248
MOTORS - 1Ø -	16
MOTORS - 3Ø -	40
MISC. -	112
TOTAL	859 KWC

SUMMER DEMAND - 235 KW
WINTER DEMAND - 346 KW

LARGEST MOTOR 25 HP 3-Ø
LARGEST A/C COMP. 25 HP 3-Ø

LOCATION SKETCH

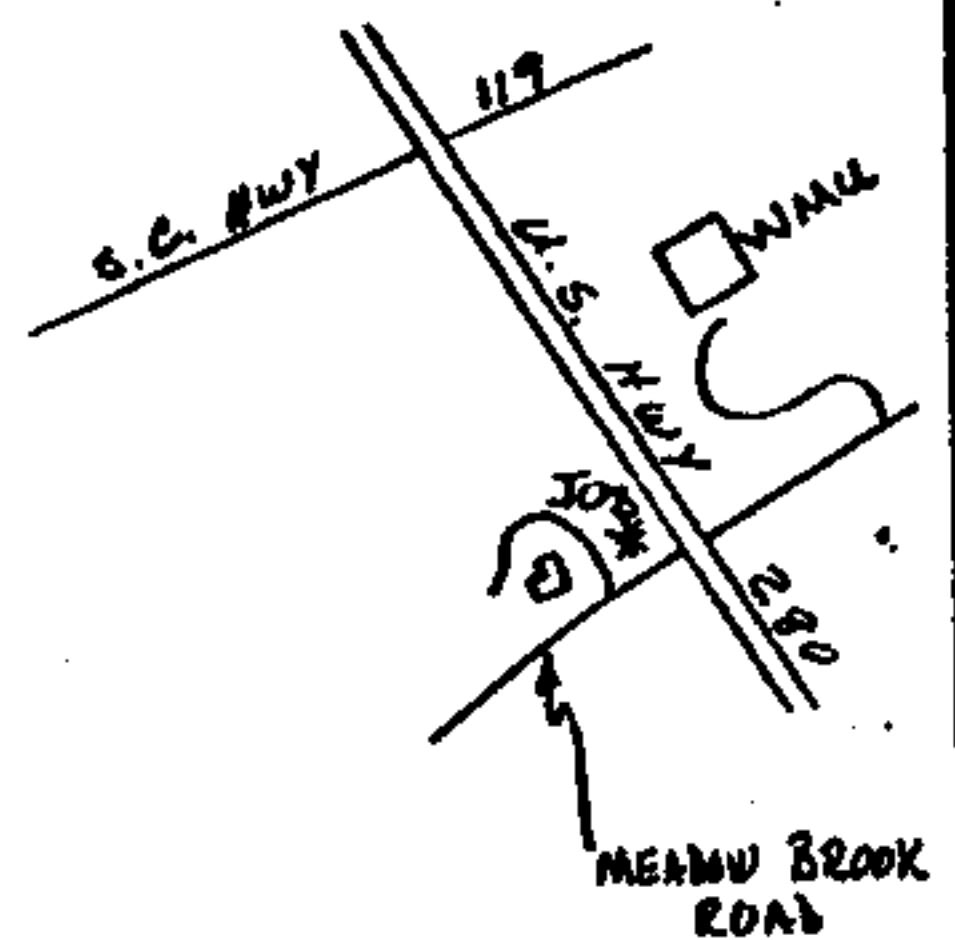

I: 3-100 A 35KV CUTOUTS
I: 3 PHASE RISER ASSEMBLY
(FUSE 15A)

(X)
8343

NOTE:

Right of Way is 10 feet
wide along route hatched
and 10 feet by 10 feet
at Transclosure.

SECTIONALIZING

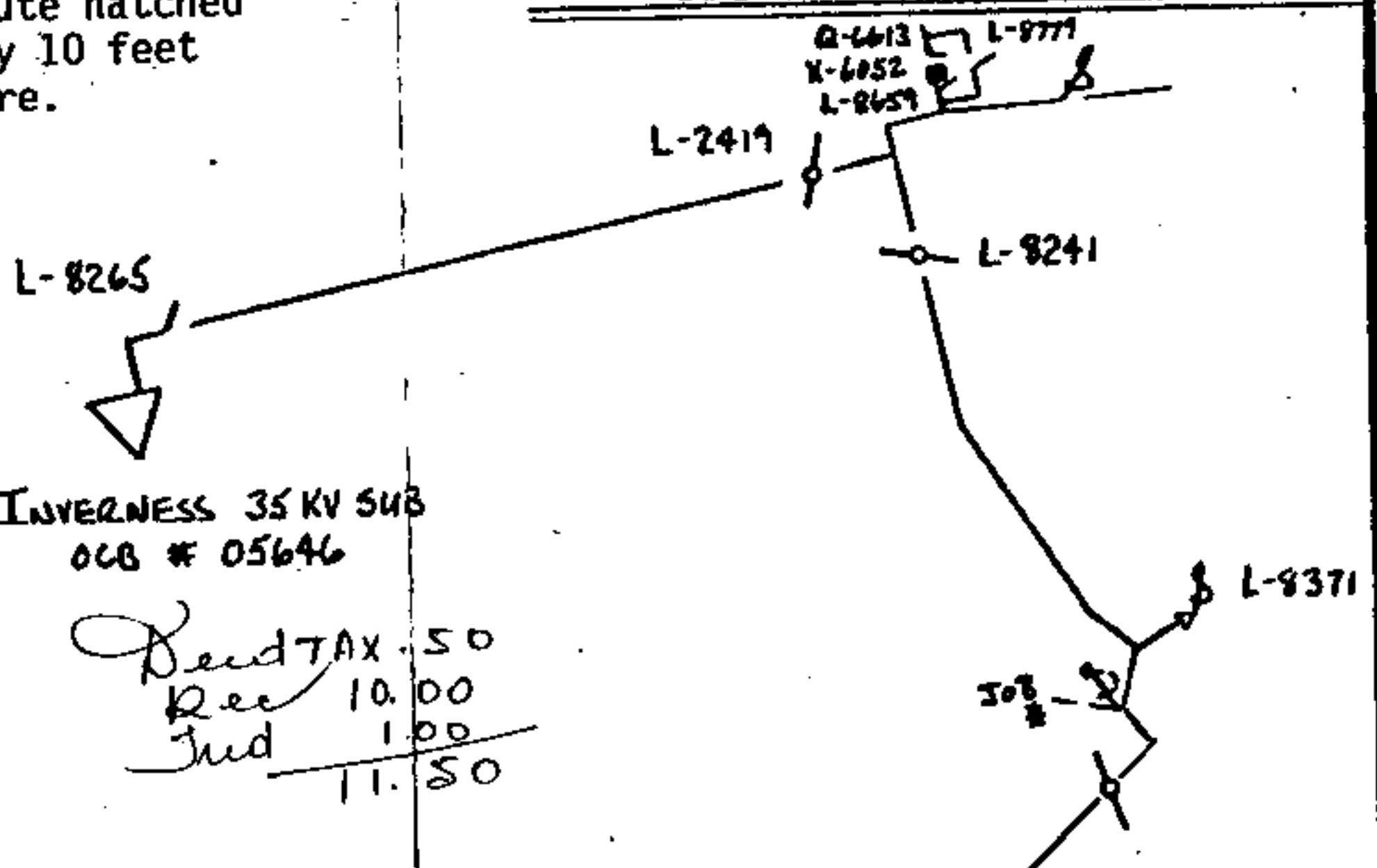

INVERNESS 35 KV SUB
OCB # 05646

Deed TAX .50
Rec 10.00
Ind 1.00
11.50

STATE OF ALA. SHELBY CO.
I CERTIFY THIS
INSTRUMENT WAS FILED
1985 OCT 23 PM 2:28

Thomas A. Schuchman, Jr.
JUDGE OF PROBATE

ALABAMA POWER COMPANY

SUBJECT NORTH SHELBY 35KV DISTRIBUTION
DETAIL PROVIDE 277/480V UG SERVICE TO
NEW BUILDING WITH 346 KWD

SCALE 1" = 90'
SHEET 1 OF 1 SHEETS
SUPERSEDES NONE

B-170000-001845-00

NOT TRACED

DATE

DATE 8/14/85

DATE 8/16/85

W. L. Coy
Waters