

STATE OF Alabama )

736

COUNTY OF Shelby )

WE # 1700-00-00173-4-00

460965

KNOW ALL MEN BY THESE PRESENTS, that the undersigned,

Lowrey Building Supply Co Inc

for and in consideration of the sum of One and No/100 Dollars (\$1.00), to  
us in hand paid by Alabama Power Company, a corporation, the receipt  
whereof is acknowledged, we hereby grant to said Alabama Power Company,  
its successors and assigns, the right to construct, install, operate and maintain,  
and the right to permit other corporations and persons to construct, install,  
operate and maintain, along a route to be selected by the grantee, (generally shown  
crosshatched on the attached drawing) its successors and assigns, all conduits,  
cables, trans closures and other appliances and facilities useful or necessary in  
connection therewith, for the underground transmission and distribution of electric  
power and for underground communication service, upon, under and across the following  
described land situated in Shelby County, Alabama:

Lot 29- Meadow Brook

2nd Sector - 2nd Phase

AS RECORDED IN MAP BOOK 7,

PAGE 86 IN THE OFFICE OF THE  
JUDGE OF PROBATE, SHELBY  
COUNTY, ALABAMA

This instrument prepared in  
the Corporate Real Estate  
Dept. of Alabama Power Co.  
Birmingham, Ala.

By R. C. Caggin

GRANTEE'S ADDRESS  
ALABAMA POWER CO.  
P. O. BOX 5041  
BIRMINGHAM, AL 35291  
ATT: CORP. REAL ESTATE

BOOK 005 PAGE 149

Together with all the rights and privileges necessary or convenient for the full enjoyment or use thereof, including the right of ingress and egress to and from said facilities and the right to excavate for installation, replacement, repair and removal thereof; and also the right to cut and keep clear all trees, underbrush, shrubbery, roots and other growth, and to keep clear any and all obstructions or obstacles of whatever character on, under or above said facilities.

TO HAVE AND TO HOLD the same to the said Company, its successors and assigns, forever.

IN WITNESS WHEREOF, we have hereunto set our hands and seals, this the

5 day of Sept, 1984.

WITNESS:

[Signature]

Lowrey Building Supply Co Inc  
Mary M. Lowrey (Seal)  
President (Seal)

STATE OF Alabama )  
COUNTY OF Shelby )

I, Don D. Bailey, a Notary Public, in and for said County in said State, hereby certify that MARY M. LOWREY whose name IS signed to the foregoing instrument and who IS known to me, acknowledged before me on this day that being informed of the contents of the instrument she executed the same voluntarily, AS President of Lowrey Building Supply Co., Inc on the day the same bears date.

Given under my hand and official seal, this the 5<sup>th</sup> day of September, 1984.

Don D. Bailey  
NOTARY Public State of Alabama  
ALABAMA STATE NOTARY

ALABAMA POWER COMPANY  
SKETCH OF PROPOSED WORK

WE NO. 170000-001734-81

DIVISION BIRMINGHAM

ESTIMATE NO. \_\_\_\_\_

TOWN MEADOW BROOK DISTRICT ALABASTER DRAWN BY L.D. COCKPELL DATE 3/17/84SCALE 1015 FT. PER INCH SECT. 12 TOWNSHIP 19S RANGE 2N MAP REFERENCE D-50-71815-54

## NOTES

- 1) CUSTOMER TO PAY \$ 283.25 PER MP-715-110.
- 2) CUSTOMER NOTIFIED OF RESPONSIBILITIES PER MP-715-110 BY A. WEBB.
- 3) CUSTOMER TO OPEN AND BACKFILL MIN. 36" DITCH.
- 4) CUSTOMER SEPTIC TANK AND FIELD LINES LOCATED SOUTH OF HOUSE.

X  
7964

I: 1.375 KVA 19.9 KV CSP 120/240V  
 PROPOSED LOAD: 29.8 KVA  
 I: 2 #3/0 & 1 #40 AL XLP 600V LG.  
 SEC. CABLE (1257).

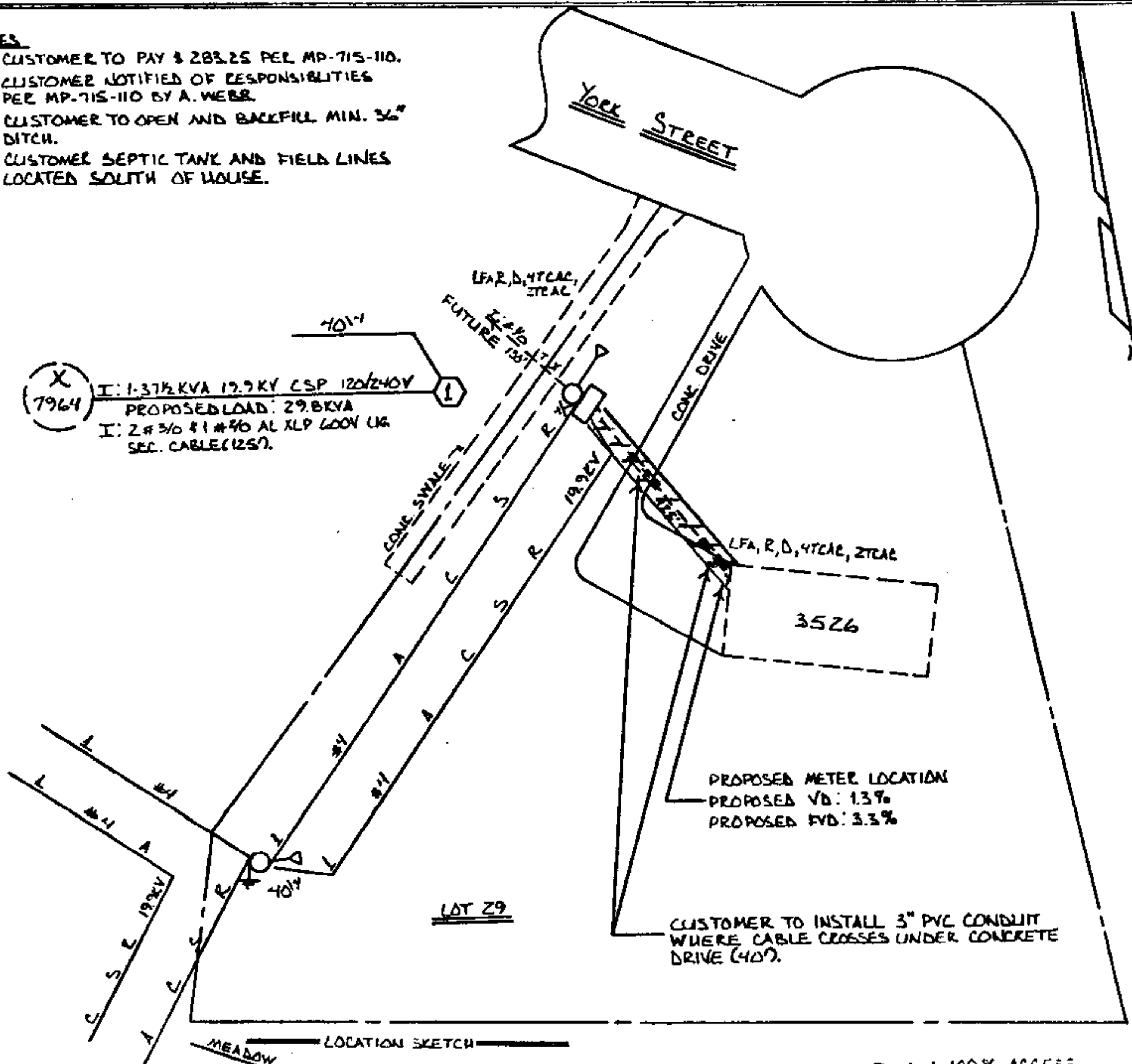

## RECORDING FEES

Mortgage Tax \$ \_\_\_\_\_  
 Deed Tax 50  
 Mineral Tax \_\_\_\_\_  
 Recording Fee 7.50  
 Index Fee 1.00  
 TOTAL \$ 9.00

STANDARD SYMBOLS SHOWN IN DISTRIBUTION STANDARDS TO BE USED

STATE OF ALABAMA  
 I CERTIFY THAT  
 INSTRUMENT NO. \_\_\_\_\_

1984 OCT 10 PM 12:52

*[Signature]*  
 JUDY \_\_\_\_\_

Bucket 100% ACCESS.

Transf. Cart \_\_\_\_\_

Hand Hole \_\_\_\_\_

Rock \_\_\_\_\_

Tree Crew \_\_\_\_\_

Staked \_\_\_\_\_

Permit P.O.W.

Work with \_\_\_\_\_