

328

GRANTEE'S ADDRESS  
ALABAMA POWER CO.  
P. O. BOX 2641  
BIRMINGHAM, AL 35291  
ATTY: CORP. REAL ESTATE

457499

STATE OF Alabama

WIT: D. E. Gibson

IVE # 1700-00-00107-4-00

COUNTY OF Shelby

KNOW ALL MEN BY THESE PRESENTS, that the undersigned,

WE, Julie NARZ & husband, MARVIN MARZ

in consideration of the sum of One and No/100 Dollars (\$1.00), to us  
in hand paid by Alabama Power Company, a corporation, the receipt whereof  
is acknowledged, WE hereby grant to said Alabama Power Company, its  
successors and assigns, the right to construct, install, operate and main-  
tain, and the right to permit other corporations and persons to construct,  
install, operate and maintain, along routes to be selected by the grantee,  
(generally shown crosshatched on the attached drawing) its successors or  
assigns, all poles, wires, conduits, cables, trans closures and other appli-  
ances and facilities useful or necessary in connection therewith for the  
overhead and underground transmission and distribution of electric power and  
for the overhead and underground communication service, upon, over, under and  
across the following described land, situated in Shelby

County, Alabama:

A TRACT OF LAND IN THE NORTHWEST QUARTER OF THE NORTHWEST QUARTER  
OF SECTION 29, TOWNSHIP 19 SOUTH, RANGE 2 WEST described AS FOLLOWS;  
<sup>BEGIN</sup>  
BEGIN AT THE SOUTHERST CORNER OF LOT 7-A OF WILLOWOOD PARK, AS  
RECORDED IN MAP BOOK 5, PAGE 78, THENCE NORTHWESTERLY ALONG LOT  
LINE 545.31 FEET TO NORTH LINE OF FORTY; THENCE RIGHT AND EASTERLY  
ALONG SAID NORTH LINE 385.0 FEET; THENCE RIGHT AND SOUTHWESTERLY  
480 FEET TO A POINT ON THE NORTH RIGHT OF WAY LINE OF HILGATE  
ROAD; SAID POINT BEING 60 FEET EAST OF THE POINT OF BEGINNING;  
THENCE RIGHT AND WESTERLY ALONG ROAD 60 FEET TO THE POINT  
OF BEGINNING.

This Instrument prepared in  
the Corporate Real Estate  
Dept. of Alabama Power Co.  
Birmingham, Ala.

By R.C. Coggins

Al. Power Co.

BOOK 357 PAGE 112

28  
S. 29  
T. 19S.  
R. 2W.

Together with all the rights and privileges necessary or convenient for the full enjoyment or use thereof, including the right of ingress and egress to and from said facilities and the right to excavate for installation, replacement, repair and removal thereof; and also the right to cut and keep clear all trees, underbrush, shrubbery, roots and other growth, and to keep clear any and all obstructions or obstacles of whatever character on, under or above said facilities.

TO HAVE AND TO HOLD the same to the said Company, its successors and assigns, forever.

IN WITNESS WHEREOF, we have hereunto set our hands and seals, this the 4<sup>th</sup> day of JUNE, 1984.

WITNESS:

\_\_\_\_\_  
\_\_\_\_\_

Julie Narz (Seal)  
Marvin Narz (Seal)

STATE OF Alabama )  
COUNTY OF Shelby )

I, DON D. BAILEY, a Notary Public, in and for said County in said State, hereby certify that JULIE NARZ & HUSBAND MARVIN NARZ whose names ARE designed to the foregoing instrument and who ARE known to me, acknowledged before me on this day that being informed of the contents of the instrument they executed the same voluntarily, on the day the same bears date.

Given under my hand and official seal, this the 4<sup>th</sup> day of JUNE, 1984.

Don D. Bailey  
NOTARY PUBLIC STATE OF ALABAMA

ALABAMA POWER COMPANY

WE NO. 170000-00107400

DIVISION BIRMINGHAM

## SKETCH OF PROPOSED WORK

ESTIMATE NO. \_\_\_\_\_

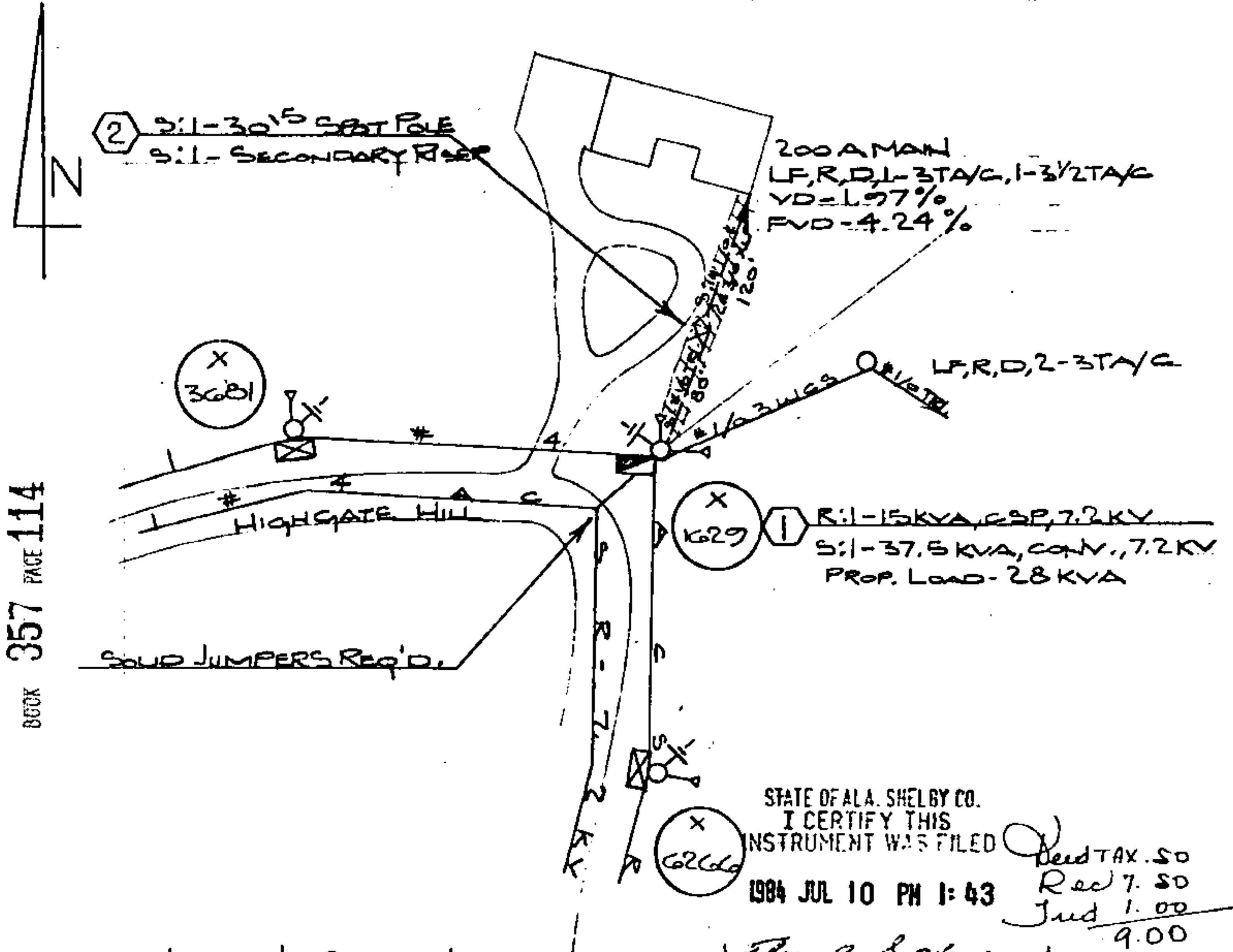
TOWN INDIAN SPRINGS DISTRICT ALABASTER DRAWN BY L. CROCKERDATE 5-17-84SCALE N.T.S. FT. PER INCH SECT. 29 TOWNSHIP 19S RANGE 2W MAP REFERENCE 71845-43357 PAGE 114  
BOOK

FAULTY CURRENT AMPS	
30	—
φ-0A	632A
φ-0A	209A

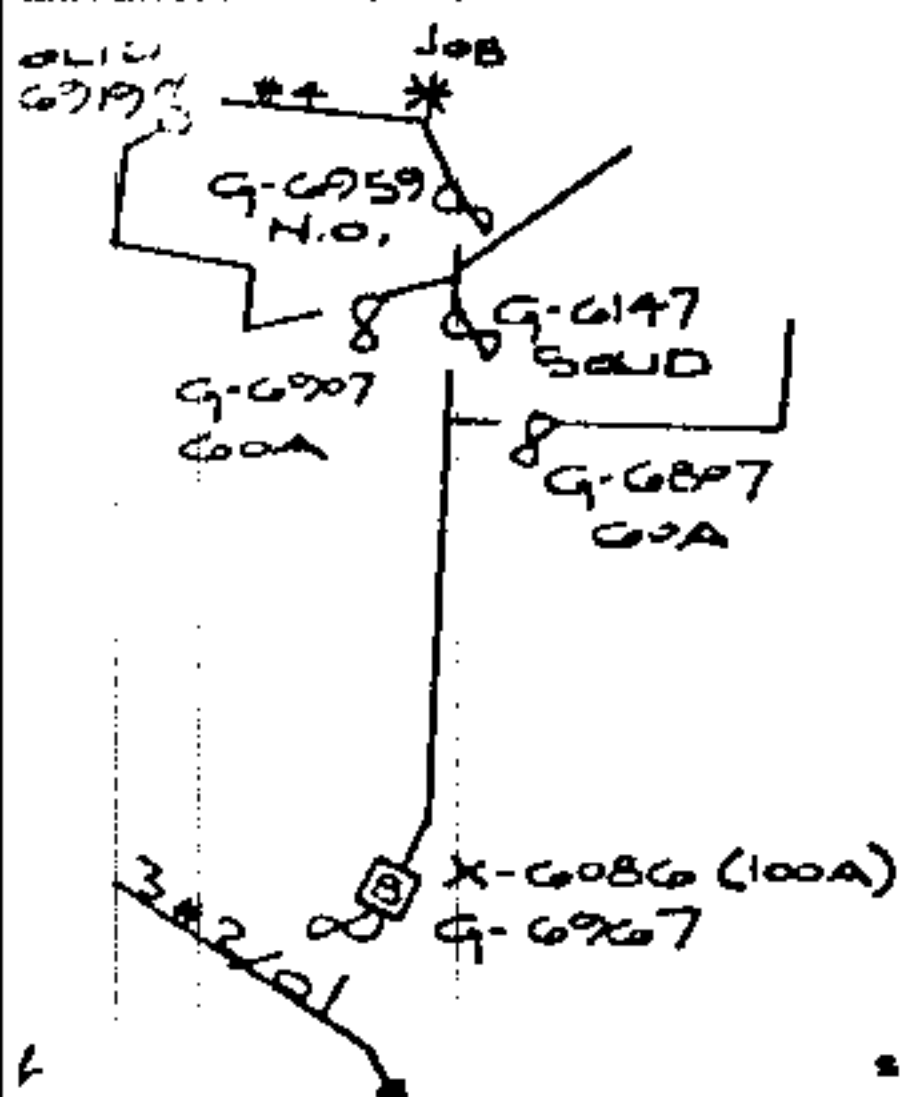

STANDARD SYMBOLS SHOWN IN DISTRIBUTION STANDARDS TO BE USED