

STATE OF Alabama 337)
COUNTY OF Shelby)

GRANTEE'S ADDRESS
ALABAMA POWER CO.
P. O. BOX 2641
BIRMINGHAM, AL 35291
ATT: CORP. REAL ESTATE

INE # 1700-08-00033-4-00

457498

KNOW ALL MEN BY THESE PRESENTS, that the undersigned,

Roy Martin Construction, Inc.

for and in consideration of the sum of One and No/100 Dollars (\$1.00), to
it in hand paid by Alabama Power Company, a corporation, the receipt
whereof is acknowledged, does hereby grant to said Alabama Power Company,
its successors and assigns, the right to construct, install, operate and maintain,
and the right to permit other corporations and persons to construct, install,
operate and maintain, along a route to be selected by the grantee, (generally shown
crosshatched on the attached drawing) its successors and assigns, all conduits,
cables, trans closures and other appliances and facilities useful or necessary in
connection therewith, for the underground transmission and distribution of electric
power and for underground communication service, upon, under and across the following
described land situated in Shelby County, Alabama:

A TRACT OF LAND IN THE EAST ONE HALF OF THE SOUTHWEST QUARTER OF
SECTION 14, TOWNSHIP 19 SOUTH, RANGE 2 WEST DESCRIBED AS FOLLOWS:
BEGIN AT THE SOUTHEAST CORNER OF LOT # 1 OF BLOCK 1 OF SUNNY
MEADOWS AS RECORDED IN MAP BOOK 8, PAGE 18 IN THE OFFICE OF THE
JUDGE OF PROBATE; THENCE WESTERLY ALONG SOUTH LINE OF SAID LOT 1
167.73 FEET; THENCE RIGHT AND ALONG SOUTHWEST LINE OF LOTS 2 & 3
313 FEET; THENCE LEFT AND ALONG SOUTH LINE OF LOTS 4, 5 & 6
298.12 FEET; THENCE LEFT AND ALONG EAST LINE OF LOT # 8 219.97
FEET; THENCE LEFT AND EASTERLY BUT ALONG EXTENDED COURSE OF
LOTS 8 & 9 SOUTH LINES 380 FEET TO A POINT; THENCE RIGHT
AND SOUTHERLY 765 FEET TO A POINT ON NORTH RIGHT OF WAY
LINE OF Shelby County Road # 14; THENCE LEFT AND NORTHEASTERLY
ALONG SAID ROAD 14 600 FEET TO THE EAST LINE OF SUNNY
MEADOWS LANE; THENCE LEFT AND NORTHERLY ALONG SAID LANE
TO THE SOUTHEAST CORNER OF LOT # 1 AND THE POINT OF
BEGINNING.

A. L. Power Co.

Together with all the rights and privileges necessary or convenient for the full enjoyment or use thereof, including the right of ingress and egress to and from said facilities and the right to excavate for installation, replacement, repair, and removal thereof; and also the right to cut and keep clear all trees, underbrush, shrubbery, roots and other growth, and to keep clear any and all obstructions or obstacles of whatever character on, under or above said facilities.

TO HAVE AND TO HOLD the same to the said Alabama Power Company, its successors and assigns, forever.

IN WITNESS WHEREOF, the said Roy Martin Construction Co., Inc has caused this instrument to be executed in its name by Roy L. Martin as its President, and attested by _____ its _____, and its corporate seal to be hereto affixed, on this the 7th day of JUNE, 1948

Attest:

Roy Martin Construction Co., Inc.
By Roy L. Martin
President

STATE OF Alabama)
COUNTY OF Shelby)

I, Undersigned, a Notary Public, in and for said County in said State, hereby certify that Roy L. Martin

_____ whose name as President of Roy Martin Construction, Inc., a corporation, is signed to the foregoing instrument, and who is known to me, acknowledged before me on this day that, being informed of the contents of this instrument, he as such officer and with full authority executed the same voluntarily for and as the act of said corporation.

Given under my hand and official seal, this the 6 day of June, 1948

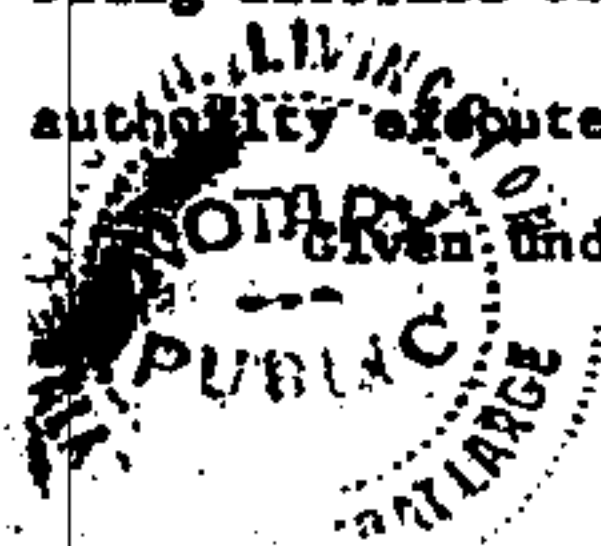

This instrument prepared in the Corporate Real Estate Dept. of Alabama Power Co. Birmingham, Ala.

By R. L. Coppin

Carol H. Livingston
Notary Public 7-16-25

ALABAMA POWER COMPANY

WE NO. 170008-000334-00

DIVISION BIRMINGHAM

SKETCH OF PROPOSED WORK

ESTIMATE NO.

TOWN CANAWA VALLEY

DISTRICT ALABASTER

DRAWN BY R. CHENEY

DATE 4-27-84

SCALE 1"=100'

FT. PER INCH

SECT. 14

TOWNSHIP 19S

RANGE 2W

MAP REFERENCE

71845-58

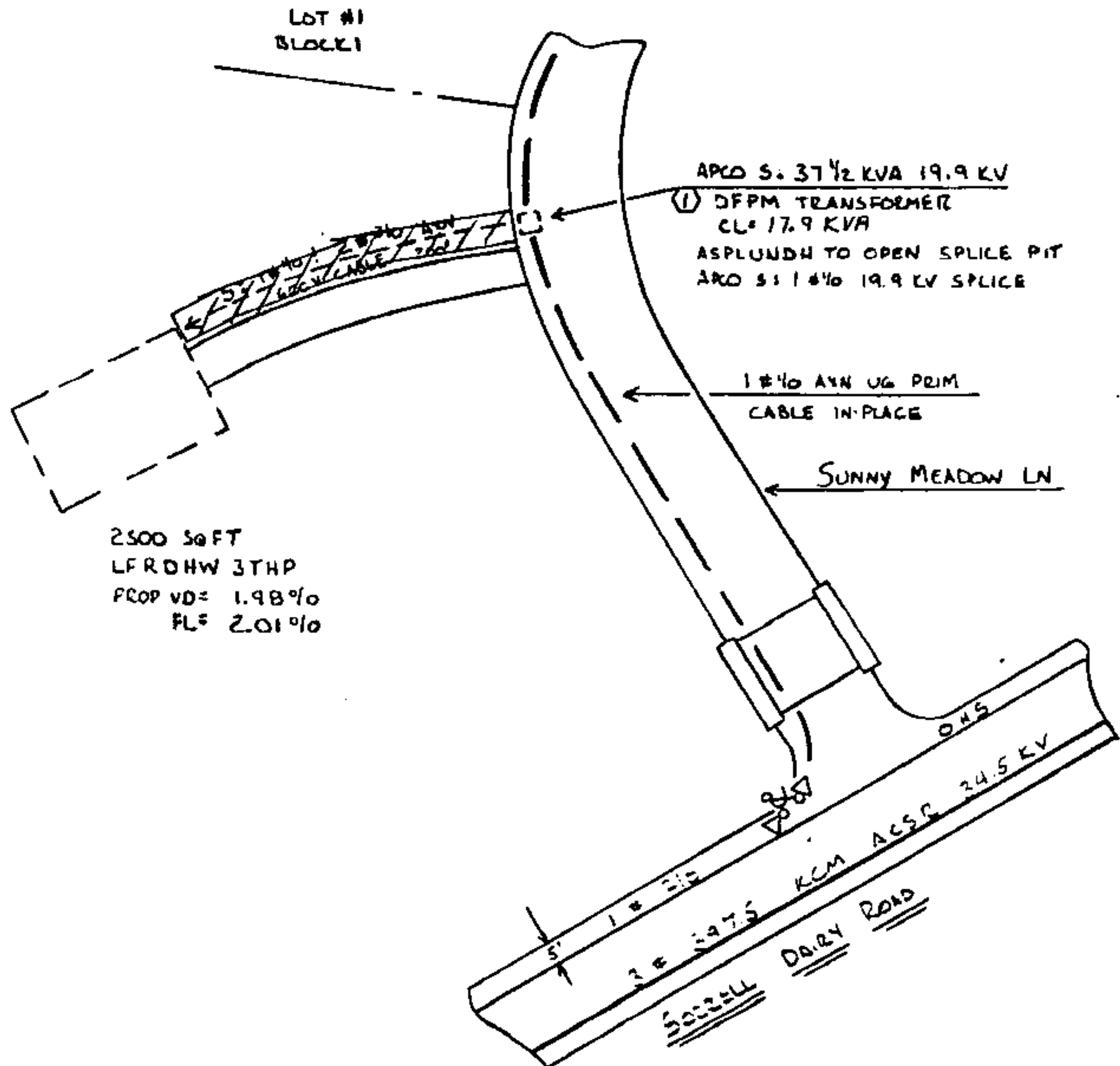

STATE OF ALA. SHELBY CO.
I CERTIFY THIS
INSTRUMENT WAS FILED

1984 JUL 10 PM 1:40

Thomas P. Lawrence, Jr.
JUDGE OF PROBATE

Deed TAX. 50
Rec 7.50
Ind 1.00
9.00

STANDARD SYMBOLS SHOWN IN DISTRIBUTION STANDARDS TO BE USED