

C-0143

Name and  
Post Office Address  
of Grantor DR. W. T. MCGUTCHEN  
801 PRINCETON AVE  
BIRMINGHAM AL 35211  
Toll  
Line (Name)  
Exchange Line COLUMBIA  
tributary to (Exchange)

The property is bounded where the line enters  
and leaves this property by the property of:  
SEE SKETCH BELOW of the  
SEE SKETCH BELOW of the  
The poles (or stakes) have the following  
identification:  
SEE SKETCH BELOW

to SEE SKETCH BELOW  
Authority 39-2203R Classification 91C  
Area North Alabama  
Approved W. T. McGutchen  
Title Operations Manager-Engineering  
NORTH

PROP OF DR  
W. T. MCGUTCHEN

[U.C.]

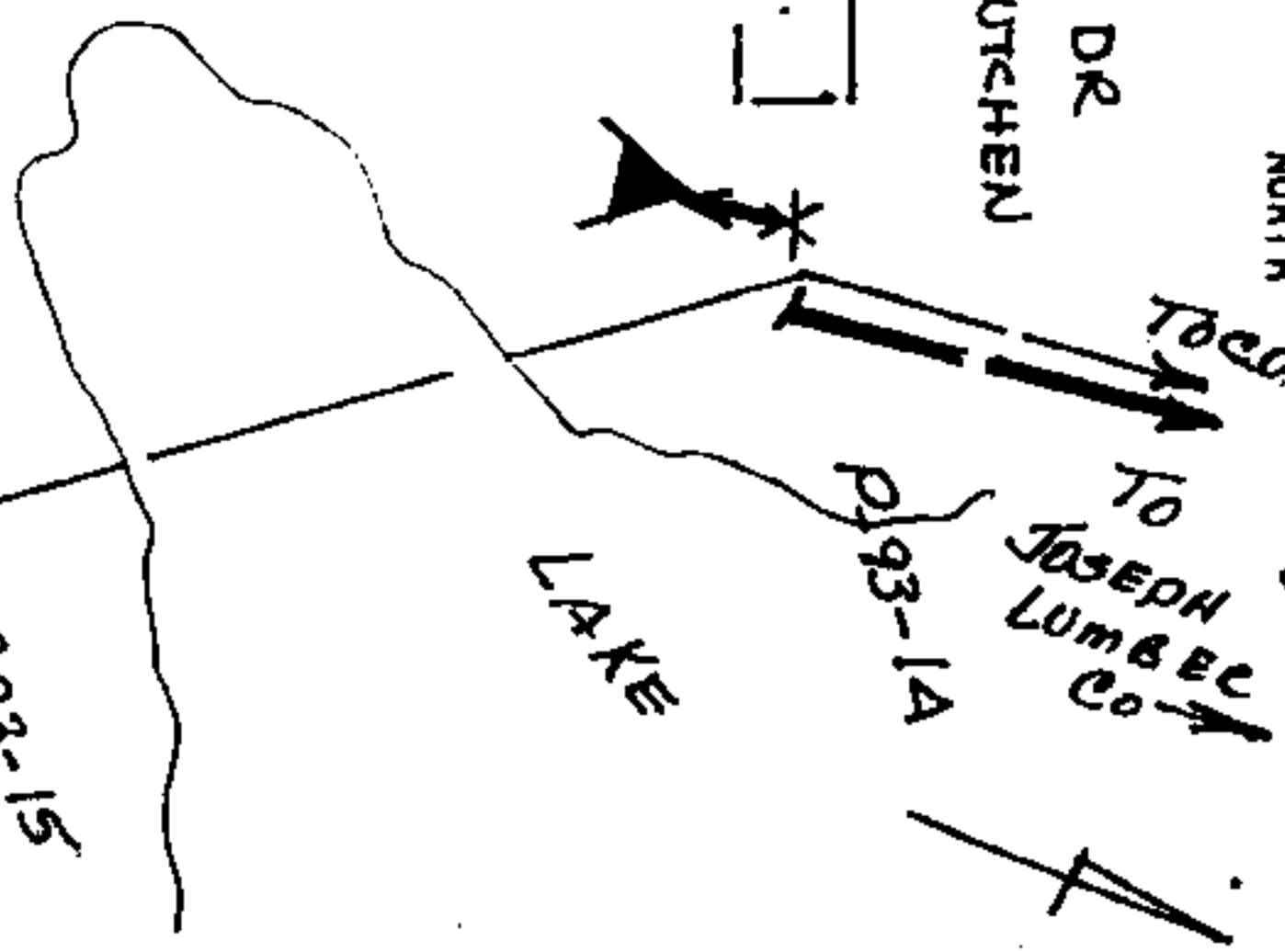

LEGEND  
\* EXISTING APCO POLE

NEW SCB ANCHOR & GUY

EXISTING AERIAL WIRE  
NEW AERIAL WIRE

### RIGHT-OF-WAY EASEMENT

FORM 8416 SC  
MARCH, 1973

In consideration of the sum of money hereinafter set out and other good and valuable consideration, the adequacy and receipt of which is hereby acknowledged from the South Central Bell Telephone Company, the undersigned, owner(s) of the premises described below, do hereby grant to the South Central Bell Telephone Company, its licenses, agents, successors, assigns, and allied and associated companies, a right of way easement to construct, operate, maintain, add or remove such lines or systems of communications or related services as the grantee may require, consisting of:

- (1) poles, guys, anchors, aerial cables and wires;
- (2) Buried cables and wires, cable terminals, markers, splicing boxes and pedestals;
- (3) Conduits, manholes, markers, underground cables and wires;
- (4) and other amplifiers, boxes, appurtenances or devices

upon over and under a strip of land 10 feet wide across the following lands in SHELBY County, State of ALABAMA generally described as follows: ON EXISTING WIRE ROUTE IN SECTION 26 - TOWNSHIP 20 SOUTH - RANGE 1 WEST

and, to the fullest extent the undersigned has the power to grant, if at all, over, along and under the roads, streets, or highways adjoining or through said property.

The following rights are also granted: to allow any other person or company to attach wires or lay cable or conduit within the right of way for communications or electric power transmission or distribution; ingress and egress to said premises at all times; to clear the land and keep it cleared of all trees, undergrowth or other obstructions within the easement area; to trim and cut and keep trimmed and cut all dead, weak, leaning or dangerous trees or limbs outside of the easement area which might interfere with or fall upon the lines or systems of communications or power transmission or distribution.

The receipt of ONE and NO /100 Dollars (\$1.00) is hereby acknowledged by the undersigned.

To have and to hold the above granted easement unto South Central Bell Telephone Company, its successors and assigns forever.

IN WITNESS WHEREOF, the undersigned has signed and sealed this document on 2-10-84 1984 caused this instrument to be executed by its duly authorized agent

Signed, sealed and delivered in the presence of:  
William C. Rasmussen, Jr., M.D.  
Robert Hunt D. Clark

Attest: Yvonne Foster  
Corporate Officer

W. T. McGutchen L.S.  
L.S.

STATE OF ALA. SHELBY CO.  
Name of Corporation  
INSTRUMENT WAS FILED  
By: Reed TAX. 50  
Recd 1.50  
Ind 1.00  
3.00

1984 JUN 12 AM 8:33

Thomas J. Henderson, Jr.  
JUDGE OF PROBATE

BOOK 356 PAGE 397