

STATE OF Alabama)

135

COUNTY OF Shelby)

WE # 1700-08-00025-4-20

456266

KNOW ALL MEN BY THESE PRESENTS, that the undersigned,

THE Harbert-Equitable Joint Venture

for and in consideration of the sum of One and No/100 Dollars (\$1.00), to

it in hand paid by Alabama Power Company, a corporation, the receipt

whereof is acknowledged, does hereby grant to said Alabama Power Company,

its successors and assigns, the right to construct, install, operate and maintain,

and the right to permit other corporations and persons to construct, install,

operate and maintain, along a route to be selected by the grantees, (generally shown

crosshatched on the attached drawing) its successors and assigns, all conduits,

cables, translosures and other appliances and facilities useful or necessary in

connection therewith, for the underground transmission and distribution of electric

power and for underground communication service, upon, under and across the following

described land situated in Shelby County, Alabama:

W RIVERCHASE Country Club 15¹/₂ Addition AS RECORDED
IN MAP BOOK 8, PAGE 168, IN THE OFFICE OF THE
JUDGE OF PROBATE, Shelby County, ALABAMA.

GRANTEE'S ADDRESS
ALABAMA POWER CO.
P. O. BOX 2641
BIRMINGHAM, AL 35281
ATT: CORP. REAL ESTATE

Donald E. Gibson

This instrument prepared in
the Corporate Real Estate
Dept. of Alabama Power Co.
Birmingham, Ala.

By R.C. Coggin

Together with all the rights and privileges necessary or convenient for the full enjoyment or use thereof, including the right of ingress and egress to and from said facilities and the right to excavate for installation, replacement, repair, and removal thereof; and also the right to cut and keep clear all trees, underbrush, shrubbery, roots and other growth, and to keep clear any and all obstructions or obstacles of whatever character on, under or above said facilities.

TO HAVE AND TO HOLD the same to the said Alabama Power Company, its successors and assigns, forever.

IN WITNESS WHEREOF, the said HARBERT-EQUITABLE JOINT VENTURE has caused this instrument to be executed in its name by W. H. ROSSMAN as its VICE PRESIDENT, and attested by

its _____, and its corporate seal to be hereto affixed, on this the 2nd day of FEBRUARY, 1982

Attest:

THE HARBERT-EQUITABLE JOINT VENTURE

By W. H. ROSSMAN
ITS VICE PRESIDENT

STATE OF Alabama
COUNTY OF Shelby

I, Cynthia A. Aldridge, a Notary Public, in and for said County in said State, hereby certify that W. H. ROSSMAN

whose name as Vice President of HARBERT INTERNATIONAL INC., a corporation, is signed to the foregoing instrument, and who is known to me, acknowledged before me on this day that, being informed of the contents of this instrument, he as such officer and with full authority executed the same voluntarily for and as the act of said corporation.

Given under my hand and official seal, this the 2nd day of FEBRUARY, 1982

Cynthia A. Aldridge
Notary Public

MY COMM. EXPIRES _____

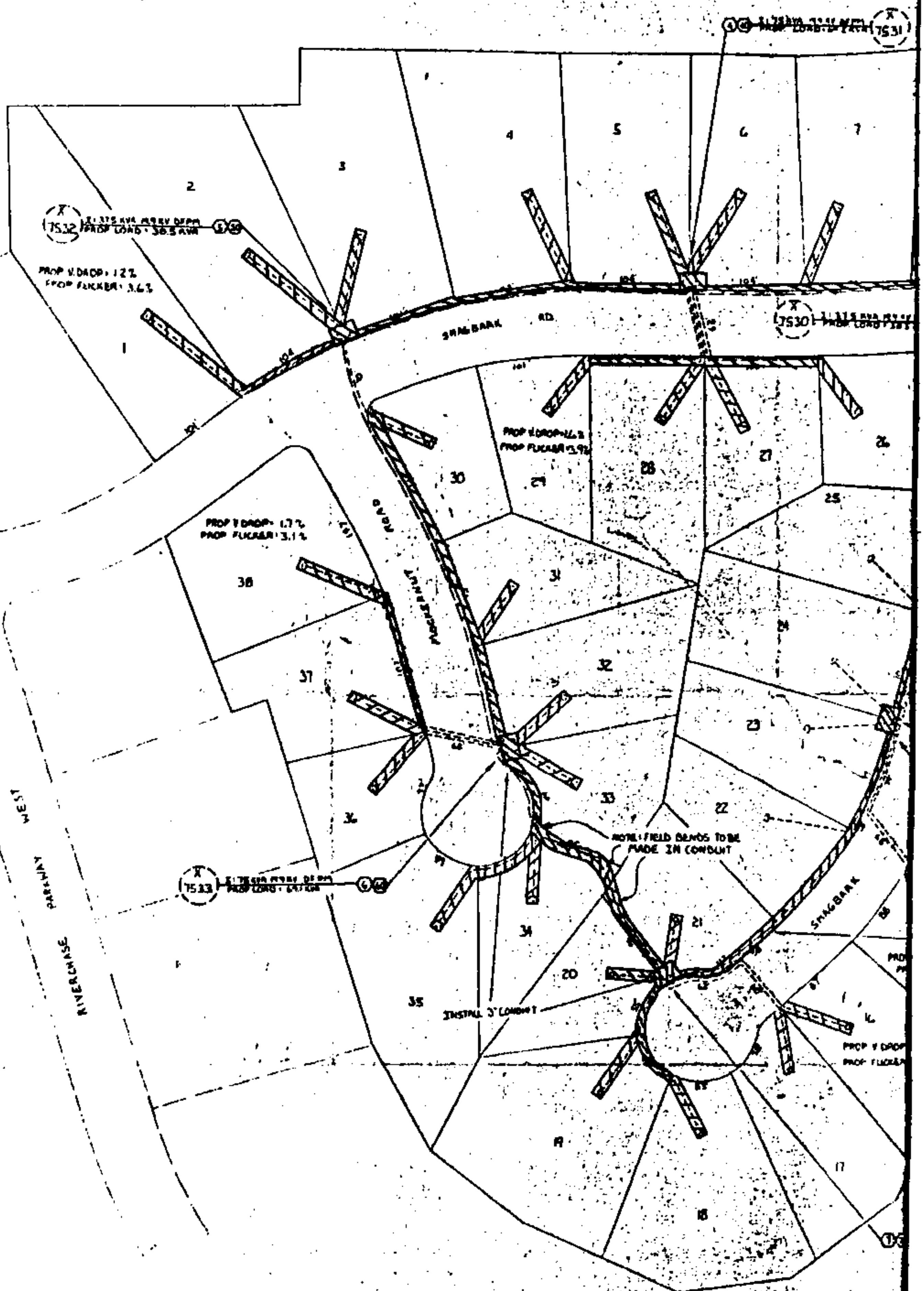

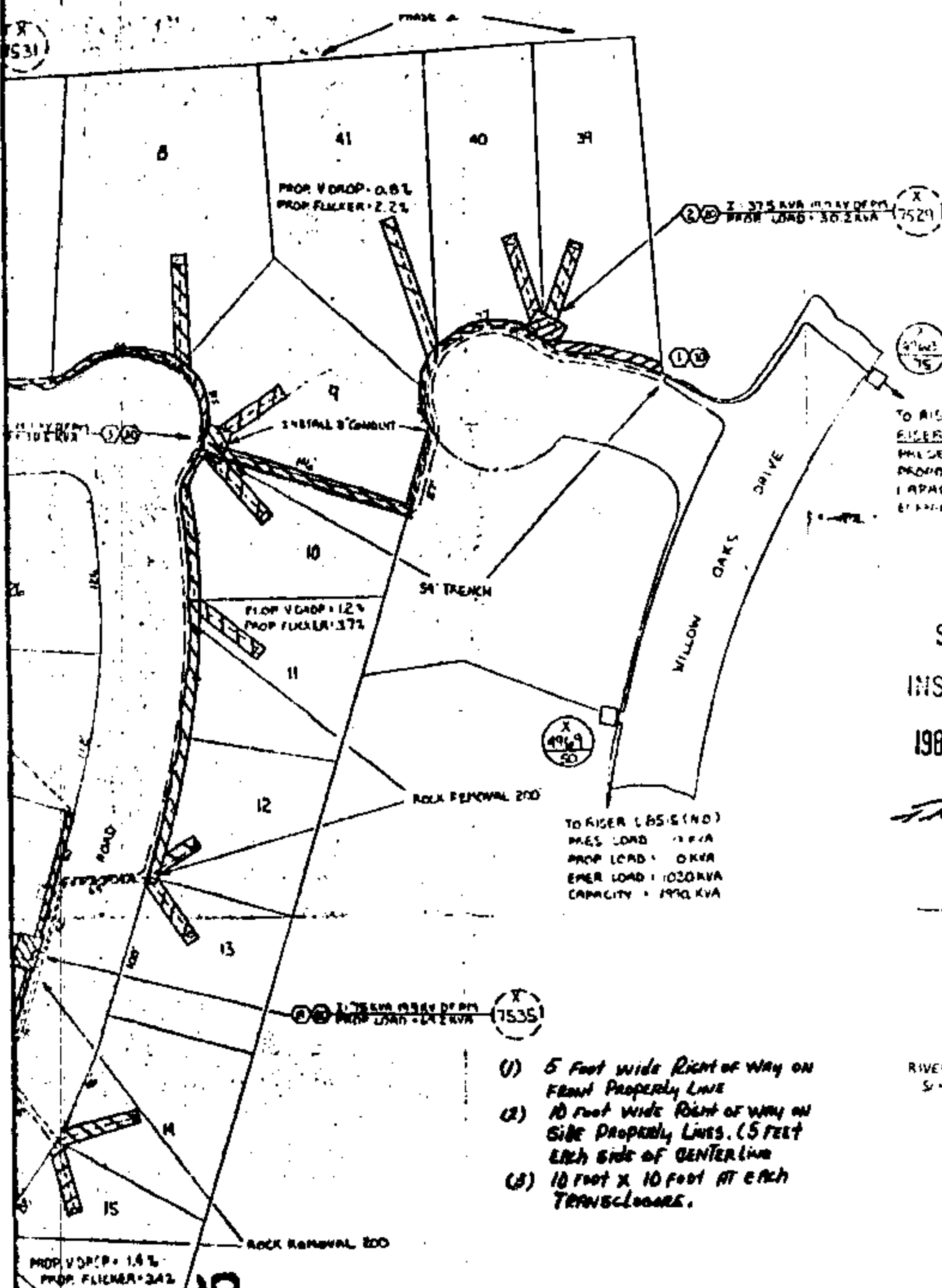

STATE OF ALA. SHELBY CO.
I CERTIFY THIS
INSTRUMENT WAS FILED
1984 JUN -4 PM 12:09

Deed tax \$0
Reg. 6.00
Ind. 1.00
7.50

Thomas P. Lawrence
JUDGE OF PROBATE

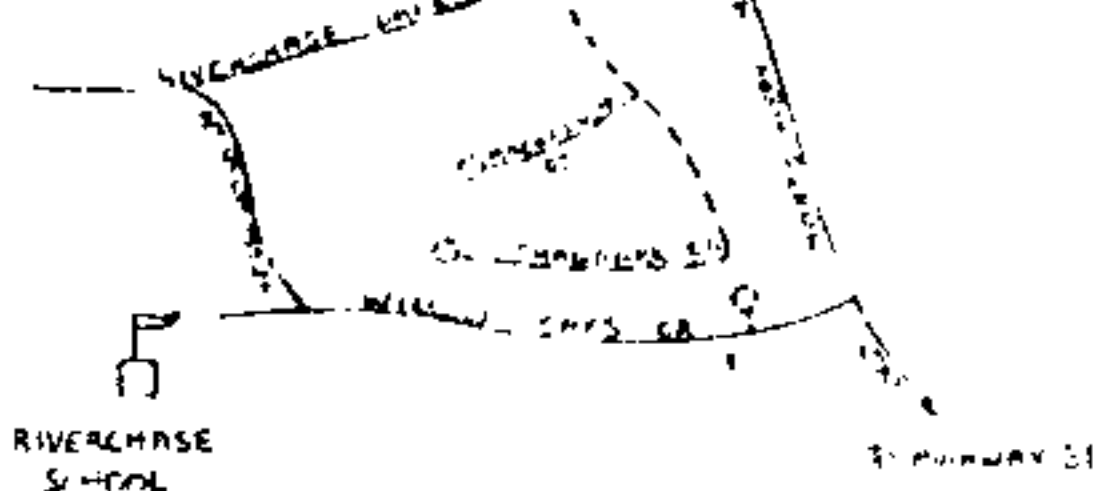

- (1) 5 foot wide Right of Way on Front Property Line
- (2) 10 foot wide Right of Way on Side Property Lines (5 feet each side of centerline)
- (3) 10 foot x 10 foot at each Transclosure.

NOTES:
1. ALL PRIMARY TO BE 1410 AMN 35 KV CABLE.
2. ALL SECONDARY AND SERVICES TO BE 1410 E 20 310 AL REP 60KV CABLE
3. AVERAGE SERVICE LENGTH = 70 FT
4. TRANSFORMER LOADING BASED ON LAD 474K.
5. RISER LOADING BASED ON 10 KVA PER LOT
6. AS PLUMBER TO PERFORM ALL TRENCHING, INSTALL TRANSFORMER PADS, GROUND RODS, PRIMARY SECONDARY AND SERVICE CONDUITORS.
7. ALL PRIMARY CABLE TO BE INSTALLED IN 48" TRENCH EXCEPT WHERE NOTED.
8. ALL SECONDARY AND SERVICES TO BE IN 36" TRENCH
9. 2" PVC CONDUIT TO BE INSTALLED FOR ALL SECONDARY ROAD CROSSINGS AND UNDER DRIVEWAYS.
10. 3" PVC CONDUIT TO BE INSTALLED FOR PRIMARY ROAD CROSSINGS AND ALONG LOT LINES.
11. 200A UG FAULT INDICATORS TO BE INSTALLED IN ALL TRANSFORMER

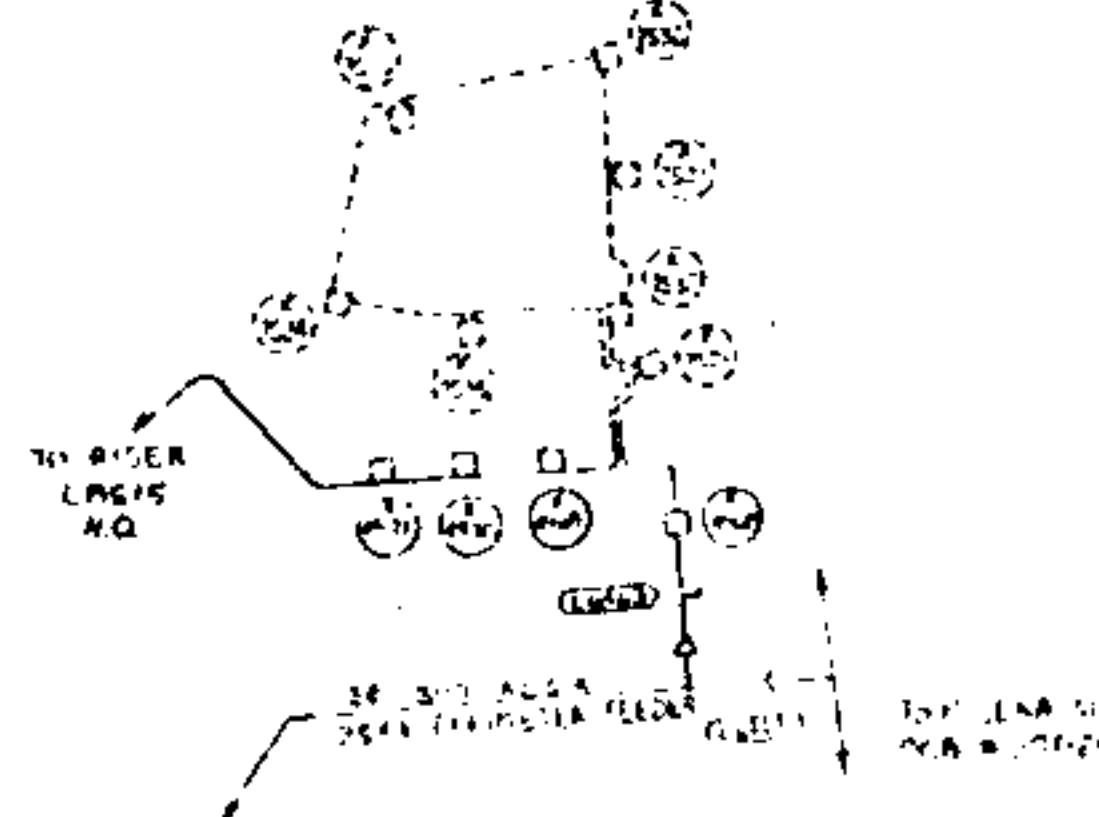

ALABAMA POWER COMPANY	
JOB NO. 100-1514-97	DATE 1-6-84
DETAILS 100-1514-97	DATE 4-9-84
SCALE 1" = 100'	SHEET 1 OF 1
SUPERSEDES C-1118-100-1514-97	

BOOK 356 PAGE 45

DRAWN: [Signature] CHECKED: [Signature] TRACED: [Signature]
APPROVED: [Signature] DATE 1-6-84
APPROVED: [Signature] DATE 4-9-84