

FORM 8416 SC
OCTOBER, 1976

444

RIGHT OF WAY EASEMENT

For and in consideration of ONE DOLLAR (\$1.00) and other good and valuable consideration, the receipt of all of which is hereby acknowledged, the undersigned do (does) hereby grant to South Central Bell Telephone Company, its licensees, successors, assigns, allied and associated companies, a right of way easement to construct, operate, maintain, add or remove such lines or systems of communications or related services as the grantee may require, from time to time, consisting of poles, guys, anchors, aerial, buried and underground cables and wires, cable terminals, splicing boxes, pedestals, conduit, manholes, markers, and other amplifiers, boxes, appurtenances or devices upon, over and under a strip of land 30 feet wide across the following lands in SHELBY County (Parish) State of ALABAMA described as follows: WITHIN THE S.E. 1/4 OF SECTION 21, T.5. 19 S., R. 2 E. ALSO SEE SKETCH.

and to the fullest extent the undersigned has the power to grant, if at all, along and under the roads, streets or highways adjoining or through said property.

The following rights are also granted: to allow any other person, firm or corporation to attach wires or lay cable or conduit or other appurtenances upon, over and under said easement for communications or electric power transmission distribution; ingress and egress to said easement at all times; to clear the easement and keep it cleared of all trees, undergrowth or other obstructions; to trim and cut and keep trimmed and cut all dead, weak, leaning or dangerous trees or limbs outside of the easement which might interfere with or fall upon the lines or systems of communications or power transmission or distribution; and the right to relocate said facilities on said lands to conform to any future highway relocation, widening or improvements.

To have and to hold the above granted easement unto South Central Bell Telephone Company, its successors and assigns forever.

In witness whereof, the undersigned has caused this instrument to be executed on the 9th day of NOVEMBER 1983

WITNESS J. H. Colhoun

James Q. Richey L.S.
(James Q. Richey)

L.S.

Name of Corporation

ATTEST: _____

By: _____
Title _____SCBT USE ONLY: AUTHORITY 334-4522B; CLASSIFICATION 91C;AREA NORTH ALABAMA; APPROVED R. H. Langston; TITLE Operas Mgr.-Eng.

(VINCENT)

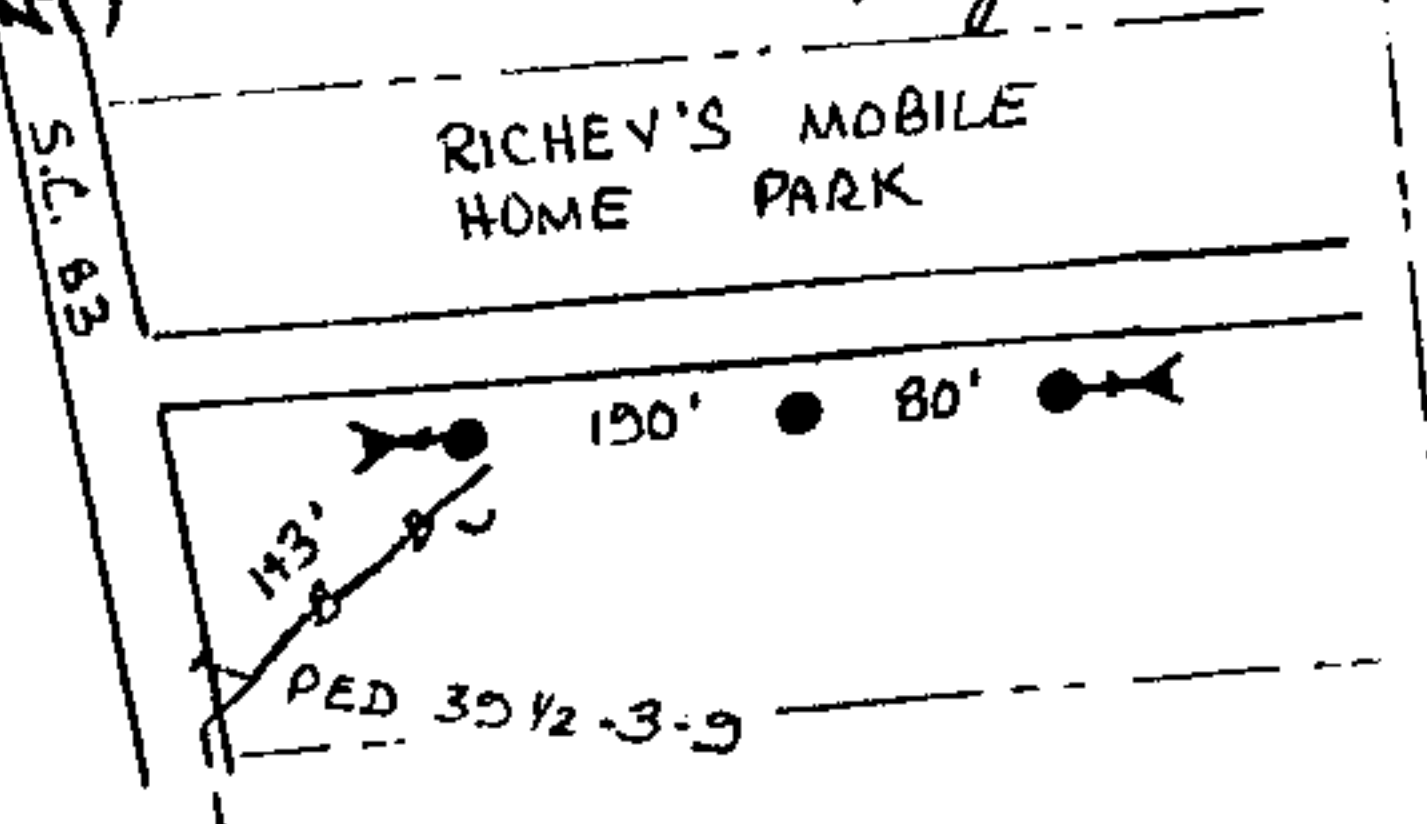

P - G Volts

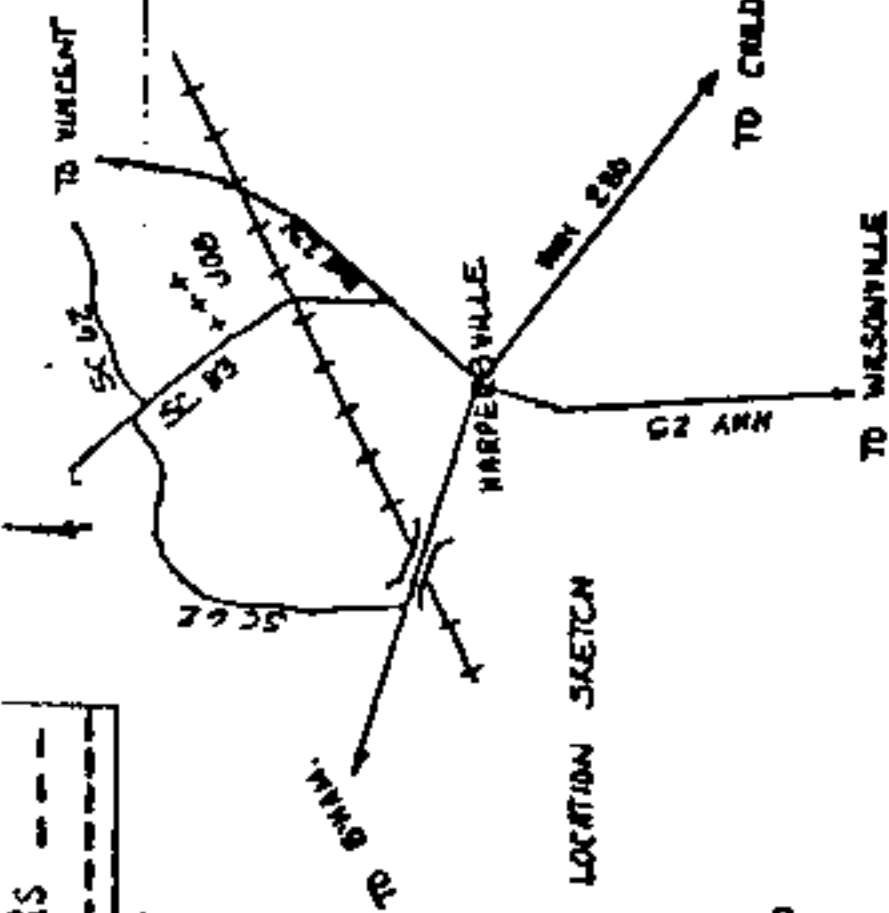

SAFETY IS NO ACCIDENT

PRIORITY KUS-4

BOOK 353 PAGE 793

RICHEY'S
MOBILE HOME PARK

ORDER EXPEDITED BY
12-8-83

APCD REG.
SCB TO R. 40'S POLE
AND 1-3/4" J.U. ANC.
SCB TO BULL APCD 41.00
PER LINE 58A

F-Lot 2 WILL SERVE LOTS 12, 13, 14
F-Lot 6 WILL SERVE LOTS 6, 7, 8, 9, 10
F-Lot 10 WILL SERVE LOTS 1, 2, 3, 4, 5, 6, 7, 8, 9, 10

TABLE MAKE UP FROM C.O.

CA	BY	DATE	TIME
1	1	1	1
2	2	2	2
3	3	3	3
4	4	4	4
5	5	5	5
6	6	6	6
7	7	7	7
8	8	8	8
9	9	9	9
10	10	10	10

JOB NOT STARTED
CONTACT ENGINEER
3 DAYS PRIOR TO
CONSTRUCTION PER 14

COPY TO

NAME	DATE	TIME
1	1	1
2	2	2
3	3	3
4	4	4
5	5	5
6	6	6
7	7	7
8	8	8
9	9	9
10	10	10

TABLE MAKE UP FROM C.O.

CA	BY	DATE	TIME
1	1	1	1
2	2	2	2
3	3	3	3
4	4	4	4
5	5	5	5
6	6	6	6
7	7	7	7
8	8	8	8
9	9	9	9
10	10	10	10

APCD REG.
SCB TO R. 40'S POLE
AND 1-3/4" NON J.U. ANC.
APCD TO BULL SCB 41.00
PER LINE 58A

CAUTION - FIELD LINES
SENSE
CLEAN OFF
PILES

APCD REG.
SCB TO R. 40'S POLE
AND 1-3/4" NON J.U. ANC.
APCD TO BULL SCB 41.00
PER LINE 58A

CAUTION - FIELD LINES
SENSE
CLEAN OFF
PILES

APCD REG.
SCB TO R. 40'S POLE
AND 1-3/4" NON J.U. ANC.
APCD TO BULL SCB 41.00
PER LINE 58A

CAUTION - FIELD LINES
SENSE
CLEAN OFF
PILES

APCD REG.
SCB TO R. 40'S POLE
AND 1-3/4" NON J.U. ANC.
APCD TO BULL SCB 41.00
PER LINE 58A

CAUTION - FIELD LINES
SENSE
CLEAN OFF
PILES

APCD REG.
SCB TO R. 40'S POLE
AND 1-3/4" NON J.U. ANC.
APCD TO BULL SCB 41.00
PER LINE 58A

CAUTION - FIELD LINES
SENSE
CLEAN OFF
PILES

APCD REG.
SCB TO R. 40'S POLE
AND 1-3/4" NON J.U. ANC.
APCD TO BULL SCB 41.00
PER LINE 58A

CAUTION - FIELD LINES
SENSE
CLEAN OFF
PILES

APCD REG.
SCB TO R. 40'S POLE
AND 1-3/4" NON J.U. ANC.
APCD TO BULL SCB 41.00
PER LINE 58A

CAUTION - FIELD LINES
SENSE
CLEAN OFF
PILES

APCD REG.
SCB TO R. 40'S POLE
AND 1-3/4" NON J.U. ANC.
APCD TO BULL SCB 41.00
PER LINE 58A

CAUTION - FIELD LINES
SENSE
CLEAN OFF
PILES

APCD REG.
SCB TO R. 40'S POLE
AND 1-3/4" NON J.U. ANC.
APCD TO BULL SCB 41.00
PER LINE 58A

CAUTION - FIELD LINES
SENSE
CLEAN OFF
PILES

STATE OF ALA. SHELBY CO.
I HEREBY CERTIFY THIS
DEED WAS FILED
-9 AM 8:06
JUDGE OF PROBATE

Deed TAX. 50
Rec 3.00
Ind 1.00
4.50