

C 0154

Name and Post Office Address  
of Grantor WILLIAM E. & CYNTHIA M. CARLISLE  
RT 2 Box 1220  
COLUMBIA, AL 35057

Toll Line (Name)  
or Exchange Line COLUMBIA  
Tributary to (Exchange)

The property is bounded where the line enters and leaves this property by the property of:  
SEE SKETCH BELOW of the  
SEE SKETCH BELOW of the  
The poles (or stakes) have the following identification:  
SEE SKETCH BELOW  
to SEE SKETCH BELOW  
Authority BB-22418 classification 91C  
Area Hydramon  
Approved Operations Manager-OSPE  
Title NORTH

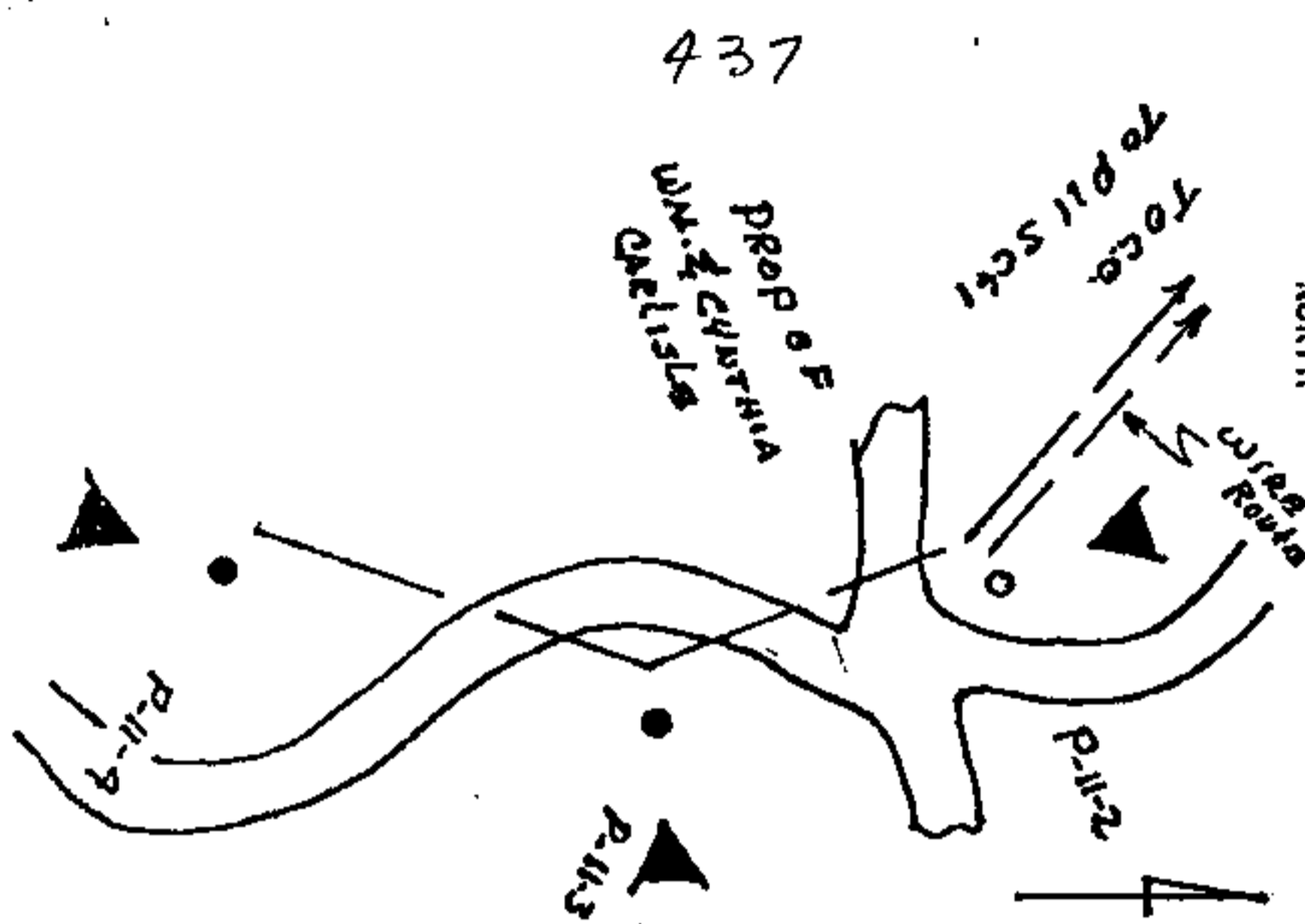

### RIGHT-OF-WAY EASEMENT

FORM 8416 SC  
MARCH, 1973

In consideration of the sum of money hereinafter set out and other good and valuable consideration, the adequacy and receipt of which is hereby acknowledged from the South Central Bell Telephone Company, the undersigned, owner(s) of the premises described below, do hereby grant to the South Central Bell Telephone Company, its licenses, agents, successors, assigns, and allied and associated companies, a right of way easement to construct, operate, maintain, add or remove such lines or systems of communications or related services as the grantee may require, consisting of:

- (1) poles, guys, anchors, aerial cables and wires;
- (2) buried cables and wires, cable terminals, markers, splicing boxes and pedestals;
- (3) Conduits, manholes, markers, underground cables and wires;
- (4) and other amplifiers, boxes, appurtenances or devices

upon over and under a strip of land 30 feet wide across the following lands in SHELBY County, State of ALABAMA generally described as follows: A TRACT OF LAND

ON SHELBY COUNTY HIGHWAY 61 FN SECTION 7 - TOWNSHIP 22 SOUTH - RANGE 1 E

and, to the fullest extent the undersigned has the power to grant, if at all, over, along and under the roads, streets, or highways adjoining or through said property.

The following rights are also granted: to allow any other person or company to attach wires or lay cable or conduit within the right of way for communications or electric power transmission or distribution; ingress and egress to said premises at all times; to clear the land and keep it cleared of all trees, undergrowth or other obstructions within the easement area; to trim and cut and keep trimmed and cut all dead, weak, leaning or dangerous trees or limbs outside of the easement area which might interfere with or fall upon the lines or systems of communications or power transmission or distribution.

The receipt of FIVE and No /100 Dollars (\$5.00) is hereby acknowledged by the undersigned.

To have and to hold the above granted easement unto South Central Bell Telephone Company, its successors and assigns forever.

IN WITNESS WHEREOF, the undersigned has signed and sealed this document on October 12, 1983 caused this instrument to be executed by its duly authorized agent

Signed, sealed and delivered in the presence of:

Witness  
Thomas J. Carlisle

Attest: Agnes Carlisle  
Corporate Officer

William E. Carlisle L.S.  
Cynthia M. Carlisle L.S.  
Name of Corporation

By: \_\_\_\_\_  
Title: \_\_\_\_\_

BOOK 353 PAGE 778

**CAUTION:**  
LOCATE ALL HIDDEN  
WIRING BEFORE  
DRILLING.

**CAUTION!**  
 RISK FOR CORROSIVE  
 DAMAGE TO SKIN

RECORDS NOTE:  
 1111 CA DOES NOT EXIST  
 IN CURRENTLY ANY  
 REFERENCES TO IT IN  
 THE PLATS SHOULD BE  
 CHANGED TO 502 CORAL.

STATE OF ALA. SHELBY CO.  
I CERTIFY THIS  
DOCUMENT WAS FILED

1984 MAR -9 AM 8:06

*Thomas A. Swenson, Jr.*  
JUDGE OF PROBATE

Deed TAX. 50  
 Rec 3.00  
 Ind 1.00  
4.50