

Ser # C0174

447

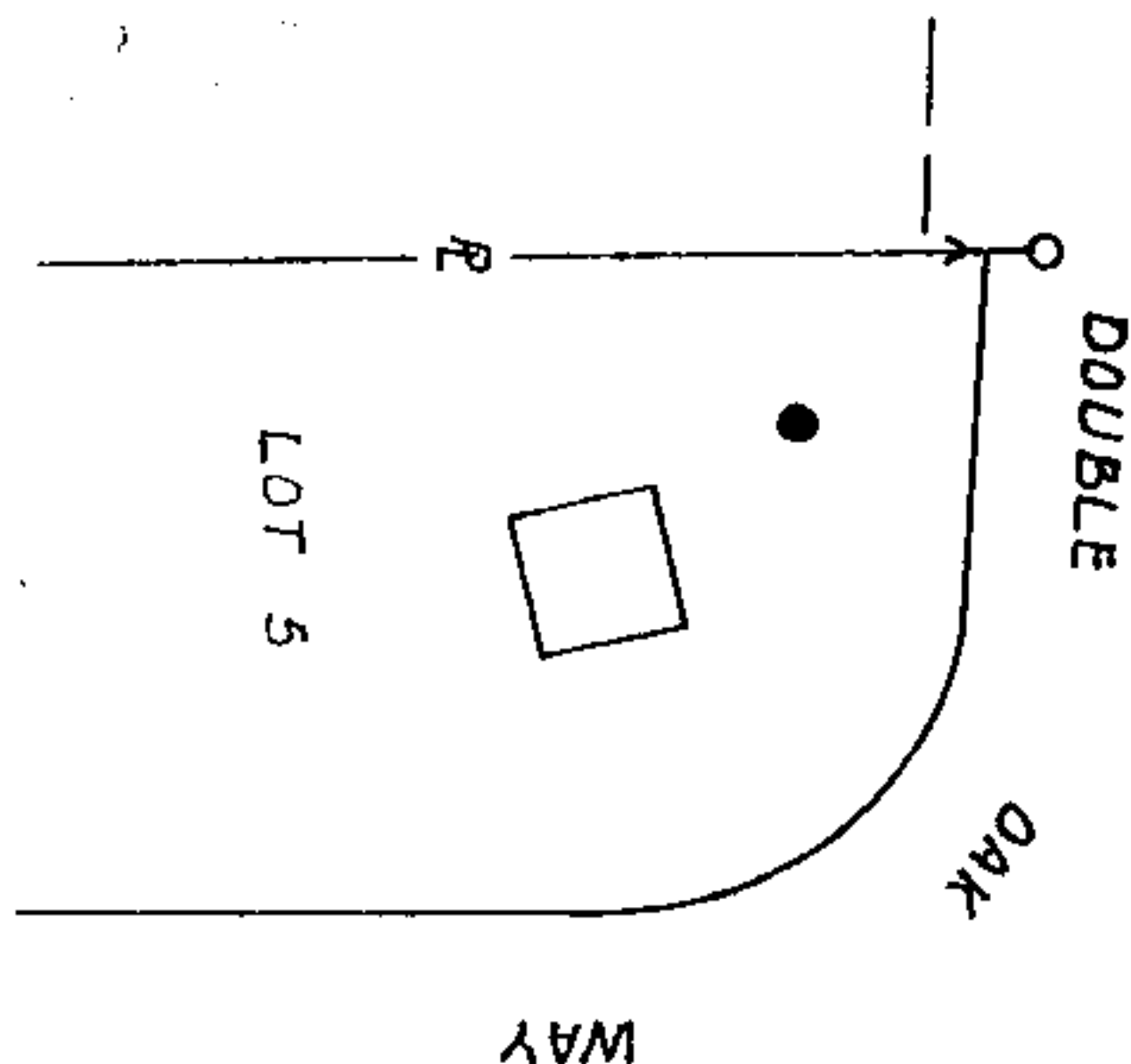

Name and Post Office Address of Grantor John Frommer  
401 E. D. Street Jr.  
Bham, Ala. 35209  
To: \_\_\_\_\_  
Line (Name) \_\_\_\_\_  
or Exchange Line OAK MOUNTAIN W.C.  
tributary to (Exchange) \_\_\_\_\_  
The Property is bounded where the line enters and leaves this property by the property of DOUBLE OAK W.C. the NORTH and \_\_\_\_\_ on the \_\_\_\_\_  
The poles (or stakes) have the following identification: \_\_\_\_\_  
Authorized by \_\_\_\_\_ to \_\_\_\_\_  
Area B' HAM SOUTH CENTRAL ALA  
Approved By [Signature]  
Title OPERATIONS MANAGER  
OSPE

### PERMIT-POLES AND LINES

FORM 8418 SC  
NOV., 1968

In consideration of the benefits to be received and of other good and valuable consideration received from South Central Bell Telephone Company, (I) (We) hereby grant said Company, its associated and allied companies, their respective licensees, successors and assigns, the right to construct, operate and maintain, add or remove lines or systems of communications consisting of such poles, guys, wires, cables, anchors, amplifiers, boxes, and other necessary appurtenances or devices as grantee may require upon, across, over and/or under that certain tract of land situated in SHELBY County, State of ALABAMA, to-wit: POLE AS SHOWN AND STAKED ON LOT 5, DOUBLE OAK ESTATES IN SHELBY COUNTY, ALABAMA.

and, to the fullest extent the undersigned has the power to grant, if at all, upon, along and under the roads, streets or highways adjoining or through said property, with the right to permit the attachment of wires and cables of any other person or company for communication purposes or for the transmission and distribution of electric power, and the right of ingress and egress to said premises at all times for the purpose of inspecting and maintaining said line, and with the right to clear and keep cleared all trees, undergrowth or other obstructions within a strip of land 2 feet on each side of the center of said line, and to trim and cut and keep trimmed and cut, all dead, weak, leaning or dangerous trees which might reach said line in falling, including the right to relocate said line on said premises to conform to any future highway relocation, widening or improvement.

Signed, sealed and delivered  
in the presence of:

Executed Oct. 18, 1983

Witness

Barbara J. Munson

[Signature] Seal

Seal

Attest:

Corporate Officer

Name of Corporation

By:

Title:

(CORPORATE SEAL)

KEY

867 PAGE 333 BOOK

● PROPOSED SCB POLE

○ EXISTING SCB

Y POLE AND ANCHOR

