

Name and

Post Office Address

of Grantor TOMMY STAGNERPO BOX 149WILSONVILLE, AL 35166Toll Line (Name) COLUMBIAor Exchange Line (Exchange)

tributary to

The property is bounded where the line enters and leaves this property by the property of:

SEE SKETCH BELOW of the
The poles (or stakes) have the following identification:

SEE SKETCH BELOW

to SEE SKETCH BELOW

Authority 334-3033 (A) Classification 916

Area

Approved

Title OPERATIONS MGR. JOSPE

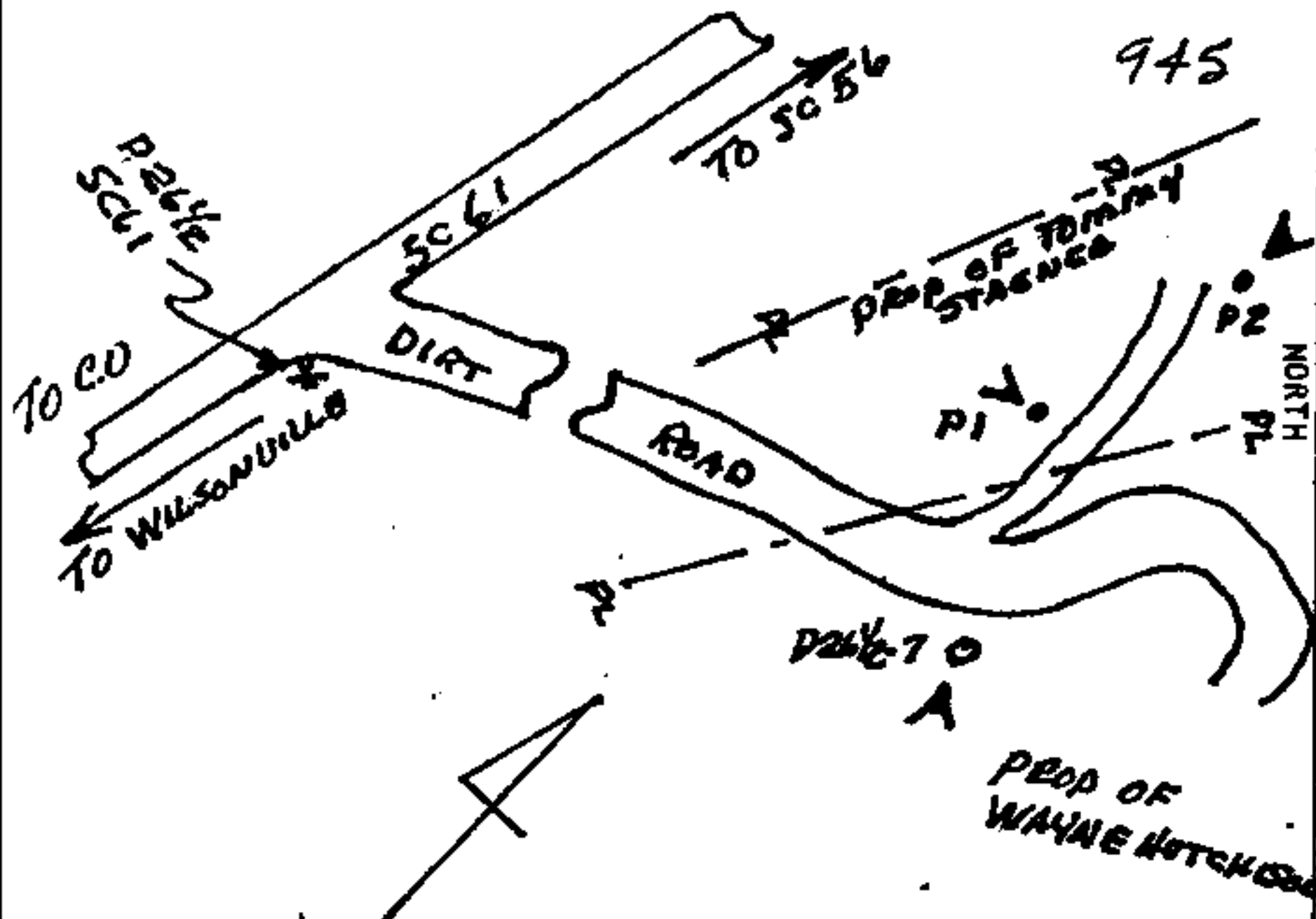

RIGHT-OF-WAY EASEMENT

FORM 8416 SC
MARCH, 1973

In consideration of the sum of money hereinafter set out and other good and valuable consideration, the adequacy and receipt of which is hereby acknowledged from the South Central Bell Telephone Company, the undersigned, owner(s) of the premises described below, do hereby grant to the South Central Bell Telephone Company, its licenses, agents, successors, assigns, and allied and associated companies, a right of way easement to construct, operate, maintain, add or remove such lines or systems of communications or related services as the grantee may require, consisting of:

- (1) poles, guys, anchors, aerial cables and wires;
- (2) buried cables and wires, cable terminals, markers, splicing boxes and pedestals;
- (3) conduits, manholes, markers, underground cables and wires;
- (4) and other amplifiers, boxes, appurtenances or devices

upon over and under a strip of land 30 feet wide across the following lands in SHELBY County, State of ALABAMA generally described as follows: A TRACT OF LAND ON

DIRT ROAD OFF SHELBY COUNTY HIGHWAY 61 IN SECTION 25-
TOWNSHIP 20 SOUTH-RANGE 1 EAST.

and, to the fullest extent the undersigned has the power to grant, if at all, over, along and under the roads, streets, or highways adjoining or through said property.

The following rights are also granted: to allow any other person or company to attach wires or lay cable or conduit within the right of way for communications or electric power transmission or distribution; ingress and egress to said premises at all times; to clear the land and keep it cleared of all trees, undergrowth or other obstructions within the easement area; to trim and cut and keep trimmed and cut all dead, weak, leaning or dangerous trees or limbs outside of the easement area which might interfere with or fall upon the lines or systems of communications or power transmission or distribution.

The receipt of FIVE and No /100 Dollars (\$50) is hereby acknowledged by the undersigned.

To have and to hold the above granted easement unto South Central Bell Telephone Company, its successors and assigns forever.

IN WITNESS WHEREOF, the undersigned has signed and sealed this document on 5-23, 1983, caused this instrument to be executed by its duly authorized agent

Signed, sealed and delivered in the presence of:

Bessie S. Tagner L.S.

Witness

John William L.S.

Name of Corporation

Attest

1983 JUN 20 PM 1:55

Corporate Officer

Title:

ENGINEERING DEPARTMENT
SOUTH CENTRAL BELL TEL. CO.
200 EASTERN AVENUE
SYLACAUGA, ALABAMA 35150

Thomas A. Stagner, Jr.
LOCAL OFF. PUBLIC

Deed TAX. \$0
Rec. 1:00
Jrd 3:00