

850

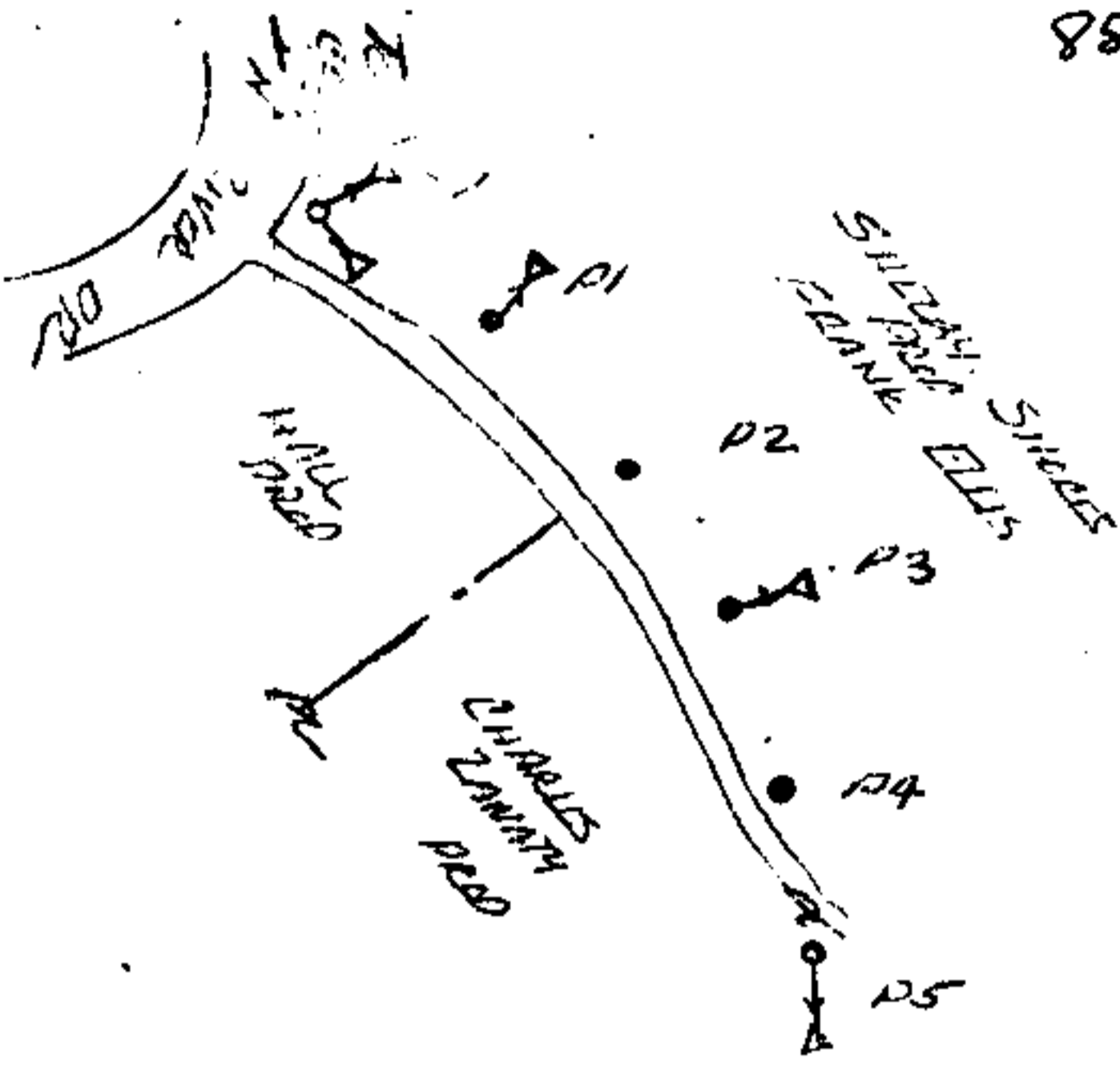

Name and Office Address  
of Frank Ellis  
P.O. Box  
Cibola, N.M.  
Tel. (Name)  
Change line Columbia  
Tributary to (Exchange)  
The property is bounded where the line enters and leaves this property by the property of:  
Sketch below of the  
Sketch below of the  
The poles (or stakes) have the following identification:  
Sketch below  
to be Sketch below  
Authority 254-30428 classification 9-1C  
Area  
Approved  
Title OPERATION MGR.-OSPE  
NORTH

RIGHT-OF-WAY EASEMENT

In consideration of the sum of money hereinafter set out and other good and valuable consideration, the adequacy and receipt of which is hereby acknowledged from the South Central Bell Telephone Company, the undersigned, owner(s) of the premises described below, do hereby grant to the South Central Bell Telephone Company, its licenses, agents, successors, assigns, and allied and associated companies, a right of way easement to construct, operate, maintain, add or remove such lines or systems of communications or related services as the grantee may require, consisting of:

- (1) poles, guys, anchors, aerial cables and wires;
- (2) Buried cables and wires, cable terminals, markers, splicing boxes and pedestals;
- (3) Conduits, manholes, markers, underground cables and wires;
- (4) and other amplifiers, boxes, appurtenances or devices

upon over and under a strip of land \_\_\_\_\_ feet wide across the following lands in Shelby County, State of Ala. generally described as follows: Sec. 12, T-22S, R-1E

and, to the fullest extent the undersigned has the power to grant, if at all, over, along and under the roads, streets, or highways adjoining or through said property.

The following rights are also granted: to allow any other person or company to attach wires or lay cable or conduit within the right of way for communications or electric power transmission or distribution; ingress and egress to said premises at all times; to clear the land and keep it cleared of all trees, undergrowth or other obstructions within the easement area; to trim and cut and keep trimmed and cut all dead, weak, leaning or dangerous trees or limbs outside of the easement area which might interfere with or fall upon the lines or systems of communications or power transmission or distribution.

The receipt of ONE and 100 /100 Dollars (\$100) is hereby acknowledged by the undersigned.

To have and to hold the above granted easement unto South Central Bell Telephone Company, its successors and assigns forever.

IN WITNESS WHEREOF, the undersigned has signed and sealed this document on 5-19, 1982 caused this instrument to be executed by its duly authorized agent

Signed, sealed and delivered in the presence of: Frank Ellis L.S.

Witness Mr. J. Arnold L.S.

Attest: 1982 SEP 23 AM 9:26 Name of Corporation

ENGINEERING DEPARTMENT  
SOUTH CENTRAL BELL TEL. CO.  
200 EASTERN AVENUE  
SYLACAUGA, ALABAMA 35150

Judge of Probate

Title: Recd TAX. 50  
Rec 1.50  
Ind 1.00  
3.00