

1186

SEE ATTACHED SKETCH

Name and Post Office Address of Grantor JOHN C. HURST  
500 EUGENIE AVE  
BIRMINGHAM, ALABAMA

Toll Line \_\_\_\_\_ (Name) \_\_\_\_\_  
 or  
 Exchange Line CAHABA HEIGHTS  
 tributary to \_\_\_\_\_ (Exchange)

The property is bounded where the line enters and leaves this property by the property of:  
~~East~~ West of the ~~North~~ East  
~~East~~ West of the ~~East~~ West

The poles (or stakes) have the following identification:  
 \_\_\_\_\_  
 \_\_\_\_\_  
 \_\_\_\_\_

to \_\_\_\_\_  
 Authority 134-8060 B classification 91C  
 Area BIRMINGHAM - SOUTH

Approved \_\_\_\_\_  
 Title OPNS MANAGER - OSP ENGINEERING  
NORTH

### RIGHT-OF-WAY EASEMENT

FORM 8416 SC  
MARCH, 1973

In consideration of the sum of money hereinafter set out and other good and valuable consideration, the adequacy and receipt of which is hereby acknowledged from the South Central Bell Telephone Company, the undersigned, owner(s) of the premises described below, do hereby grant to the South Central Bell Telephone Company, its licenses, agents, successors, assigns, and allied and associated companies, a right of way easement to construct, operate, maintain, add or remove such lines or systems of communications or related services as the grantee may require, consisting of:

- (1) poles, guys, anchors, aerial cables and wires;
- (2) ~~Buried cables and wires, cable terminals, markers, splicing boxes and pedestals;~~
- (3) ~~Conduits, manholes, markers, underground cables and wires;~~
- (4) ~~and other amplifiers, boxes, appurtenances or devices~~

upon over and under a strip of land 30 feet wide across the following lands in SHELBY & JEFFERSON County, State of ALABAMA generally described as follows: LOCATED IN THE

SW 1/4 OF THE NE 1/4 OF SECTION 25, TOWNSHIP 18 S, RANGE 2 W,

and, to the fullest extent the undersigned has the power to grant, if at all, over, along and under the roads, streets, or highways adjoining or through said property.

The following rights are also granted: to allow any other person or company to attach wires or lay cable or conduit within the right of way for communications or electric power transmission or distribution; ingress and egress to said premises at all times; to clear the land and keep it cleared of all trees, undergrowth or other obstructions within the easement area; to trim and cut and keep trimmed and cut all dead, weak, leaning or dangerous trees or limbs outside of the easement area which might interfere with or fall upon the lines or systems of communications or power transmission or distribution.

The receipt of ONE and NO /100 Dollars (\$1.00) is hereby acknowledged by the undersigned.

To have and to hold the above granted easement unto South Central Bell Telephone Company, its successors and assigns forever.

IN WITNESS WHEREOF, the undersigned has signed and sealed this document ~~caused this instrument to be executed by its~~ on DECEMBER 1, 1981. ~~duly authorized agent~~

Signed, sealed and delivered in the presence of:

Witness  
Janet H. Guffey

Attest: \_\_\_\_\_  
 Corporate Officer

\_\_\_\_\_  
 L.S.  
 \_\_\_\_\_  
 L.S.  
 \_\_\_\_\_  
 Name of Corporation  
 By: J. C. Hurst 12-1-81  
 Title: PROPERTY OWNER

BOOK 330 PAGE 939

CAUTION Joint Use  
P-G Volts

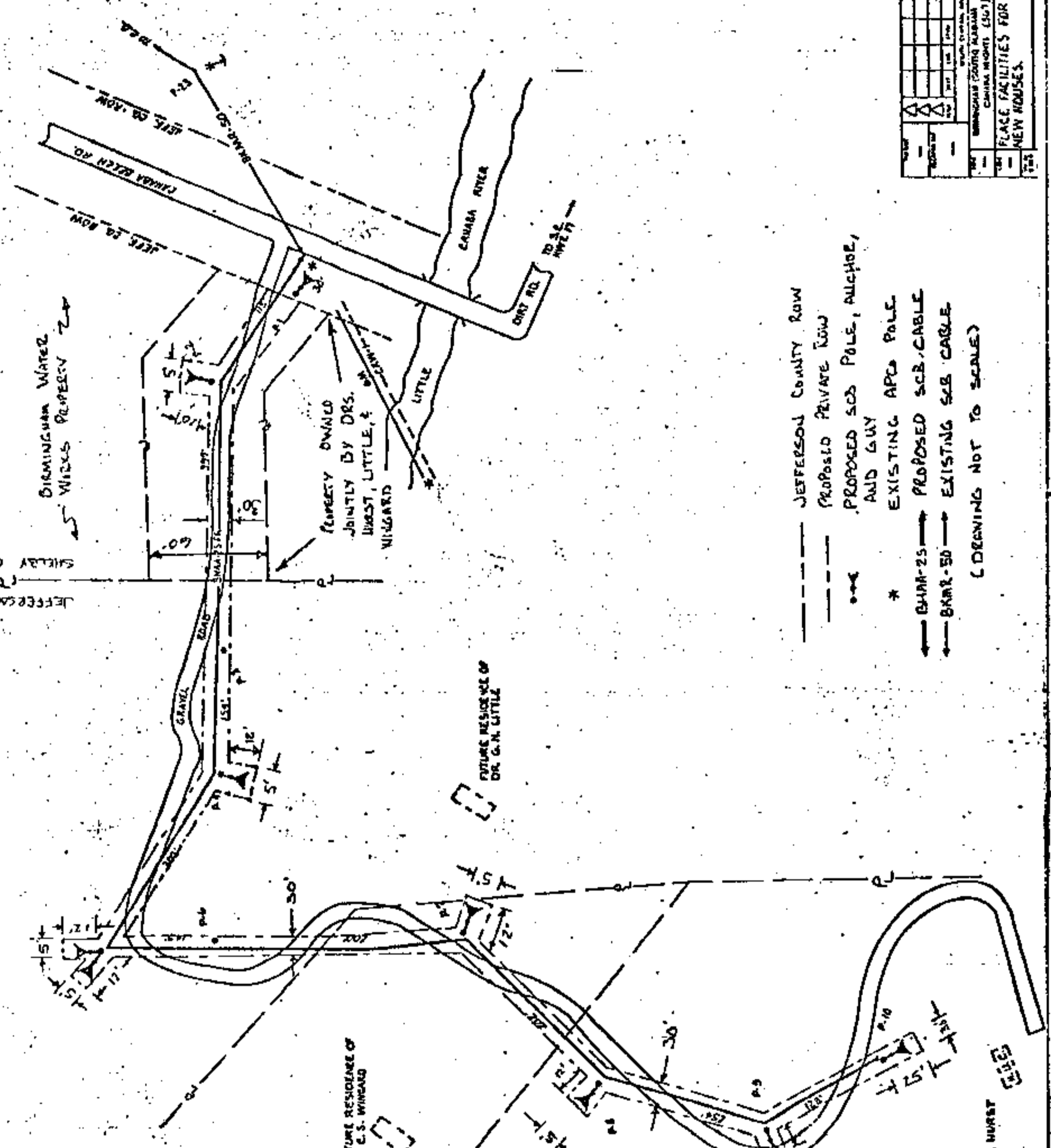

- JEFFERSON COUNTY ROW
  - PROPOSED PRIVATE ROW
  - PROPOSED SCS POLE, ALICHOE, AND GUY
  - \* EXISTING APCs POLE
  - BARR-25 --- PROPOSED SCS CABLE
  - BARR-50 --- EXISTING SCS CABLE
- (DRAWING NOT TO SCALE)

NO.	DESCRIPTION	DATE	BY	SCALE	STATUS
1	PROPOSED SCS POLE, ALICHOE, AND GUY				
2	EXISTING APCs POLE				
3	PROPOSED SCS CABLE				
4	EXISTING SCS CABLE				

FUTURE RESIDENCE OF  
DR. G. S. WINDY

FUTURE RESIDENCE OF  
DR. G. N. LITTLE

STATE OF ALA. SHELBY CO.  
I CERTIFY THIS  
INSTRUMENT WAS FILED  
1982 APR -1 AM 10:04  
*Thomas G. Snowden, Jr.*  
JUDGE OF PROBATE

Deed Tax .50  
Rec 3.00  
Fund 1.00  
4.50

DR. J.C. HURST  
E.E.E.