

30  
NOTICE OF LIS PENDENS

CITY OF PELHAM, ALABAMA,  
a municipal corporation,

vs.

IN THE PROBATE COURT OF

SEABOARD COAST LINE RAILROAD  
COMPANY, a corporation,  
X Company, a corporation, the  
owner of the property described  
on Exhibits "A", "B", "C", and  
"D" attached hereto and made  
part and parcel hereof as fully  
as if set out herein, B Company,  
a corporation, the corporation  
in possession of the property  
described on said Exhibits "A",  
"B", "C" and "D", all of whose  
true names will be added by  
amendment when ascertained.

SHELBY COUNTY, ALABAMA

TO THE HONORABLE THOMAS A. SNOWDEN, JR., JUDGE OF PROBATE OF SHELBY COUNTY,  
ALABAMA:

*See Minutes Book 6 Page 333*  
Comes City of Pelham, Alabama, a municipal corporation, by its  
attorney, and files herewith notice to all persons concerned that on the  
20th day of March, 1932, condemnation proceedings were commenced in  
the Probate Court of Shelby County, Alabama, whereby said City seeks to  
obtain certain strips of land for ways and rights of ways for the  
construction, maintenance and improvements of public utilities, water and  
sewer mains and other rights, and said proceedings are now pending.

The names of the property owners concerned together with the  
property sought to be condemned are as set forth below:

Property Owners: Seaboard Coast Line Railroad  
Company, a corporation, X Company, a corporation,  
the owner of the property described on Exhibits  
"A", "B", "C", and "D" attached hereto and made  
part and parcel hereof as fully as if set out  
herein, B Company, a corporation, the corporation  
in possession of the property described on said  
Exhibits "A", "B", "C" and "D", all of whose  
true names will be added by amendment when  
ascertained.

Property description:

A temporary easement forty feet in width, this  
dimension being 20 feet either side of the center  
line of the proposed water or sewer line as  
hereinafter described and a 20 ft. wide permanent  
easement, this dimension being 10 feet on either  
side of the proposed center line of the water or  
sewer line as hereinafter described, all as shown

on plans and specifications attached to the original petition on file in the Probate Court in this cause, and the right and privilege to construct, erect, install, operate and maintain sewage and water mains, on, upon, along, over, through, under and across the hereinafter described lands; the right, privilege and easement to cut, trim and remove any brush, trees, or other obstructions upon the hereinafter described lands, together with the right of ingress and egress to and from, over and above the hereinafter described lands, for the purpose of the installation and upkeep of the sewage and water system;

The properties involved are described on Exhibits "A", "B", "C", and "D" attached hereto and made part and parcel hereof as fully as if set out herein. Said properties consisting of two parcels.

Description of the above property is taken from plans and specifications attached to the original petition for condemnation in this cause in the Probate Office of Shelby County, Alabama.

CITY OF PELHAM, ALABAMA  
a municipal corporation

By

  
Attorney for said City

State of Alabama )

Shelby County )

IN THE PROBATE OFFICE OF SHELBY COUNTY, ALABAMA

I hereby certify that the within Lis Pendens was filed in this office for record on the \_\_\_\_\_ day of March, 1982, at \_\_\_\_\_ o'clock \_\_\_\_ M., and duly recorded in Book \_\_\_\_\_ of Lis Pendens at Page \_\_\_\_\_, and examined.

\_\_\_\_\_  
Judge of Probate

*Lis Pendens Book 6 Page 334*

# EXHIBIT "A"

PELHAM

## RAILROAD DESCRIPTIONS -- S-1 REVISION

Commence at the NW corner of the SE  $\frac{1}{4}$  of the NW  $\frac{1}{4}$  of Section 14, Township 20 South, Range 3 West, Shelby County, Alabama. Thence South along West line of said  $\frac{1}{4}$ - $\frac{1}{4}$  section for a distance of 622.63 feet to the center line of Seaboard Coast Line Railroad; thence an angle of  $89^{\circ}-20'$  to the left for a distance of 258.96 feet along the center line of railroad to the center line of proposed sanitary sewer crossing; said sewer line intersects at an angle of  $70^{\circ}-11'$  to the right from previously described center line of railroad. Railroad right of way is 100 feet in width at Station 4446.35 sanitary sewer location which is 3670 feet West of railroad Mile Post 960.

See Section 10, Page 335

L.N.W. Cor. SE  $\frac{1}{2}$  - NW  $\frac{1}{4}$   
 Sec. 14, T20S, R3W  
 Shelby Co. AL.

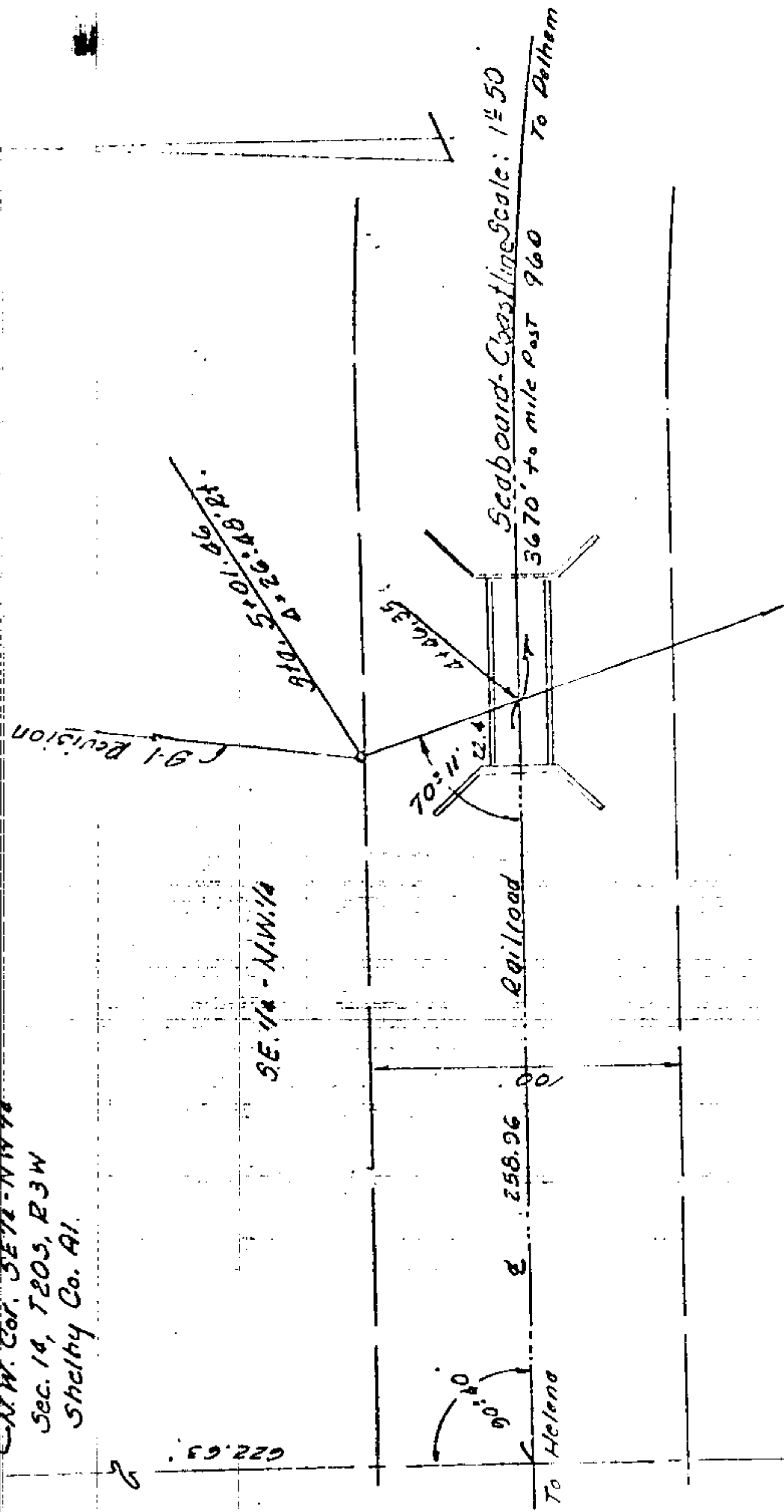

CITY OF DELHAM  
9-1 Revision  
Section and Railroad Tie

# EXHIBIT "C"

PELHAM

RAILROAD DESCRIPTION -- S-2 REVISION

Commence at the SE corner of Section 14, Township 20 South, Range 3 West, Shelby County, Alabama; thence West along the South line of said section a distance of 204.05 feet to the center line of Seaboard Coast Line Railroad; thence an angle to the right of  $61^{\circ}-20'59''$  along center line of railroad right of way a distance of 18.15 feet to the center line of railroad to the intersection of proposed sanitary sewer center line; said center line lying at an angle of  $89^{\circ}-25'$  to the right of previously described center line of railroad. Railroad right of way is 100 feet in width. Intersection of sanitary sewer is at Station 45+95.26 and is located 833 feet Northwest of Pelham depot, Pelham, Alabama (Mile post not available).

See Appendix Page 337

Time: 14.50.

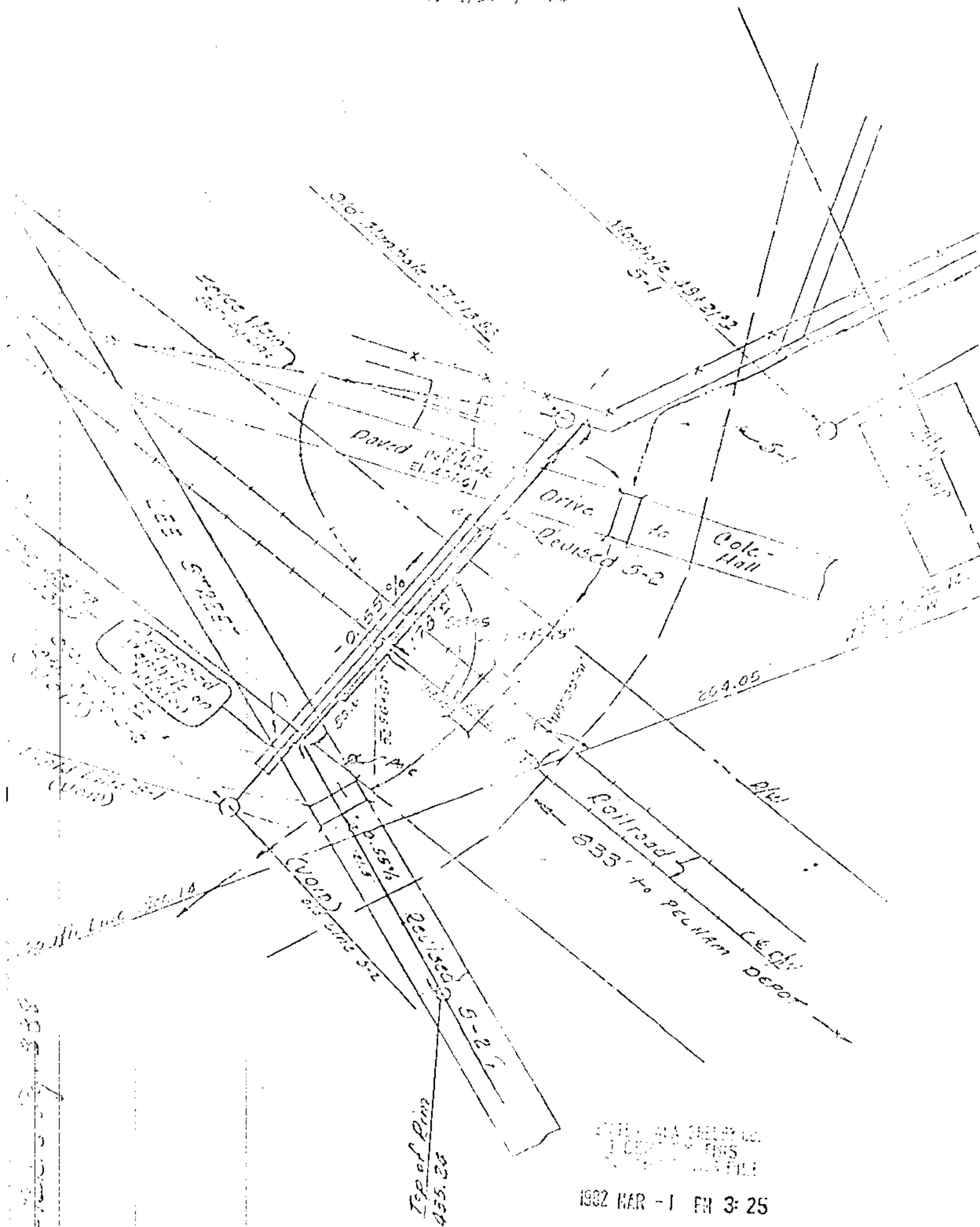

ALL INFORMATION CONTAINED  
HEREIN IS UNCLASSIFIED  
DATE 08-11-2011 BY 60322  
AUTHORITY 50 USC 3025

1982 MAR -1 PM 3: 25

Thomas A. Shandling  
JUDGE OF PROBATE

Rec. 9 0 0  
Ind. 1 0 0

/ B. O. O.