

307

430350

OPR 44-2841-3 (Rev. 1)

Owners Name Frank (Butch) EllisService Address Lot 26 '77-'78 AdditionCity Shelby Shores , Al. Zip W. E. No. 460000-00486100APCo Map No. C-60913-30Sec. 12 Tn. 22S R. 1ELot 26 Block '77-'78 AdditionSubdivision Shelby ShoresDate December 14, 1981

UNDERGROUND SERVICE EASEMENT

EXHIBIT 'A' - PROPERTY DISCRIPTION
IS ATTACHED HERETO AND
MADE A PART HEREOF.

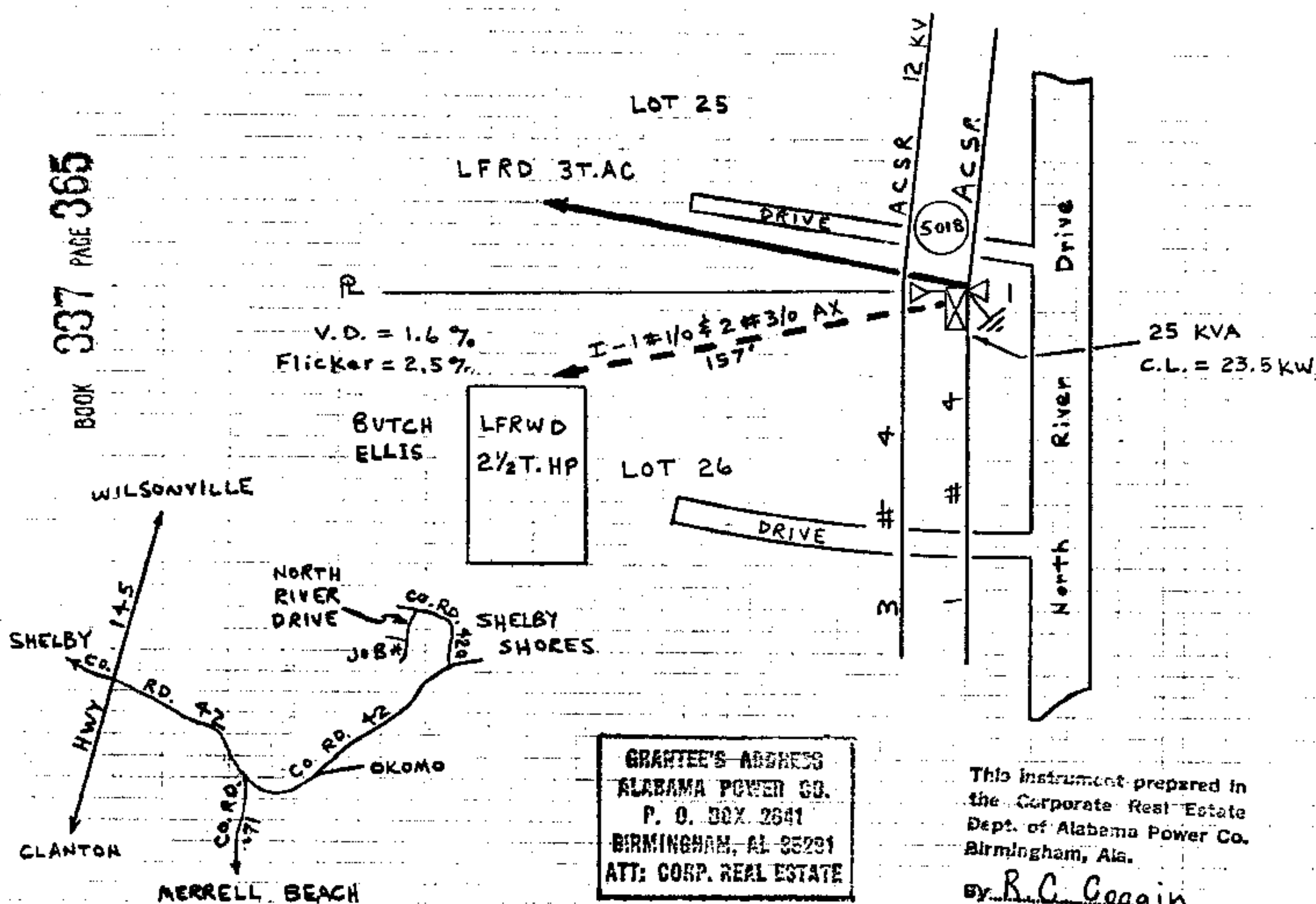

UNDERGROUND SERVICE EASEMENT

In consideration of the supplying and maintenance of said electric current and facilities, the undersigned hereby grants to Alabama Power Company, so far as legally possible, the right to construct, operate and maintain upon, over, under and across the premises at the above location its poles, conductors, facilities and appliances necessary in connection therewith for the transmission of electric power along the route generally shown above together with the rights of ingress and egress to and from said facilities and the right to cut and keep clear all trees and other obstructions that may injure or endanger said facilities.

Owner understands and agrees that Company will retain title to such underground facilities and that such facilities will not in any way be considered a fixture but will remain personal property belonging to the Alabama Power Company.

Owner agrees to pay the cost of any customer requested or caused modifications to the Underground facilities after the initial installation.

Leslie B. Ellis
witness

Leslie B. Ellis
witness

Original and one copy to Alabama Power Company
One copy for owner
Form 5-42841

Frank C. Ellis Jr. 12-22-81
owner of land date

Marie B. Ellis 12-22-81
owner of land date

Husband and Wife Must BOTH Sign
Title Owner Must Sign First

44-2841-3

EXHIBIT A

LOT 26 OF THE 1977-1978 ADDITION TO SHELBY
SHORES SUBDIVISION AS RECORDED IN MAPBOOK 7,
AT PAGE 88, IN THE OFFICE OF THE JUDGE OF PROBATE
OF SHELBY COUNTY, ALABAMA.

BOOK 337 PAGE 366

STATE OF ALA. SHELBY CO.
I CERTIFY THIS
INSTRUMENT WAS FILED

1982 JAN 19 AM 8:47

Thomas A. Shores, Jr.
JUDGE OF PROBATE

Decl. 50

Rec. 1.50

Ind. 1.00

3.00

130320