

STATE OF ALABAMA)

COUNTY OF SHELBY)

235 -

429855

W.E. # 1700-06-0-0013-2-00

KNOW ALL MEN BY THESE PRESENTS, that the undersigned,

City of Hoover

for and in consideration of the sum of One and No/100 Dollars (\$1.00), to
it in hand paid by Alabama Power Company, a corporation, the receipt
whereof is acknowledged, does hereby grant to said Alabama Power Company,
its successors and assigns, the right to construct, install, operate and maintain,
and the right to permit other corporations and persons to construct, install,
operate and maintain, along a route to be selected by the grantee, (generally shown
crosshatched on the attached drawing) its successors and assigns, all conduits,
cables, trans closures and other appliances and facilities useful or necessary in
connection therewith, for the underground transmission and distribution of electric
power and for underground communication service, upon, under and across the following
described land situated in Shelby County, Alabama:

See attached Exhibit "A"

GRANTEE'S ADDRESS
ALABAMA POWER CO.
P. O. BOX 2001
BIRMINGHAM, AL 35201
ATT: GOV. REAL ESTATE

This instrument prepared in
the Corporate Real Estate
Dept. of Alabama Power Co.
Birmingham, Ala.

By R.C. Coggins

BOOK 337 PAGE 310

Together will all the rights and privileges necessary or convenient for the full enjoyment or use thereof, including the right of ingress and egress to and from same facilities and the right to excavate for installation, replacement, repair and removal thereof; and also the right to cut and keep clear all trees, underbrush, shrubbery, roots and other growth, and to keep clear any and all obstructions or obstacles of whatever character on, under or above said facilities.

TO HAVE AND TO HOLD the same to the said Alabama Power Company, its successors and assigns, forever.

IN WITNESS WHEREOF, the said City of Hoover has caused this instrument to be executed in its name by Frank S. Skinner, Jr. as its Mayor, and attested by Anita Steiner as its Clerk, and its corporate seal to be hereto affixed, on this the 10th day of December, 19 81.

CITY OF HOOVER

ATTEST:

By Frank S. Skinner, Jr.
Its Mayor

Anita Steiner
City Clerk

COUNTY OF Jefferson

_____, whose name _____ as _____ Mayor _____ of
the City of Hoover, Alabama _____ signed to the foregoing

Frank S. Skinner, Jr. as such Mayor and with full authority
executed the same voluntarily for and as the act of said City of Hoover

Given under my hand and official seal, this the 10th
day of December, 19 81.

Ante H. Steiner
Notary Public

My Commission Expires June 10, 1984

Exhibit "A"

The following is a description of a tract of land situated in the SE $\frac{1}{4}$ of the NW $\frac{1}{4}$ and the SW $\frac{1}{4}$ of the NE $\frac{1}{4}$ of Section 25, Township 19 South, Range 3 West, Shelby County, City of Hoover, Alabama, being more particularly described as follows:

Beginning at the most northerly point of Lot 2, of the Amended, Second Addition, Riverchase Country Club, Residential Subdivision as recorded in Map Book 7, Page 121, in the office of the Judge of Probate, Shelby County, said point also being on the Southeasterly right-of-way line of Parkway West; thence, leaving said right-of-way line, run a southeasterly direction along the northeasterly line of said Lot 2 for a distance of 149.68 feet to the most easterly corner of said Lot 2, thence, turn an angle of 47° 06' 28" to the left and run in a northeasterly direction for a distance of 130.99 feet to a point on the westerly right-of-way line of the Old Montgomery Highway; thence, turn an angle of 90° to the left and run in a northwesterly direction along said right-of-way line for a distance of 238.90 feet; thence, turn an angle to the left of 87° 32' 21" and leaving said right-of-way line, run in a southwesterly direction for a distance of 150.08 feet to a point on the easterly right-of-way of Parkway West; thence, turn an angle of 71° 05' 11" to the left and run a southerly direction along said right-of-way line for a distance of 35.0 feet to a curve to the right, said curve having a central angle of 25° 44' and a radius of 280.0 feet; thence, being tangent to said curve, run in a southerly direction along the arc of said curve and along said right-of-way line for a distance of 125.76 feet to the point of beginning and containing 44,365 square feet or 1.02 acres more or less.

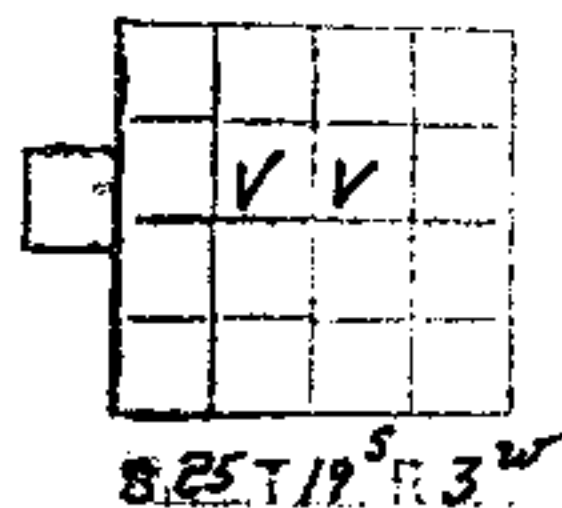

WE NO. 17PMG-200133-00

SKETCH OF PROPOSED WORK

ESTIMATE NO

DISTRICT ALABASTER

DRAWN BY: W. Cheney

DATE 12-2-81

SCALE NT5

FT. PER INCH

SECT 25

TOWNSHIP 19 S

RANGE 34

MAP REFERENCE 71E45-15

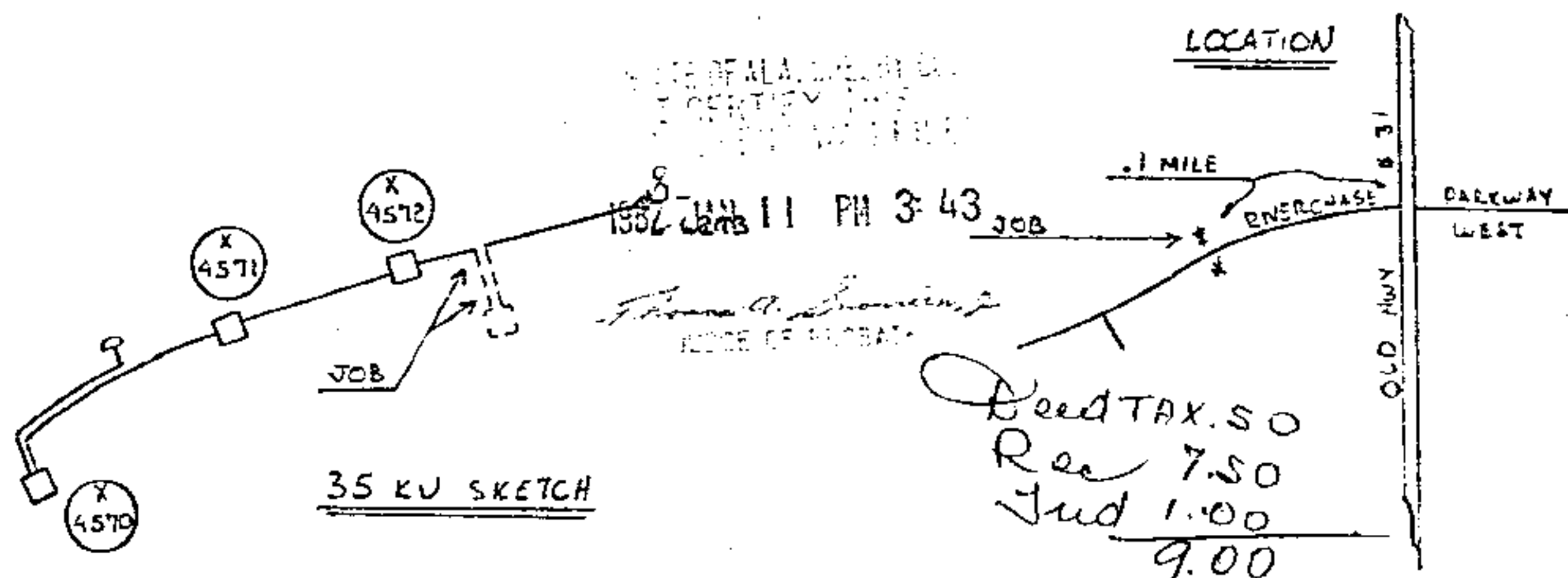
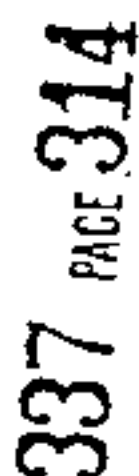

STANDARD SYMBOLS SHOWN IN DISTRIBUTION STANDARDS TO BE USED