

711

FORM 8416 SC  
OCTOBER, 1978

RIGHT OF WAY EASEMENT

For and in consideration of ONE DOLLAR ( \$1.00 ) and other good and valuable consideration, the receipt of all of which is hereby acknowledged, the undersigned do (does) hereby grant to South Central Bell Telephone Company, its licensees, successors, assigns, allied and associated companies, a right of way easement to construct, operate, maintain, add or remove such lines or systems of communications or related services as the grantee may require, from time to time, consisting of poles, guys, anchors, aerial, buried and underground cables and wires, cable terminals, splicing boxes, pedestals, conduit, manholes, markers, and other amplifiers, boxes, appurtenances or devices upon, over and under a strip of land 10 feet wide across the following lands in SHELBY County (Parish) State of ALABAMA described as follows: AS SHOWN ON THE ATTACHED SHEET IN THE SOUTHWEST 1/4 OF THE SOUTHEAST 1/4 OF SECTION 17 TOWNSHIP 20 SOUTH RANGE 2 WEST.

and to the fullest extent the undersigned has the power to grant, if at all, along and under the roads, streets or highways adjoining or through said property.

The following rights are also granted: to allow any other person, firm or corporation to attach wires or lay cable or conduit or other appurtenances upon, over and under said easement for communications or electric power transmission distribution; ingress and egress to said easement at all times; to clear the easement and keep it cleared of all trees, undergrowth or other obstructions; to trim and cut and keep trimmed and cut all dead, weak, leaning or dangerous trees or limbs outside of the easement which might interfere with or fall upon the lines or systems of communications or power transmission or distribution; and the right to relocate said facilities on said lands to conform to any future highway relocation, widening or improvements.

To have and to hold the above granted easement unto South Central Bell Telephone Company, its successors and assigns forever.

In witness whereof, the undersigned has caused this instrument to be executed on the 15 day of Aug, 1981

WITNESS

Charles R. Blackburn, Jr. Aug 28, 1981

Roger D. Morsey L.S.

L.S.

Name of Corporation

ATTEST: \_\_\_\_\_

By: \_\_\_\_\_  
Title

SCBT USE ONLY: AUTHORITY 134-2321B; CLASSIFICATION 91C;

AREA BIRMINGHAM SOUTH; APPROVED 99/1/81; TITLE OPERATION MANAGER  
ALABAMA OSPE

LOCATION SKETCH

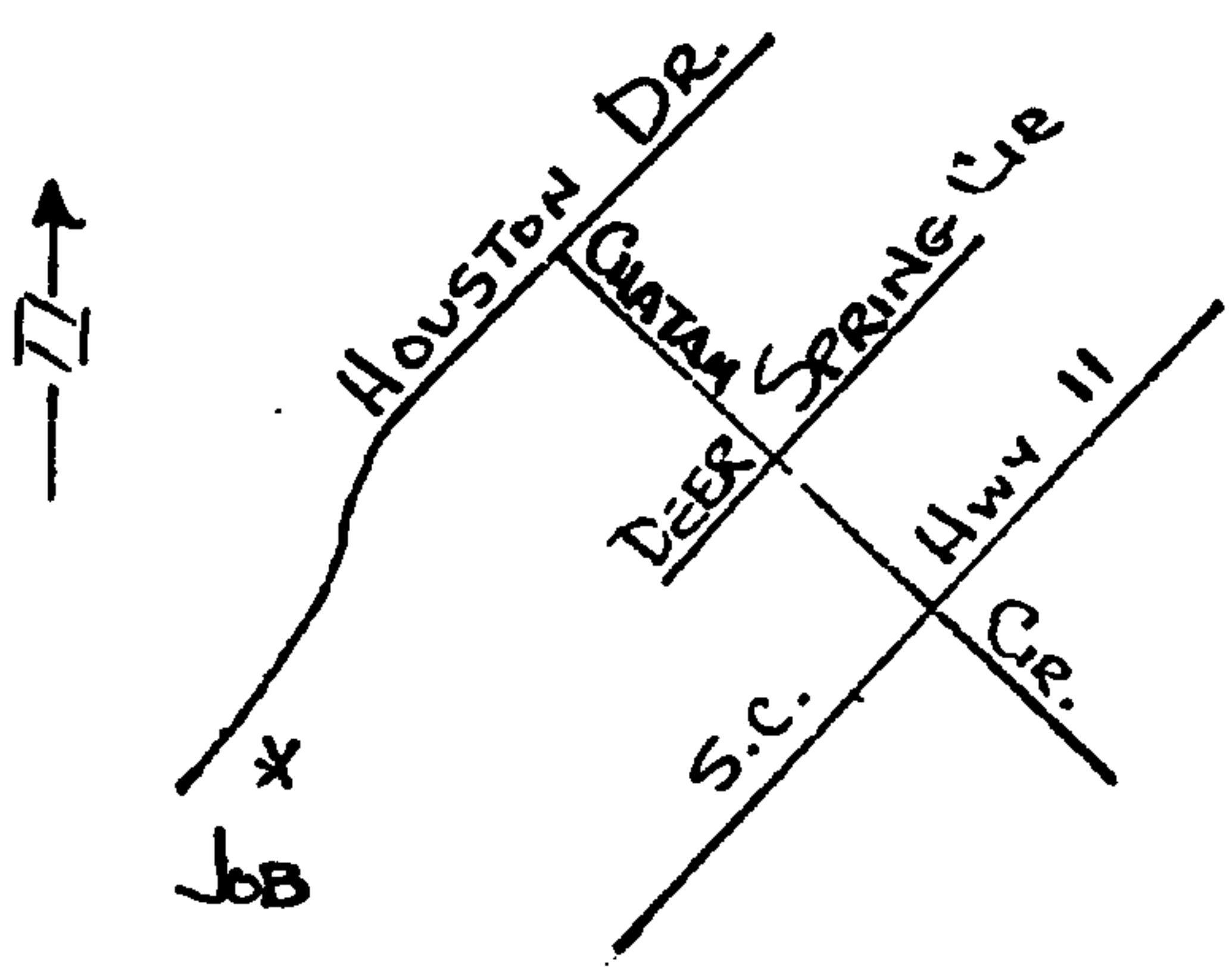

BOOK 336 PAGE 221

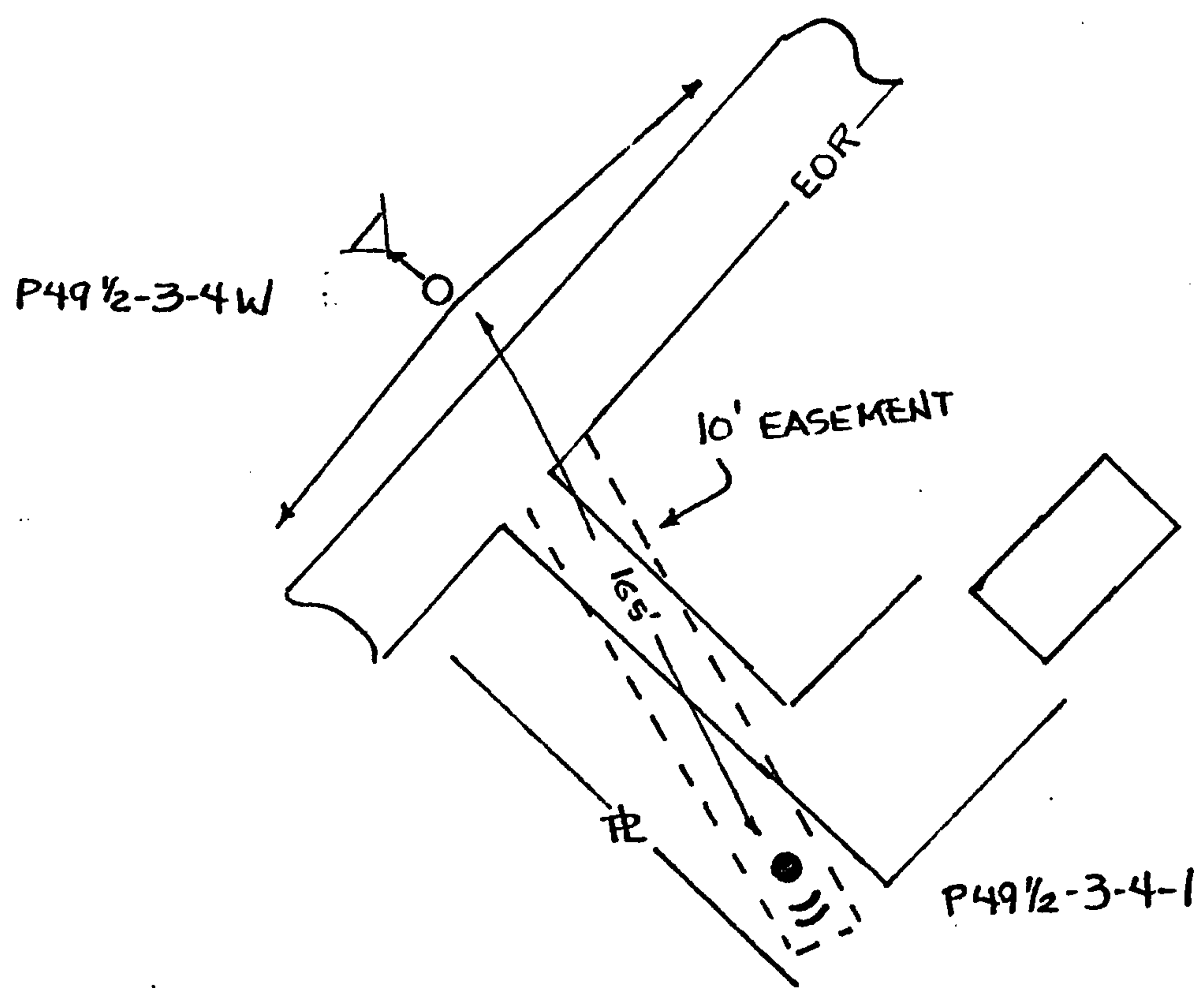

KEY

- O EXISTING SCB POLE.
- △ EXISTING SCB ANCHOR AND GUY.
- PROPOSED SCB POLE.
- " PROPOSED APCO ANCHOR TO BE SET BY SCB.
- ↔ EXISTING SCB AERIAL CABLE

STATE OF ALA. SHELBY CO.  
 I CERTIFY THIS  
 1981 NOV 20 AM 10:34

*Thomas W. Shivers, Jr.*  
 JUDGE OF PROBATE

Deed .50  
 Rec. 3.00  
 Incl. 1.00  
4.50