

- PROPOSED SCB POLE
- * EXISTING APCO. POLE

KEY

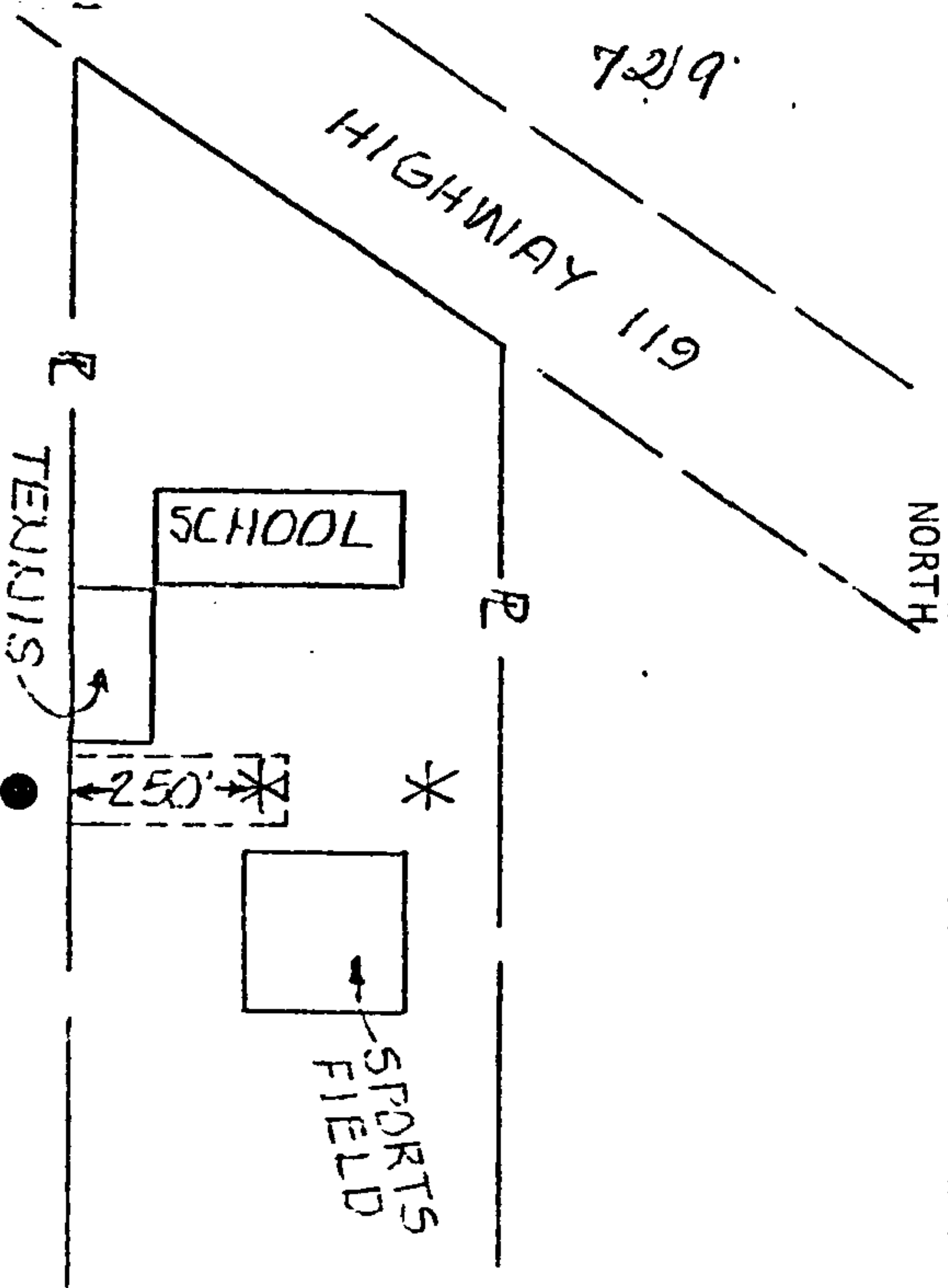

Name and Post Office Address of Grantor BRIARWOOD CONTINUING PRESBYTERIAN CHURCH
3001 HIGHWAY 280 SOUTH
Toll Line (Name)
or Exchange Line B'HAM-CAHABA HEIGHTS W
tributary to (Exchange)
The property is bounded where the line enters and leaves this property by the property of:
SCOTCH of the SOUTH
The poles (or stakes) have the following identification:
to
Authority 134-8040B classification 91C
Area BIRMINGHAM (SOUTH CENTRAL) ALA
Approved
Title OPERATIONS MANAGER DSPE

RIGHT-OF-WAY EASEMENT

FORM 8416 SC
MARCH, 1973

In consideration of the sum of money hereinafter set out and other good and valuable consideration, the adequacy and receipt of which is hereby acknowledged from the South Central Bell Telephone Company, the undersigned, owner(s) of the premises described below, do hereby grant to the South Central Bell Telephone Company, its licenses, agents, successors, assigns, and allied and associated companies, a right of way easement to construct, operate, maintain, add or remove such lines or systems of communications or related services as the grantee may require, consisting of:

- 142 BJM (1) poles, guys, anchors, aerial cables and wires;
- 142 BJM (2) Buried cables and wires, cable terminals, markers, splicing boxes and pedestals;
- 142 BJM (3) Conduits, manholes, markers, underground cables and wires;
- (4) and other amplifiers, boxes, appurtenances or devices

upon over and under a strip of land 30 feet wide across the following lands in SHELBY County, State of ALABAMA generally described as follows: ON THE BRIARWOOD SCHOOL PROPERTY AS SHOWN IN SECTION 7, TOWNSHIP 19 SOUTH, RANGE 1 WEST IN SHELBY COUNTY, ALABAMA.

and, to the fullest extent the undersigned has the power to grant, if at all, over, along and under the roads, streets, or highways adjoining or through said property.

The following rights are also granted: to allow any other person or company to attach wires or lay cable or conduit within the right of way for communications or electric power transmission or distribution; ingress and egress to said premises at all times; to clear the land and keep it cleared of all trees, undergrowth or other obstructions within the easement area; to trim and cut and keep trimmed and cut all dead, weak, leaning or dangerous trees or limbs outside of the easement area which might interfere with or fall upon the lines or systems of communications or power transmission or distribution.

The receipt of ONE and NO /100 Dollars (\$1.00) is hereby acknowledged by the undersigned.

To have and to hold the above granted easement unto South Central Bell Telephone Company, its successors and assigns forever.

IN WITNESS WHEREOF, the undersigned Has signed and sealed this document on July 30 1981 caused this instrument to be executed by its duly authorized agent

Signed, sealed and delivered in the presence of W. A. SHELBY CO. L.S.

James H. P. P. P. L.S.

James H. P. P. P. L.S.

James H. P. P. P. L.S.

James H. P. P. P. L.S.

James H. P. P. P. L.S.

James H. P. P. P. L.S.

James H. P. P. P. L.S.

James H. P. P. P. L.S.

James H. P. P. P. L.S.

James H. P. P. P. L.S.

James H. P. P. P. L.S.