

WE 1700 00 0 0077 100

STATE OF Illinois )

506

COUNTY OF Cook )

KNOW ALL MEN BY THESE PRESENTS, that the undersigned,  
AMERICAN HOSPITAL SUPPLY CORPORATION

for and in consideration of the sum of One and No/100 Dollars (\$1.00), to  
it in hand paid by Alabama Power Company, a corporation, the receipt  
whereof is acknowledged, does hereby grant to said Alabama Power Company,  
its successors and assigns, the right to construct, install, operate and maintain,  
and the right to permit other corporations and persons to construct, install,  
operate and maintain, along a route to be selected by the grantee, (generally shown  
crosshatched on the attached drawing) its successors and assigns, all conduits,  
cables, trans closures and other appliances and facilities useful or necessary in  
connection therewith, for the underground transmission and distribution of electric  
power and for underground communication service, upon, under and across the following  
described land situated in Shelby County, Alabama:

See Exhibit "A"  
Attached hereto and made a part hereof

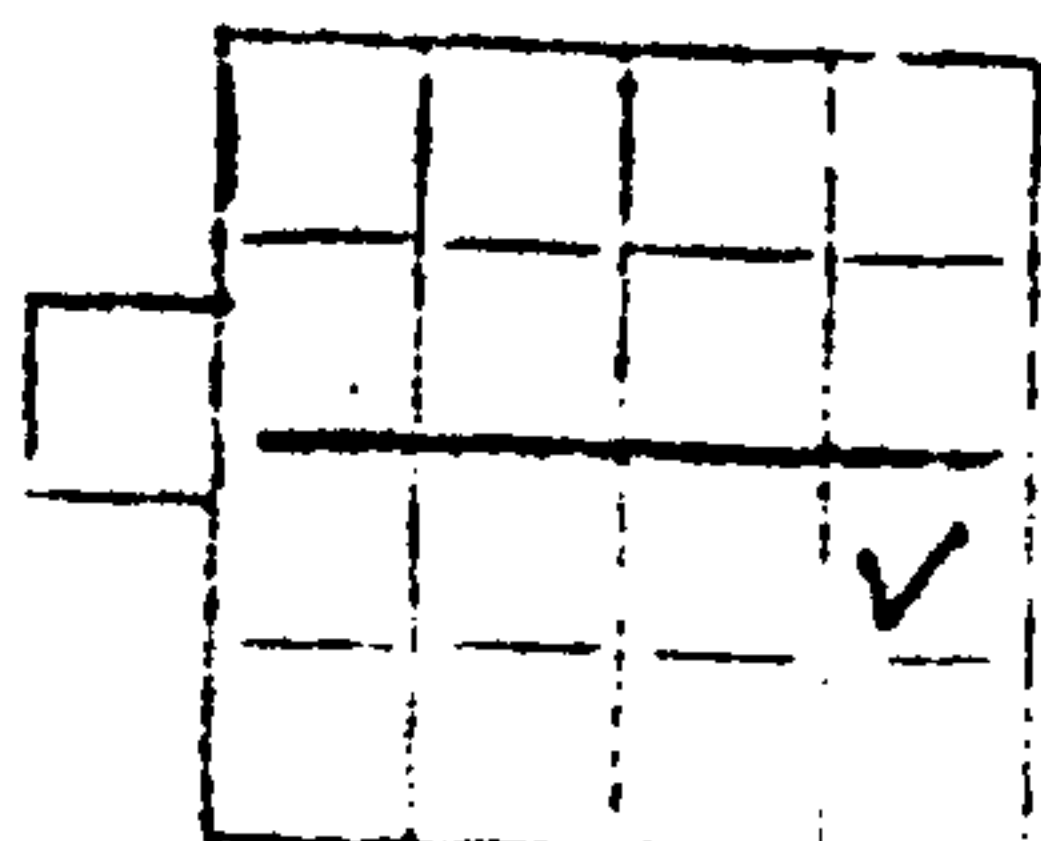

S19 T19 S R2 W

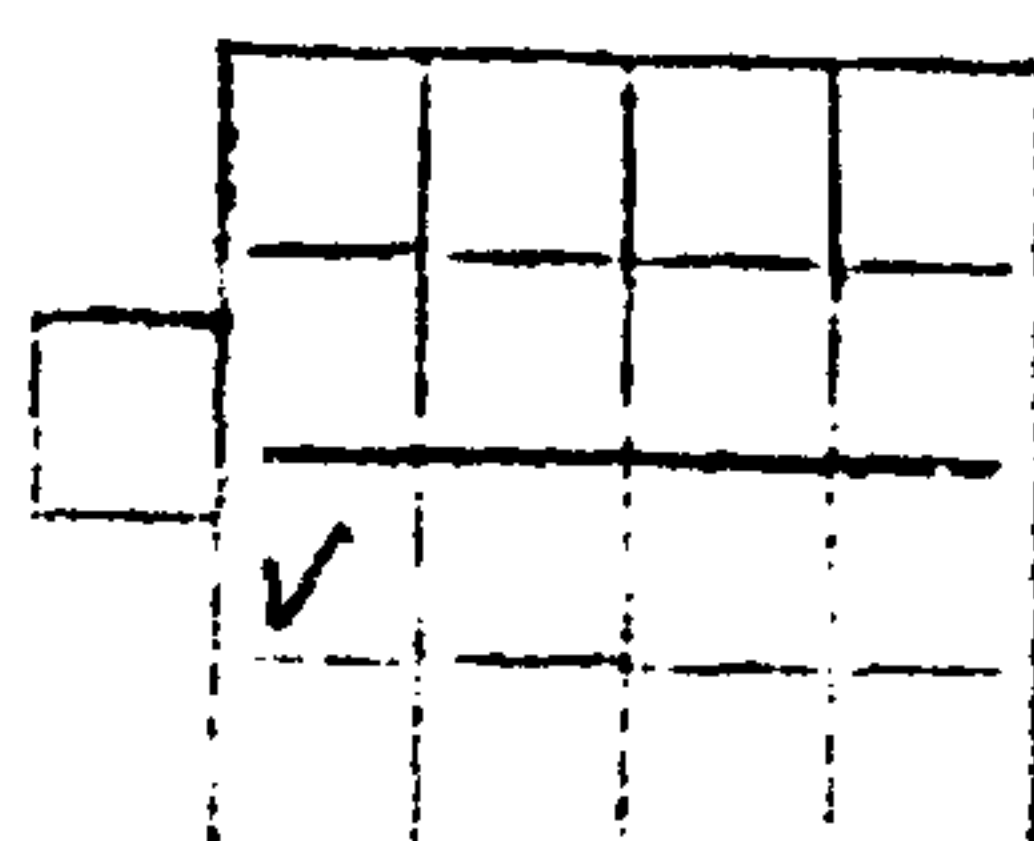

S20 T19 S R2 W

This instrument prepared in  
the Corporate Book of Records  
Dept. of Records & Post. Co.  
Birmingham, Ala.

By R.C. Coggin

Exhibit "A"

A tract of land situated in the NE $\frac{1}{4}$  of the SE $\frac{1}{4}$ , Section 19, and the NW $\frac{1}{4}$  of the SW $\frac{1}{4}$ , Section 20, all in Township 19 South, Range 2 West, Shelby County, Alabama, being more particularly described as follows:

From the NE corner of said NE $\frac{1}{4}$  of the SE $\frac{1}{4}$ , run in a southerly direction along the east line of said  $\frac{1}{4}$ - $\frac{1}{4}$  section for a distance of 436.37 feet to the point of beginning; thence turn an angle to the right of 126° 40' 55" and run in a northwesterly direction for a distance of 62.42 feet; thence turn an angle to the left of 57° 59' 05" and run in a southwesterly direction for a distance of 42.46 feet; thence turn an angle to the right of 4° 20' 41" and run in a southwesterly direction for a distance of 52.10 feet; thence turn an angle to the left of 6° 46' 41" and run in a southwesterly direction for a distance of 165.35 feet; thence turn an angle to the right of 19° 38' and run in a westerly direction for a distance of 194.85 feet; thence turn an angle to the left of 14° 32' 45" and run in a southwesterly direction for a distance of 131.13 feet; thence turn an angle to the left of 20° 13' and run in a southwesterly direction for a distance of 134.15 feet; thence turn an angle to the left of 73° 01' and run in a southeasterly direction for a distance of 25.76 feet; thence turn an angle to the right of 90° and run in a southwesterly direction for a distance of 53.00 feet to a point on the curved east right-of-way line of Parkway Office Circle, said curved right-of-way having the following characteristics: Radius of 370.00 feet, a central angle of 7° 40' 54" and being concave in a southwesterly direction, thence turn an angle to the left and run along the arc of said curve for a distance of 49.60 feet (chord measures 49.57 feet and chord line is obtained by turning a left interior angle of 99° 10' 48") to the end of said curve, thence turn an angle to the right and run along a line tangent to end of said curve which is also said east right-of-way line and run in a southwesterly direction for a distance of 161.86 feet to a point of curve, said curve being concave in a northeasterly direction and having a radius of 400.00 feet and a central angle of 22° 26'; thence turn an angle to the left and run along the arc of said curve (which is also the east right-of-way line of said road) for a distance of 156.61 feet to the end of said curve; thence turn an angle to the left and run along a line tangent to the end of said curve for a distance of 77.85 feet; thence turn an angle to the left of 68° 25' 35" and run in a northeasterly direction for a distance of 957.73 feet to a point on the west right-of-way line of Interstate Highway #65; thence turn an angle of 74° 45' 55" to the left and run along said west right-of-way line for a distance of 97.04 feet; thence turn an angle to the right of 9° 59' 25" and run in a northeasterly direction for a distance of 184.41 feet along said west right-of-way line; thence turn an angle to the left of 19° 51' 03" and run in a northwesterly direction along said west right-of-way line for a distance of 247.00 feet; thence turn an angle to the left of 97° 09' 02" and run in a southwesterly direction for a distance of 154.84 feet; thence turn an angle to the left of 29° 49' 50" and run in a southwesterly direction for a distance of 66.34 feet; thence turn an angle to the right of 37° 31' 55" and run in a westerly direction for a distance of 100.00 feet; thence turn an angle to the right of 51° 15' 55" and run in a northwesterly direction for a distance of 87.52 feet to the point of beginning.



together with all the rights and privileges necessary or convenient for the full enjoyment or use thereof, including the right of ingress and egress to and from said facilities and the right to excavate for installation, replacement, repair, and removal thereof; and also the right to cut and keep clear all trees, underbrush, shrubbery, roots and other growth, and to keep clear any and all obstructions or obstacles of whatever character on, under or above said facilities.

TO HAVE AND TO HOLD the same to the said Alabama Power Company, its successors and assigns, forever.

IN WITNESS WHEREOF, the said American Hospital Supply Corporation has caused this instrument to be executed in its name by J. Richard Hull as its Corporate Vice-President, and attested by Jay Nigro its Assistant Secretary, and its corporate seal to be hereto affixed, on this the 19 day of May, 1981

Attest:

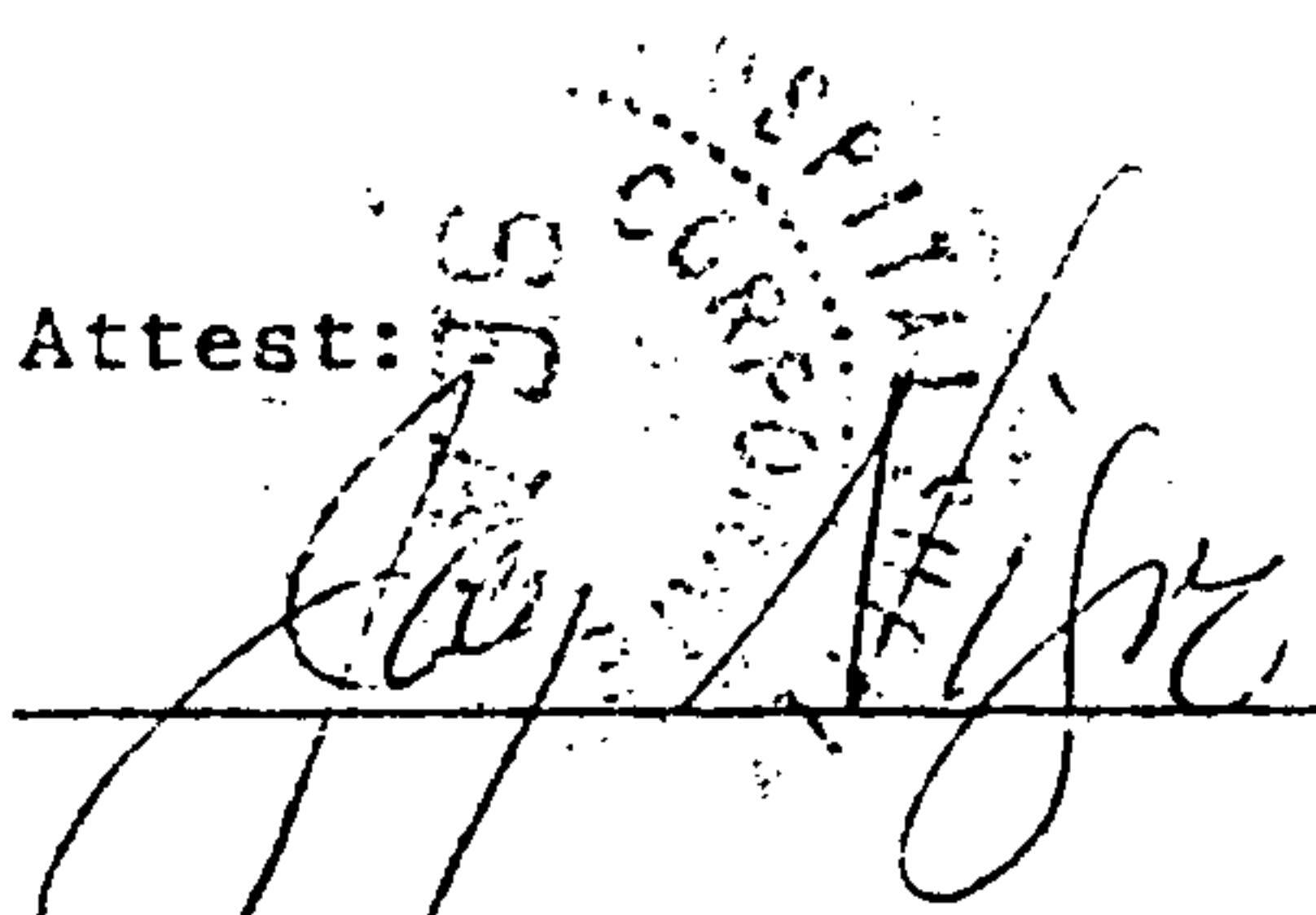
  
\_\_\_\_\_  
STATE OF Illinois )  
COUNTY OF Cook )

American Hospital Supply Corporation

By J. Richard Hull  
Corporate Vice-President

STATE OF Illinois )  
COUNTY OF Cook )

I, Luis Jean Mongin, a Notary Public, in and for said County in said State, hereby certify that J. Richard Hull

\_\_\_\_\_, whose name as Corporate Vice-President of American Hospital Supply Corp., a corporation, is signed to the foregoing instrument, and who is known to me, acknowledged before me on this day that, being informed of the contents of this instrument, he as such officer and with full authority executed the same voluntarily for and as the act of said corporation.

Given under my hand and official seal, this the 19th day of May, 1981

Luis Jean Mongin  
Notary Public  
my commission expires April 2, 1984

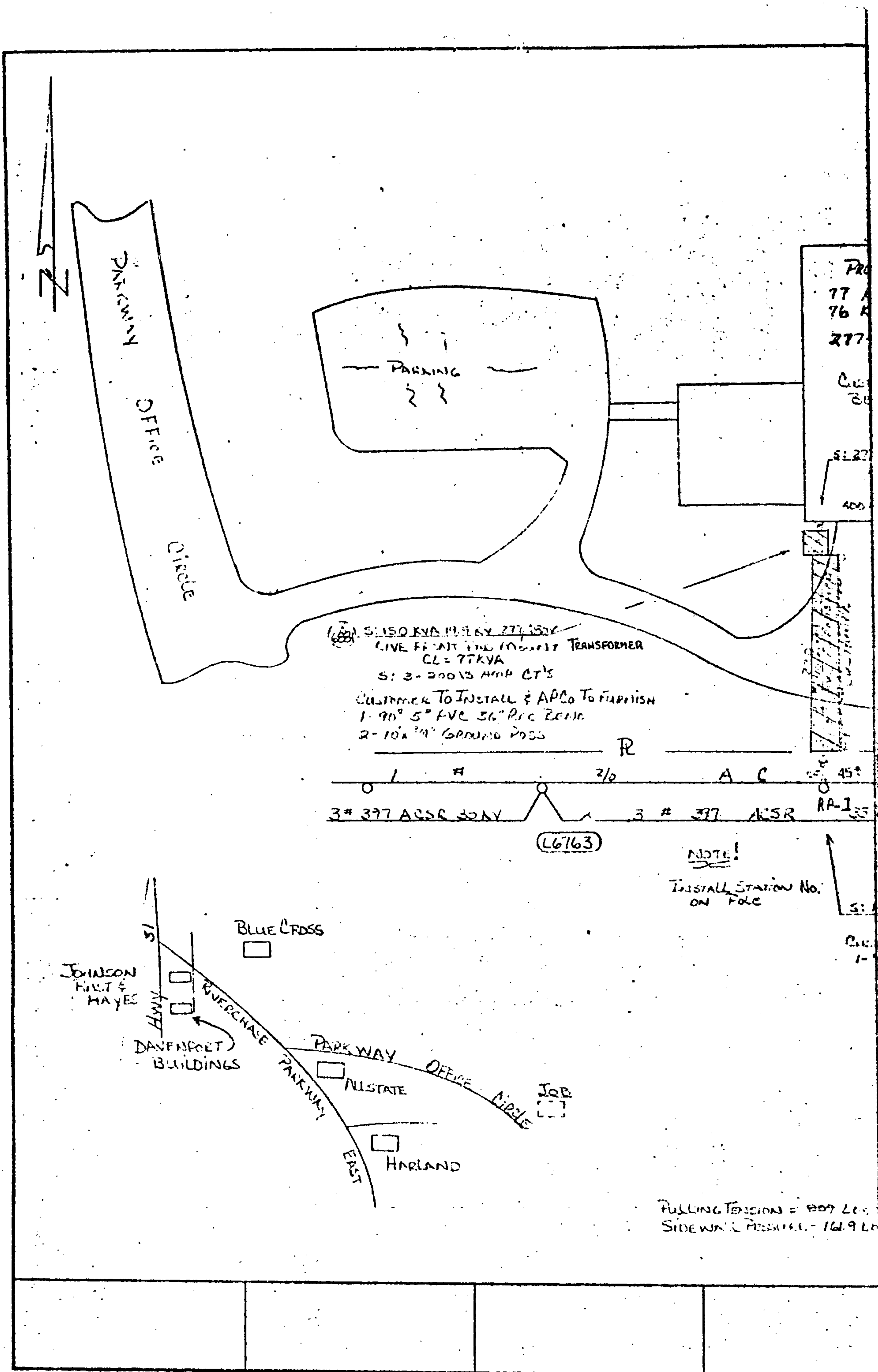

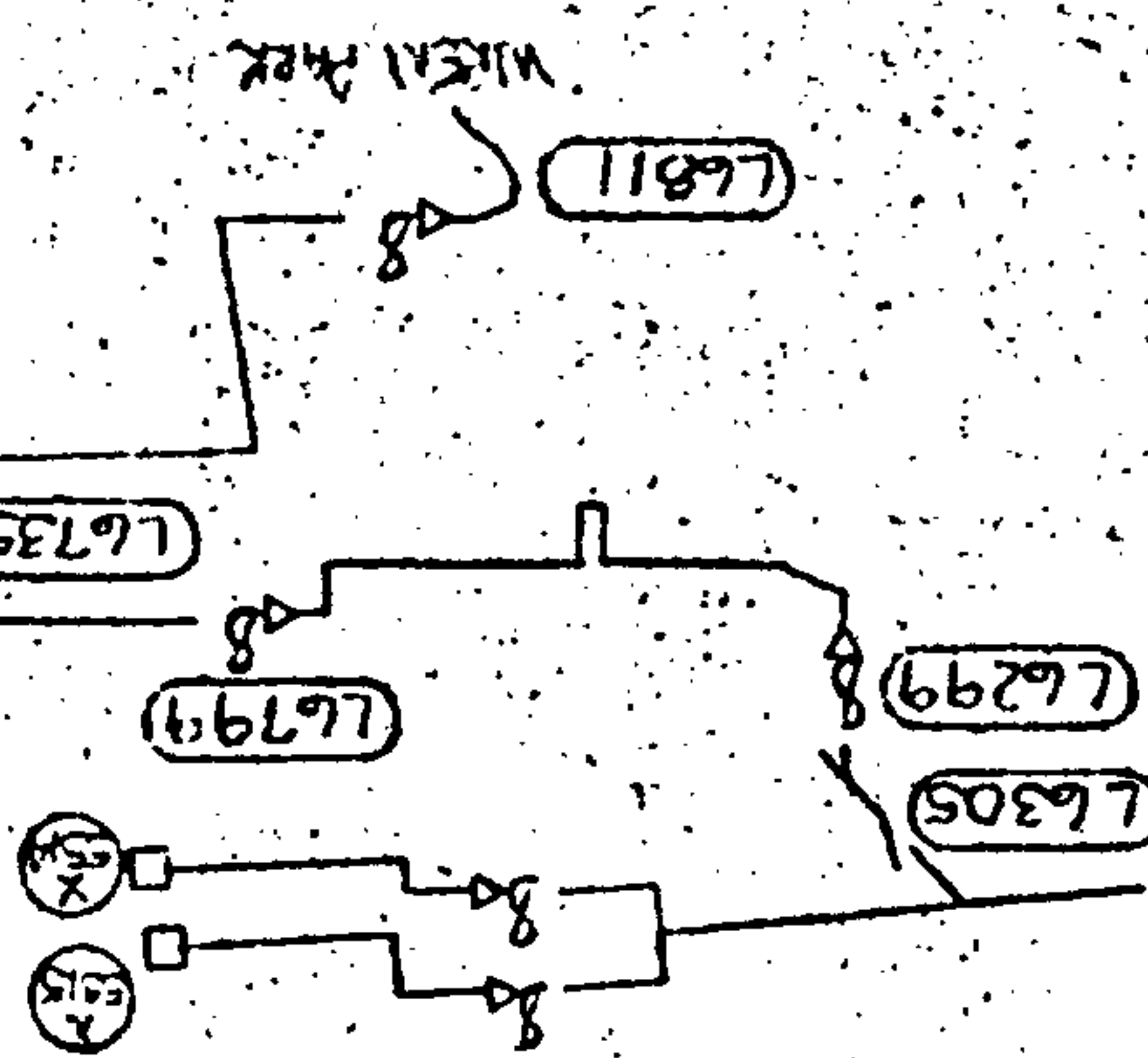

[illegible]

5:1-38 10 AMP FUSE (1)  
FUSE: 7 AMP (1)  
CUSTOMER TO INSTALL: ALSO TO  
1-70'S PVC 3/4" AC. BEND

45: S R

PROPOSED - LOADING  
17 KVA SUMMER DEMAND  
16 KVA WINTER  
277-480 VOLT 3Ø SERVICE

1931 JUN 15 TH 2:29

BOOK 333 PAGE 391

Dead Tax 50  
 Fed 7.50  
 Ind 1.00  
9.00