



19801024000122020 Pg 1/2 .00
Shelby Cnty Judge of Probate, AL
10/24/1980 00:00:00 FILED/CERTIFIED

Name and Post Office Address of Grantor Daniel Spitzer
1970 CHANDALAR PARK
Prichard, ALABAMA 35124.
Toll Line (Name)
or
Exchange Line ALABAMA
tributary to (Exchange)
The property is bounded where the line enters and leaves this property by the property of:
of the
The poles (or stakes) have the following identification:
to
Authority 034-2334 classification 945C
Area BIRMINGHAM SOUTH ALABAMA
Approved J.P. McManey
Title District Manager - OSP Eng.
NORTH

10/3

SEE ATTACHED SKETCH.

RIGHT-OF-WAY EASEMENT

FORM 8416 SC
MARCH, 1973

In consideration of the sum of money hereinafter set out and other good and valuable consideration, the adequacy and receipt of which is hereby acknowledged from the South Central Bell Telephone Company, the undersigned, owner(s) of the premises described below, do hereby grant to the South Central Bell Telephone Company, its licenses, agents, successors, assigns, and allied and associated companies, a right of way easement to construct, operate, maintain, add or remove such lines or systems of communications or related services as the grantee may require, consisting of:

- ~~(1) poles, guys, anchors, aerial cables and wires;~~
- (2) Buried cables and wires, cable terminals, markers, splicing boxes and pedestals;
- ~~(3) Conduits, manholes, markers, underground cables and wires;~~
- ~~(4) and other amplifiers, boxes, appurtenances or devices~~

upon over and under a strip of land 10 feet wide across the following lands in SHELBY County, State of ALABAMA generally described as follows:

SECTION 12 TOWNSHIP 20 SOUTH RANGE 3 WEST.

and, to the fullest extent the undersigned has the power to grant, if at all, over, along and under the roads, streets, or highways adjoining or through said property.

The following rights are also granted: to allow any other person or company to attach wires or lay cable or conduit within the right of way for communications or electric power transmission or distribution; ingress and egress to said premises at all times; to clear the land and keep it cleared of all trees, undergrowth or other obstructions within the easement area; to trim and cut and keep trimmed and cut all dead, weak, leaning or dangerous trees or limbs outside of the easement area which might interfere with or fall upon the lines or systems of communications or power transmission or distribution.

The receipt of ONE and NONE /100 Dollars (\$1.00) is hereby acknowledged by the undersigned.

To have and to hold the above granted easement unto South Central Bell Telephone Company, its successors and assigns forever.

IN WITNESS WHEREOF, the undersigned has ~~caused this instrument to be executed by its~~ signed and sealed this document
on JULY 23, 1980. ~~duly authorized agent~~

Signed, sealed and delivered in the presence of:

Witness

Charles R. Blackburn, Jr. 7/23/80

Attest

Corporate Officer

By

Name of Corporation

Title:

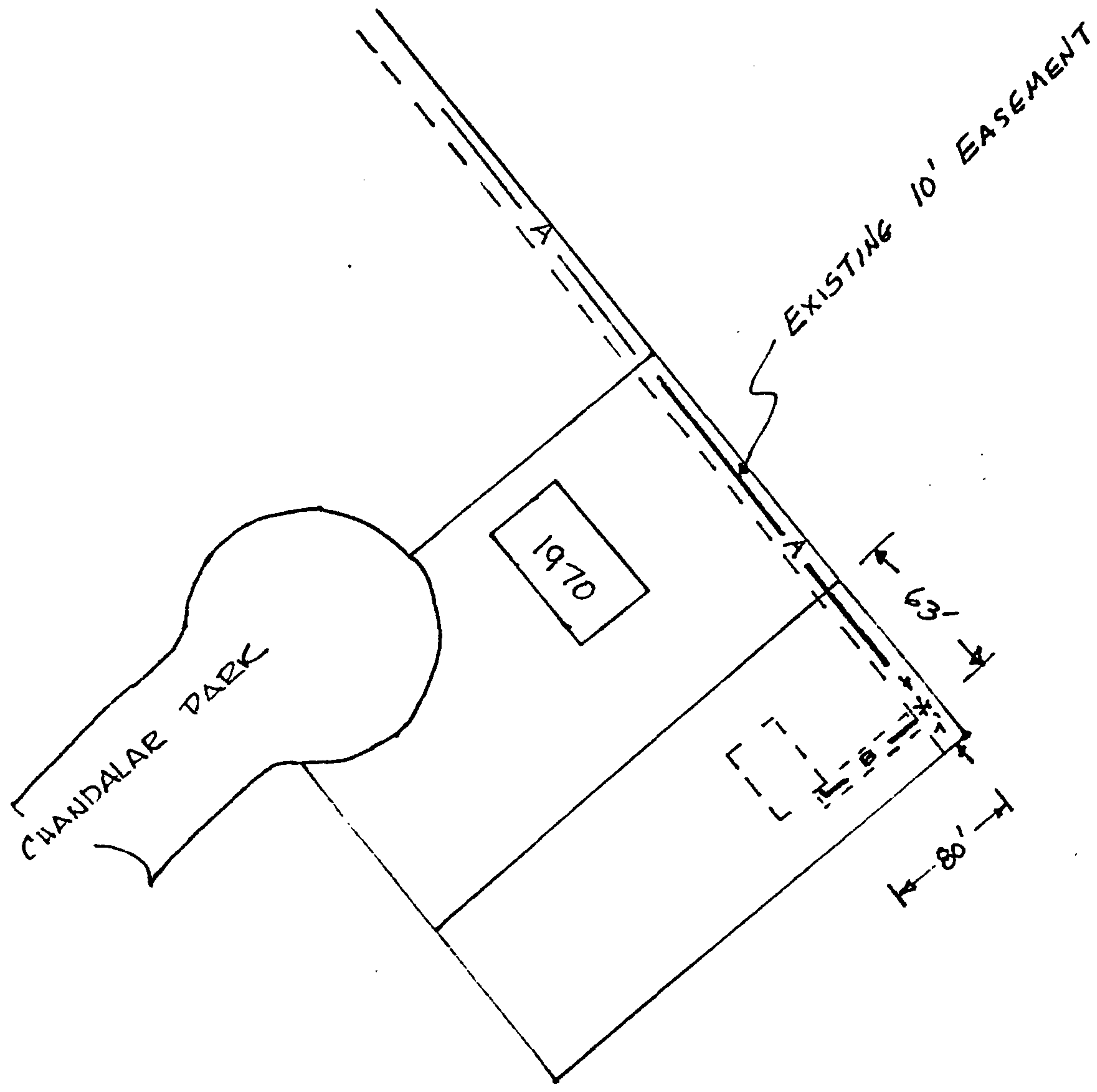

— KEY —

- * EXISTING APCO POLE
- B — PROPOSED BURIED CABLE
- A — PROPOSED AERIAL CABLE
- A — EXISTING AERIAL CABLE

STATE OF ALA. SHELBY CO.
I CERTIFY THIS
1980 OCT 24 AM 8:56

Deed 50
Rec. 3.00
Ind. 1.00
150