

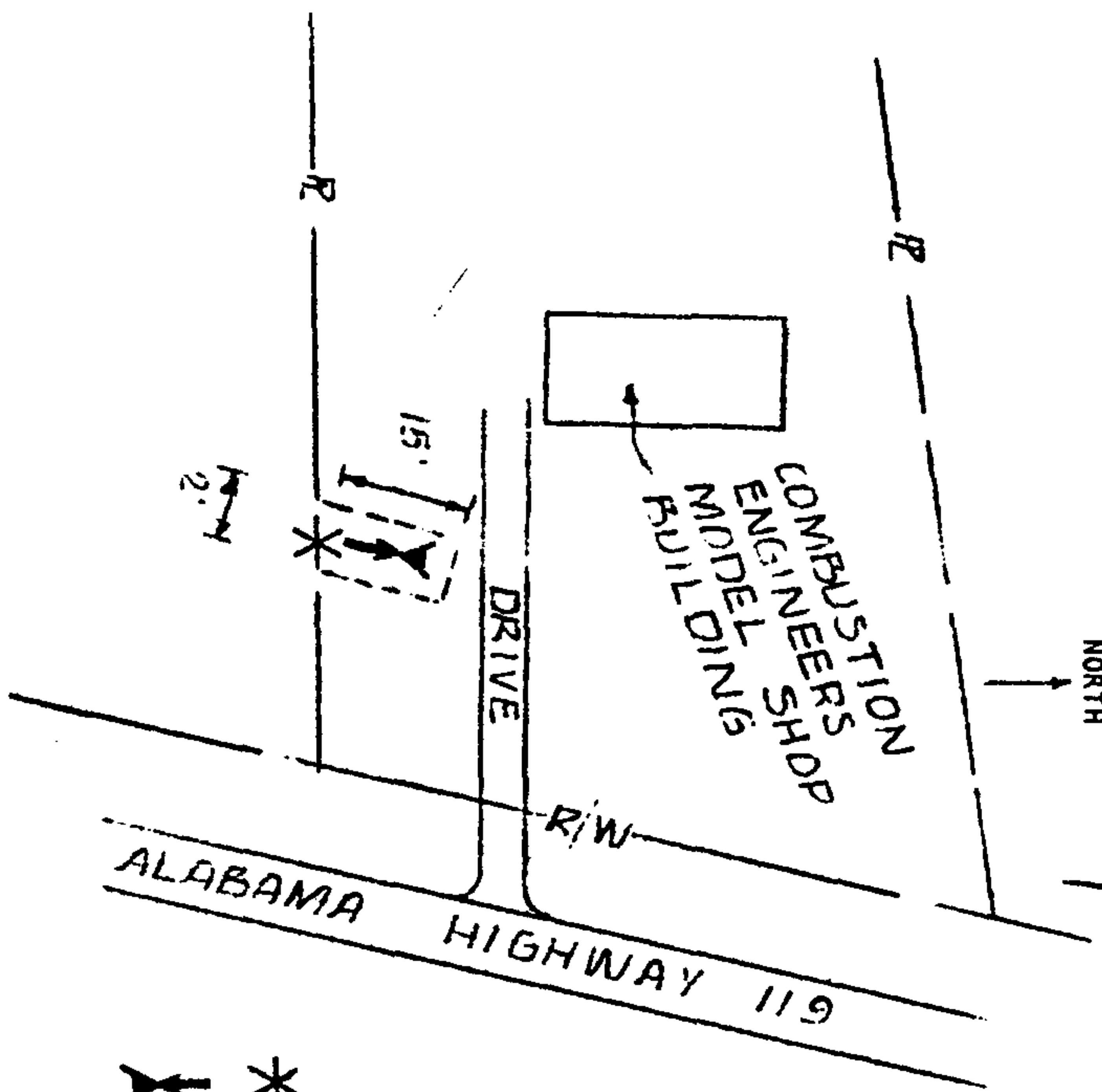

19801002000111450 Pg 1/1 .00  
Shelby Cnty Judge of Probate, AL  
10/02/1980 00:00:00 FILED/CERTIFIED



Name and Post Office Address of Grantor N. Lee Cooper  
1980 First National Bldg.  
Birmingham, AL 35203  
Toll Line (Name) \_\_\_\_\_  
or Exchange Line (Name) \_\_\_\_\_  
Exchange Line (Exchange) \_\_\_\_\_  
tributary to \_\_\_\_\_  
The Property is bounded where the line enters and leaves this property by the property of: \_\_\_\_\_ on the \_\_\_\_\_ and \_\_\_\_\_ on the \_\_\_\_\_  
The poles (or stakes) have the following Identification: \_\_\_\_\_  
Authority ASA-2161 Classification 91C  
Area BIRMINGHAM SOUTH ALA.  
Approved [Signature]  
Title DISTRICT MANAGER OSPEN

FORM 8418 SC  
NOV., 1968

### PERMIT-POLES AND LINES

In consideration of the benefits to be received and of other good and valuable consideration received from South Central Bell Telephone Company, (I) (We) hereby grant said Company, its associated and allied companies, their respective licensees, successors and assigns, the right to construct, operate and maintain, add or remove lines or systems of communications consisting of such poles, guys, wires, cables, anchors, amplifiers, boxes, and other necessary appurtenances or devices as grantee may require upon, across, over and/or under that certain tract of land situated in SHELBY County, State of ALABAMA, to-wit: PROPERTY OF COMBUSTION ENGINEERS MODEL SHOP ON ALABAMA HIGHWAY 119 IN SECTION 32, TOWNSHIP 18 SOUTH RANGE 1 WEST IN SHELBY COUNTY, ALABAMA.

and, to the fullest extent the undersigned has the power to grant, if at all, upon, along and under the roads, streets or highways adjoining or through said property, with the right to permit the attachment of wires and cables of any other person or company for communication purposes or for the transmission and distribution of electric power, and the right of ingress and egress to said premises at all times for the purpose of inspecting and maintaining said line, and with the right to clear and keep cleared all trees, undergrowth or other obstructions within a strip of land 1 foot on each side of the center of said line, and to trim and cut and keep trimmed and cut, all dead, weak, leaning or dangerous trees which might reach said line in falling, including the right to relocate said line on said premises to conform to any future highway relocation, widening or improvement.

Signed, sealed and delivered in the presence of:

Executed June 11, 1980

Barbara Davidson  
Witness

N. Lee Cooper Seal  
James L. Hubbard, Agent  
Name of Corporation

Attest: \_\_\_\_\_  
Corporate Officer

By: \_\_\_\_\_  
Title: \_\_\_\_\_

(CORPORATE SEAL)

KEY  
\* EXISTING APPO. POLE  
X PROPOSED SCB GUY AND ANCHOR.

688 300 822 X008

STATE OF ALA. SHELBY CO.  
I CERTIFY THIS  
PERMIT WAS FILED  
1980 OCT -2 AM 9:42  
[Signature]  
JUDGE OF PROBATE