



19800529000058550 Pg 1/2 00
Shelby Cnty Judge of Probate, AL
05/29/1980 00:00:00 FILED/CERTIFIED

Name and Post Office Address of Grantor Roy D. Jowers
P.O. Box 343
PELHAM, ALABAMA
Toll Line (Name)
Exchange Line ALABASTER
tributary to (Exchange)
The property is bounded where the line enters and leaves this property by the property of:
The poles (or stakes) have the following identification:
to
Authority, 034-2140 classification 91C
Area BIRMINGHAM, SOUTH ALABAMA
Approved W D McIlwain
Title DISTRICT MANAGER - OSP ENGR.
NORTH

See ATTACHED SHEET.

849

RIGHT-OF-WAY EASEMENT

FORM 8416 SC
MARCH, 1973

In consideration of the sum of money hereinafter set out and other good and valuable consideration, the adequacy and receipt of which is hereby acknowledged from the South Central Bell Telephone Company, the undersigned, owner(s) of the premises described below, do hereby grant to the South Central Bell Telephone Company, its licenses, agents, successors, assigns, and allied and associated companies, a right of way easement to construct, operate, maintain, add or remove such lines or systems of communications or related services as the grantee may require, consisting of:

- (1) poles, guys, anchors, aerial cables and wires;
- (2) ~~Buried cables and wires, cable terminals, markers, splicing boxes and pedestals;~~
- (3) ~~Conduits, manholes, markers, underground cables and wires;~~
- (4) ~~and other amplifiers, boxes, appurtenances or devices.~~

upon over and under a strip of land 30 feet wide across the following lands in SHELBY County, State of ALABAMA generally described as follows:

PARCEL OF LAND OWNED BY ROY D. JOWERS IN SECTION 20, TOWNSHIP 20 SOUTH, RANGE 2 WEST AS SHOWN ON ATTACHED SKETCH.

and, to the fullest extent the undersigned has the power to grant, if at all, over, along and under the roads, streets, or highways adjoining or through said property.

The following rights are also granted: to allow any other person or company to attach wires or lay cable or conduit within the right of way for communications or electric power transmission or distribution; ingress and egress to said premises at all times; to clear the land and keep it clear of all trees, undergrowth or other obstructions within the easement area; to trim and cut and keep trimmed and cut all dead, weak, leaning or dangerous trees or limbs outside of the easement area which might interfere with or fall upon the lines or systems of communications or power transmission or distribution.

The receipt of ONE and NONE /100 Dollars (\$1.00) is hereby acknowledged by the undersigned.

To have and to hold the above granted easement unto South Central Bell Telephone Company, its successors and assigns forever.

IN WITNESS WHEREOF, the undersigned has signed and sealed this document on APRIL 15, 1980 caused this instrument to be executed by its duly authorized agent

Signed, sealed and delivered in the presence of:

Roy D. Jowers L.S.

Witness

Charles R. Blackburn, Jr. L.S.

Name of Corporation

Attest

By:

So. Central Bell Corporate Officer 200 Eastern Ave Title: 35/50

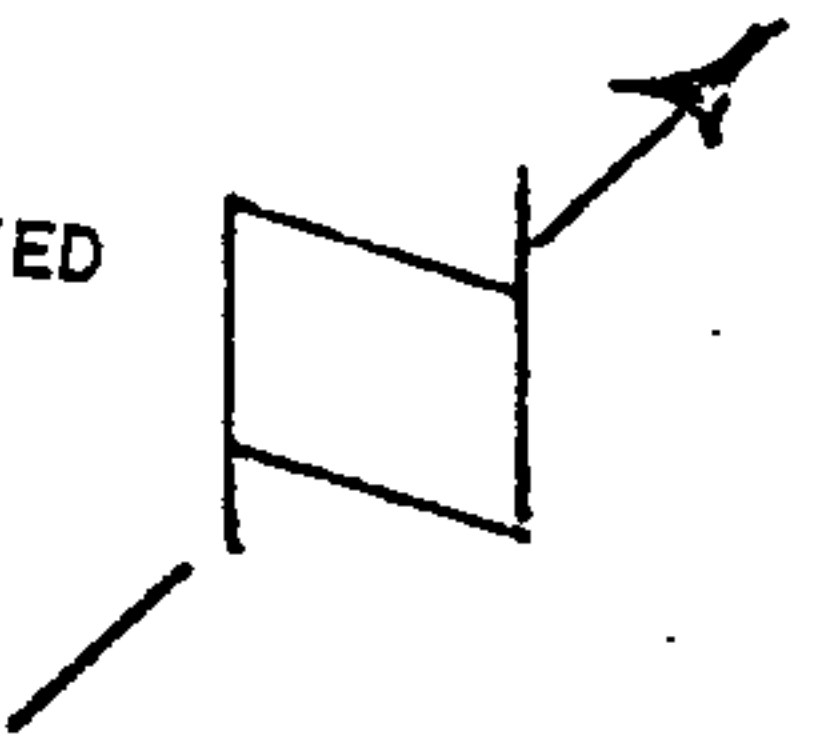

BOOK 326 PAGE 582

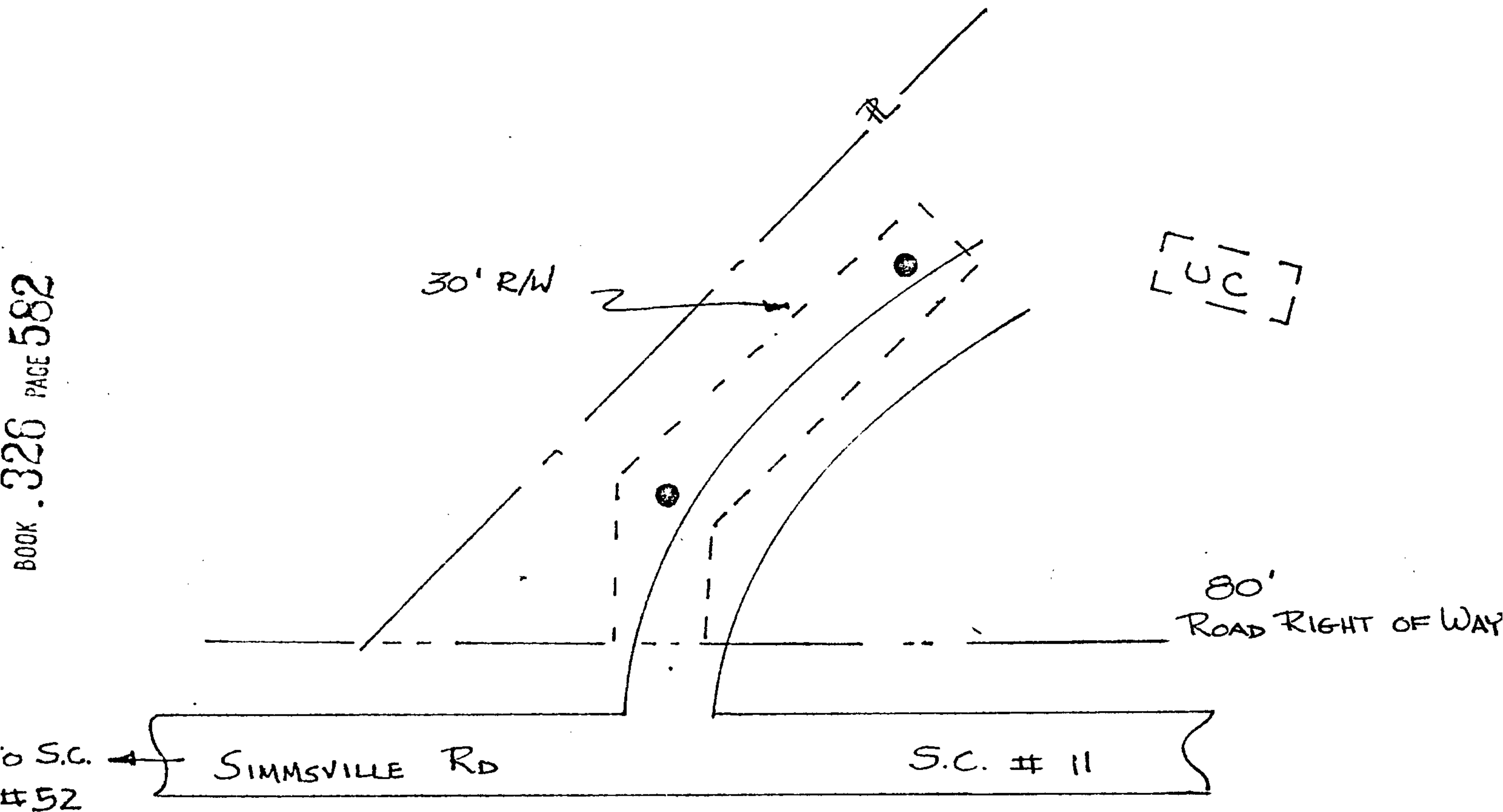

S.C. # 52

SIMMSVILLE RD

S.C. # 11

* *

STATE OF ALA. SHELBY CO.
I CERTIFY THIS
1980 MAY 29 AM 9:30

Goodman, S.O.
Rec. 300
Ad. 100
450

— KEY —

Shelby C. Shumaker, Jr.
JUDGE OF PROBATE

- * EXISTING APC₆ POLE
- * PROPOSED APC₆ POLE
- PROPOSED SCB POLE