

6010

0460 090001 000

STATE OF Alabama ) Town Creek Apartments Phase II  
COUNTY OF Shelby ) West Columbiana District Sub.

861

408116

KNOW ALL MEN BY THESE PRESENTS, that the undersigned,

Jeff Falkner + Frank R. Griffith  
a partnership

in consideration of the sum of One and No/100 Dollars (\$1.00), to US  
in hand paid by Alabama Power Company, a corporation, the receipt whereof  
is acknowledged, do hereby grant to said Alabama Power Company, its  
successors and assigns, the right to construct, install, operate and main-  
tain, and the right to permit other corporations and persons to construct,  
install, operate and maintain, along routes to be selected by the grantee,  
(generally shown crosshatched on the attached drawing) its successors or  
assigns, all poles, wires, conduits, cables, trans closures and other appli-  
ances and facilities useful or necessary in connection therewith for the  
overhead and underground transmission and distribution of electric power  
and for the overhead and underground communication service, upon, over,  
under and across the following described land, situated in Shelby  
County, Alabama:

5 acres more or less - sec. 26, T2S, R1W bounded as follows: North by the  
public Road, and East, South and West  
by lands belonging to Frank R. Griffith.

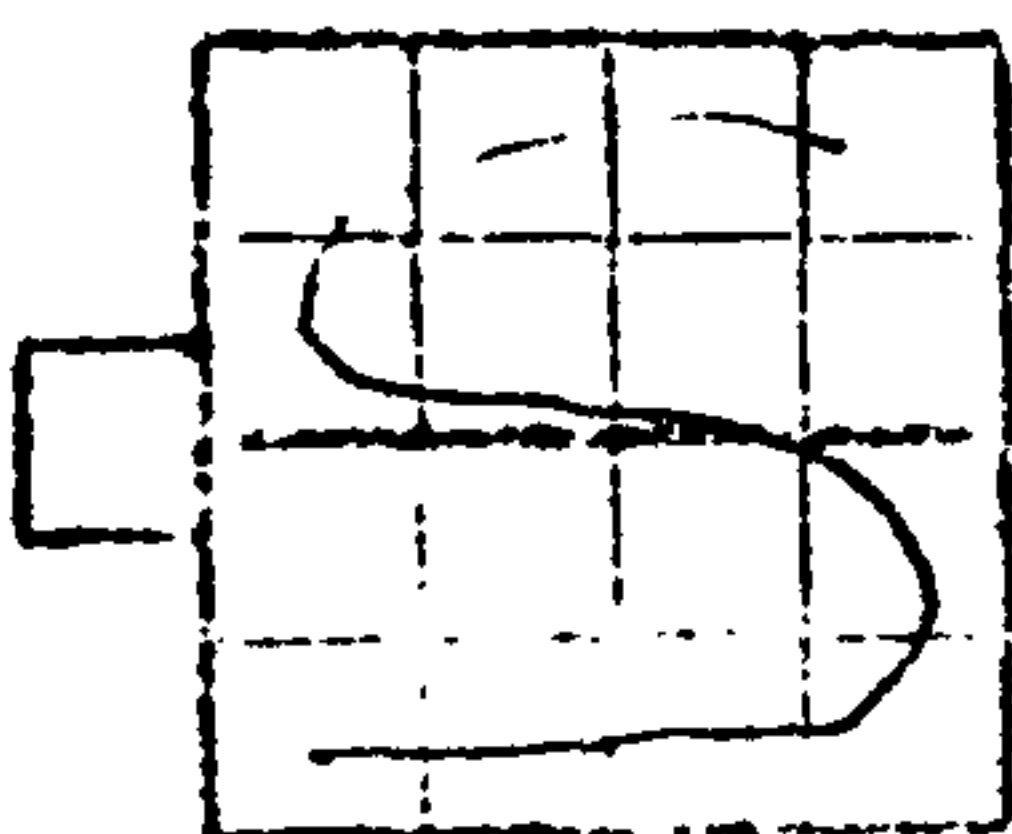

S 26, T2S, R1W

This instrument prepared in  
the Probate Real Estate  
Office of Alabama Power Co.  
Birmingham, AL  
By R.C. Coggin

BOOK 325 PAGE 136

BOOK 325 PAGE 137

Together with all the rights and privileges necessary or convenient for the full enjoyment or use thereof, including the right of ingress and egress to and from said facilities and the right to excavate for installation, replacement, repair and removal thereof; and also the right to cut and keep clear all trees, underbrush, shrubbery, roots and other growth, and to keep clear any and all obstructions or obstacles of whatever character on, under or above said facilities.

TO HAVE AND TO HOLD the same to the said Company, its successors and assigns, forever.

IN WITNESS WHEREOF, we have hereunto set our hands and seals, this the 23rd day of January, 19 80.

WITNESS:

Janet. W. Winkler  
[Signature]

✓ [Signature] (Seal)

✓ [Signature] (Seal)

✓ \_\_\_\_\_ (Seal)

✓ \_\_\_\_\_ (Seal)

STATE OF Alabama

COUNTY OF Shelby

I, Willis Hittelman, a Notary Public, in and  
for said County in said State, hereby certify that Left Falkner  
and Frank R. Griffin a Partnership  
whose name Sam signed to the foregoing instrument and who Sam  
known to me, acknowledged before me on this day that being informed of the  
contents of the instrument They executed the same voluntarily, on the  
day the same bears date.

Given under my hand and official seal, this the 23  
day of January, 19 80.

Notary Public Seal



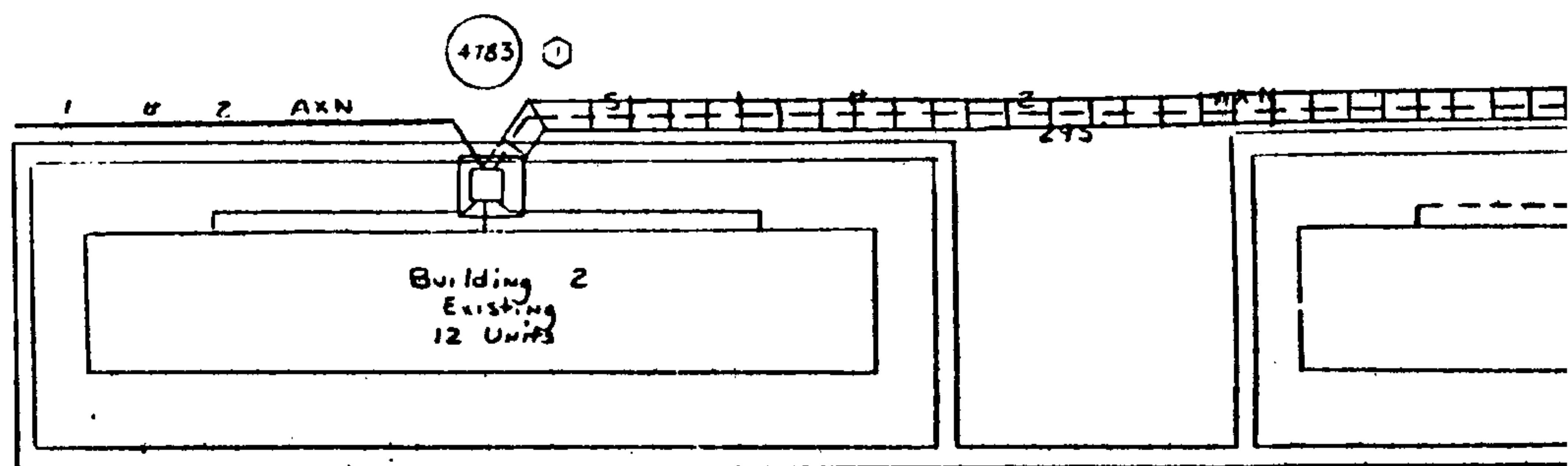

#### Alabama Power Company Responsibilities

1. Install up to 300 ft of underground primary cable per pad mounted transformer location. This includes cost of trenching, cable, and installation, backfilling trench, and installing conduit under paved areas. If paved areas is 50 ft. or less and can be bored under, the conduit shall be omitted.
2. Install pads and pad mounted transformers.
3. Install service laterals in customer owned and installed conduit from the pad mounted transformers to be the customers meter location.

#### Customer Responsibilities

1. Provide rights of way with agreements to reimburse Alabama Power Company for costs of relocating its facilities.
2. Install and own all service entrance equipment. Customer owned multiple meter breaker panels must be approved by the superintendent of meters prior to installation.
3. Excess trenching costs plus cost of all installed cable over 300 ft per transformer location.
4. Notify Alabama Power Company in writing 30 days prior to paving areas that must be trenched.
5. Provide and install protective barriers for transformer locations when necessary.
6. Install and own secondary conduit from transformer location to meter location. Conduit shall conform to APCo requirements as to type, size, depth, and location.

Map Ref.

Sec 26, T-2

S-75KVA 7.2KV Padmount  
CL-69KW

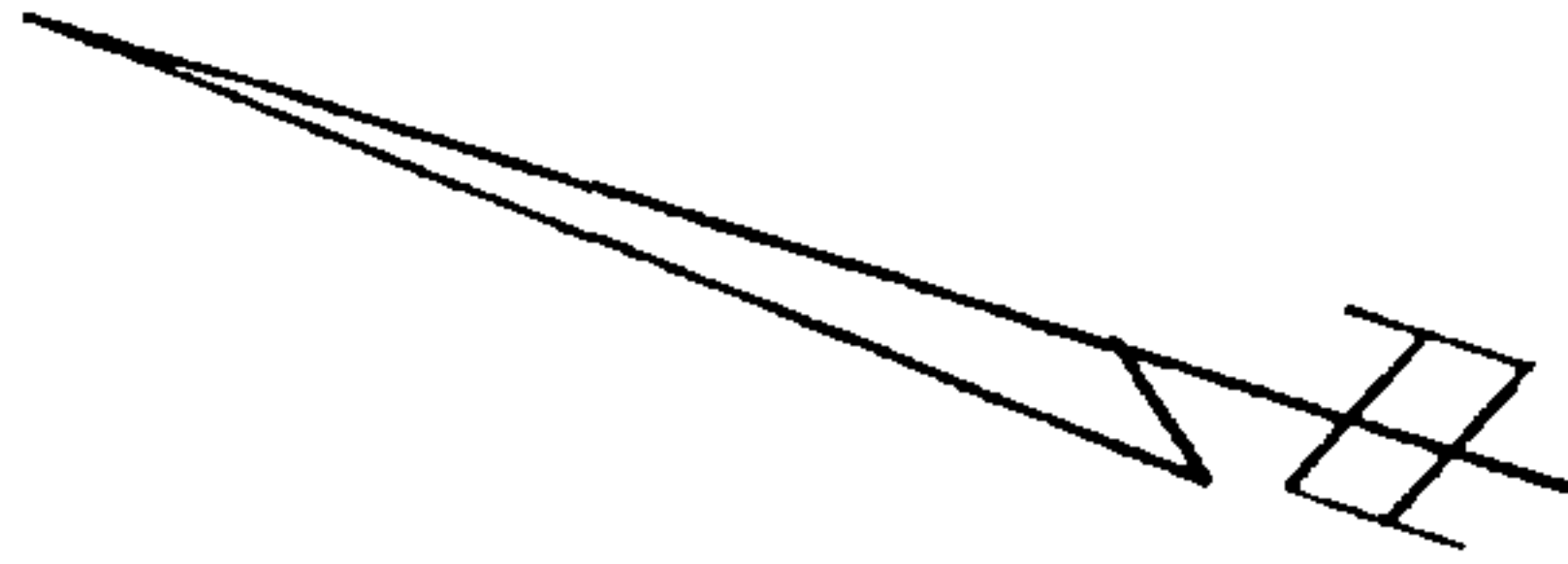

Typical Load Each Unit  
LFRWD 1 1/2 TAC 7 KW HT

19800226000022790 Pg 5/5 .00  
Shelby Cnty Judge of Probate, AL  
02/26/1980 00:00:00 FILED/CERTIFIED

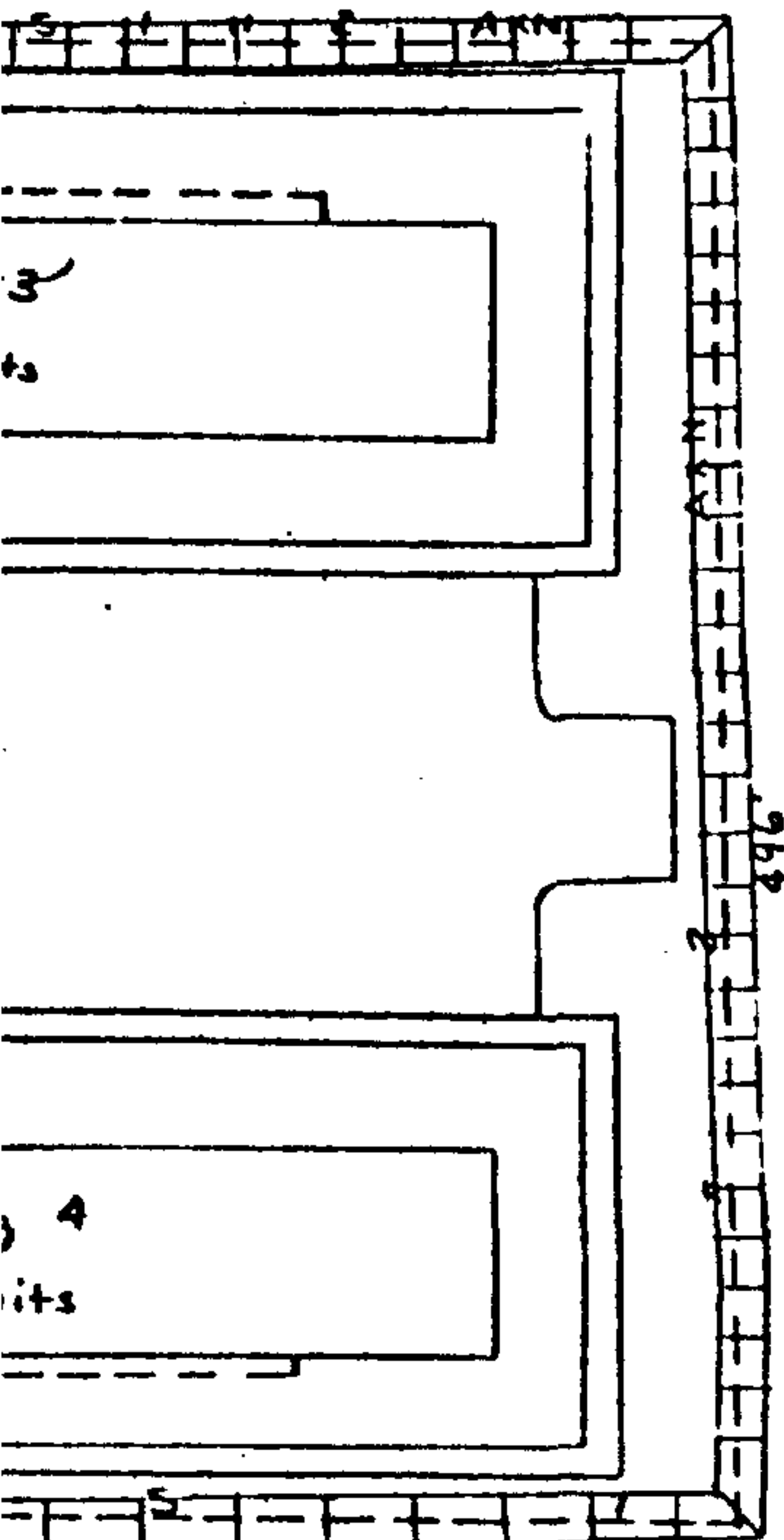

Service Lateral  
To Each 4 Gang Meter Socket - 1 # 4/0 { 2 # 500 MCM AL

Note : Developer charged for excess trenching  
Cost on Phase I.

S-75 KVA 7.2KV Padmount  
CL-69 KW

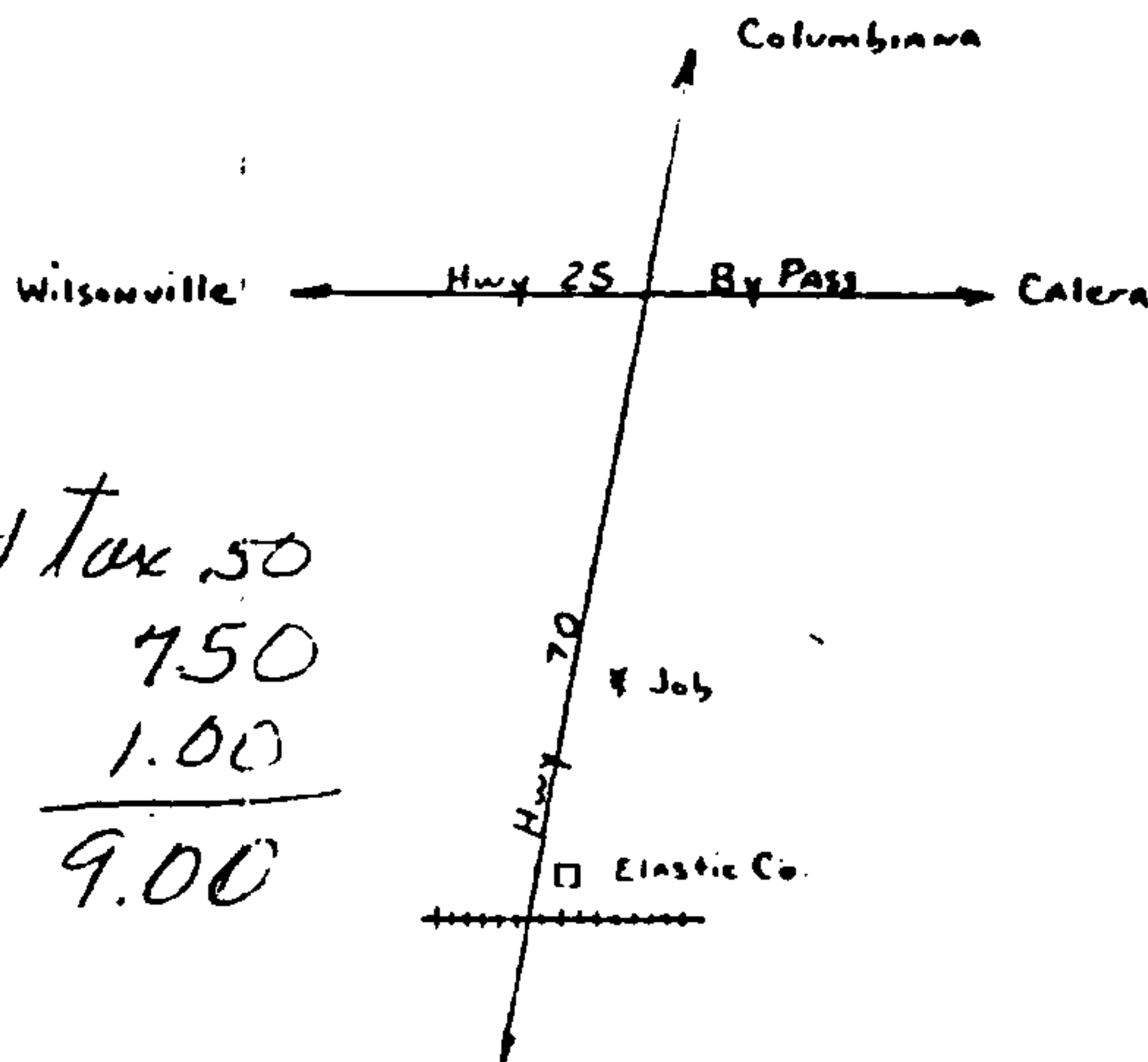

STATE OF ALA. SHELBY CO.  
JUDGE OF PROBATE

1980 FEB 26 PM 3:30

deed tax so  
rec. 750  
ind 1.00  
9.00

BOOK 325 PAGE 140

JUDGE OF PROBATE

0460 09 0001 220

### ALABAMA POWER COMPANY

JOB West Columbiana District 12KV Distribution  
DETAIL Provide U.G Service to 2nd Phase of  
Town Creek Apartments in Columbiana

SCALE N.T.S. B/M

SHEET 1 OF 1 SHEETS  
SUPERSEDES

F-461-05

DRAWN Mobley 12-10-79  
CHECKED \_\_\_\_\_ TRACED \_\_\_\_\_  
APPROVED \_\_\_\_\_ DATE \_\_\_\_\_  
APPROVED \_\_\_\_\_ DATE \_\_\_\_\_

1 Copy