

Name and
Post Office Address
of Grantor REALTY BROKERS, Inc
5355 CROFTS AVENUE
BIRMINGHAM, ALABAMA
Line (Name)
or
Exchange Line CAMERA HEIGHTS
tributary to (Exchange)
The property is bounded where the line enters
and leaves this property by the property of:
of the
The poles (or stakes) have the following
identification:
P-
to P-
Authority 934-8040B classification 91C
Area BIRMINGHAM SOUTH
Approved 10/10/79
Title DISTRICT MANAGER - OSP ENG.
NORTH

SKETCH IS AN ATTACHED

SHEET.

RIGHT-OF-WAY EASEMENT

FORM 8416 SC
MARCH, 1973

In consideration of the sum of money hereinafter set out and other good and valuable consideration, the adequacy and receipt of which is hereby acknowledged from the South Central Bell Telephone Company, the undersigned, owner(s) of the premises described below, do hereby grant to the South Central Bell Telephone Company, its licenses, agents, successors, assigns, and allied and associated companies, a right of way easement to construct, operate, maintain, add or remove such lines or systems of communications or related services as the grantee may require, consisting of:

- (1) poles, guys, anchors, aerial cables and wires;
CRB (2) ~~Buried cables and wires, cable terminals, markers, splicing boxes and pedestals;~~
CRB (3) ~~Conduits, manholes, markers, underground cables and wires;~~
CRB (4) ~~and other amplifiers, boxes, appurtenances or devices~~

upon over and under a strip of land 30 feet wide across the following lands in JEFFERSON County, State of ALABAMA generally described as follows:

THE PARCEL OF LAND THAT
IS SHOWN ON THE ATTACHED SHEET LOCATED N.E. 1/4 OF S.E. 1/4 OF
SECTION 15, TOWNSHIP 18 SOUTH, RANGE 2 WEST.

and, to the fullest extent the undersigned has the power to grant, if at all, over, along and under the roads, streets, or highways adjoining or through said property.

The following rights are also granted: to allow any other person or company to attach wires or lay cable or conduit within the right of way for communications or electric power transmission or distribution; ingress and egress to said premises at all times; to clear the land and keep it cleared of all trees, undergrowth or other obstructions within the easement area; to trim and cut and keep trimmed and cut all dead, weak, leaning or dangerous trees or limbs outside of the easement area which might interfere with or fall upon the lines or systems of communications or power transmission or distribution.

The receipt of ONE and NONE /100 Dollars (\$1.00) is hereby acknowledged by the undersigned.

To have and to hold the above granted easement unto South Central Bell Telephone Company, its successors and assigns forever.

IN WITNESS WHEREOF, the undersigned has signed and sealed this document
on 8-28, 1979. caused this instrument to be executed by its
duly authorized agent

Signed, sealed and delivered in the presence of:

L.S.

Witness

L.S.

Charles R. Blackburn, Jr.

Realty Brokers, Inc.

Name of Corporation

Attest

By

Ronald H. Chan

Title:

Vice Pres.

Corporate Officer

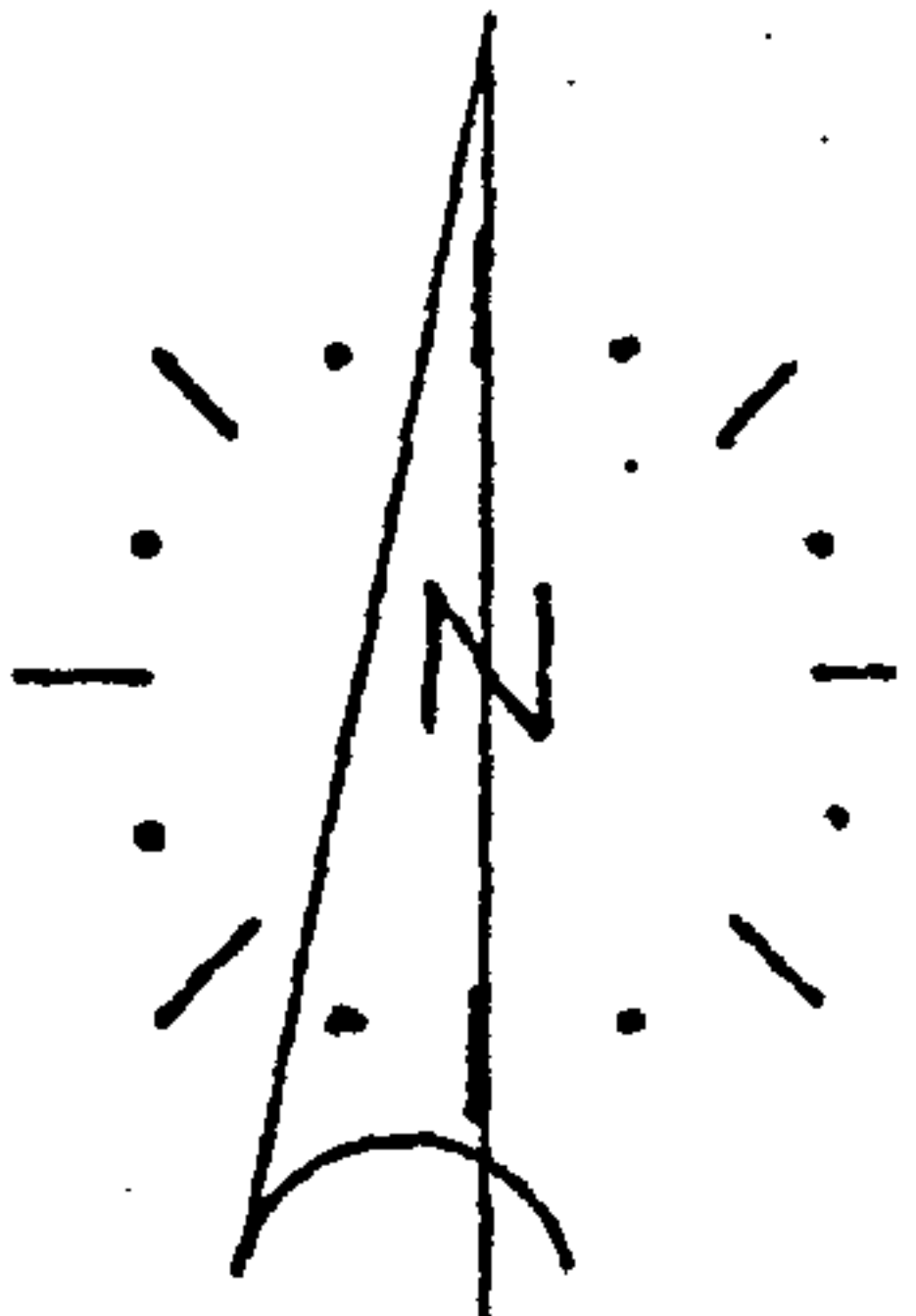

○ EXISTING SCB POLE

● PROPOSED SCB POLE

✱ PROPOSED SCB ANCHOR GUY

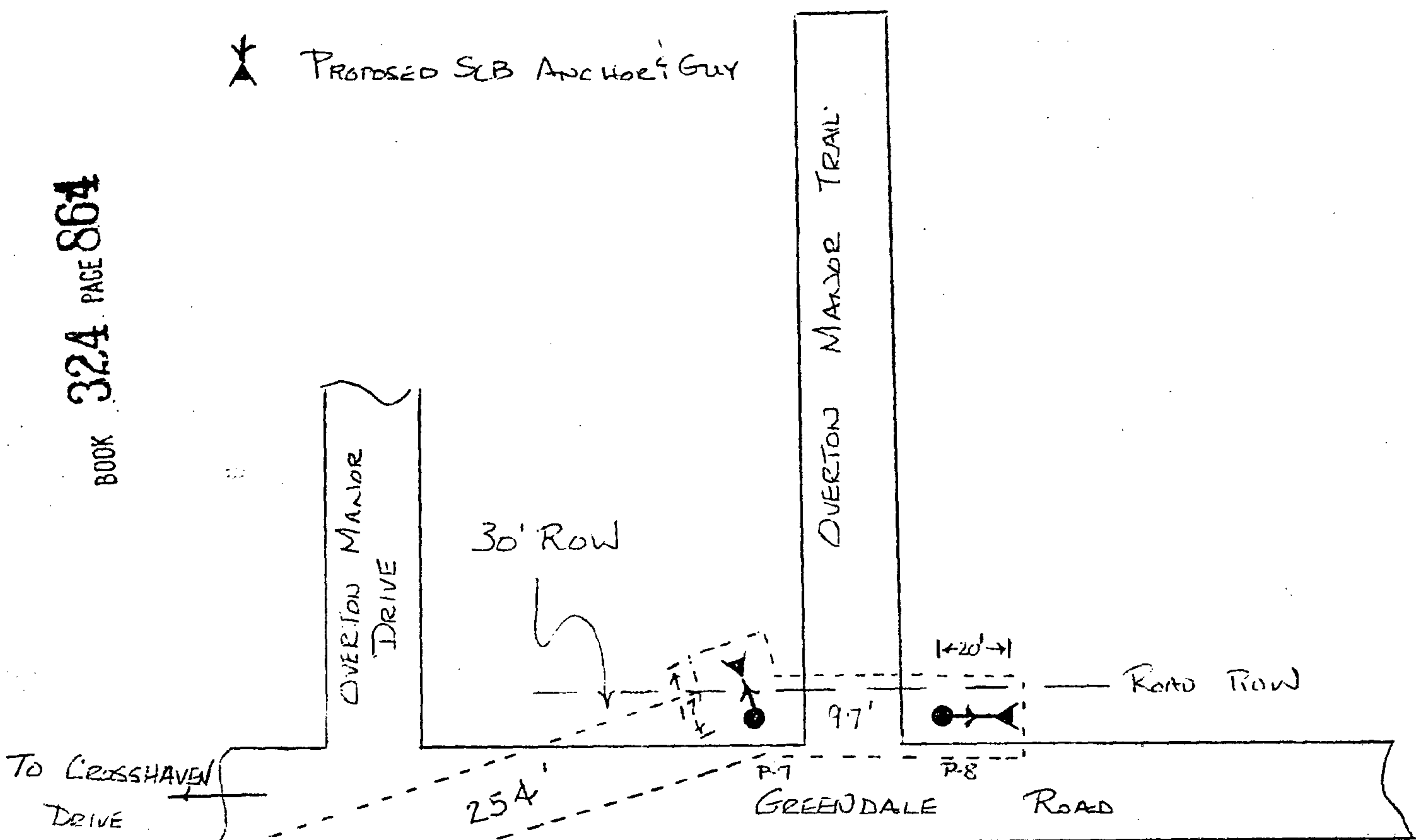

STATE OF ALA. SHELBY CO.

I CERTIFY THIS

DEED WAS FILED *Deed by - .50*

1980 FEB 12 AM 8:23



Rec. 3.00

Sub 1.00

4.50

William P. Sullivan, Jr.
JUDGE OF PROBATE

APPROVED: *	
DISTRICT MGR. - OSP ENGRG.	
DATE	19
DATE	19
GR. EXP.	
PLY. RET.	
SALVAGE	
MTCE.	
GR. ADDNS.	
N.Y. CAT.	

TAX DIST.							
							
RECORDS REF.							
	ISSUE	DATE	ENG.	APVD.	NATURE OF REVISION		
SOUTH CENTRAL BELL TELEPHONE CO.							
ZONE					ENG.	DFTM.	PROJ NO
CODE					APVD.	DATE	EST. OR J.C.
HV JU V To G							DWG. NO
SCALE							