



19790726000094750 1/2 \$.00
Shelby Cnty Judge of Probate, AL
07/26/1979 12:00:00AM FILED/CERT

Name and Post Office Address of Grantor Mr. C. R. Milstead
3153 Warrington Road
Birmingham, Alabama 35223

Toll Line (Name) _____
or _____
Exchange Line Cahaba Heights
tributary to _____ (Exchange)

The property is bounded where the line enters and leaves this property by the property of: _____ of the _____ of the _____

The poles (or stakes) have the following identification: _____

to _____

Authority 934-0096 classification 1-C

Area Birmingham-South

Approved OSP Milstead

Title District Manager OSP Engr.

NORTH

115-3

See Attached Sketch

— Key —

● Proposed Pole

— 2-CRW-1 — Service Wire

RIGHT-OF-WAY EASEMENT

FORM 8416 SC
MARCH, 1973

In consideration of the sum of money hereinafter set out and other good and valuable consideration, the adequacy and receipt of which is hereby acknowledged from the South Central Bell Telephone Company, the undersigned, owner(s) of the premises described below, do hereby grant to the South Central Bell Telephone Company, its licenses, agents, successors, assigns, and allied and associated companies, a right of way easement to construct, operate, maintain, add or remove such lines or systems of communications or related services as the grantee may require, consisting of:

- (1) poles, guys, anchors, aerial cables and wires;
- (2) Buried cables and wires, cable terminals, markers, splicing boxes and pedestals;
- (3) Conduits, manholes, markers, underground cables and wires;
- (4) and other amplifiers, boxes, appurtenances or devices

upon over and under a strip of land 15 feet wide across the following lands in Jefferson County, State of Alabama generally described as follows:

Redstone Forest Subdivision, First Sector - Third Addition

and, to the fullest extent the undersigned has the power to grant, if at all, over, along and under the roads, streets, or highways adjoining or through said property.

The following rights are also granted: to allow any other person or company to attach wires or lay cable or conduit within the right of way for communications or electric power transmission or distribution; ingress and egress to said premises at all times; to clear the land and keep it cleared of all trees, undergrowth or other obstructions within the easement area; to trim and cut and keep trimmed and cut all dead, weak, leaning or dangerous trees or limbs outside of the easement area which might interfere with or fall upon the lines or systems of communications or power transmission or distribution.

The receipt of One and No /100 Dollars (\$1.00) is hereby acknowledged by the undersigned.

To have and to hold the above granted easement unto South Central Bell Telephone Company, its successors and assigns forever.

IN WITNESS WHEREOF, the undersigned has signed and sealed this document on 3-1, 1979, caused this instrument to be executed by its duly authorized agent

Signed, sealed and delivered in the presence of:

Witness _____

Attest _____
Corporate Officer

Eunice B. Milstead L.S.
Clinton Romistana L.S.

Name of Corporation
By _____
Title: _____

BOOK 320
PAGE 922

LOCATION SKETCH

734-0096

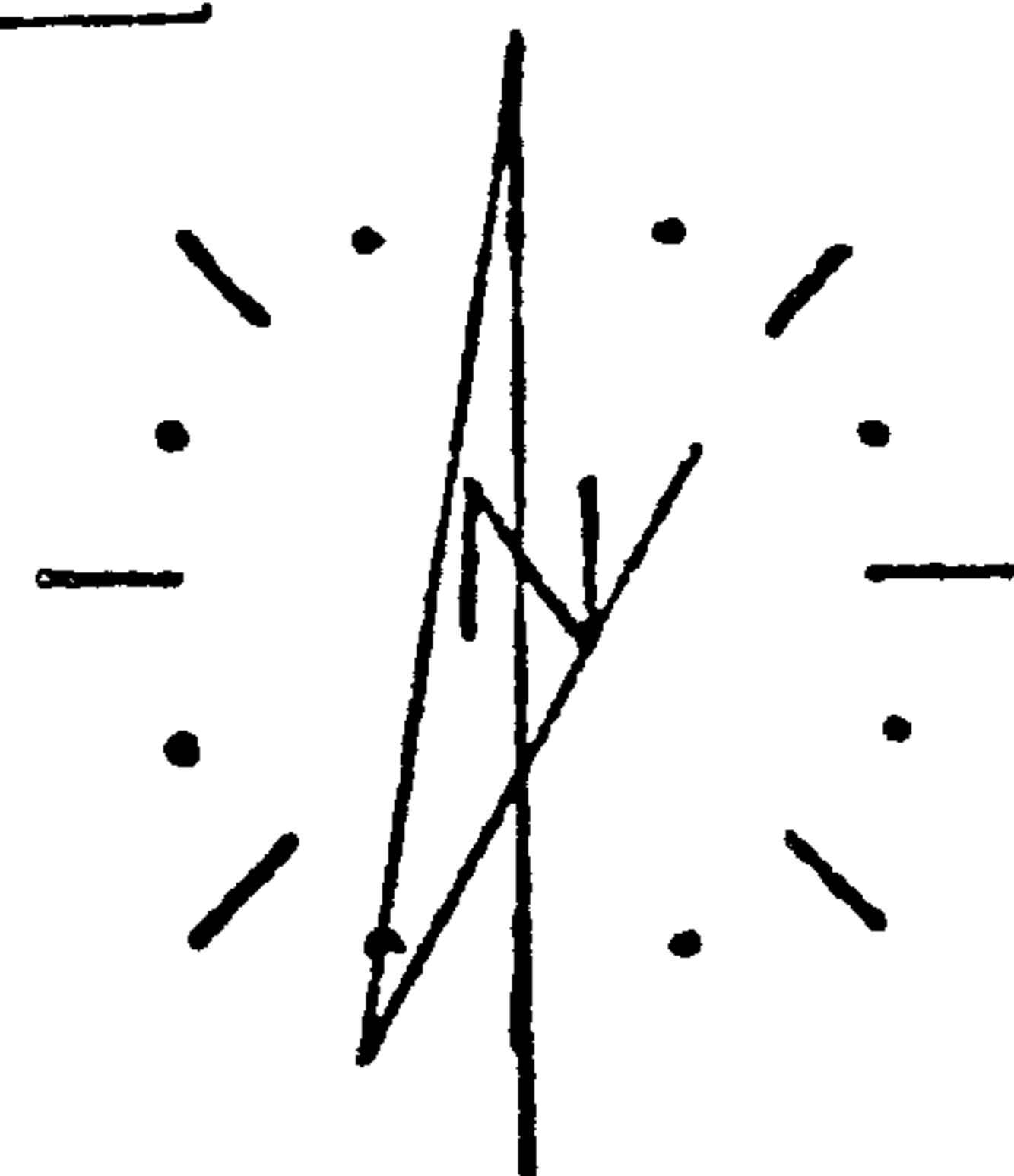
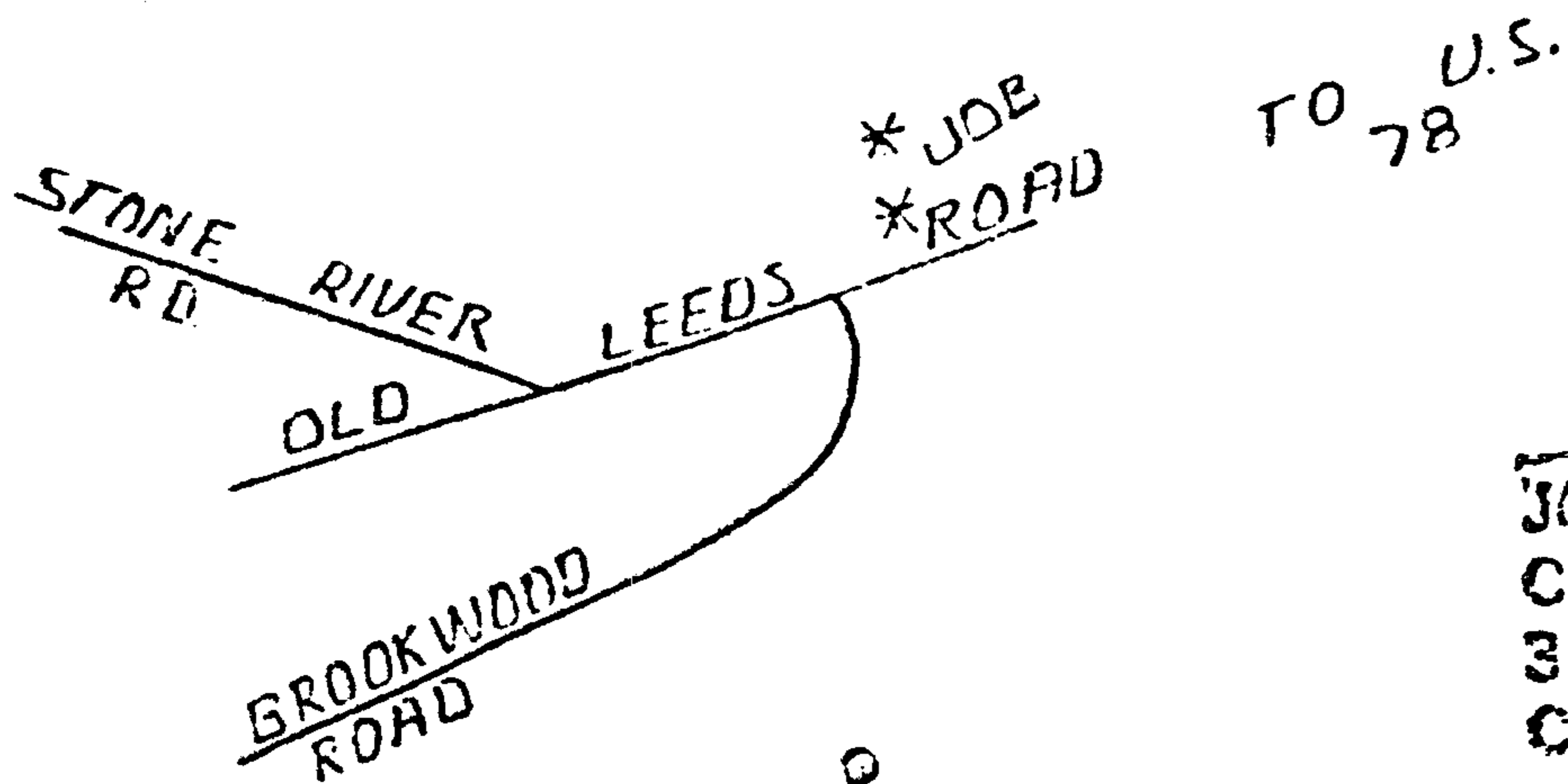

4700
(U.C.)

CAUTION
CHECK FOR DEFECTIVE
POLES BEFORE CLIMBING

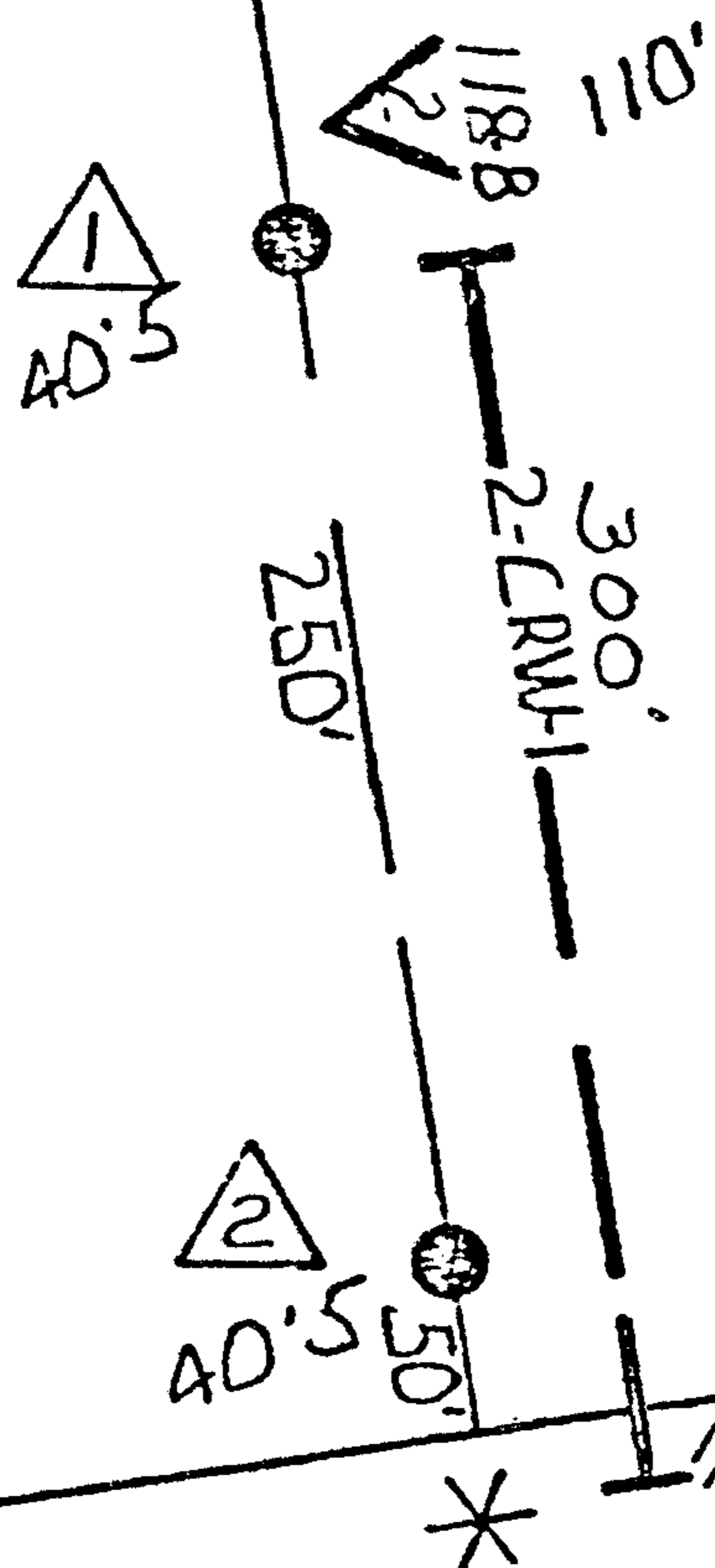

F# 4700
26.50
NC-25
401

BHAA-50
401, 1-50

OLD LEEDS ROAD

-NOTE-

PLACE C-WIRE AT
DOUBLE RECOMMENDED
SAG.

CAUTION! HIGH
VOLTAGE 7.2 KV.

APPROVED: *	
DISTRICT MGR. - OSP ENGRG.	
DATE	19
FILE	
DATE	1-26 1979
Gr. 32	1001
PLT. RET.	---
SALVAGE	---
MTCE.	---
GR. ADDNS.	1001
N.Y. CAT.	G-10

TAX DIST.	03731				
RECORDS REF.	2203				
ISSUE	DATE	ENG.	APVD.	NATURE OF REVISION	
SOUTH CENTRAL BELL TELEPHONE CO.					
ZONE	BIRMINGHAM (SOUTH) ALABAMA	ENG.	DRB	DTM.	PROJ. NO.
TLR	CAHABH HEIGHTS	APVD.	DATE	EST. OR J.O.	934-0096
AN	PLACE POLES & C-WIRE TO SERVE NEW HOME			DWG. NO.	10F1
CODE	14.4				
HV JU	7.2	NO SCALE			



19790726000094750 2/2 \$.00
Shelby Cnty Judge of Probate, AL
07/26/1979 12:00:00AM FILED/CERT

BOOK 320 PAGE 923

STATE OF ALA. SHE
I CERTIFY T

1979 JUL 26 PM

JUDGE OF PROBATE

dec'd for 50
rec 2.00
net 1.00
450