

11
PARTIAL RELEASE OF REAL PROPERTY FROM LIEN OF A MORTGAGE

STATE OF ALABAMA)

KNOW ALL MEN BY THESE PRESENTS:

SHELBY COUNTY)

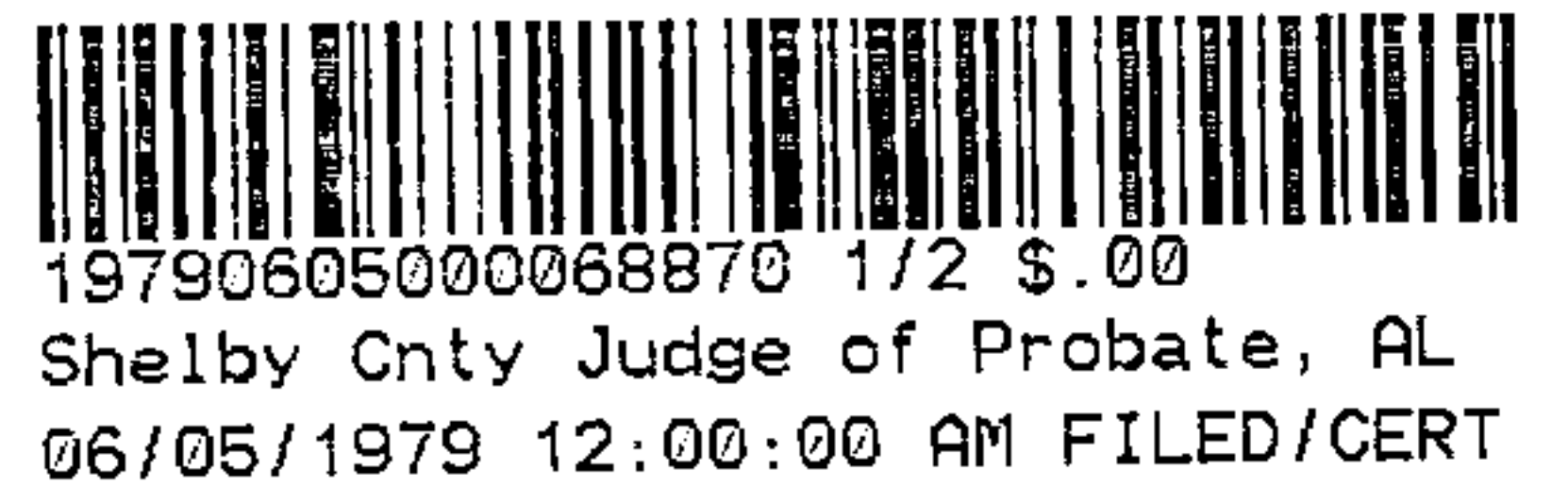

That for an in consideration of the sum of One (\$1.00), to the undersigned PELHAM INDUSTRIAL PARK INC., in hand paid by Cornerstone Properties Inc., the receipt and sufficiency whereof is hereby acknowledged, the said Pelham Industrial Park Inc., does hereby release and discharge from that certain mortgage recorded in Mortgage Book 382, Page 76 in the Probate Office, the following described real property, situated in Shelby County, Alabama viz:

A parcel of land located in the Northwest 1/4 of the Southeast 1/4 of Section 14, Township 20 South, Range 3 West, Shelby County, Alabama, more particularly described as follows: Commence at the Southwest corner of said 1/4-1/4 Section; thence in a Northerly direction, along the West line of said 1/4-1/4 Section, a distance of 461.07 feet to a point on the Southeasterly Right of Way Line of Parker Drive; thence 41 degrees 28 minutes 50 seconds right, in a Northeasterly direction along said Right of Way Line, a distance of 46.66 feet to the Point of Beginning; Thence 106 degrees 27 minutes 00 seconds right, in a Southeasterly direction, a distance of 130.33 feet; thence 73 degrees 33 minutes 00 seconds right, in a Southwesterly direction, a distance of 130 feet, more or less, to a point on the Northeast bank of Buck Creek; thence in a Northwesterly direction along said Northeast bank of Buck Creek, a distance of 135 feet, more or less, to a point on the Southeast Right of Way Line of Parker Drive (extended); thence in a Northeasterly direction, along said Southeast Right of Way Line, a distance of 105 feet, more or less, to the Point of Beginning.

But this release is given under the following express condition:

That said mortgage shall be and remain valid and subsisting lien against all of the remaining real property conveyed therein and not heretofore released.

IN TESTIMONY WHEREOF, Pelham Industrial Park Inc., has caused its seal to be hereto affixed, and these presents to be executed by Owen F. Parker, its President, who is thereunto lawfully authorized, all on this the 29th day of May, 1979.

PELHAM INDUSTRIAL PARK INC.,

ATTEST:

Delano Morris
Secretary

By: Owen F. Parker (SEAL)
Owen F. Parker Its President

STATE OF ALABAMA)

SHELBY COUNTY)

I, C.B. Holliman, a Notary Public in and for said County, in said State, do hereby certify that Owen F. Parker, whose name as President of Pelham Industrial Park, Inc., is signed to the foregoing release, and who is known to me, acknowledged before me on this day, that, being informed of the contents of said release he in his capacity as such President, executed the same voluntarily for and as the act of said corporation, on the day the same bears date.

Witness my hand and official seal this the 29th day of May, 1979.

C.B. Holliman
Notary Public



19790605000068870 2/2 \$.00
Shelby Cnty Judge of Probate, AL
06/05/1979 12:00:00 AM FILED/CERT

SOUTHWEST CORNER OF THE
NW 1/4 OF THE S 1/4 OF SEC 4 T 25 N R 10 E

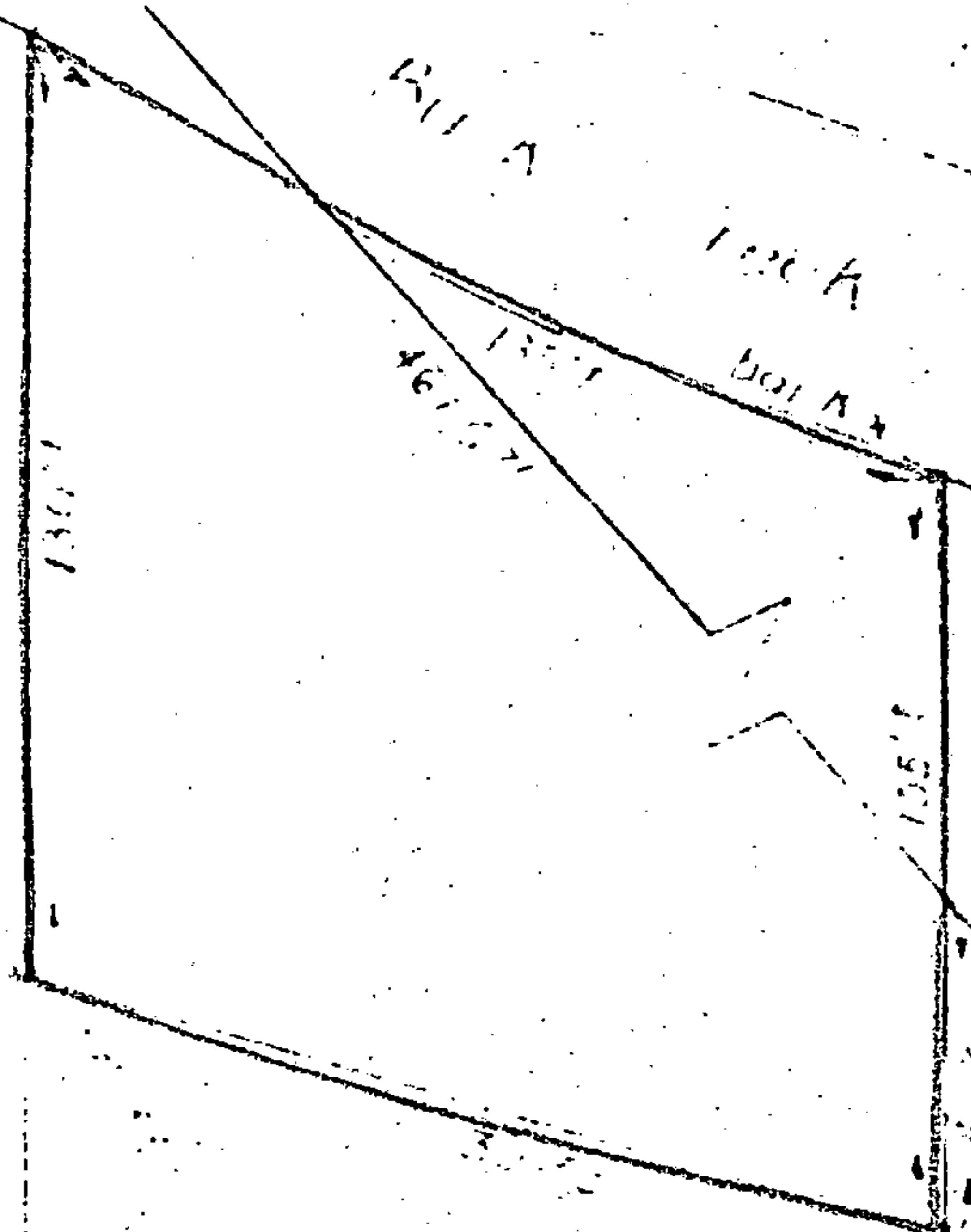

STATE OF ALA. SHELBY CO.

18.9 JUN '5 AM 9:24

Thomas L. Thompson, Jr.
JUDGE OF PROBATE
Rec. 3.00
Ind. 1.00
4.00