

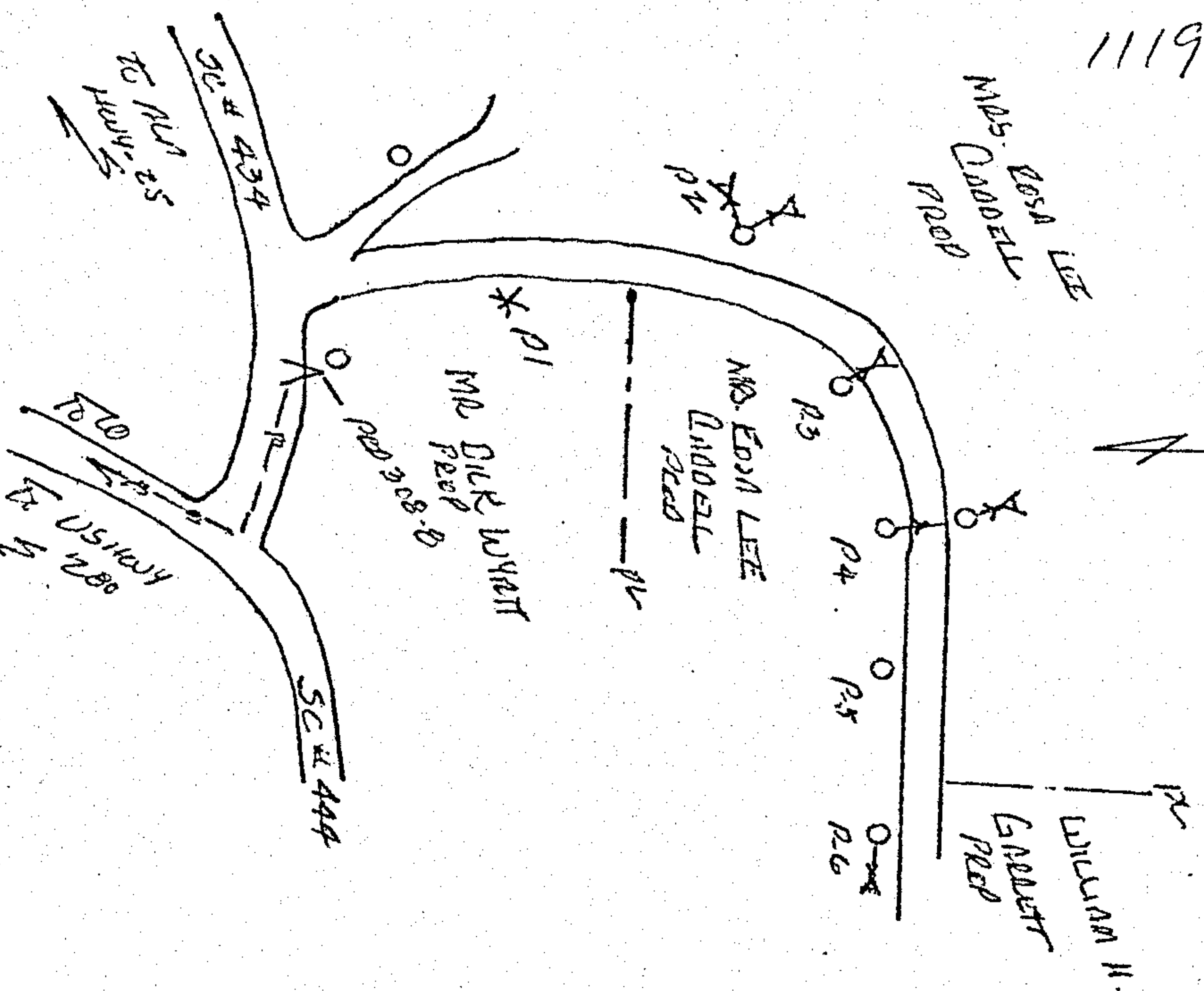

19780824000112580 1/1 \$.00
Shelby Cnty Judge of Probate, AL
08/24/1978 12:00:00AM FILED/CERT



Name and Post Office Address of Grantor MRS ROSA LEE CADDLE
Line ROUTE 1 (Name)
Toll ANNEXVILLE RD 35078
Exchange Line VINEYARD or (Exchange)
tributary to
The property is bounded where the line enters and leaves this property by the property of:
SEE SKETCH ESTATE of the
The poles (or stakes) have the following identification:
SEE SKETCH ESTATE
to SEE SKETCH ESTATE
Authority 834-3049 classification 91C
Area 1.11
Approved [Signature]
Title District Manager-OSP Engrg.

RIGHT-OF-WAY EASEMENT

FORM 8416 SC
MARCH, 1973

In consideration of the sum of money hereinafter set out and other good and valuable consideration, the adequacy and receipt of which is hereby acknowledged from the South Central Bell Telephone Company, the undersigned, owner(s) of the premises described below, do hereby grant to the South Central Bell Telephone Company, its licenses, agents, successors, assigns, and allied and associated companies, a right of way easement to construct, operate, maintain, add or remove such lines or systems of communications or related services as the grantee may require, consisting of:

- (1) poles, guys, anchors, aerial cables and wires;
- (2) Buried cables and wires, cable terminals, markers, splicing boxes and pedestals;
- (3) Conduits, manholes, markers, underground cables and wires;
- (4) and other amplifiers, boxes, appurtenances or devices

upon over and under a strip of land 15 feet wide across the following lands in SHELBY County, State of ALABAMA generally described as follows:

IN SECTION 32 TOWNSHIP 19 S RANGE 2 EAST
OFF SHELBY COUNTY ROAD NO. 434

and, to the fullest extent the undersigned has the power to grant, if at all, over, along and under the roads, streets, or highways adjoining or through said property.

The following rights are also granted: to allow any other person or company to attach wires or lay cable or conduit within the right of way for communications or electric power transmission or distribution; ingress and egress to said premises at all times; to clear the land and keep it cleared of all trees, undergrowth or other obstructions within the easement area; to trim and cut and keep trimmed and cut all dead, weak, leaning or dangerous trees or limbs outside of the easement area which might interfere with or fall upon the lines or systems of communications or power transmission or distribution.

The receipt of ONE and NO /100 Dollars (\$1.00) is hereby acknowledged by the undersigned.

To have and to hold the above granted easement unto South Central Bell Telephone Company, its successors and assigns forever.

IN WITNESS WHEREOF, the undersigned Ha signed and sealed this document caused this instrument to be executed by its duly authorized agent on MAY 2, 1978

Signed, sealed and delivered in the presence of: x Rosa Lee Caddell L.S.

Witness [Signature] L.S.

Attest: [Signature] Name of Corporation
By: [Signature] Title: [Signature]

BOOK 314 PAGE 509

Corporate Officer
Deed 50
Rec. 1.50
Ind. 1.00
3.00