

Name and  
Office Address  
of Grantor

Toll  
Line  
(Name)

Exchange Line  
or  
tributary to (Exchange)

The property is bounded where the line enters  
and leaves this property by the property of:

SEE SKETCH of the  
The poles (or stakes) have the following  
identification:

SEE SKETCH below  
to SEE SKETCH below  
Authority 834-4010 classification 51C  
Area  
Approved  
Title District Manager-OSP Engrg.

NORTH

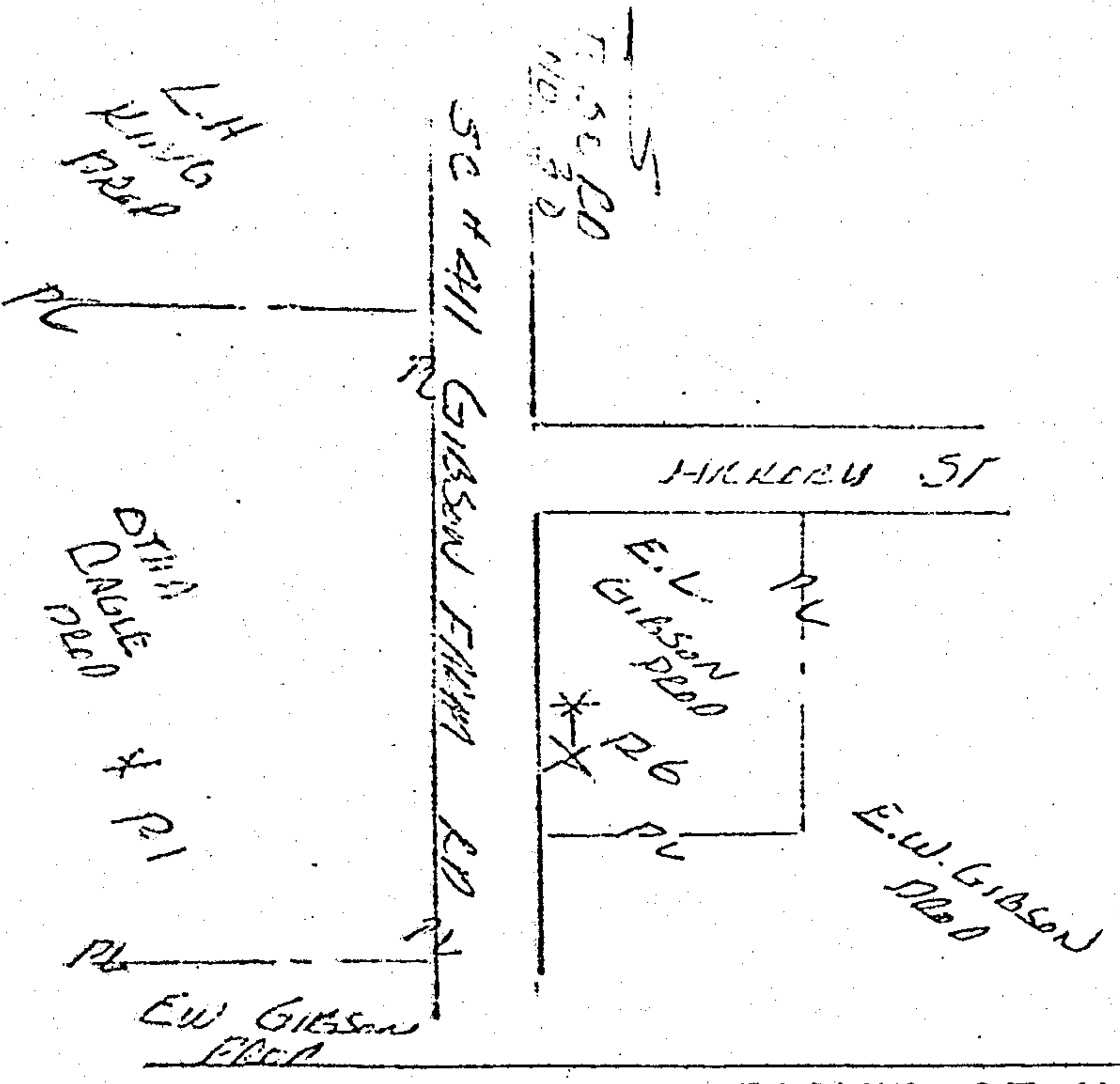

### RIGHT-OF-WAY EASEMENT

FORM 8416 SC  
MARCH, 1973

In consideration of the sum of money hereinafter set out and other good and valuable consideration, the adequacy and receipt of which is hereby acknowledged from the South Central Bell Telephone Company, the undersigned, owner(s) of the premises described below, do hereby grant to the South Central Bell Telephone Company, its licenses, agents, successors, assigns, and allied and associated companies, a right of way easement to construct, operate, maintain, add or remove such lines or systems of communications or related services as the grantee may require, consisting of:

- (1) poles, guys, anchors, aerial cables and wires;
- (2) Buried cables and wires, cable terminals, markers, splicing boxes and pedestals;
- (3) Conduits, manholes, markers, underground cables and wires;
- (4) and other amplifiers, boxes, appurtenances or devices

upon over and under a strip of land 15 feet wide across the following lands in SHELBY County, State of ALABAMA generally described as follows:

LOCATED BETWEEN SE CO. RD. NO. 411 IN SECTION 20 TOWNSHIP 21 SOUTH RANGE 1 EAST

and, to the fullest extent the undersigned has the power to grant, if at all, over, along and under the roads, streets, or highways adjoining or through said property.

The following rights are also granted: to allow any other person or company to attach wires or lay cable or conduit within the right of way for communications or electric power transmission or distribution; ingress and egress to said premises at all times; to clear the land and keep it cleared of all trees, undergrowth or other obstructions within the easement area; to trim and cut and keep trimmed and cut all dead, weak, leaning or dangerous trees or limbs outside of the easement area which might interfere with or fall upon the lines or systems of communications or power transmission or distribution.

The receipt of ONE and NO /100 Dollars (\$1.00) is hereby acknowledged by the undersigned.

To have and to hold the above granted easement unto South Central Bell Telephone Company, its successors and assigns forever.

IN WITNESS WHEREOF, the undersigned has signed and sealed this document caused this instrument to be executed by its  
on MARCH 4, 1978 duly authorized agent

Signed, sealed and delivered in the presence of: [Signature] L.S.

Witness E.W. Gibson L.S.

Attest: [Signature] By: [Signature] Title: [Signature] L.S.

Corporate Officer

Name of Corporation

Title: Doc. 50  
Rec. 1.50  
End. 1.00  
3.00



19780815000107350 1/1 \$ .00  
Shelby Cnty Judge of Probate, AL  
08/15/1978 12:00:00AM FILED/CERT

BOOK 314 PAGE 284