

STATE OF ALABAMA) Service to Riverchase Country Club 3rd Addition
COUNTY OF SHELBY) Valleydale Sub. 578

6010 017008 0027800

384580

KNOW ALL MEN BY THESE PRESENTS, that the undersigned,

THE HARBERT - EQUITABLE JOINT VENTURE

for and in consideration of the sum of One and No/100 Dollars (\$1.00), to
it in hand paid by Alabama Power Company, a corporation, the receipt
whereof is acknowledged, does hereby grant to said Alabama Power Company,
its successors and assigns, the right to construct, install, operate and maintain,
and the right to permit other corporations and persons to construct, install,
operate and maintain, along a route to be selected by the grantee, (generally shown
crosshatched on the attached drawing) its successors and assigns, all conduits,
cables, trans closures and other appliances and facilities useful or necessary in
connection therewith, for the underground transmission and distribution of electric
power and for underground communication service, upon, under and across the following
described land situated in Shelby County, Alabama:

See Exhibit "A" attached hereto and made a part hereof.

THIS INSTRUMENT WAS PREPARED BY:
NAME R.C. COGGIN - CORP. REAL EST
ADDRESS ALA. POWER CO. - BIRMINGHAM
SOURCE OF TITLE _____
BOOK _____ PAGE _____
SUBDIVISION LOT PLAT BK PAGE
QQ Q S T R

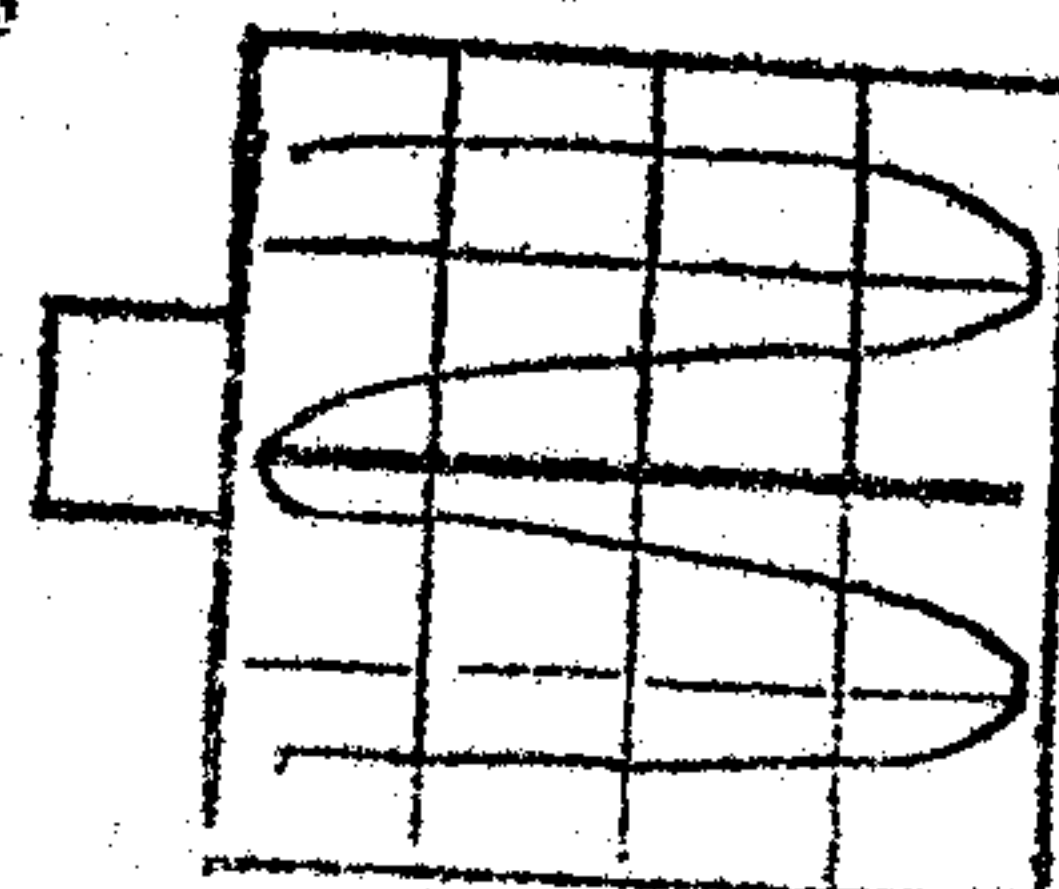

S35T19S R 3W



19780531000068300 1/10 \$.00
Shelby Cnty Judge of Probate, AL
05/31/1978 12:00:00AM FILED/CERT

EXHIBIT "A"

Parcel 1

9/16/21
Lot #⁴⁵~~44~~ of Riverchase Country Club, 3rd Addition, as recorded in Map Book 7 Page 53 in the Probate Office of Shelby County, Alabama. Also, a parcel of land more particularly described as follows: Begin at the SW corner of Lot #⁴⁵~~44~~ of Riverchase Country Club, 3rd Addition (See recorded data above) and run Southwesterly along road right-of-way line 10 ft; thence turn left 90° and run 10 ft; thence turn left 90° and run 10 ft; thence turn left 90° and run 10 ft. to the point of beginning.

Parcel 2

312 PAGE 607
BOOK
Lot #41 of Riverchase Country Club, 3rd Addition, as recorded in Map Book 7 Page 53 in the Probate Office of Shelby County, Alabama. Also, a parcel of land more particularly described as follows: Begin at the SW corner of Lot #41 of Riverchase Country Club, 3rd Addition (See recorded data above) and run Southwesterly along road right-of-way line 10 ft; thence turn right 90° and run 10 ft; thence turn right 90° and run 10 ft; thence turn right 90° and run 10 ft. to the point of beginning.

Parcel 3

Lot #8 of Riverchase Country Club, 3rd Addition, as recorded in Map Book 7 Page 53 in the Probate Office of Shelby County, Alabama. Also, a parcel of land more particularly described as follows: Begin at the NW corner of the above described Lot #8 and run Northwesterly along road right-of-way line 10 ft; thence turn left 90° and run 10 ft; thence turn left 90° and run 10 ft; thence turn left 90° and run 10 ft. to the point of beginning.

Parcel 4

A parcel of land more particularly described as follows: Commence at the SE corner of Lot #34 of Riverchase Country Club, 3rd Addition, as recorded in Map Book 7 Page 53 in the Probate Office of Shelby County, Alabama and run Southwesterly along the SE line of said Lot #34 and a continuation thereof of 210 ft; thence turn right 72°29' and run Northwesterly 70 ft. to the point of beginning; thence turn right 90° and run 10 ft; thence turn left 90° and run 20 ft; thence turn left 90° and run 20 ft; thence turn left 90° and run 20 ft; thence turn left 90° and run 10 ft. to the point of beginning.

Parcel 5

Lot # 32 of Riverchase Country Club, 3rd Addition, as recorded in Map Book 7 Page 53 in the Probate Office of Shelby County, Alabama. Also, a parcel of land more particularly described as follows: Begin at the NW

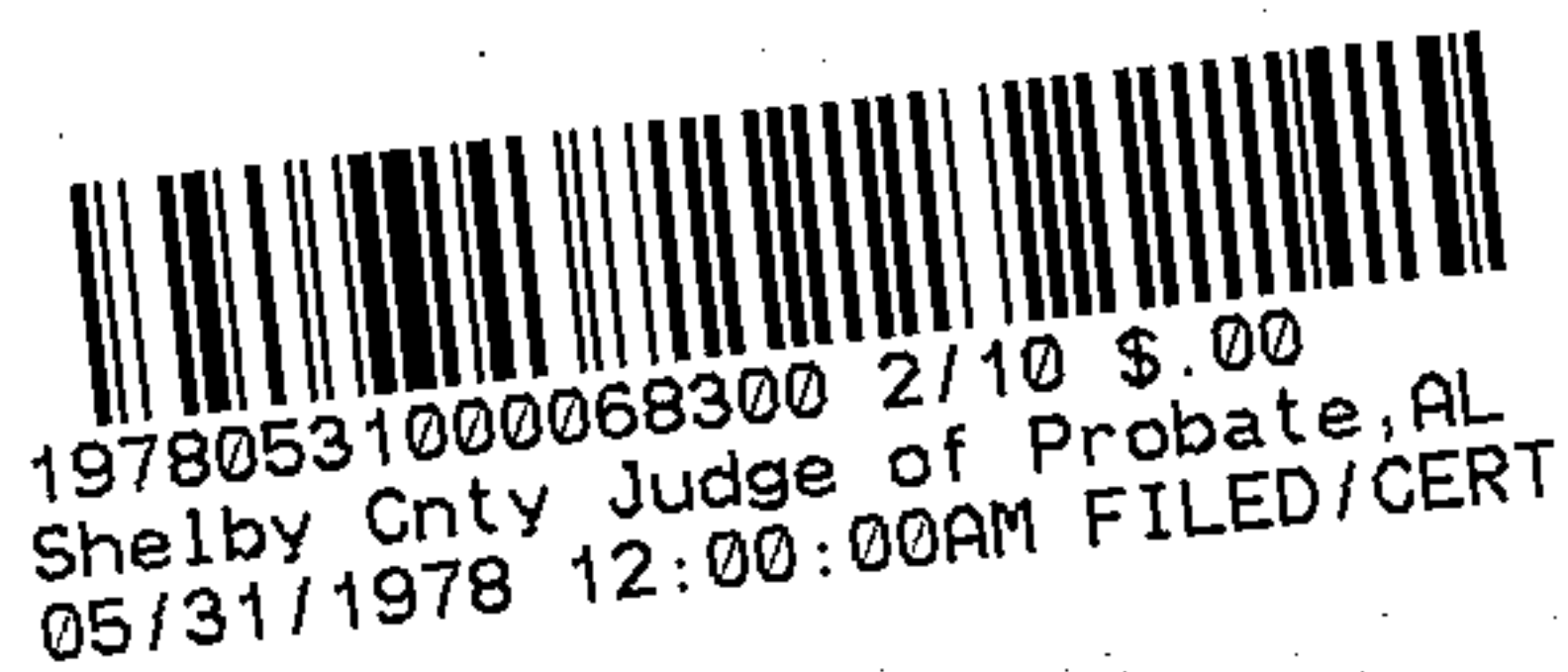

corner of the above described Lot #32 and run Northwesterly along road right-of-way line 10 ft; thence turn right 90° and run 10 ft; thence turn right 90° and run 10 ft; thence turn right 90° and run 10 ft. to the point of beginning.

Parcel 6

Lot #22 of Riverchase Country Club, 3rd Addition, as recorded in Map Book 7 Page 53 in the Probate Office of Shelby County, Alabama. Also, a parcel of land more particularly described as follows: Commence at the NW corner of the above described Lot #22 and run Northeasterly along the NW line of said Lot #22 143.51 ft. to the point of beginning; thence turn left 90° and run 10 ft; thence turn right 90° and run 10 ft; thence turn right 90° and run 10 ft. to the point of beginning.

Parcel 7

Lot #'s 27 and 28 of Riverchase Country Club, 3rd Addition, as recorded in Map Book 7 Page 53 in the Probate Office of Shelby County, Alabama.

Parcel 8

A parcel of land more particularly described as follows: Commence at the NE corner of Lot #10 of Riverchase Country Club, 3rd Addition, as recorded in Map Book 7 Page 53 in the Probate Office of Shelby County, Alabama and run Northwesterly along road right-of-way line 210 ft. to the point of beginning; thence continue along last described course 20 ft; thence turn left 90° and run 10 ft; thence turn left 90° and run 20 ft; thence turn left 90° and run 10 ft. to the point of beginning.

Parcel 9

A parcel of land more particularly described as follows: Commence at the SE corner of Lot #50 of Riverchase Country Club, 3rd Addition, as recorded in Map Book 7 Page 53 in the Probate Office of Jefferson County, Alabama and run Southwesterly along the South line of said Lot #50 and a continuation thereof 229.08 ft. to a point on the SW right-of-way line of a public road; thence turn right 88° and run Northwesterly along said right-of-way line 45 ft. to the point of beginning; thence continue along last described course 20 ft; thence turn left 90° and run 10 ft; thence turn left 90° and run 20 ft; thence turn left 90° and run 10 ft. to the point of beginning.

19780531000068300 3/10 \$.00
Shelby Cnty Judge of Probate, AL
05/31/1978 12:00:00AM FILED/CERT

Parcel 10

Lot #'s 52 and 53 of Riverchase Country Club, 3rd Addition, as recorded in Map Book 7 Page 53 in the Probate Office of Shelby County, Alabama.

Parcel 11

A parcel of land more particularly described as follows: Commence at the NE corner of Lot #53 of Riverchase Country Club, 3rd Addition, as recorded in Map Book 7 Page 53 in the Probate Office of Shelby County, Alabama and run Southeasterly along the Easterly line of said Lot #53 and a continuation thereof 311.53 ft; thence turn right 65° and run Southwesterly 196.70 ft. to the point of beginning; thence turn right 90° and run 10 ft; thence turn left 90° and run 10 ft; thence turn left 90° and run 20 ft; thence turn left 90° and run 10 ft; thence turn left 90° and run 10 ft. to the point of beginning.

Parcel 12

A parcel of land in the SW 1/4 of SW 1/4 of Section 35, Township 19 South, Range 3 West more particularly described as follows: Commence at the SW corner of said 1/4-1/4 and run East 480 ft; thence turn left 64° and run Northeasterly 140 ft. to the point of beginning; thence continue along last described course 580 ft; thence turn left 90° and run Northwesterly 20 ft; thence turn left 90° and run Southwesterly 580 ft; thence turn left 90° and run Southeasterly 20 ft. to the point of beginning.



19780531000068300 4/10 \$.00
Shelby Cnty Judge of Probate, AL
05/31/1978 12:00:00AM FILED/CERT

BOOK 312 PAGE 609

BOOK 312 PAGE 610

Together with all the rights and privileges necessary or convenient for the full enjoyment or use thereof, including the right of ingress and egress to and from said facilities and the right to excavate for installation, replacement, repair, and removal thereof; and also the right to cut and keep clear all trees, underbrush, shrubbery, roots and other growth, and to keep clear any and all obstructions or obstacles of whatever character on, under or above said facilities.

TO HAVE AND TO HOLD the same to the said Alabama Power Company, its successors and assigns, forever.

IN WITNESS WHEREOF, the said HARBERT-EQUITABLE JOINT VENTURE has caused this instrument to be executed in its name by STILL HUNTER, JR., HARBERT CONSTRUCTION CORPORATION as its MANAGER REAL ESTATE and attested by LEO A. MOREHOUSE, JR. its PROJECT MANAGER, and its corporate seal to be hereto affixed, on this the 28 day of APRIL, 19 78.

THE HARBERT-EQUITABLE JOINT VENTURE
Under Joint Venture Agreement Dated January 30, 1974
BY: HARBERT CONSTRUCTION CORPORATION
AS MANAGING VENTURER
BY: Still Hunter Jr.
By ITS: Manager - Real Estate

ATTEST:
Leo A. Morehouse Jr.

19780531000068300 5/10 \$.00
Shelby Cnty Judge of Probate, AL
05/31/1978 12:00:00AM FILED/CERT

STATE OF Alabama

COUNTY OF Shelby

I, Donna C. White,

a Notary Public, in and for said County in said State, hereby certify that

Stell Hunter, Jr.

whose name as Manager of Estate of The Harbert - Equitable
Joint Venture a corporation, is signed to the foregoing

instrument, and who is known to me, acknowledged before me on this day that,
being informed of the contents of this instrument, he as such officer and
with full authority executed the same voluntarily for and as the act of said
corporation.

Given under my hand and official seal, this the 28th
day of April, 19 78.

Donna C. White
Notary Public

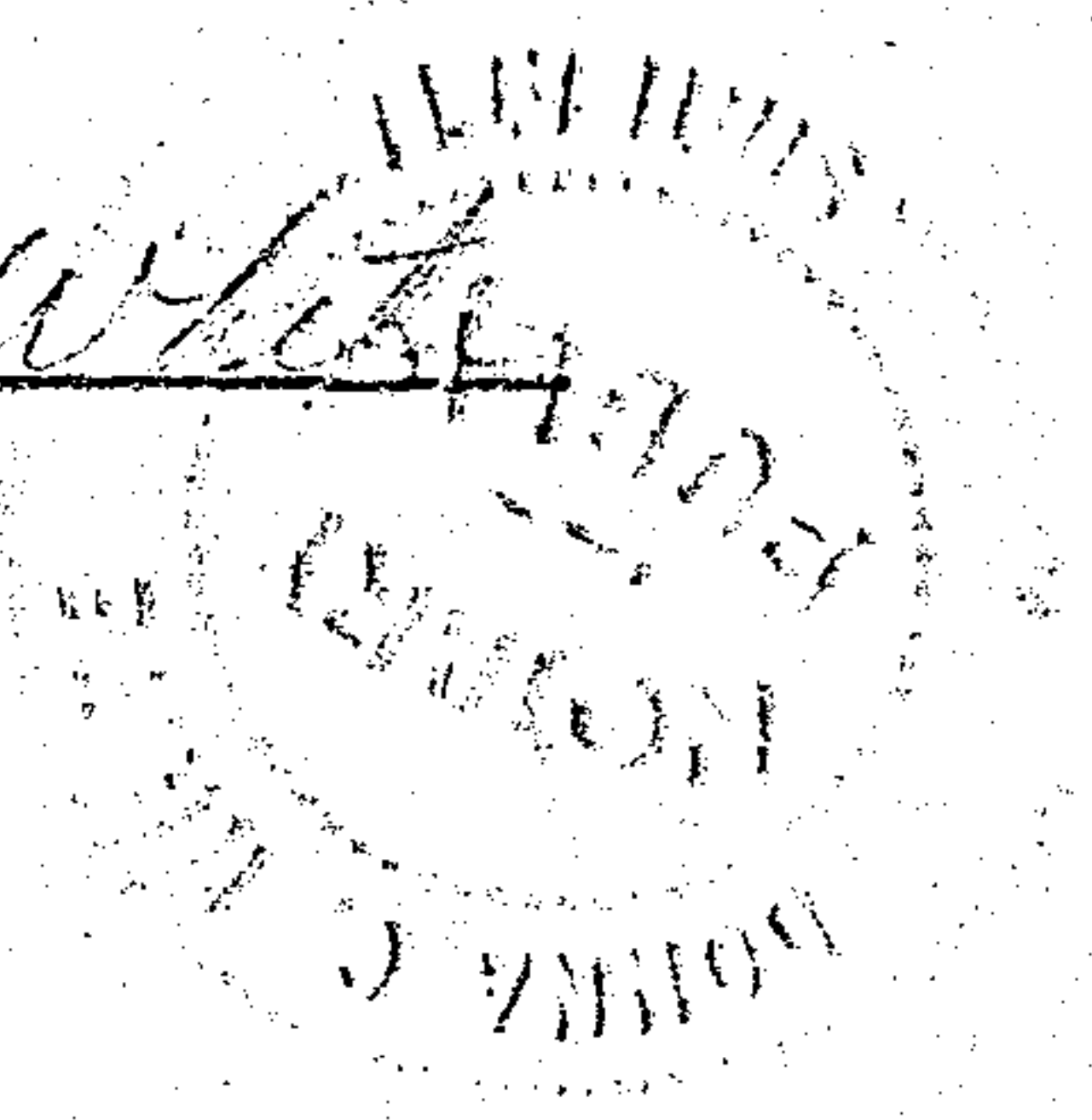

19780531000068300 6/10 \$.00
Shelby Cnty Judge of Probate, AL
05/31/1978 12:00:00AM FILED/CERT

BOOK 312 PAGE 611

SEE WE DND-080032 61
-700

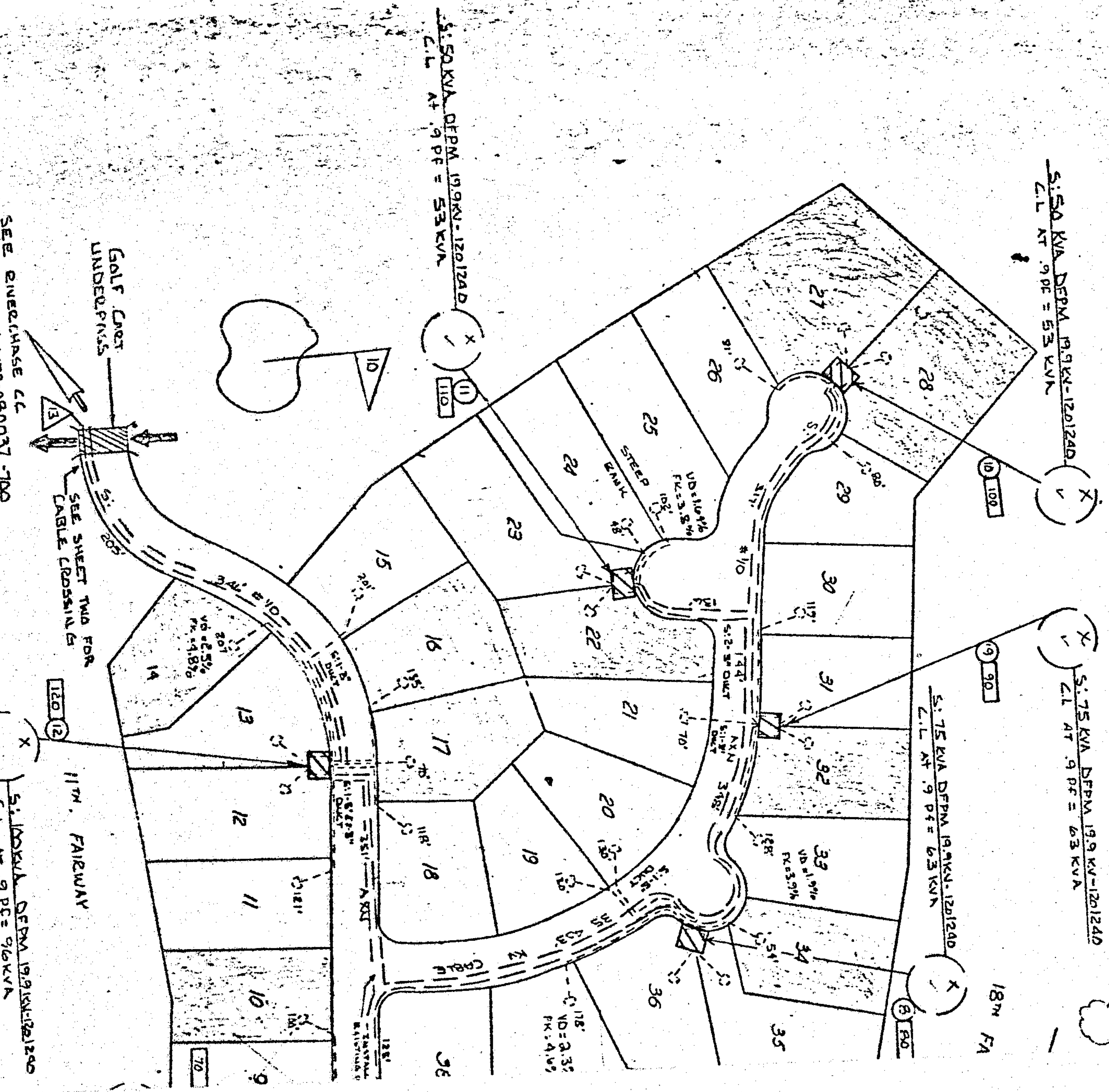

19780531000068300 7/10 \$.00
Shelby Cnty Judge of Probate, AL
05/31/1978 12:00:00AM FILED/CERT

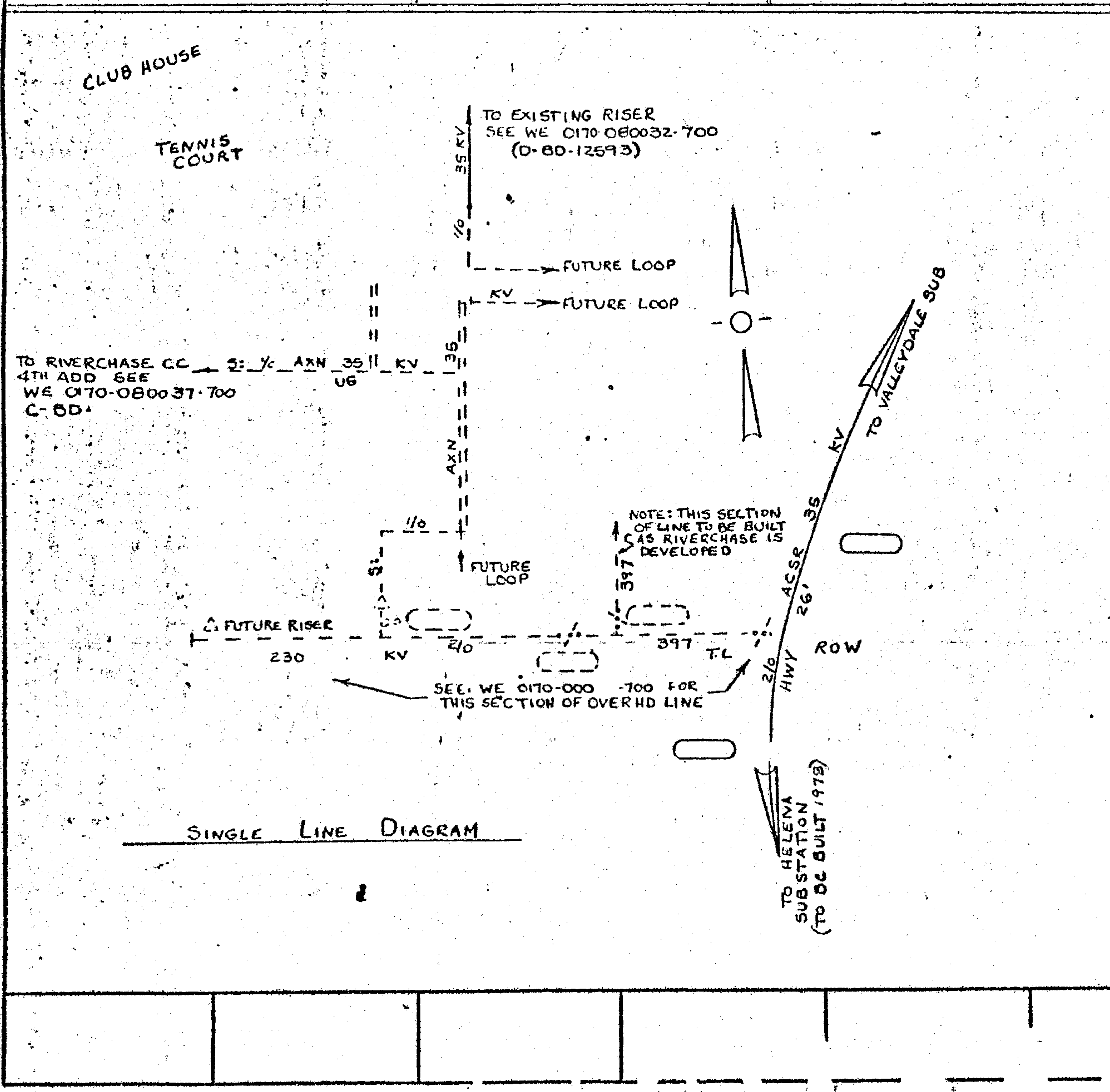
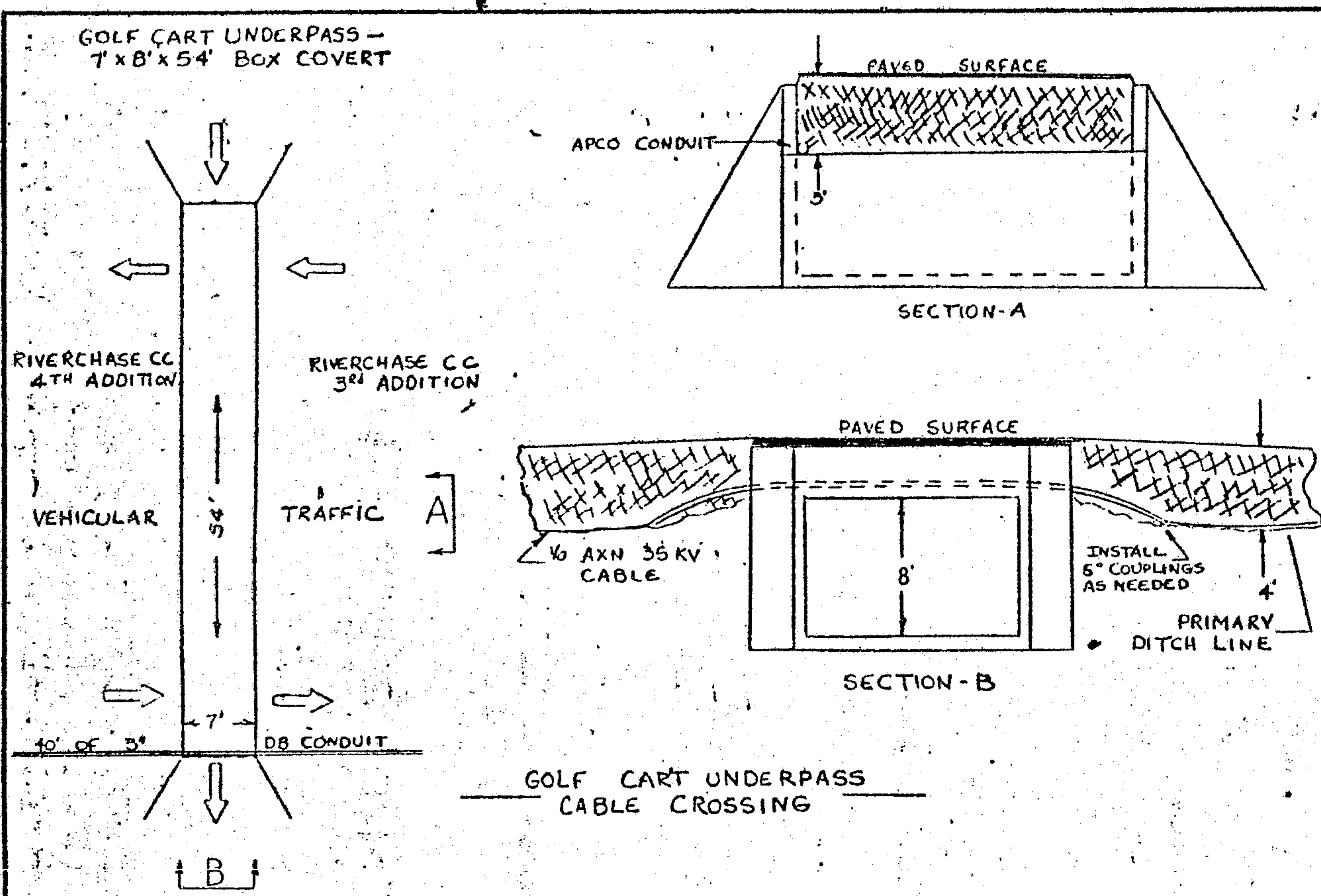

BOOK 312 PAGE 014

NOTE: THE DEVELOPER WILL EXTEND THIS ROAD SO THAT UNDERGO FACILITIES TO RISER MAY BE INSTALLED

NOTE: CABLE TO BE INSTALLED ALONG FAIRWAY ROW

LOOP PRIMARY FOR FUTURE TRANSFORMER TO BE INSTALLED ON THIS PROPOSED LOT.

STUB 1/2 AXN 25 KV CABLE 10' PAST TRANSFORMER

FUTURE LOOP

12TH FAIRWAY

13TH FAIRWAY

GASTON-MAGELLA, 230KV TL ROW

NOTE: SEE WE 017C-000 FOR OVERHD LINE

5: 35 KV 10 RISER (10KVA/LOT)
PRESENT LOADING: 730 KVA
PLANNED LOADING: 1200 KVA
MAXIMUM LOADING: 3005 KVA

Recd. 30
Rec. 15.00
Indl. 1.00
16.50

STATE OF ALA. SHELBY CO.
I CERTIFY THIS INSTRUMENT WAS FILED
1978 MAY 31 PM 12:16
Thommas A. Snowdon, Jr.
JUDGE OF PROBATE

35 T-19 R-3 11.27 71645

ALABAMA POWER COMPANY	
JOB	SHIRLEY A. SNOWDON, JR.
DETAIL	THIRD ADDITION
SCALE	AS SHOWN
SHEET	1 OF 1 SHEETS
SUPERSEDES	C-12650

DRAWN	CHECKED	TRACED
APPROVED	DATE	
APPROVED	DATE	



19780531000068300 10/10 \$.00
Shelby Cnty Judge of Probate, AL
05/31/1978 12:00:00AM FILED/CERT