

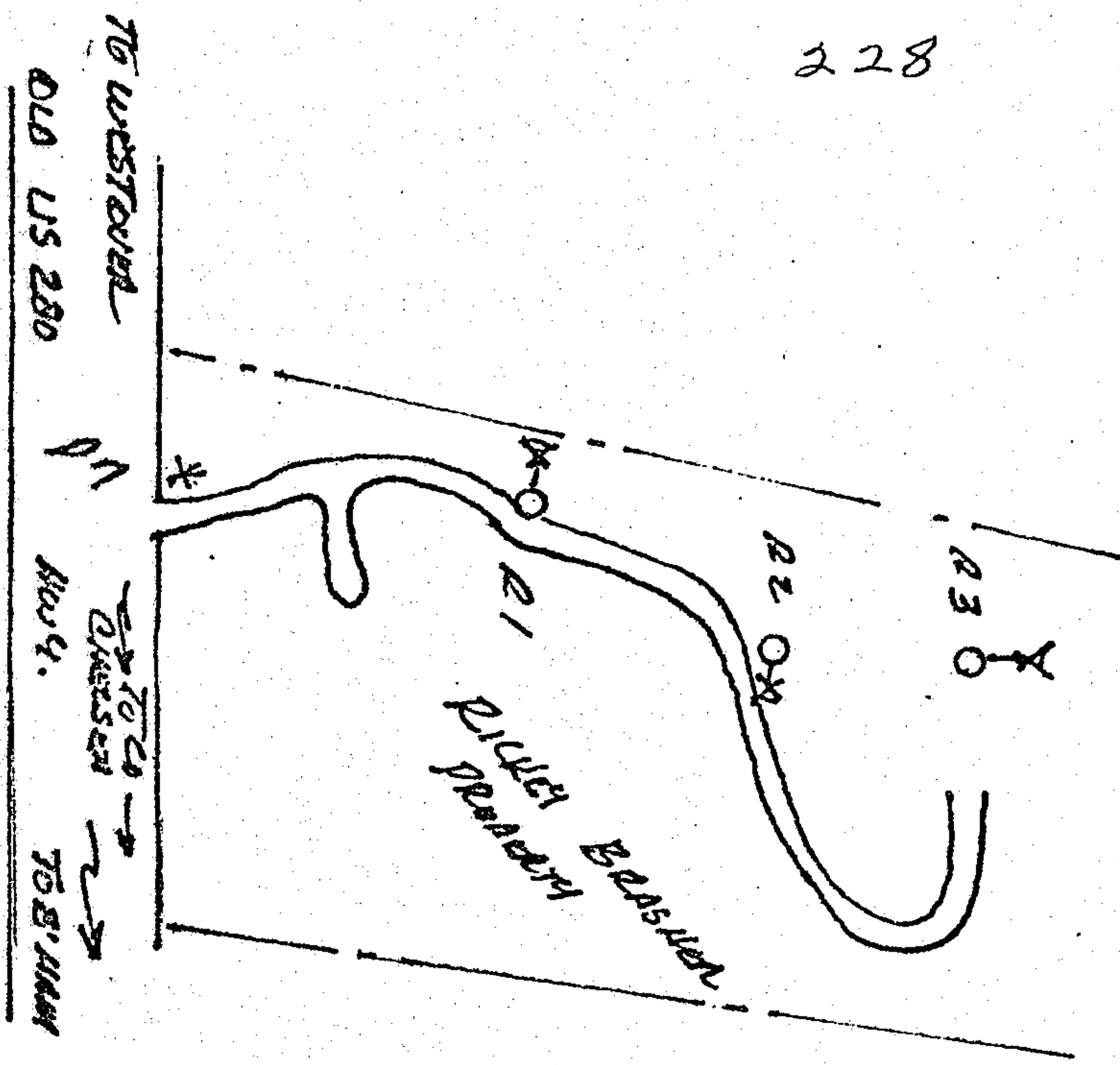

19780524000065270 1/1 \$.00  
Shelby Cnty Judge of Probate, AL  
05/24/1978 12:00:00AM FILED/CERT

Name and Post Office Address of Grantor MR RICKY BRASHER  
Box 293 Route 1  
Steele, AL 35147  
Toll Line (Name)  
or Exchange Line CHASSEN  
tributary to (Exchange)  
The property is bounded where the line enters and leaves this property by the property of:  
SEE SKETCH BELOW of the  
SEE SKETCH BELOW of the  
The poles (or stakes) have the following identification:  
SEE SKETCH BELOW  
to SEE SKETCH BELOW  
Authority 834-3022 classification 91A  
Area  
Approved Ricky Brasher  
Title District Manager-OSP Engrg.



### RIGHT-OF-WAY EASEMENT

FORM 8416 SC  
MARCH, 1973

In consideration of the sum of money hereinafter set out and other good and valuable consideration, the adequacy and receipt of which is hereby acknowledged from the South Central Bell Telephone Company, the undersigned, owner(s) of the premises described below, do hereby grant to the South Central Bell Telephone Company, its licenses, agents, successors, assigns, and allied and associated companies, a right of way easement to construct, operate, maintain, add or remove such lines or systems of communications or related services as the grantee may require, consisting of:

- (1) poles, guys, anchors, aerial cables and wires;
- (2) Buried cables and wires, cable terminals, markers, splicing boxes and pedestals;
- (3) Conduits, manholes, markers, underground cables and wires;
- (4) and other amplifiers, boxes, appurtenances or devices

upon over and under a strip of land 30 feet wide across the following lands in SHELBY County, State of ALA generally described as follows:

280 IN SECTION 25 TOWNSHIP 19 SOUTH RANGE 1 WEST OFF OLD US HWY 4

and, to the fullest extent the undersigned has the power to grant, if at all, over, along and under the roads, streets, or highways adjoining or through said property.

The following rights are also granted: to allow any other person or company to attach wires or lay cable or conduit within the right of way for communications or electric power transmission or distribution; ingress and egress to said premises at all times; to clear the land and keep it cleared of all trees, undergrowth or other obstructions within the easement area; to trim and cut and keep trimmed and cut all dead, weak, leaning or dangerous trees or limbs outside of the easement area which might interfere with or fall upon the lines or systems of communications or power transmission or distribution.

The receipt of ONE and NO /100 Dollars (\$1.00) is hereby acknowledged by the undersigned.

To have and to hold the above granted easement unto South Central Bell Telephone Company, its successors and assigns forever.

IN WITNESS WHEREOF, the undersigned Ha signed and sealed this document caused this instrument to be executed by its  
on MARCH 1, 1978 duly authorized agent

Signed, sealed and delivered in the presence of:

Ricky Brasher L.S.  
RICKY BRASHER L.S.

Witness CO. Mr. Egan STATE OF ALA. SHELBY CO. JUDGE OF PROBATE

Attest:

Corporate Officer

JUDGE OF PROBATE

Name of Corporation

Fee: .50  
1.50  
1.00  
3.00