

209

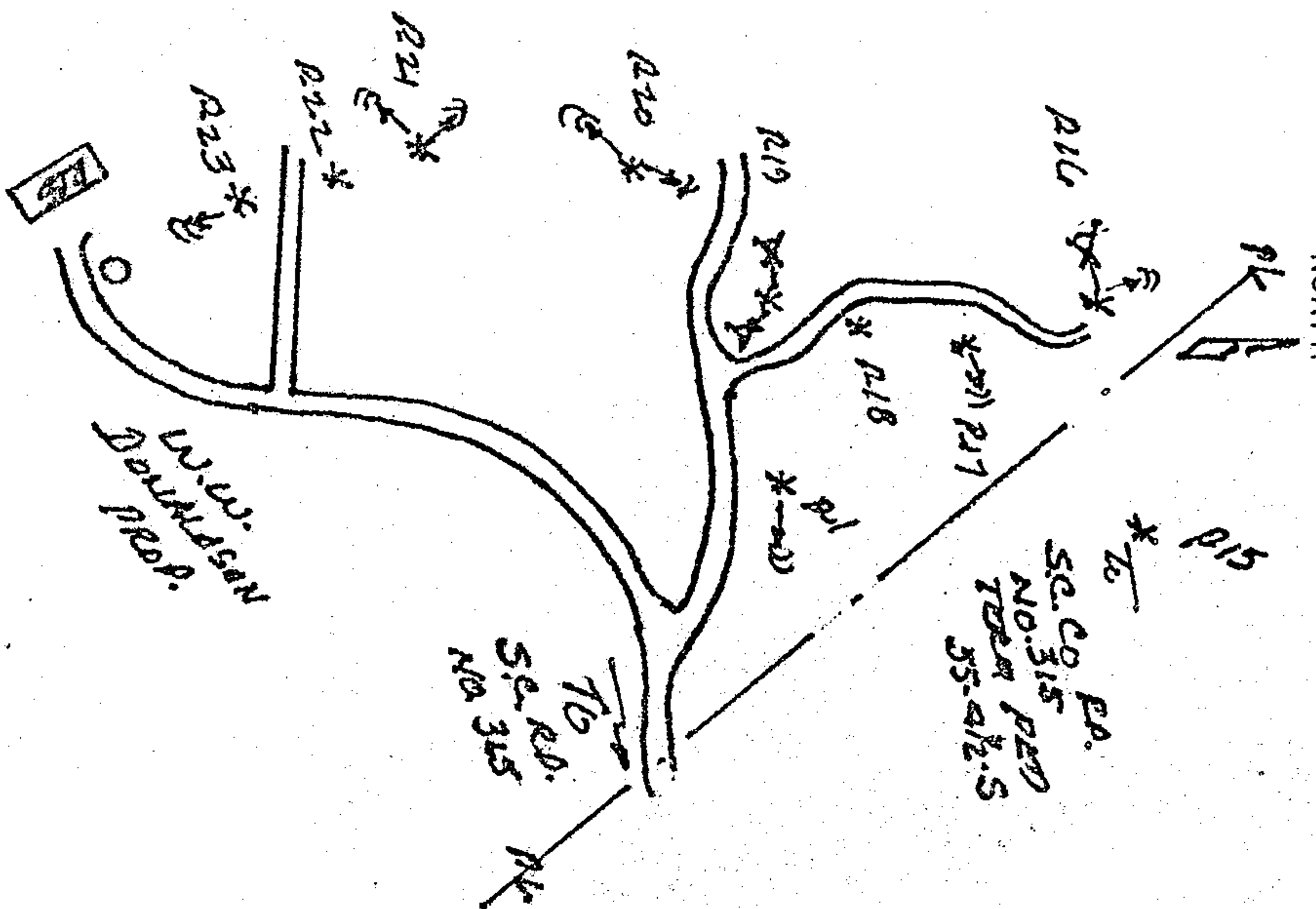

Name and Post Office Address of Grantor W.W. Donaldson
Box 2
Shelby County, Ala. 35551
The property is bounded where the line enters and leaves this property by the property of:
See sketch below of the
The poles (or stakes) have the following identification: Pole 1 (at corner) 23
(H.L. P. Co. Poles)
to See sketch below
Authority 734-41576 classification SIC
Area Shelby County, Ala. District
Approved See sketch below
Title District Mgr. OSPE

RIGHT-OF-WAY EASEMENT

FORM 8416 SC
MARCH, 1973

In consideration of the sum of money hereinafter set out and other good and valuable consideration, the adequacy and receipt of which is hereby acknowledged from the South Central Bell Telephone Company, the undersigned, owner(s) of the premises described below, do hereby grant to the South Central Bell Telephone Company, its licenses, agents, successors, assigns, and allied and associated companies, a right of way easement to construct, operate, maintain, add or remove such lines or systems of communications or related services as the grantee may require, consisting of:

- (1) poles, guys, anchors, aerial cables and wires;
- (2) Buried cables and wires, cable terminals, markers, splicing boxes and pedestals;
- (3) Conduits, manholes, markers, underground cables and wires;
- (4) and other amplifiers, boxes, appurtenances or devices

upon over and under a strip of land 20 feet wide across the following lands in SHELBY County, State of ALABAMA generally described as follows:

ALONG A ROAD OFF SHELBY COUNTY RD NO. 315 IN SECTION 5
TOWNSHIP 22S RANGE 1 EAST

and, to the fullest extent the undersigned has the power to grant, if at all, over, along and under the roads, streets, or highways adjoining or through said property.

The following rights are also granted: to allow any other person or company to attach wires or lay cable or conduit within the right of way for communications or electric power transmission or distribution; ingress and egress to said premises at all times; to clear the land and keep it cleared of all trees, undergrowth or other obstructions within the easement area; to trim and cut and keep trimmed and cut all dead, weak, leaning or dangerous trees or limbs outside of the easement area which might interfere with or fall upon the lines or systems of communications or power transmission or distribution.

The receipt of ONE and NO /100 Dollars (\$1.00) is hereby acknowledged by the undersigned.

To have and to hold the above granted easement unto South Central Bell Telephone Company, its successors and assigns forever.

IN WITNESS WHEREOF, the undersigned Ha signed and sealed this document
on December 6 1977 caused this instrument to be executed by its
duly authorized agent

Signed, sealed and delivered in the presence of:

W.W. Donaldson
W.W. Donaldson

L.S.

L.S.

STATE OF ALA. SHELBY CO.

I CERTIFY THIS Name of Corporation
INSTRUMENT WAS FILED

Attest:

Corporate Officer

1978 MAY 24

By: Deed, tal .50
AM TO OUTLET
Rec. 1.50
1.00
3.00

Thomas A. [Signature]
JUDGE OF PROBATE



19780524000064440 1/1 \$.00
Shelby Cnty Judge of Probate, AL
05/24/1978 12:00:00AM FILED/CERT