

452

STATE OF Alabama)

6010 0170-08-0031-700

COUNTY OF Shelby) Service to Kingwood Second Addition
Alabaster Sub.

374558

KNOW ALL MEN BY THESE PRESENTS, that the undersigned,

We, James L. King and wife Rose Marie King

for and in consideration of the sum of One and No/100 Dollars (\$1.00), to
us in hand paid by Alabama Power Company, a corporation, the receipt
whereof is acknowledged, we hereby grant to said Alabama Power Company,
its successors and assigns, the right to construct, install, operate and maintain,
and the right to permit other corporations and persons to construct, install,
operate and maintain, along a route to be selected by the grantee, (generally shown
crosshatched on the attached drawing) its successors and assigns, all conduits,
cables, trans closures and other appliances and facilities useful or necessary in
connection therewith, for the underground transmission and distribution of electric
power and for underground communication service, upon, under and across the following
described land situated in Shelby County, Alabama:

A parcel of land located in the NE 1/4 of NW 1/4, Section 26, Township 20 South,
Range 3 West, more particularly described as follows: Commence at the northwest
corner of Lot 57, Kingwood, 1st Addition, as recorded in Map Book 6, Page 90,
Probate Office, Shelby County, thence east 150.05 feet along the north line of said
Lot 57 to the west line of King Charles Court, thence north along the west line of
said road to the south line of said forty, thence west 15 feet along the south line
of said forty, thence 90° right 10 feet, thence 90° right 25 feet, thence 90° right
to the south line of said forty, thence west to the point of beginning.

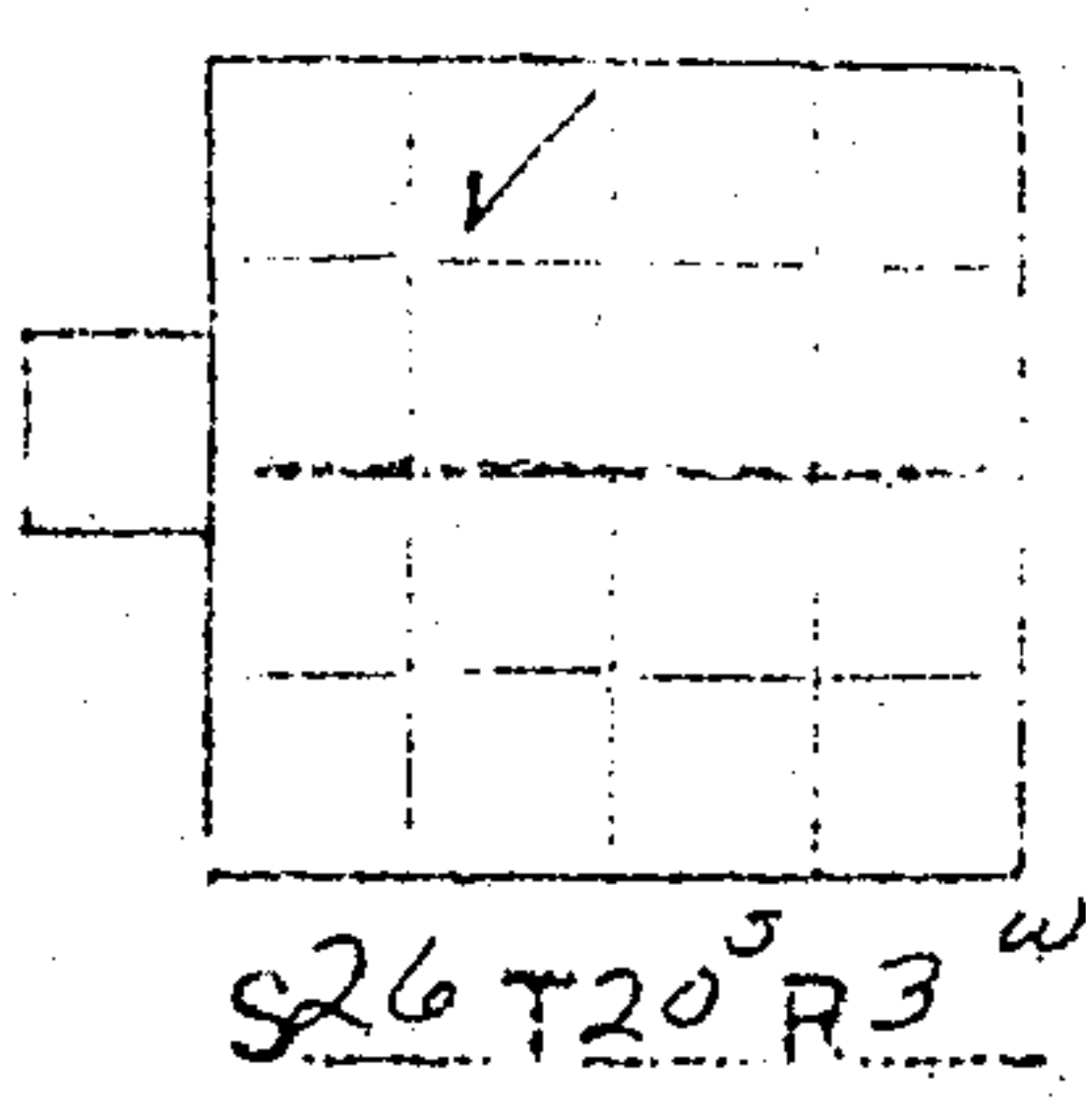

THIS INSTRUMENT WAS PREPARED BY:
NAME R.C. Cossin - Corp. Real Estate
ADDRESS ALA. Power Co. - B'ham

SOURCE OF TITLE _____

BOOK		PAGE	
SUBDIVISION	LOT	PLAT BK	PAGE
26	Q	S	T R

BOOK 307 PAGE 184

Re H

6200
2024-2601
B'ham 35291

Together with all the rights and privileges necessary or convenient for the full enjoyment or use thereof, including the right of ingress and egress to and from said facilities and the right to excavate for installation, replacement, repair and removal thereof; and also the right to cut and keep clear all trees, underbrush, shrubbery, roots and other growth, and to keep clear any and all obstructions or obstacles of whatever character on, under or above said facilities.

TO HAVE AND TO HOLD the same to the said Company, its successors and assigns, forever.

IN WITNESS WHEREOF, we have hereunto set our hands and seals, this the 25th day of July, 1977.

WITNESS:

_____ James L. King (Seal)
_____ Rose Marie King (Seal)



19770811000083820 2/4 \$.00
Shelby Cnty Judge of Probate, AL
08/11/1977 12:00:00AM FILED/CERT

STATE OF Alabama)

COUNTY OF Shelby)

I, John F. Powell, Jr., a Notary Public, in and
for said County in said State, hereby certify that James L. King
And wife Rose Marie King
whose name S ARE signed to the foregoing instrument and who ARC
known to me, acknowledged before me on this day that being informed of the
contents of the instrument they executed the same voluntarily, on the
day the same bears date.

Given under my hand and official seal, this the 25th day of
July, 1977.

[Signature]
Notary Public State at Large

19770811000083820 3/4 \$.00
Shelby Cnty Judge of Probate, AL
08/11/1977 12:00:00AM FILED/CERT

BOOK 337 PAGE 116

ALABAMA POWER COMPANY
SKETCH OF PROPOSED WORK

DSO OR SERIAL NO. 017008003-7

ESTIMATE NO. _____

DIVISION BIRMINGHAM

TOWN ALABASTER DISTRICT ALABASTER DRAWN BY SMITH, W.R. DATE 5-26-77

SCALE 1"=50' FT. PER INCH SECT. 26 TOWNSHIP 20S RANGE 3W MAP REFERENCE C-750B-36

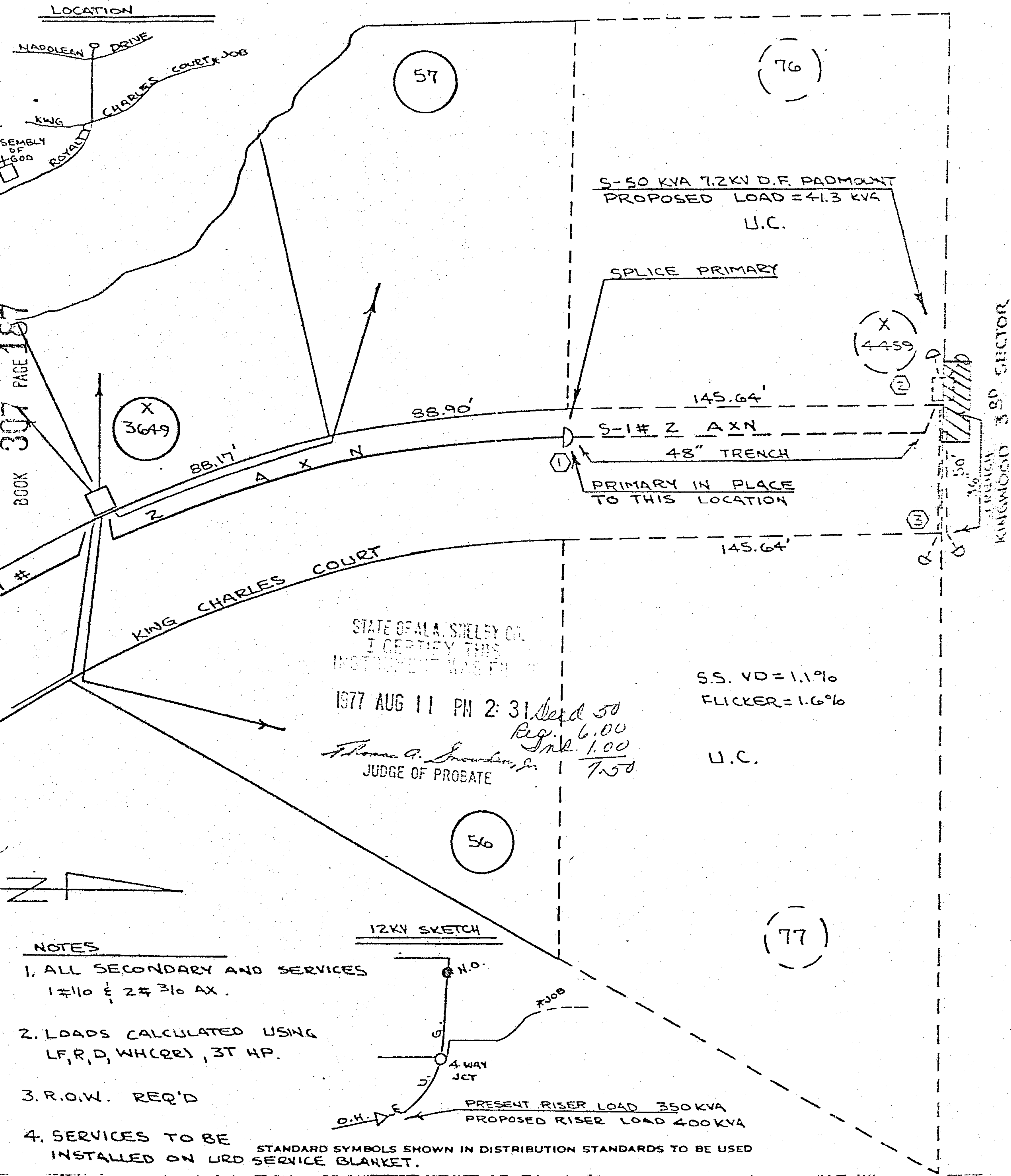

STATE OF ALA. SHELBY CO.
I CERTIFY THIS
INSTRUMENT WAS FILED
1977 AUG 11 PM 2:31
Thomas A. Snowden, Jr.
JUDGE OF PROBATE
Rec'd 50
Reg. 6.00
Fee 1.00
7.50

S.S. VD = 1.1%
FLICKER = 1.6%
U.C.

- NOTES
1. ALL SECONDARY AND SERVICES
1#10 & 2#30 AX.
 2. LOADS CALCULATED USING
LF, R, D, WH(QR), 3T HP.
 3. R.O.W. REQ'D
 4. SERVICES TO BE
INSTALLED ON URD SERVICE BLANKET.

