

453

STATE OF Alabama) Service to Kingwood Second Addition
COUNTY OF Shelby) Alabaster Sub.

6010 0170-08-0031-700

374556

KNOW ALL MEN BY THESE PRESENTS, that the undersigned,
Bill Brantley Construction Company, Inc.

for and in consideration of the sum of One and No/100 Dollars (\$1.00), to
it in hand paid by Alabama Power Company, a corporation, the receipt
whereof is acknowledged, it does hereby grant to said Alabama Power Company,
its successors and assigns, the right to construct, install, operate and maintain,
and the right to permit other corporations and persons to construct, install,
operate and maintain, along a route to be selected by the grantee, (generally shown
crosshatched on the attached drawing) its successors and assigns, all conduits,
cables, translosures and other appliances and facilities useful or necessary in
connection therewith, for the underground transmission and distribution of electric
power and for underground communication service, upon, under and across the following
described land situated in Shelby County, Alabama:

A parcel of land located in the SE 1/4 of NW 1/4, Section 26, Township 20 South,
Range 3 West, more particularly described as follows: Commence at the northwest
corner of Lot 57, Kingwood, 1st Addition, as recorded in Map Book 6, Page 90,
Probate Office, Shelby County, thence east 150.05 feet along the north line of
said Lot 57 to the west line of King Charles Court for a point of beginning, thence
north 145.64 feet along the west line of said road to the north line of said forty,
thence west 15 feet along the north line of said forty, thence 90° left 10 feet,
thence 90° left 5 feet, thence south and parallel to the west line of said road, to
a point on the north line of said Lot 57, said point being 10 feet west of the point
of beginning, thence east 10 feet to the point of beginning.

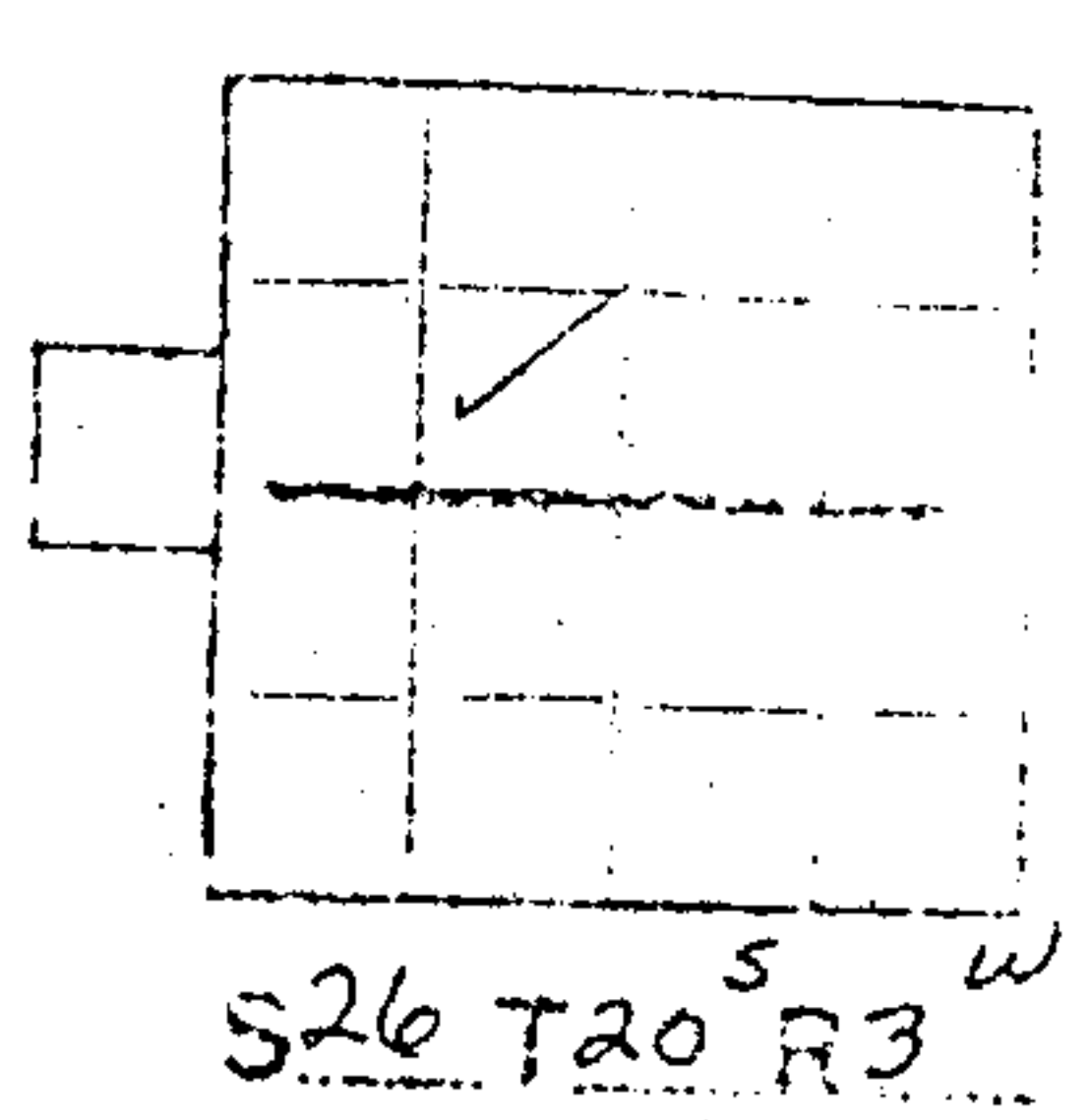

THIS INSTRUMENT WAS PREPARED BY:
NAME R.C. COOPER - CORP Real Estate
ADDRESS P.A. POWER CO - B' HAM
SOURCE OF TITLE _____
BOOK _____ PAGE _____
SUBDIVISION LOT PLAT BK PAGE
CO Q S T R

19770811000083520 1/4 \$.00
Shelby Cnty Judge of Probate, AL
08/11/1977 12:00:00AM FILED/CERT

BOOK 307 PAGE 188

2 P.C.B.
500-76-1846A
P.O. 814 2641
C. 711m. 01. 35271

BOOK 307 PAGE 189

Together with all the rights and privileges necessary or convenient for the full enjoyment or use thereof, including the right of ingress and egress to and from said facilities and the right to excavate for installation, replacement, repair, and removal thereof; and also the right to cut and keep clear all trees, underbrush, shrubbery, roots and other growth, and to keep clear any and all obstructions or obstacles of whatever character on, under or above said facilities.

TO HAVE AND TO HOLD the same to the said Alabama Power Company, its successors and assigns, forever.

IN WITNESS WHEREOF, the said Bill Brantley Construction Company, Inc. has caused this instrument to be executed in its name by Bill Brantley as its President, ~~and attested by~~ its, ~~and its corporate seal to be hereto affixed~~, on this the 21st day of July, 19 77.

Bill Brantley Construction Company, Inc.

ATTEST:

By Bill Brantley

19770811000083520 2/4 \$.00
Shelby Cnty Judge of Probate, AL
08/11/1977 12:00:00AM FILED/CERT

STATE OF Alabama)

COUNTY OF Shelby)

I, John F. Powell, Jr.,

a Notary Public, in and for said County in said State, hereby certify that

Bill Brantley

whose name as President of Bill Brantley Construction Company,

Inc. a corporation, is signed to the foregoing

instrument, and who is known to me, acknowledged before me on this day that,

being informed of the contents of this instrument, he as such officer and

with full authority executed the same voluntarily for and as the act of said

corporation.

Given under my hand and official seal, this the 21st

day of July, 19 77.

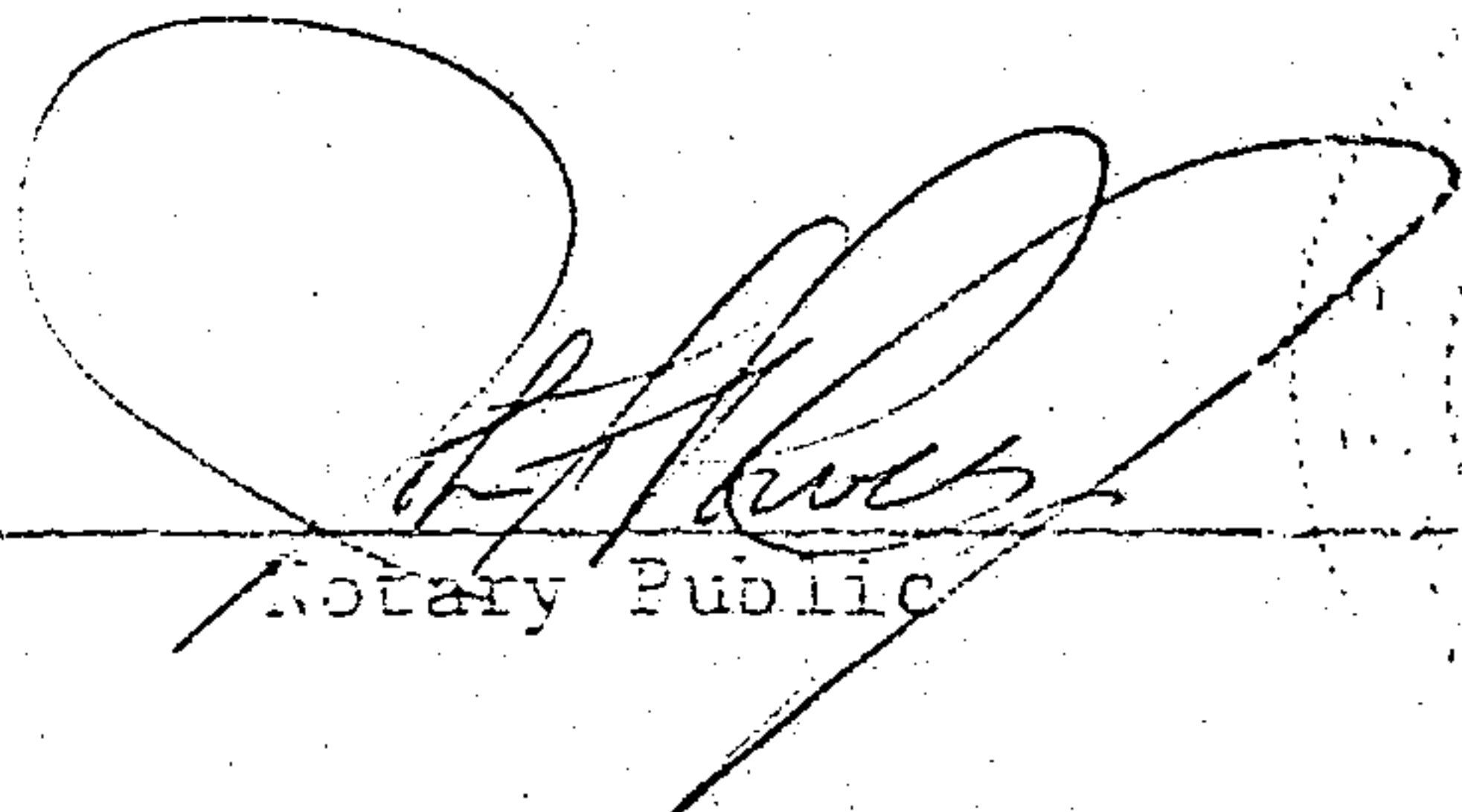

Notary Public



19770811000083520 3/4 \$.00
Shelby Cnty Judge of Probate, AL
08/11/1977 12:00:00AM FILED/CERT

BOOK 307 PAGE 199

ALABAMA POWER COMPANY SKETCH OF PROPOSED WORK

DSO OR SERIAL NO. 017008 003 70

ESTIMATE NO. _____

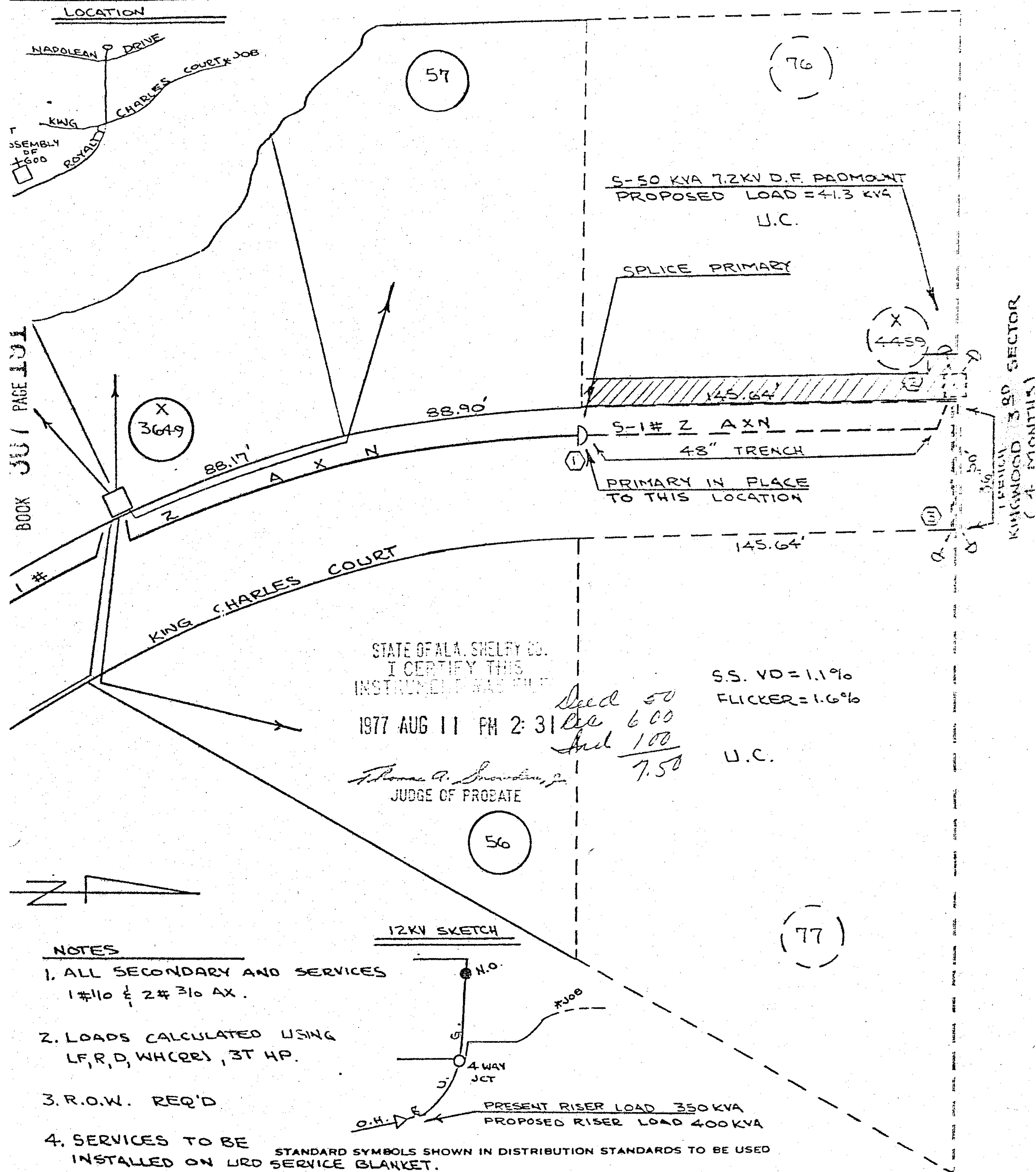
DIVISION BIRMINGHAMTOWN ALABASTER DISTRICT ALABASTER DRAWN BY SMITH, W.R. DATE 5-26-77SCALE 1"=50' FT. PER INCH SECT. 26 TOWNSHIP 20S RANGE 3W MAP REFERENCE C-75018-36

19770811000083520 4/4 \$.00
Shelby Cnty Judge of Probate, AL
08/11/1977 12:00:00AM FILED/CERT