

~~XXX~~ 6010 DSO 6430-90-1 1975
Falcon Manor II (Scott Realty)
Off Montevallo District

349441

STATE OF ALABAMA)

COUNTY OF SHELBY)

8707

Victor Scott and wife, Charlene H. Scott

KNOW ALL MEN BY THESE PRESENTS, that the undersigned,

Victor Scott and wife, Charlene H. Scott

in consideration of the sum of One and No/100 Dollars (\$1.00), to us
in hand paid by Alabama Power Company, a corporation, the receipt whereof
is acknowledged, do hereby grant to said Alabama Power Company, its
successors and assigns, the right to construct, install, operate and main-
tain, and the right to permit other corporations and persons to construct,
install, operate and maintain, along routes to be selected by the grantee,
(generally shown crosshatched on the attached drawing) its successors or
assigns, all poles, wires, conduits, cables, translosures and other appli-
ances and facilities useful or necessary in connection therewith for the
overhead and underground transmission and distribution of electric power
and for the overhead and underground communication service, upon, over,
under and across the following described land, situated in Shelby
County, Alabama:

300
3 acres more or less in Section 21, Township 22 south,
Range 3 west bounded as follows: North by Sam Schafferman
lands, east by the Public Road, south by lands belonging
to Vic-San Inc., a corp, west by lands belonging to Vic-
San Inc. a corp and lands belonging to H. B. Vest.



19751021000058590 1/4 \$.00
Shelby Cnty Judge of Probate, AL
10/21/1975 12:00:00AM FILED/CERT

This instrument prepared in
the Law Dept. of Alabama
Power Co., Birmingham, Ala.

By R.C. Cassin

BOOK 295 PAGE 164



Together with all the rights and privileges necessary or convenient for the full enjoyment or use thereof, including the right of ingress and egress to and from said facilities and the right to excavate for installation, replacement, repair and removal thereof; and also the right to cut and keep clear all trees, underbrush, shrubbery, roots and other growth, and to keep clear any and all obstructions or obstacles of whatever character on, under or above said facilities.

TO HAVE AND TO HOLD the same to the said Company, its successors and assigns, forever.

IN WITNESS WHEREOF, we have hereunto set our hands and seals, this the 15 day of September, 1975

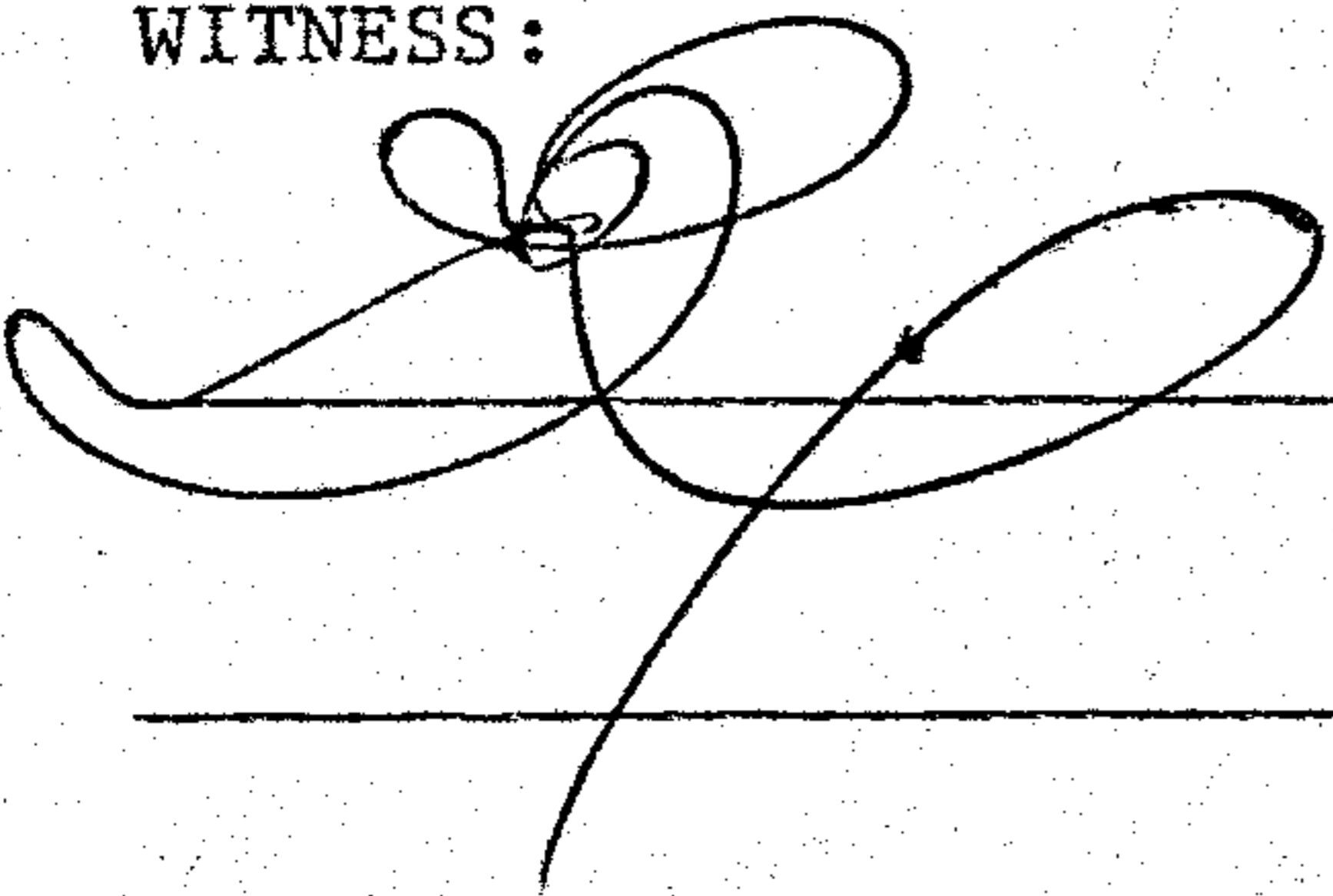
WITNESS:

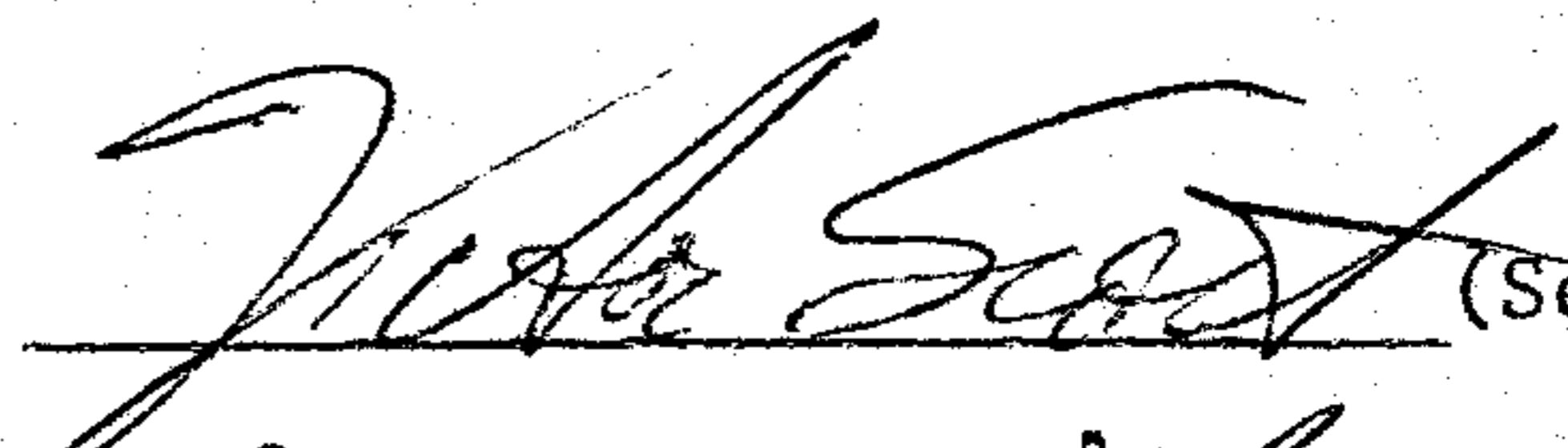

 (Seal)
 (Seal)

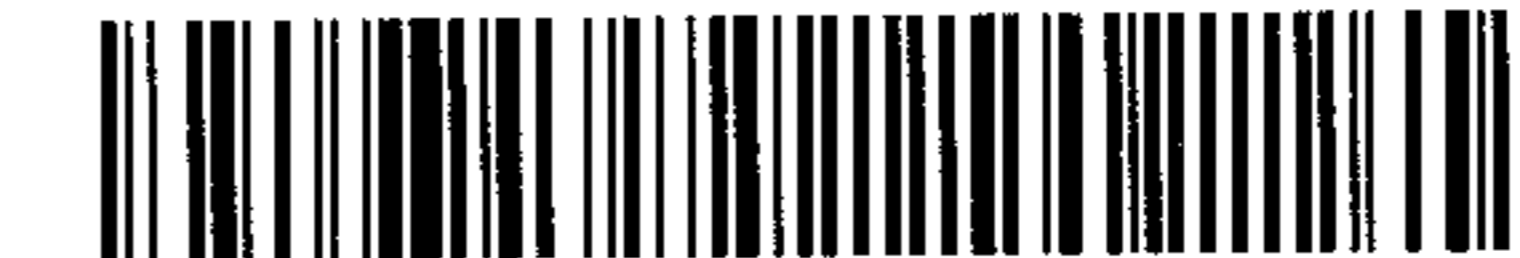

19751021000058590 2/4 \$.00
Shelby Cnty Judge of Probate, AL
10/21/1975 12:00:00AM FILED/CERT

STATE OF Alabama)
COUNTY OF Shelby ;

I, Willis H. Hendrix,
a Notary Public State of Alabama, in and for said County in said State,
hereby certify that Victor Scott and Charlene
H. Scott

whose name See signed to the foregoing instrument and who two
known to me, acknowledged before me on this day that being informed
of the contents of the instrument they executed the same voluntarily,
on the day the same bears date.

Given under my hand and official seal, this the 15
day of September, 1975.

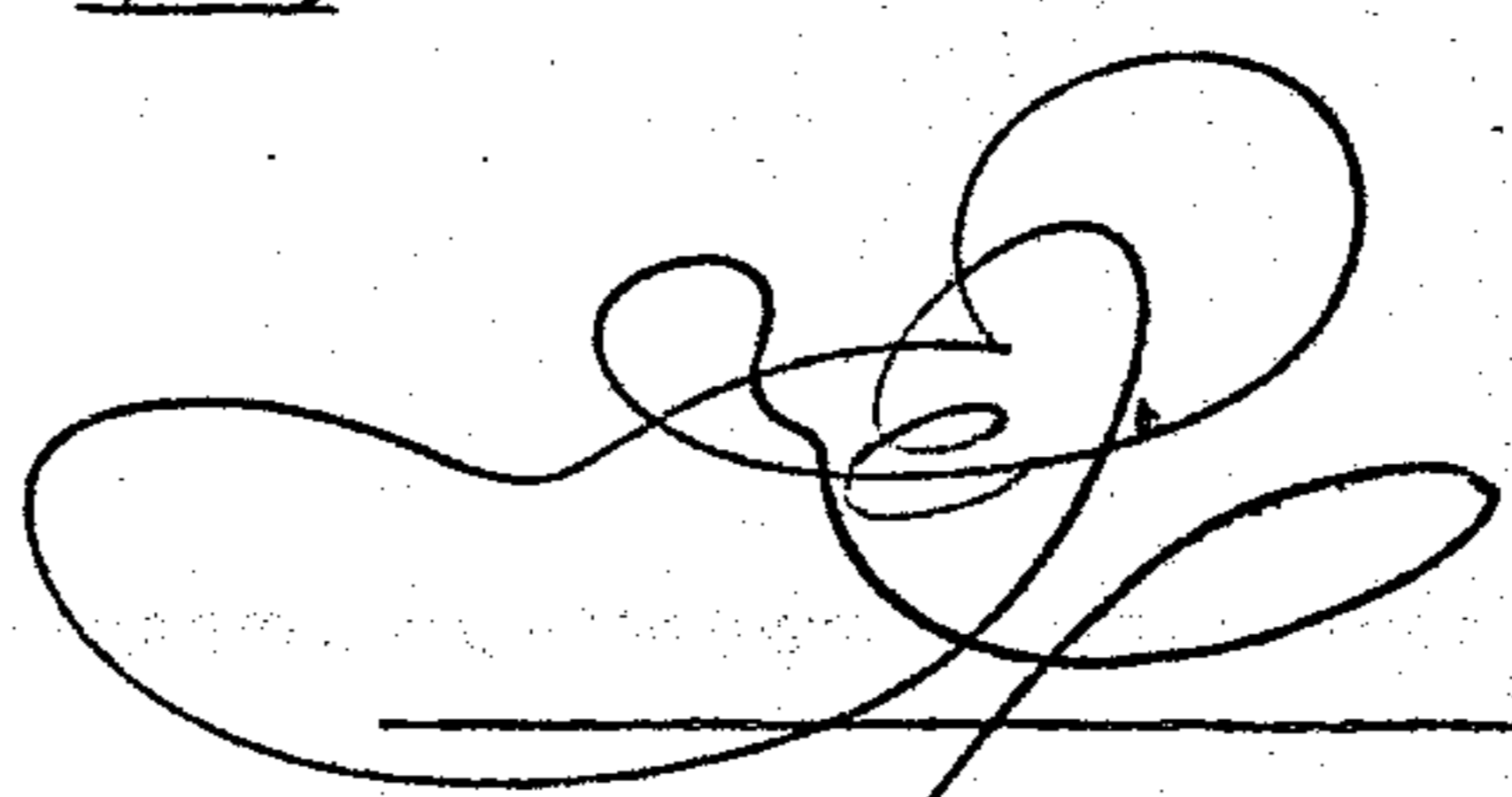
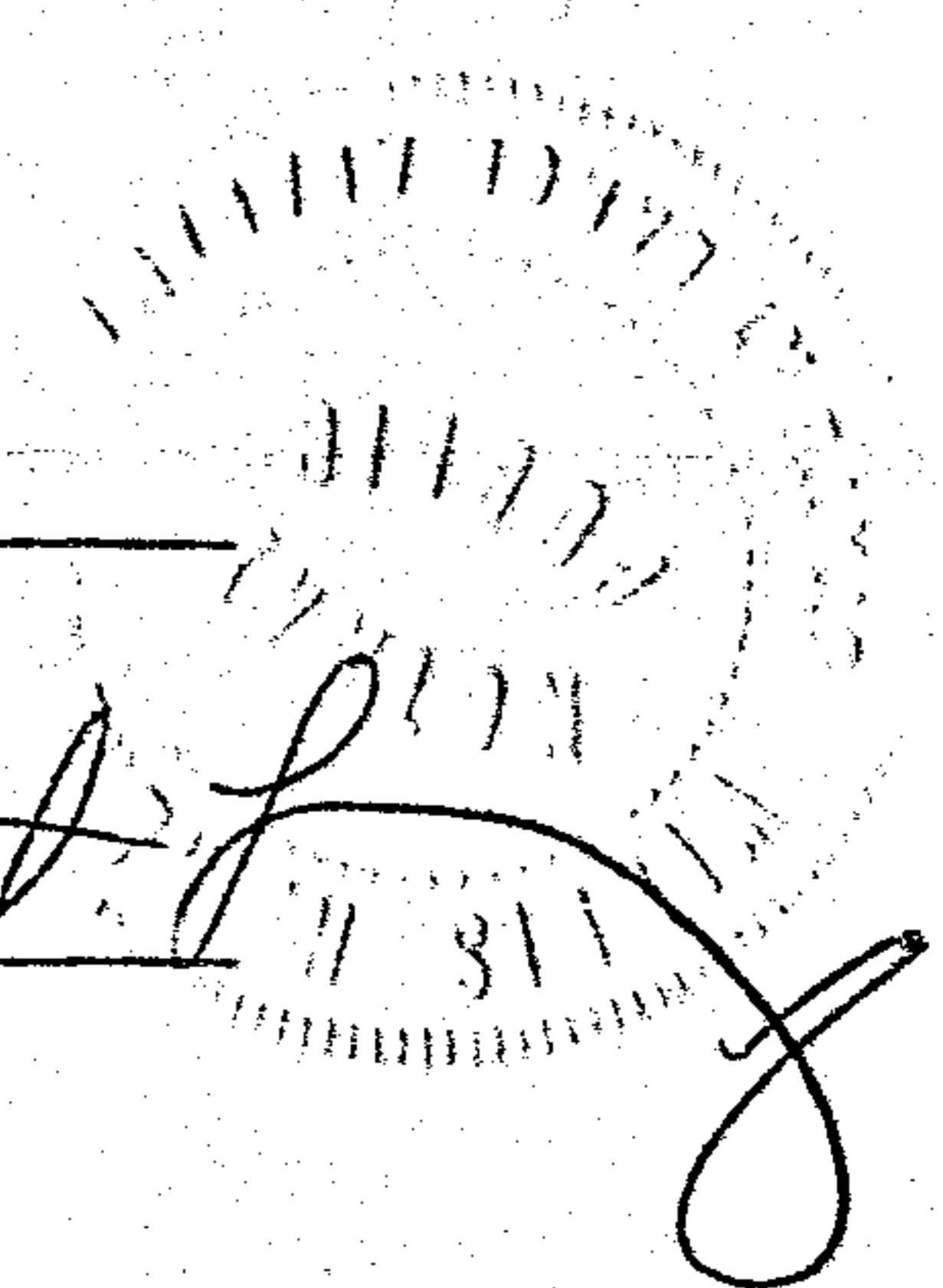
Notary Public State of Alabama

BOOK 295 PAGE 166

19751021000058590 3/4 \$.00
Shelby Cnty Judge of Probate, AL
10/21/1975 12:00:00AM FILED/CERT

3031	C	392	1/46 2# 500MCM AX	0 UNIT	2A/4
3032	A	392	1/46 2# 500MCM AX	3 UNIT	APARTMENT
3033	A1	410	1/46 2# 500MCM AX	5 UNIT	PURCHASED BY CUSTOMER

19751021000058590 4/4 \$.00
 Shelby Cnty Judge of Probate, AL
 10/21/1975 12:00:00AM FILED/CERT

BOOK 295 PAGE 167

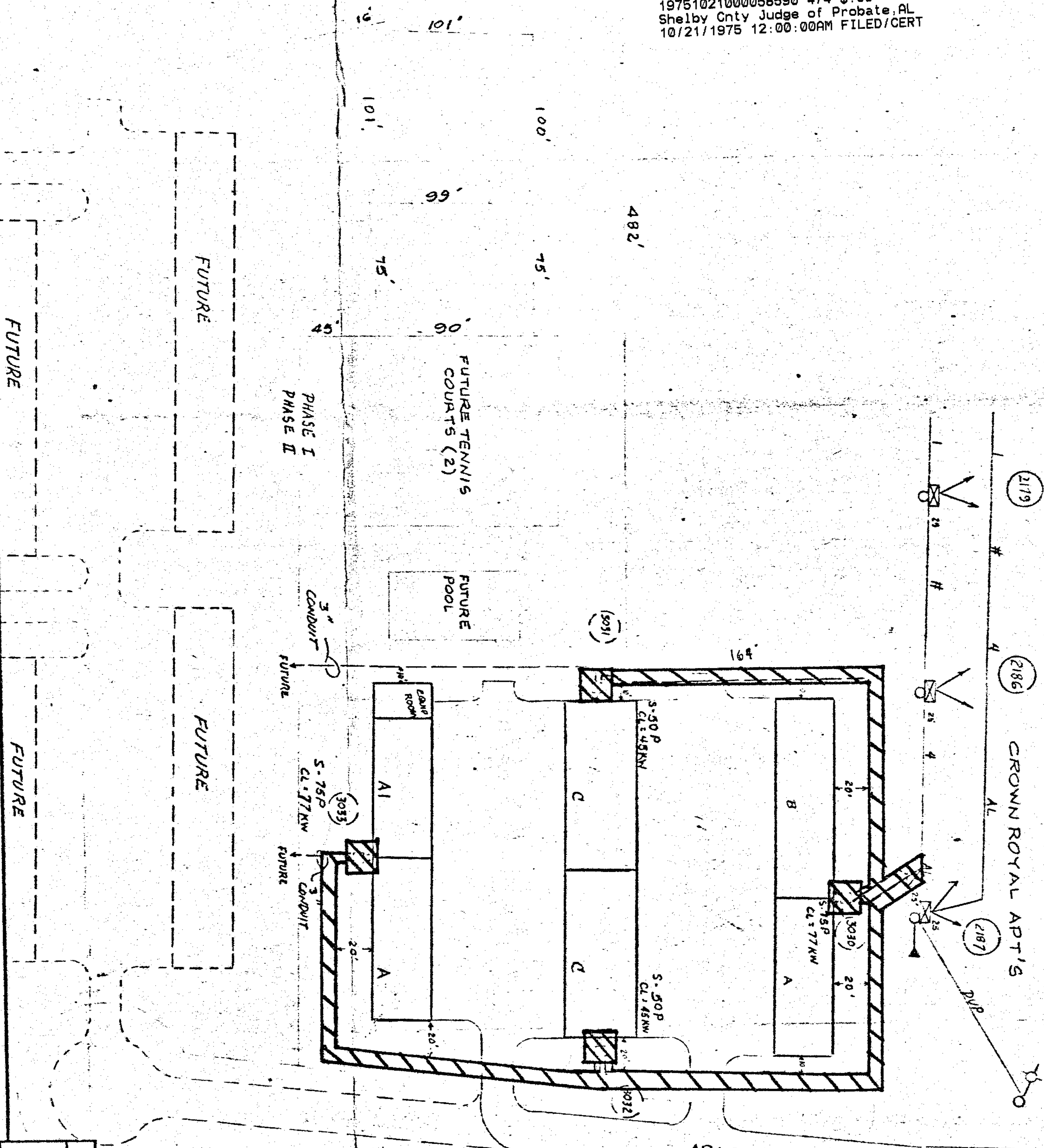

STATE OF ALA. SHELBY CO.
 I CERTIFY THIS
 INSTRUMENT WAS FILED
 1975 OCT 21 PM 12:26
Neil Taylor
 JUDGE OF PROBATE

PRIMARY - 1#24XN
 3 INCH CONDUIT UNDER PAVEMENT
 TOTAL PRIMARY LOADING - 464 KVA
 (INCLUDES FUTURE)

- LOAD DATA
- A --- (3) LFRW 21HP
 - A1 --- (3) LFRW 21HP
 - B --- (4) LFRWD 21HP
 - C --- (6) LFRW 1 1/2 TH

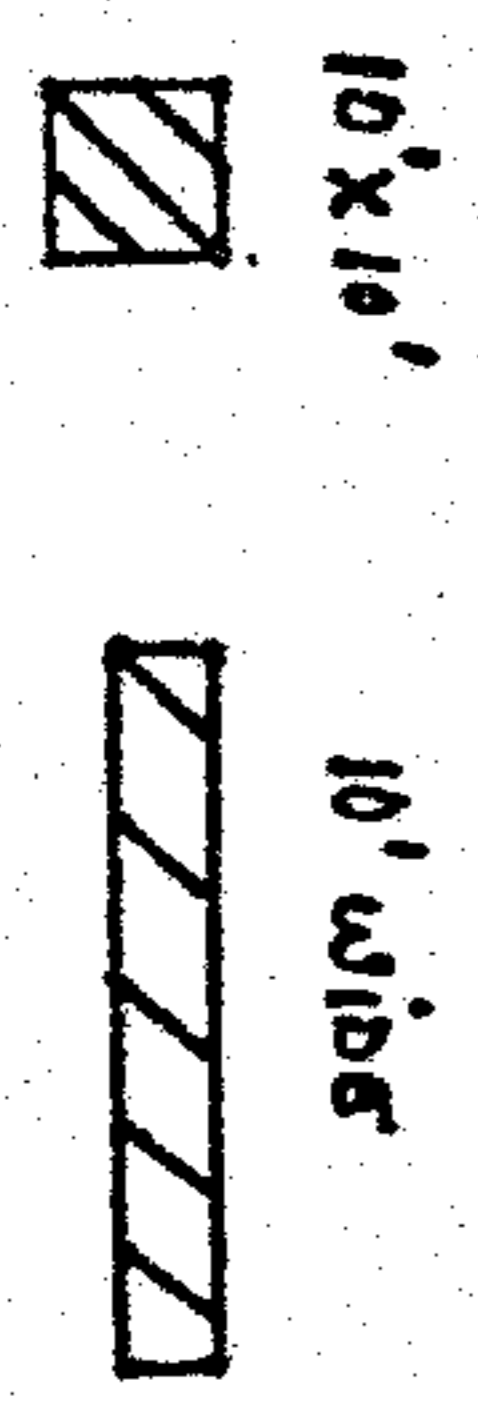

C-55507-6
 SEC 21
 DRAWN GLASS CHECKED
 TRACED
 DATE 8-19-75

6430-99-1
ALABAMA POWER COMPANY
 JOB MONTEVALLO 12KV DISTRIBUTION
 DETAIL FALCON MEIJDOR II APTS (UAD)

SCALE 1" = 50'
 SHEET 1 OF 1 SHEETS