

19740814000040210 1/1 \$.00
Shelby Cnty Judge of Probate, AL
08/14/1974 12:00:00AM FILED/CERT

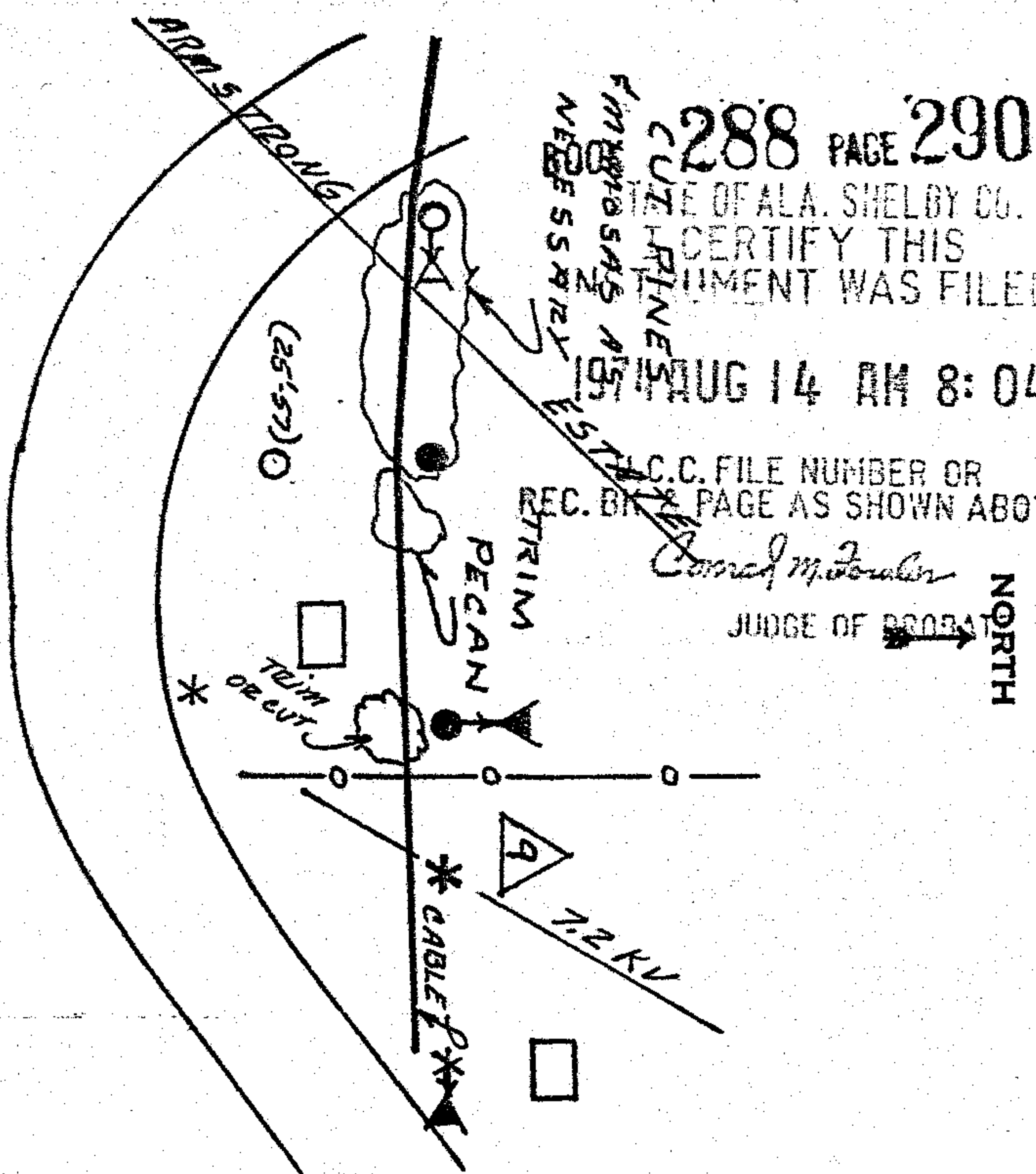

1636

Name and Post Office Address of Grantor BILLY K. GRAHAM
RT 1 BOX 307
CALEERA, ALA.

Toll Line _____ (Name)
Or Exchange Line _____ (Exchange)
tributary to _____

The Property is bounded where the line enters and leaves this property by the property of:
ARMSTRONG ESTATE on the W and _____ on the _____

The poles (or stakes) have the following identification: P-3 to P-6
Authority 34-0553 Classification 1C
Area BHAM SOUTH DIST
Approved [Signature]
Title DIST ENGR

STATE OF ALA. SHELBY CO. CERTIFY THIS DOCUMENT WAS FILED
AUG 14 AM 8:04
C.C. FILE NUMBER OR REC. BY PAGE AS SHOWN ABOVE
JUDGE OF PROBATE

GEF 47.101 GENERAL PERMIT (INDIVIDUAL) Form 8416 Nov. '54

Received of the SOUTH CENTRAL BELL TELEPHONE COMPANY ONE AND NO/100

Dollars in consideration of which (I) (We) hereby grant said Company, its associated and allied companies, their respective licensees, successors and assigns, the right to construct, operate and maintain a line of communication consisting of such poles, wires, cables, conduits, guys, anchors and other necessary appurtenances as from time to time are required upon, across, over and/or under that certain tract of land situated in SHELBY County, State of ALABAMA, to-wit:
SECTION 12 T. 24N RANGE 13E

and upon, along and under the roads, streets, or highways adjoining or through said property with the right to permit the attachment of and/or carry in conduit wires and cables of any other person or company for communications purposes or for the transmission and distribution of electric power and the right of ingress and egress to said premises at all times for the purpose of inspecting and maintaining said line and with the right to clear and keep cleared all trees, undergrowth or other obstructions within a strip of land 5 feet on each side of the center of said line and to trim and cut and keep trimmed and cut all dead, weak, leaning or dangerous trees which might reach said line in falling; including the right to relocate said line on said premises to conform to any future highway relocation, widening or improvement; the said sum being received in full payment for the rights herein granted.

PERMISSION IS ALSO GRANTED FOR ALABAMA POWER TO
PLACE AN INTERMEDIATE POLE AT ARBITRARY #9 AS SHOWN ON SKETCH

Signed, sealed and delivered in the presence of: Executed 7-29, 1974

[Signature] Billy Graham (SEAL)
[Signature] Louis W. Graham (SEAL)