

19720911000045080 1/4 \$.00
Shelby Cnty Judge of Probate, AL
09/11/1972 12:00:00 AM FILED/CERT

6010 DSO BD-280 1972
Provide 277/480 v Service to
Irrigation Pumps at Fletcher Properties
Inc.
Cahaba Heights

STATE OF ALABAMA)
:
COUNTY OF SHELBY)

Fletcher Properties of Alabama, Inc.

KNOW ALL MEN BY THESE PRESENTS, that the undersigned,

Fletcher Properties of Alabama, Inc

for and in consideration of the sum of ONE AND NO/100 DOLLARS (\$1.00),
to it in hand paid by ALABAMA POWER COMPANY, a corporation, the receipt
whereof is acknowledged, does hereby grant to said ALABAMA POWER COMPANY,
its successors and assigns, the right to construct, install, operate
and maintain, and the right to permit other corporations and persons
to construct, install, operate and maintain, along a route to be selected
by the grantee, (generally shown crosshatched on the attached drawing)
its successors or assigns, all conduits, cables, trans closures and other
appliances and facilities useful or necessary in connection therewith,
for the underground transmission and distribution of electric power and
for the underground communication service, upon, under and across the
following described land, situated in Shelby County, Alabama:

Commence at the Northeast corner of the Southeast
Quarter of the Northwest Quarter of Section 2,
Township 19 South, Range 2 West; thence South 00°
48' 00" East, 296.46 feet to a point; thence South
55° 20' 20" East 332.39 feet to a point; thence
South 34° 39' 40" West, 70.0 feet to the point of
beginning; thence South 55° 20' 20" East, 24.97
feet to a point; thence North 74° 25' 50" East,
575.62 feet to a point; thence North 45° 00' 00"
176.78 feet to a point; thence South 45° 00' 00"
East, 34.45 feet to a point; thence South 45° 00'
00" West, 176.78 feet to a point; thence South
74° 25' 50" West, 606.60 feet to a point; thence

This instrument prepared in
the Land Dept. of Alabama
Power Co., Birmingham, AL
by *[Signature]*

BOOK 276 PAGE 257



19720911000045080 2/4 \$.00
Shelby Cnty Judge of Probate, AL
09/11/1972 12:00:00 AM FILED/CERT

North 55° 20' 20" West, 382.26 feet to a point;
thence North 40° 33' 27" East, 30.16 feet to a
point; thence South 55° 20' 20" East, 340.10 feet,
more or less, to the point of beginning, contain-
ing 0.80 acres, more or less.

Together with all the rights and privileges necessary or
convenient for the full enjoyment or use thereof, including the right
of ingress and egress to and from said facilities and the right to
excavate for installation, replacement, repair and removal thereof;
and also the right to cut and keep clear all trees, underbrush, shrub-
bery, roots and other growth, and to keep clear any and all obstructions
or obstacles of whatever character on, under or above said facilities.

TO HAVE AND TO HOLD the same to the said ALABAMA POWER COMPANY,
its successors and assigns, forever.

IN WITNESS WHEREOF, the said Fletcher Properties
OF ALABAMA, INC has caused this instrument to
be executed in its name by Bud Fielder, as its
Vice-President, and attested by _____, its
_____, and its corporate seal to be hereto affixed,
on this the 10th day of August, 1972.

ATTEST:

By Bud Fielder
ITS VICE-PRESIDENT
Fletcher Properties OF ALABAMA, INC.

By _____
Its Vice-President

BOOK 270 PAGE 258

STATE OF ALABAMA)
COUNTY OF JEFFERSON)

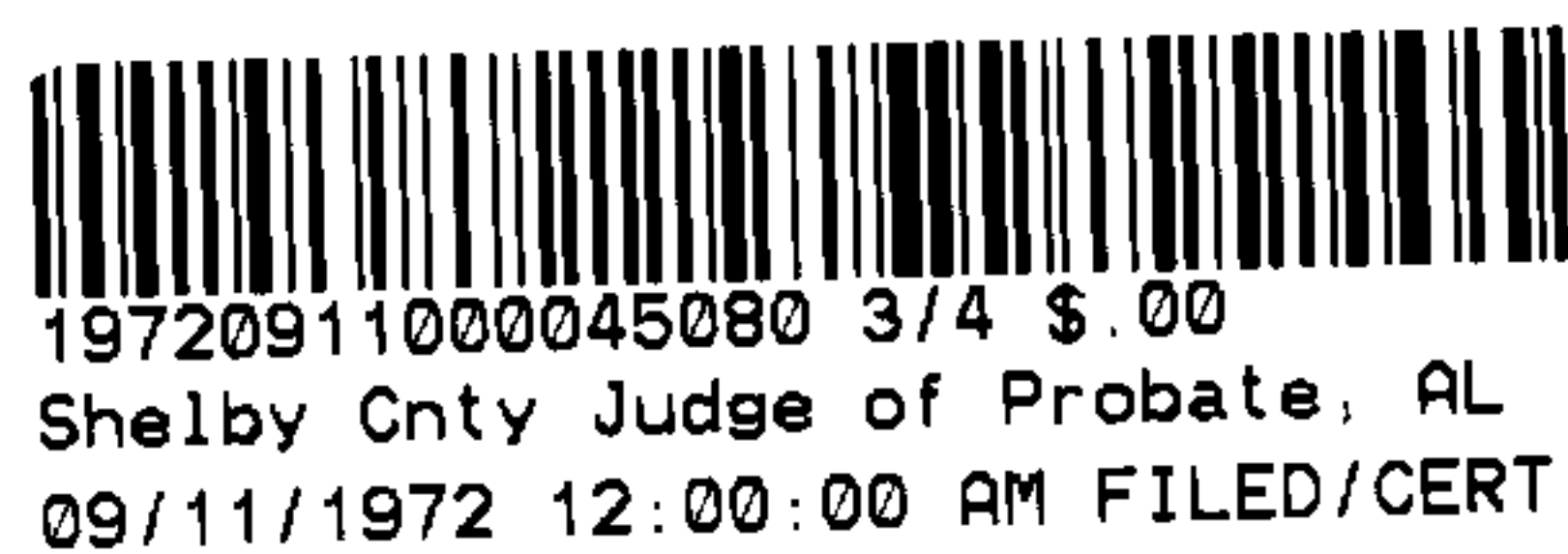

I, N. WAYNE TAYLOR,
a Notary Public, in and for said County in said State, hereby certify
that Bud Fielder

whose name as Vice-President
of Fletcher Properties of ALABAMA, Inc.,
a corporation, is signed to the foregoing instrument, and who is known
to me, acknowledged before me on this day that, being informed of the
contents of this instrument, he as such officer and with full authority
executed the same voluntarily for and as the act of said corporation.

Given under my hand and official seal, this the 10th
day of August, 1972.

N. Wayne Taylor
Notary Public



19720911000045080 4/4 \$.00
Shelby Cnty Judge of Probate, AL
09/11/1972 12:00:00 AM FILED/CERT

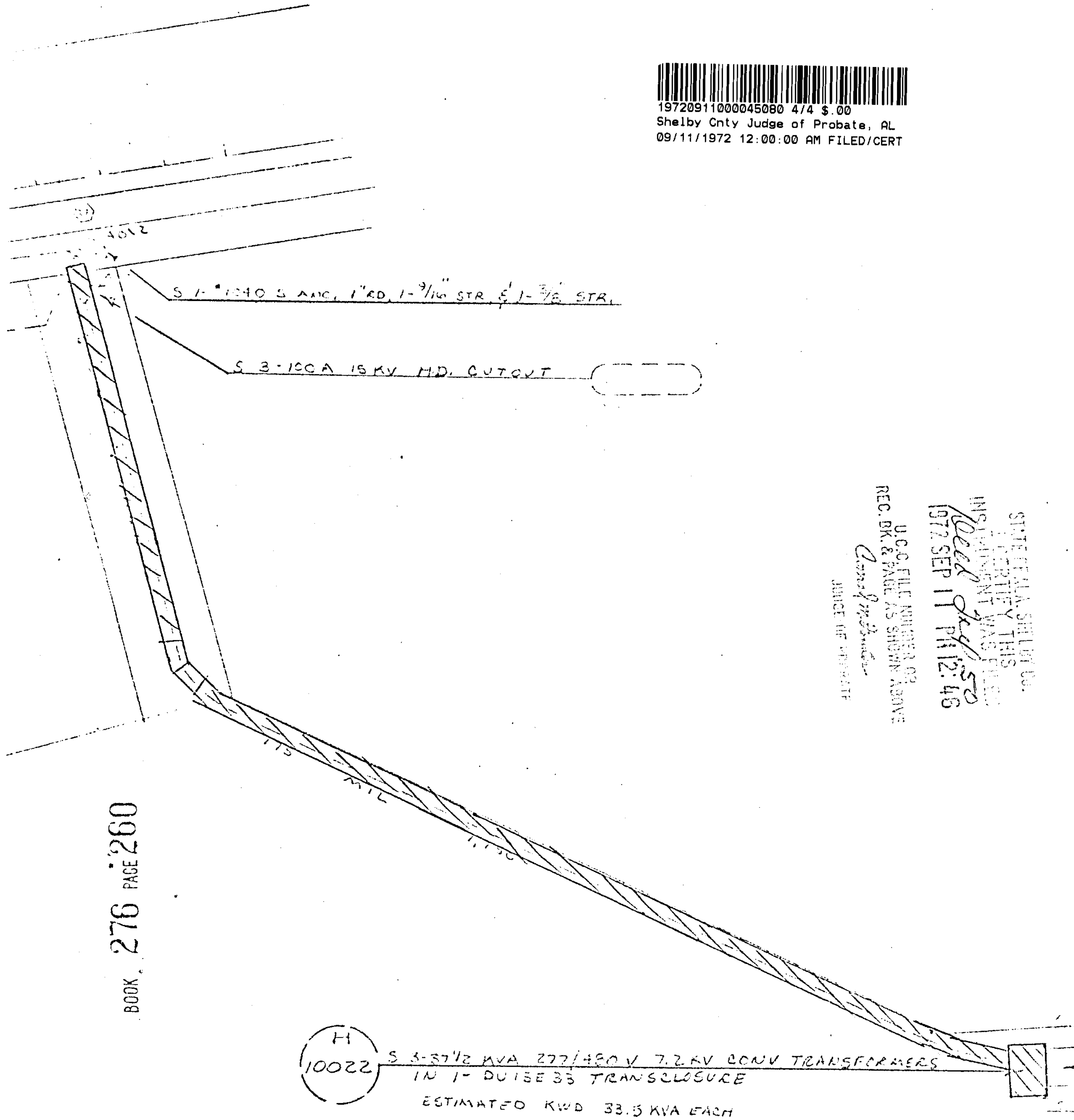

SHIRLEY A. SHILOH Co.
I CERTIFY THIS
INSTRUMENT WAS FILED
1972 SEP 11 PM 12:46
REC. BK. & PAGE AS SHOWN ABOVE
U.C.C. FILE NUMBER 02
JUDGE OF PROBATE

BOOK 276 PAGE 260

H
10022

S 3-37 1/2 KVA 277/480 V 7.2 KV CONV TRANSFORMERS
IN 1- DUIS 33 TRANSCLASURE
ESTIMATED KWD 33.5 KVA EACH

DRAWN	CLM	CHECKED	
APPROVED	S W Risher		
APPROVED			