



19720417000020240 1/4 \$.00
Shelby Cnty Judge of Probate, AL
04/17/1972 12:00:00 AM FILED/CERT

6010 DSO 6430-90-1 1971
Town and Country #2
Montevallo Dist.

8657

STATE OF ALABAMA)
COUNTY OF SHELBY)

KNOW ALL MEN BY THESE PRESENTS, that the undersigned,

BORINQUEN FARMS, INC.

for and in consideration of the sum of One and No/100 Dollar (\$1.00), to them in hand paid by Alabama Power Company, a corporation, the receipt whereof is acknowledged, do hereby grant to said Alabama Power Company, its successors and assigns, the right to construct, install, operate and maintain, and the right to permit other corporations and persons to construct, install, operate and maintain, along a route to be selected by the grantee, (generally shown crosshatched on the attached drawing) its successors or assigns, all conduits, cables, trans closures and other appliances and facilities useful or necessary in connection therewith, for the underground transmission and distribution of electric power and for underground communication service, upon, under and across the following described land, situated in Shelby County, Alabama:

Commence at the northeast corner of the southeast quarter of the northeast quarter of Section 21, Township 22 south, Range 3 west; thence run westward 200 feet to the west side of Commanche Road; thence turn 92 degrees 13 minutes left along said road 277.97 feet to the point of beginning; thence continue said course 252.20 feet to the point of intersection of north side of Overland Road; thence westward along the north right of way of Overland Road 310.20 feet; thence turn 88 degrees 41 minutes right 275.0 feet; thence turn 90 degrees right 331.50 to the point of beginning.

273

BOOK 273 PAGE 817



19720417000020240 2/4 \$.00
Shelby Cnty Judge of Probate, AL
04/17/1972 12:00:00 AM FILED/CERT

A parcel of land situated in the southeast quarter of the northeast quarter of Section 21, Township 22 south, Range 3 west, described as follows: Begin at the northeast corner of said quarter-quarter section; thence westward 150.0 feet to the east boundary of Commanche Road; thence 92 degrees 13 minutes left 439.40 feet to the point of beginning; thence continue same course 93.03 feet to the beginning of a curve turning left, said curve having a central angle of 87 degrees 36 minutes, a radius of 25.00 feet and sub-tended by a cord 34.61 feet in length and making an angle of 43 degrees 48 minutes left from previous course; thence along this curve 38.22 feet; thence 43 degrees 48 minutes left from said cord 106.03 feet along north line of Overland Road; thence 90 degrees 00 minutes left 122.45 feet; thence 92 degrees 24 minutes left 135.78 feet to point of beginning.

Together with all the rights and privileges necessary or convenient for the full enjoyment or use thereof, including the right of ingress and egress to and from said facilities and the right to excavate for installation, replacement, repair and removal thereof; and also the right to cut and keep clear all trees, underbrush, shrubbery, roots and other growth, and to keep clear any and all obstructions or obstacles of whatever character on, under or above said facilities.

TO HAVE AND TO HOLD the same to the said Company, its successors and assigns, forever.

IN WITNESS WHEREOF, we have hereunto set our hands and seals, this the 10th day of February, 1972.

WITNESS:

BORINQUEN FARMS, INC.

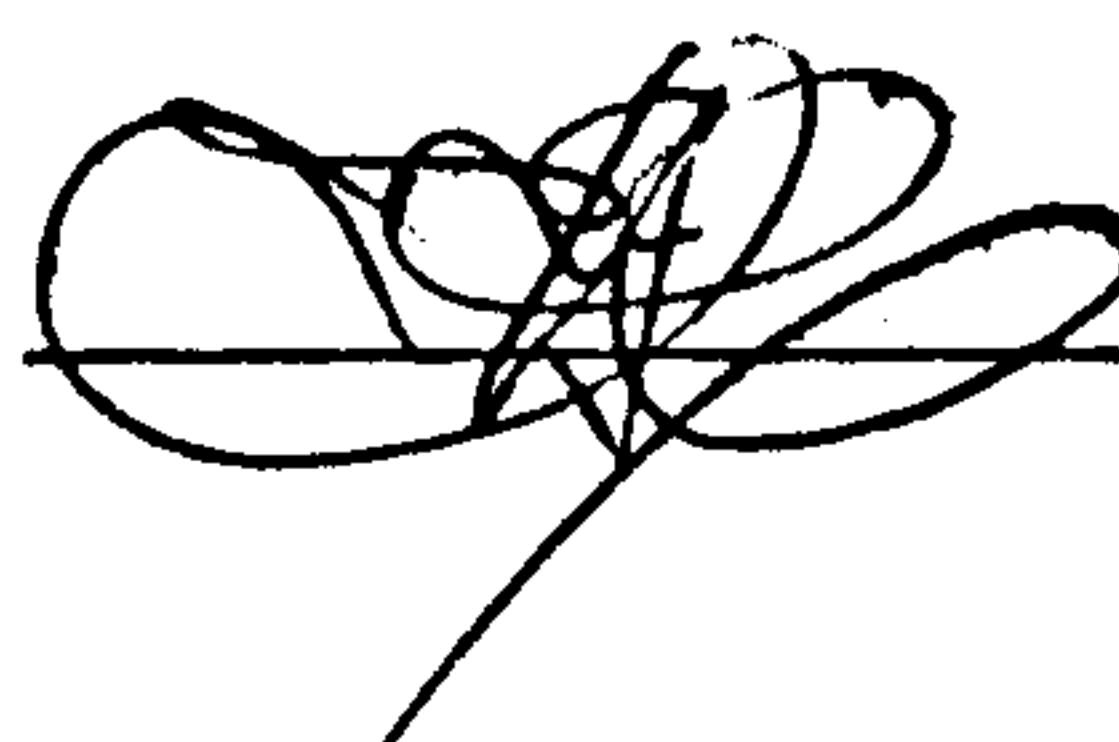

By William B. Surace (Seal)
President

ATTEST:

June C. Surace (Seal)
Secretary

STATE OF ALABAMA)
COUNTY OF SHELBY)

I, _____ the undersigned _____,
a Notary Public _____, in and for said County in said
State, hereby certify that William B. Surface _____

_____ as President of Borinquen Farm
whose name is _____ signed to the foregoing instrument/and who is _____ Inc.

known to me, acknowledged before me on this day that being informed
of the contents of the instrument he executed the same voluntarily, for
and as the act of said corporation, and with full authority,
on the day the same bears date.

Given under my hand and official seal, this the 10th day
of February, 1972.

Nancy K. Brasher
Notary Public

STATE OF ALA. SHELBY CO.
I CERTIFY THIS
INSTRUMENT WAS FILED
1972 APR 17 PM 3:46
JUDGE OF PROBATE
REC. BK. & PAGE AS SHOWN ABOVE
U.C.C. FILE NUMBER OR
CORRESPONDENCE



19720417000020240 3/4 \$.00
Shelby Cnty Judge of Probate, AL
04/17/1972 12:00:00 AM FILED/CERT

BOOK 273 PAGE 819 A



19720417000020240 4/4 \$.00
Shelby Cnty Judge of Probate, AL
04/17/1972 12:00:00 AM FILED/CERT

6430-90-1
Town + County Apt 237427

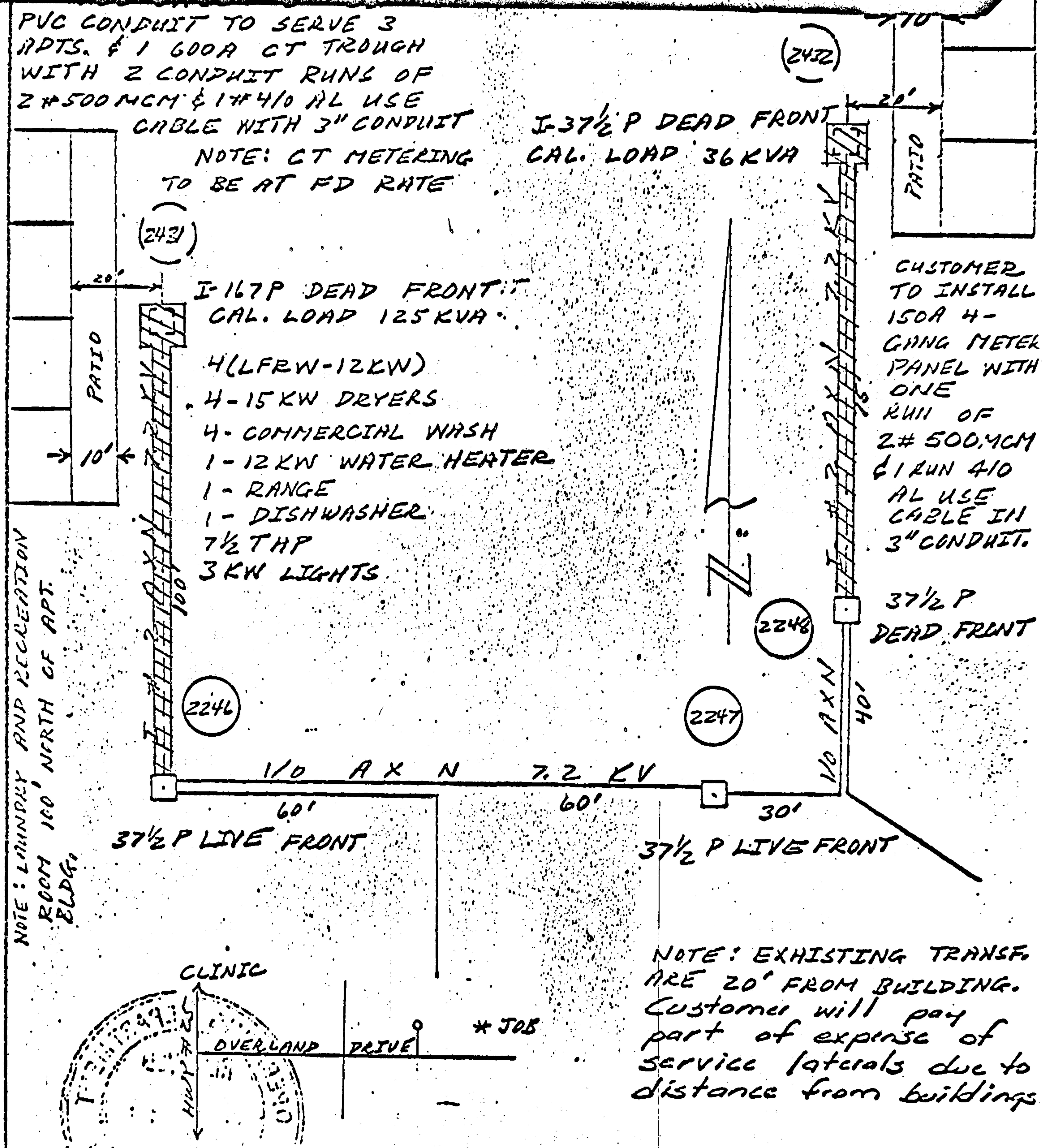

DR. <u>RIGBY</u>	NO.	DATE	REVISION	ALABAMA POWER COMPANY	
TR.				SUBJECT <u>MONTEVALLO 7.2 KV URD</u>	
CK.				DETAIL <u>SERVICE TO TOWN & COUNTRY</u>	
APP.				APTS. SECTION #2	
DATE <u>10-1-71</u>	SUPERSEDES			SCALE <u>1" = 30'</u>	SH. <u>1</u> OF <u>2</u> SHEETS
					A-646-77

Book 273 Page 819 B.