

STATE OF ALABAMA)
COUNTY OF SHELBY)

2457

KNOW ALL MEN BY THESE PRESENTS, that the undersigned,
WE, JOHN F. MATHERS, AND WIFE ALMA S.
MATHERS

for and in consideration of the sum of One and No/100 Dollars (\$1.00),
to them in hand paid by Alabama Power Company, a corporation, the receipt
whereof is acknowledged, does hereby grant to said Alabama Power Company,
its successors and assigns, the right to construct, install, operate
and maintain, and the right to permit other corporations and persons
to construct, install, operate and maintain, along a route to be
selected by the grantee, (generally shown crosshatched on the attached
drawing) its successors or assigns, all conduits, cables, trans closures
and other appliances and facilities useful or necessary in connection
therewith, for the underground transmission and distribution of electric
power and for the underground communication service, upon, under and across
the following described land, situated in Shelby County, Alabama:

All that portion of the east half of the southeast
quarter of Section 3, Township 22 south, Range 3
west that lies south of Highway 22; all that portion
of the southeast quarter of the northeast quarter of
said section that lies south of Highway 22; a strip
of land in Section 2, Township 22 south, Range 3 west,
bordering on the westside of said section and having
a uniform width of 220.0 feet and extending northward
from the south side of said section to Highway 22,
according to survey made on March 29, 1969.

BOOK 267 PAGE 93



19710409000013480 1/4 \$.00
Shelby Cnty Judge of Probate, AL
04/09/1971 12:00:00 AM FILED/CERT



19710409000013480 2/4 \$.00
Shelby Cnty Judge of Probate, AL
04/09/1971 12:00:00 AM FILED/CERT

Together with all the rights and privileges necessary or convenient for the full enjoyment or use thereof, including the right of ingress and egress to and from said facilities and the right to excavate for installation, replacement, repair and removal thereof; and also the right to cut and keep clear all trees, underbrush, shrubbery, roots and other growth, and to keep clear any and all obstructions or obstacles of whatever character on, under or above said facilities.

TO HAVE AND TO HOLD the same to the said Company, its successors and assigns, forever.

IN WITNESS WHEREOF, we have hereunto set our hands and seals,
this the 15th day of MARCH, 1971.

WITNESS:

Thaddeus Bowditch Alma D. Mathers (Seal)

J. C. Gibson John L. Mathers (Seal)

STATE OF Alabama)

COUNTY OF Jefferson)

I, Marguerite Tate,

a Notary Public

in and for said County in said State, hereby certify that

Adna S. Mathers and John T. Mathers

whose names are signed to the foregoing instrument and who

are known to me, acknowledged before me on this day that being

informed of the contents of the instrument, they

executed the same voluntarily, on the day the same bears date.

Given under my hand and official seal, this the 18th

day of March, 1971.

Marguerite Tate
Notary Public

My Commission Expires January 27, 1972



19710409000013480 3/4 \$.00
Shelby Cnty Judge of Probate, AL
04/09/1971 12:00:00 AM FILED/CERT

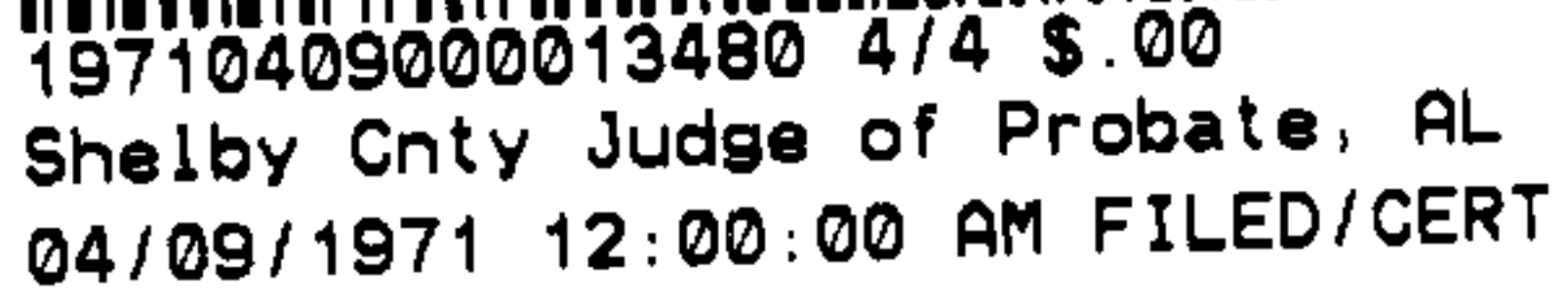

AC-2315-S-112425

ALABAMA POWER COMPANY SKETCH OF PROPOSED WORK

OSO OR SERIAL NO. 6430-115

DIVISION WATER SKETCH OF PROPOSED WORK ESTIMATE NO. 100
 TOWN WATER DISTRICT WATER DRAWN BY WATER DATE 2-17-71
 SCALE 1" = 100' FT. PER INCH SECT. 243 TOWNSHIP 240 RANGE 2-00 MAP REFERENCE 6-60269-5

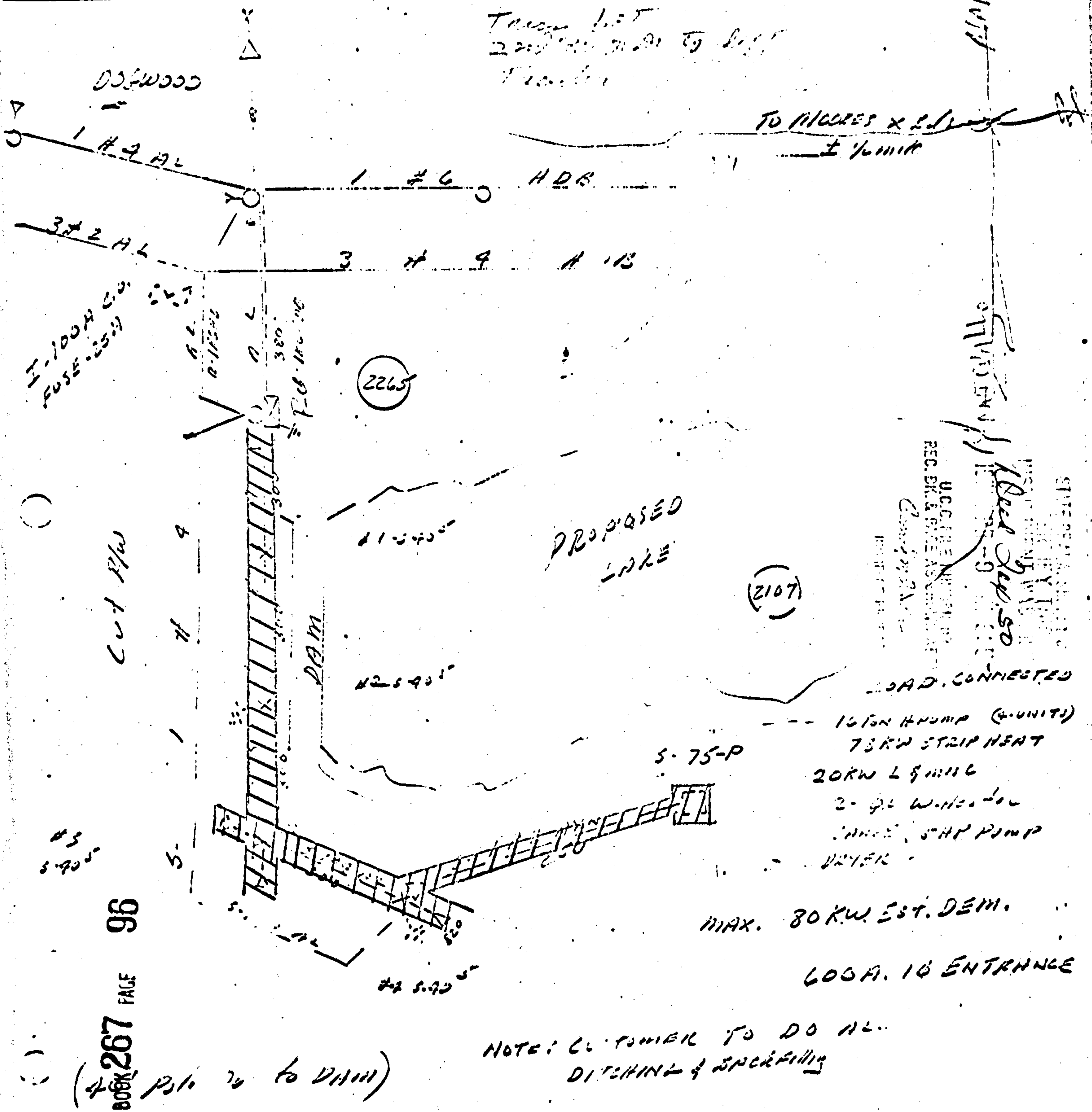

STANDARD SYMBOLS SHOWN IN DISTRIBUTION STANDARDS TO BE USED