

1.95

2080

SEE ATTACHMENT

Name and Post Office Address of Grantor: Robert E. Lee
U. S. Highway 31
Pelham, Alabama

Toll Line (Name) _____
 or Exchange Line Siluria
 tributary to (exchange) _____

The property is bounded where the line enters and leaves this property by the property of: _____

Rt. E. Lee on the East and US Hwy 31 on the West

The poles (or stakes) have the following identification: None

to _____
 Authority Classification 45C
Area B'hom-South (Siluria)
 Approved by Lutz
 title District Engineer
North

RIGHT-OF-WAY EASEMENT

FORM 8318 BC NOV., 1968

In consideration of the sum of money hereinafter set out and other good and valuable consideration, the adequacy and receipt of which is hereby acknowledged from the South Central Bell Telephone Company, the undersigned, owner(s) of the premises described below, do hereby grant to the South Central Bell Telephone Company, its licensees, agents, successors, assigns, and allied and associated companies, a right of way easement to construct, operate, maintain, add or remove such lines or systems of communications or related services as the grantee may require, consisting of:

- ~~(1) poles, guys, anchors, aerial cables and wires;~~
- (2) Buried cables and wires, cable terminals, markers, splicing boxes and pedestals;
- (3) Conduits, manholes, markers, underground cables and wires;
- (4) and other amplifiers, boxes, appurtenances or devices

upon over and under a strip of land 4 feet wide across the following lands in Shelby County, State of Ala., generally described as follows:

A certain tract of land located in the northeast quadrant of Sec. 11 Township 20 South, Range 3 West.

and, to the fullest extent the undersigned has the power to grant, if at all, over, along and under the roads, streets or highways adjoining or through said property.

The following rights are also granted: to allow any other person or company to attach wires or lay cable or conduit within the right of way for communications or electric power transmission or distribution; ingress and egress to said premises at all times; to clear the land and keep it cleared of all trees, undergrowth or other obstructions within the easement area; to trim and cut and keep trimmed and cut all dead, weak, leaning or dangerous trees or limbs outside of the easement area which might interfere with or fall upon the lines or systems of communications or power transmission or distribution.

The receipt of one and -- /100 Dollars (\$1.00) is hereby acknowledged by the undersigned.

To have and to hold the above granted easement unto South Central Bell Telephone Company, its successors and assigns forever.

IN WITNESS WHEREOF, the undersigned has signed and sealed this document

on April 10, 1970

Signed, sealed and delivered in the presence of:

R. E. Lee L.S.

Witness
James C. Moon

Attest: _____
 Corporate Officer

 Name of Corporation
 By: _____
 Title:

108
 282
 800K 282

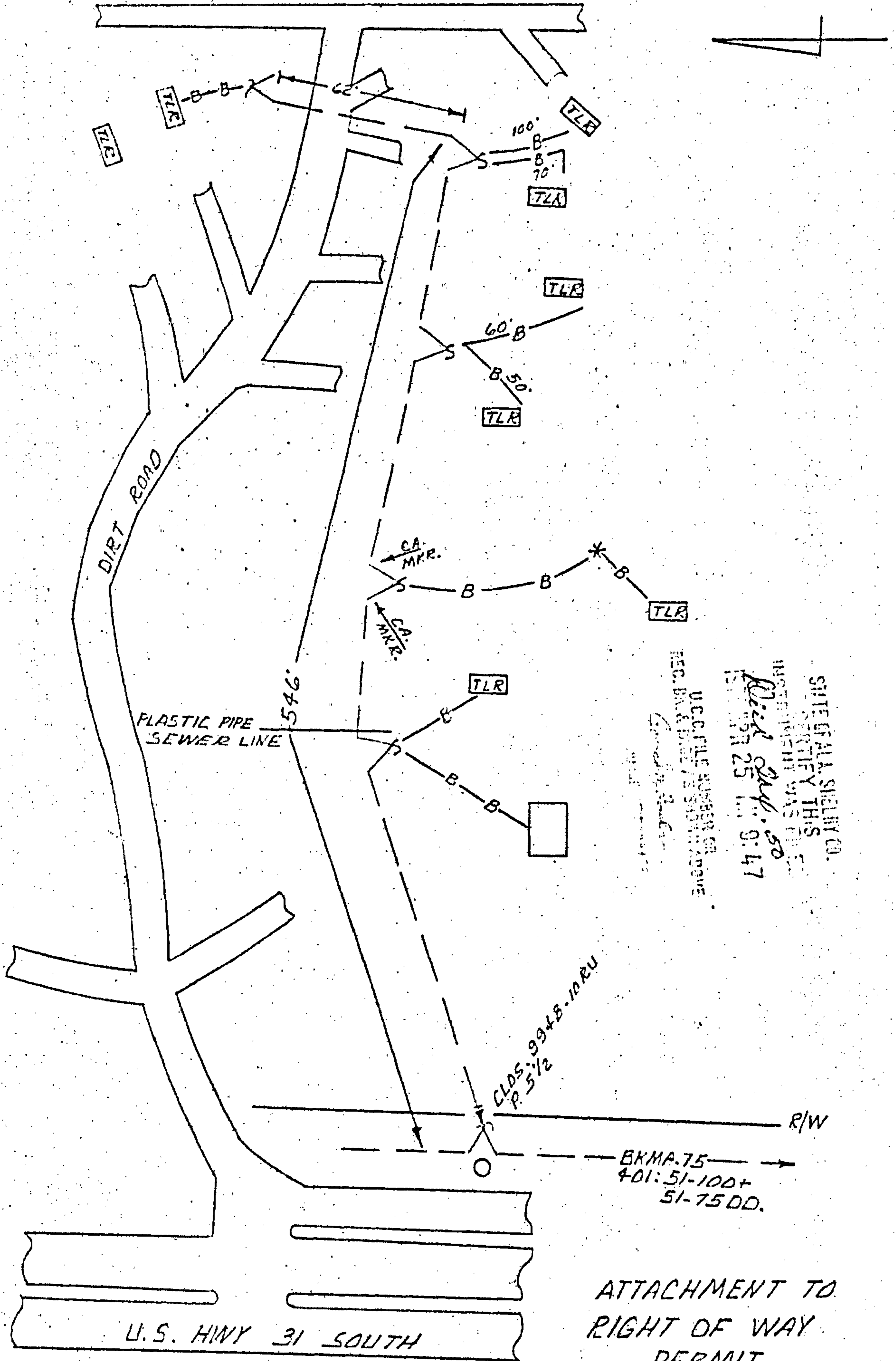

UCC FILE NUMBER 00
REC. DATE 11/15/2000

SAFETY SHEET CO.
VERIFY THIS
INSTRUMENT WAS
RECORDED
25 NOV 2000 9:47

ATTACHMENT TO
RIGHT OF WAY
PERMIT
JOB-044-0107