

3094

BOOK 160 PAGE 4

THIS SUPPLEMENTAL AGREEMENT, made and entered into this 25 day of February, 1953, by and between

SOUTHERN RAILWAY COMPANY, a corporation of the State of Virginia, hereinafter for convenience styled the Railway Company, party of the first part; and

COUNTY OF SHELBY, Alabama, a municipal corporation of the State of Alabama, hereinafter for convenience styled the County, party of the second part;

W I T N E S S E T H:

THAT the PARTIES HERETO, for good and sufficient considerations thereunto moving them, do hereby mutually covenant and agree that, effective as of the 25 day of February, 1953, the agreement, in writing, heretofore made and entered into by and between them, dated July 28, 1952, concerning highway encroachments, at or near ALDRICH, DOGWOOD, RYAN and MAYLENE, in the County of Shelby and State of Alabama, as described in said agreement, shall be, and the same hereby is, modified and amended in the following manner, but not otherwise, that is to say:

By the incorporation in said agreement of July 28, 1952, of an additional paragraph in Article one (1), designated as (c), reading as follows:

"(c) To construct and maintain upon the southeasterly side of the right of way or property of the Railway Company, at or near NOMEN, in the County of Shelby and State of Alabama, a portion of a County road to extend from survey station 1374 + 46 to survey station 1376 + 50, located substantially as shown in red outline on blueprint of Drawing No. 30172, dated August 28, 1952, hereunto annexed and made a part hereof."

IN WITNESS WHEREOF, the parties hereto have executed these presents, in duplicate, each part being an original, as of the day and year first above written.

In presence of:

SOUTHERN RAILWAY COMPANY,  
By

*C. E. Clarke*  
.....

*[Signature]*  
.....  
As to Railway Company.

*[Signature]*  
.....  
Vice President.

In presence of:

COUNTY OF SHELBY, Alabama  
By

*[Signature]*  
.....  
*[Signature]*  
.....  
As to County.

*[Signature]*  
.....  
Chairman, Board of Revenue & Control,  
Shelby County.

SHELBY Co., ALA.  
V-86 MAP 7

26-P

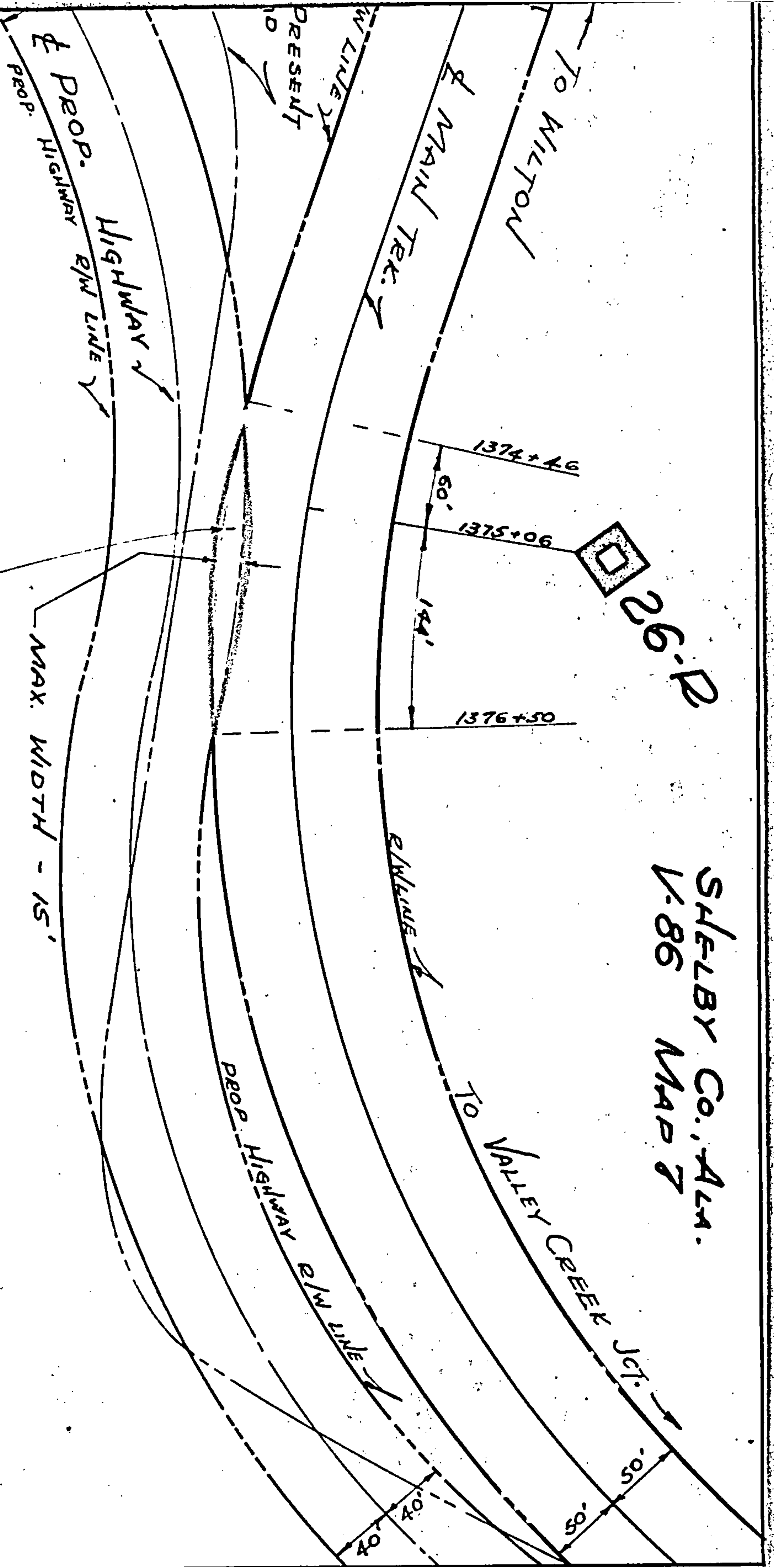

ENCROACHMENT DESIRED BY  
SHELBY COUNTY - (1st COMM.)  
WITH PROJ. S.A.C.P. 460-A)

# SOUTHERN BY SYSTEM

WESTERN LINES

MOBILE DIV.

(NEAR) NOMEH, ALA.

ENCROACHMENT DESIRED BY THE  
BOARD OF REVENUE AND CONTROL,  
SHELBY COUNTY, COLUMBIA, ALA.

OFF. OF CHIEF ENGR. M.W.S.  
SCALE 1"=100' <sup>BS</sup> CINCINNATI, OHIO  
Aug. 28, 1952

DE. No 30172

Filed in the office of the Probate Judge on the 22 day of Apr 1953 at 8 o'clock PM.  
and recorded in Deed Book 160 Page 4 this 29 day of Apr 1953.  
Deed Tax \_\_\_\_\_ Mortgage Tax \_\_\_\_\_ has been paid.

L.C. Walker, Judge of Probate