

EASEMENT - DISTRIBUTION FACILITIES

STATE OF ALABAMA

10500

COUNTY OF SHELBY

20190515000164650

05/15/2019 11:58:42 AM

ESMTAROW 1/2

This instrument prepared by: **S HOPKINS**

**Alabama Power Company
Corporate Real Estate
2 Industrial Park Drive
Pelham, AL 35124**

KNOW ALL MEN BY THESE PRESENTS That the undersigned CHRISTOPHER S COOPER and JENNIFER C COOPER, husband and wife (hereinafter known as "Grantors", whether one or more) for and in consideration of One and No/100 Dollar (\$1.00) and other good and valuable consideration paid to Grantors in hand by Alabama Power Company, a corporation, the receipt and sufficiency of which are hereby acknowledged, do hereby grant to said Alabama Power Company its successors and assigns (hereinafter the "Company"), the following easements, rights, and privileges:

Overhead and/or Underground. The right from time to time to construct, install, operate and maintain, upon, over, under and across the Property described below all poles, towers, wires, conduits, fiber optics, cables, communication lines, trans closures, transformers, anchors, guy wires, and other facilities useful or necessary in connection therewith (collectively, "Facilities"), for the overhead and/or underground transmission and distribution of electric power and communications, along a route selected by the Company, as determined by the location(s) in which the Company's facilities are to be installed. The width of the Company's right of way will depend on whether the Facilities are underground or overhead: for underground, the right of way will extend five (5) feet on all sides of said Facilities as and where installed; for overhead Facilities, the right of way will extend fifteen (15) feet on all sides of said Facilities as and where installed.

The Company is further granted all the rights or privileges necessary or convenient for the full enjoyment and use of said right of way for the purposes above described, including, without limitation, the right of ingress and egress to and from said Facilities, as applicable, the right to excavate for installation, replacement repair and removal of said Facilities, the right in the future to install intermediate poles and facilities on said right of way, the right to install, maintain, and use anchors and guy wires on land adjacent to said right of way, and also the right to cut, remove, and otherwise keep clear any and all trees, undergrowth, structures, obstructions or obstacles of whatever character, on, under and above said right of way, as applicable. Further, with respect to overhead Facilities, the Company is also granted the right to trim and cut, and keep trimmed and cut, all dead, weak, leaning or dangerous trees or limbs outside of the aforementioned right of way that, in the opinion of the Company, may now or hereafter endanger, interfere with, or fall upon any of said overhead Facilities.

The easements, rights and privileges granted hereby shall apply to, and the word "Property" as used in this instrument shall mean the real property more particularly described in that certain instrument recorded in INSTRUMENT #20171103000400520, in the Office of the Judge of Probate of the above named County.

In the event it becomes necessary or desirable for the Company from time to time to move any of the Facilities in connection with the construction or improvement of any public road or highway in proximity to the Facilities, Grantors hereby grant to the Company the right to relocate the Facilities and, as to such relocated Facilities, to exercise the rights granted above; provided, however, the Company shall not relocate said Facilities on the Property at a distance greater than ten feet (10') outside the boundary of the right of way of any such public road or highway as established or re-established from time to time. This grant and agreement shall be binding upon and shall inure to the benefit of Grantors, the Company and each of their respective heirs, personal representatives, successors and assigns and the words "Company" and "Grantors" as used in this instrument shall be deemed to include the heirs, personal representatives, successors and assigns of such parties.

TO HAVE AND TO HOLD the same to the Company, its successors and assigns, forever.

IN WITNESS WHEREOF, the undersigned Grantors have executed this instrument on this the 22 day of April, 2019.

Monett White
Witness Signature (non-relative)

Monett White
Print Name

Bethany Shirah
Witness Signature (non-relative)

Bethany Shirah
Print Name

Christopher S Cooper
(Grantor) CHRISTOPHER S COOPER

Christopher S Cooper
Print Name

Jennifer C Cooper
(Grantor) JENNIFER C COOPER

Jennifer C Cooper
Print Name

-----For Alabama Power Company Corporate Real Estate Department Use Only-----

W.E. # A6170-00-BD19 Transformer # T0149E All facilities on Grantor: NO STR & LOC to LOC 18S-02E-19 NW/NW, NE/NW

SKETCH OF PROPOSED WORK - SIMPLIFIED W.E.

Map Center UTM: 1799505 12113908
 Map Center Lat/lon: 33.369088 -86.478742
 1 inch = 100 feet
 Alabama Power

Customer CHRIS COOPER	Location 378 CHRISTOPHER COVE	Created Svc Date 1799505	County Shelby	Section 19	Township 19S	Range 07E	Add'l Info. REF #: 1598219	Estimate No. A6170-00-BD19
Division PD BHM	District VARNONS	Town STERRETT	UserID	Created: 4/17/2019	Substation X_460126	Y_XA2380	MISSALL#	

JOB NOTES:
 -JOB TO INSTALL 2 SPANS OF #2 ACSR TO SERVE NEW HOME
 -CUSTOMER TO TRIM TREES
 -JOB ONLY TO SERVE TEMP.
 -PERM SERVICE WILL BE INSTALL ON SEPARATE JOB

DRIVING DIRECTIONS:
 -ACCESS 378 CHRISTOPHER COVE
 -DRIVE TO THE END OF CHRISTOPHER COVE CROSS OVER GAS PIPE LINE. BARE TO RIGHT, THEN TURN LEFT UP GRAVEL DRIVE.
 -ACCESS LOCATIONS 1 & 2 FROM DEERWOOD LAKES.

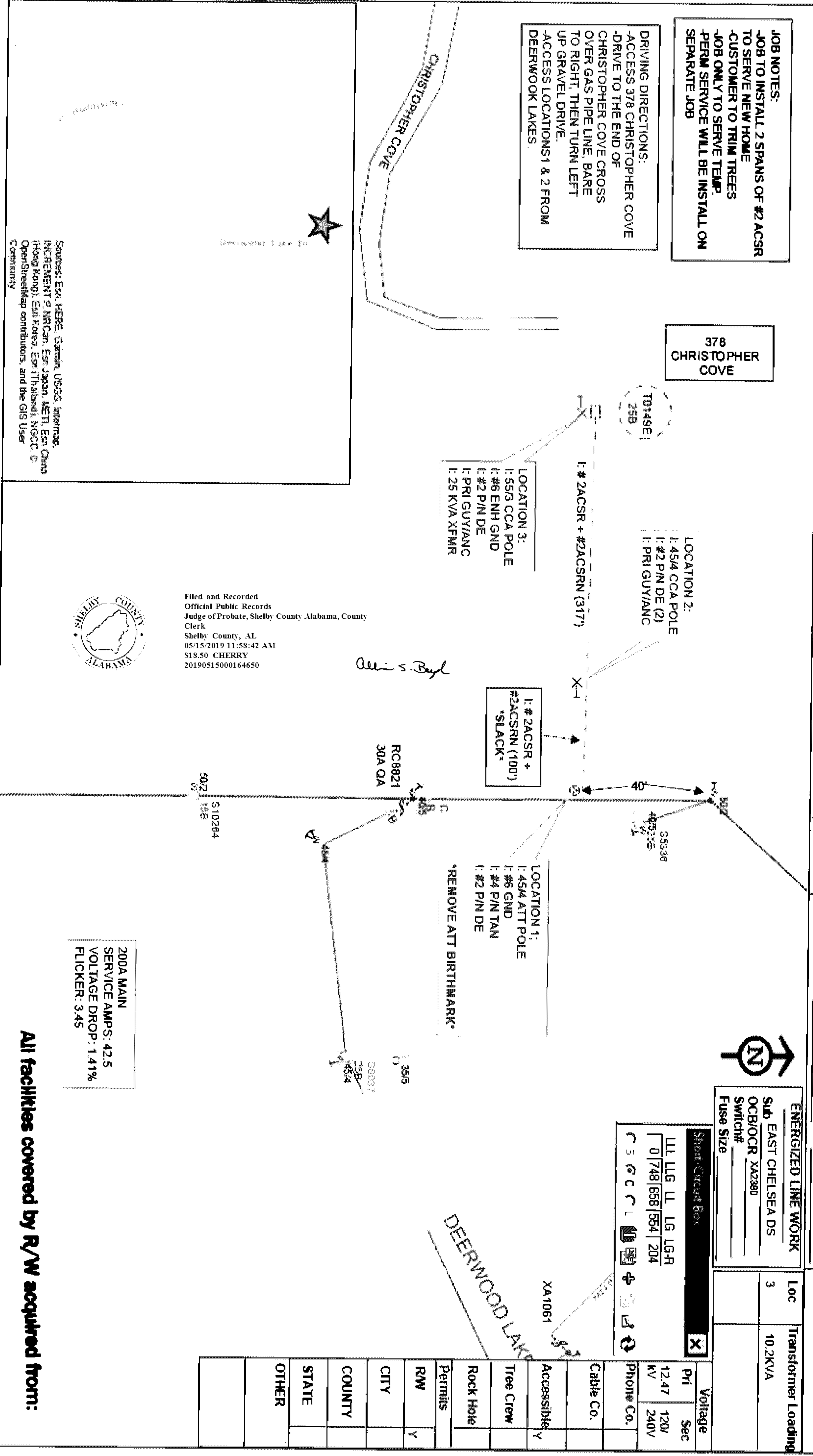

Filed and Recorded
 Official Public Records
 Judge of Probate, Shelby County Alabama, County Clerk
 Shelby County, AL
 05/15/2019 11:58:42 AM
 S18.50 CHERRY
 20190515000164650



Source: Esri, HERE, Garmin, USGS, Intermap, INCREMENT P, NRCan, Esri Japan, METI, Esri China (Hong Kong), Swisstopo, Esri Korea, Esri (Thailand), Swisstopo, OpenStreetMap contributors, and the GIS User Community

ENERGIZED LINE WORK	Loc	Transformer Loading
SUB EAST CHELSEA DS	3	10.2KVA
OCB/OCR XA2380		
Switch#		
Fuse Size		
Sheet Circuit Box		
LL LG LL LG LG-R		
0 748 658 554 204		
Voltage	Pri	Sec
	12.47	120V
		240V
Phone Co.		
Cable Co.		
Accessible		
Tree Crew		
Rock Hole		
Permits		
RW		Y
CITY		
COUNTY		
STATE		
OTHER		

All facilities covered by R/W acquired from:

Job: _____
 Parcel No. 722514804-001
RECORD THIS DRAWING!