

Source of Title:
Instrument Number 20140403000096470

EASEMENT - DISTRIBUTION FACILITIES

STATE OF ALABAMA
COUNTY OF SHELBY

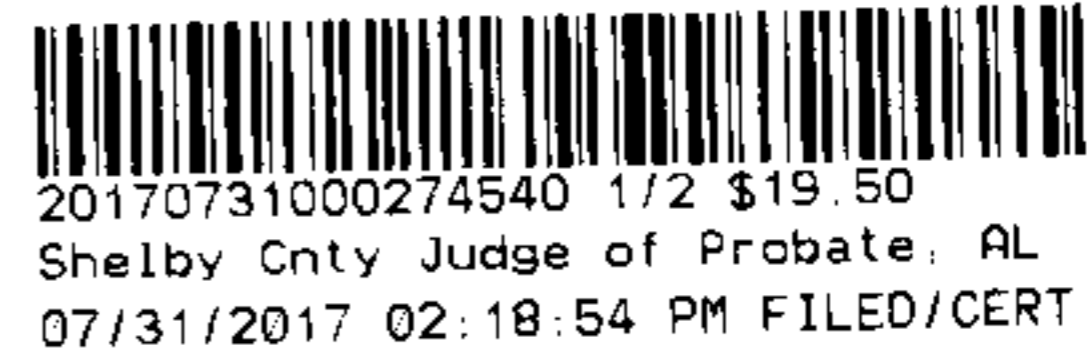

This instrument prepared by: Shannon Floyd \$500

Alabama Power Company
Attn: Corporate Real Estate/12N-0982
600 N. 18th St.
Birmingham, Alabama 35203

KNOW ALL MEN BY THESE PRESENTS, That the undersigned Jason E. Lucia and wife, Andrea B. Lucia AKA JASON Lucia (hereinafter known as "Grantors", whether one or more) for and in consideration of One and No/100 Dollar (\$1.00) and other good and valuable consideration paid to Grantors in hand by Alabama Power Company, a corporation, the receipt and sufficiency of which are hereby acknowledged, do hereby grant to said Alabama Power Company, its successors and assigns (hereinafter the "Company"), the following easements, rights, and privileges:

Overhead and/or Underground. The right from time to time to construct, install, operate and maintain, upon, over, under and across the Property described below, all poles, towers, wires, conduits, fiber optics, cables, communication lines, translosures, transformers, anchors, guy wires, and other facilities useful or necessary in connection therewith (collectively, "Facilities"), for the overhead and/or underground transmission and distribution of electric power and communications, along a route selected by the Company, as determined by the location(s) in which the Company's facilities are to be installed. The width of the Company's right of way will depend on whether the Facilities are underground or overhead: for underground, the right of way will extend five (5) feet on all sides of said Facilities as and where installed; for overhead Facilities, the right of way will extend fifteen (15) feet on all sides of said Facilities as and where installed.

The Company is further granted all the rights or privileges necessary or convenient for the full enjoyment and use of said right of way for the purposes above described, including, without limitation, the right of ingress and egress to and from said Facilities, as applicable, the right to excavate for installation, replacement, repair and removal of said Facilities, the right in the future to install intermediate poles and facilities on said right of way, the right to install, maintain, and use anchors and guy wires on land adjacent to said right of way, and also the right to cut, remove, and otherwise keep clear any and all trees, undergrowth, structures, obstructions, or obstacles of whatever character, on, under and above said right of way, as applicable. Further, with respect to overhead Facilities, the Company is also granted the right to trim and cut, and keep trimmed and cut, all dead, weak, leaning or dangerous trees or limbs outside of the aforementioned right of way that, in the opinion of the Company, may now or hereafter endanger, interfere with, or fall upon any of said overhead Facilities.

The easements, rights and privileges granted hereby shall apply to, and the word "Property" as used in this instrument shall mean the real property more particularly described in that certain instrument recorded in Instrument Number 20140403000096470, in the Office of the Judge of Probate of the above named County.

In the event it becomes necessary or desirable for the Company from time to time to move any of the Facilities in connection with the construction or improvement of any public road or highway in proximity to the Facilities, Grantors hereby grant to the Company the right to relocate the Facilities and, as to such relocated Facilities, to exercise the rights granted above; provided, however, the Company shall not relocate said Facilities on the Property at a distance greater than ten feet (10') outside the boundary of the right of way of any such public road or highway as established or re-established from time to time. This grant and agreement shall be binding upon and shall inure to the benefit of Grantors, the Company and each of their respective heirs, personal representatives, successors and assigns and the words "Company" and "Grantors" as used in this instrument shall be deemed to include the heirs, personal representatives, successors and assigns of such parties.

TO HAVE AND TO HOLD the same to the Company, its successors and assigns, forever.

IN WITNESS WHEREOF, the undersigned Grantors have executed this instrument on this the 29th day of JUNE, 2017.

Chris Shows
Witness Signature (non-relative)
Chris Shows
Print Name
Chris Shows
Witness Signature (non-relative)
Chris Shows
Print Name

Jason Lucia (SEAL)
(Grantor) Jason E. Lucia
Jason Lucia
Print Name
Andrea B Lucia (SEAL)
(Grantor) Andrea B. Lucia
Andrea B Lucia
Print Name

Shelby County, AL 07/31/2017
State of Alabama
Deed Tax: \$.50

For Alabama Power Company Corporate Real Estate Department Use Only

All facilities on Grantor: ~~700~~

Location to Location: Loc 1+00 to 1+60' (easterly)

NE 1/4 of the NE 1/4 of Section 6, Township 24 North, Range 14 East
W.E. No. A6170-00-C417 Transformer No. T0049B

APC Document # _____

R/W Agent Shanna JH
 Date Assigned 6.9.17
 Date Cleared 7.3.17
 Parcel # _____

SKETCH OF PROPOSED WORK - SIMPLIFIED W.E.

Map Center UTM: 1730545 12014011
 Map Center LatLon: 33.095185 -86.705611

Customer WES WYATT	Location CYPRESS LAKES RD.	Contd. Svc Date 11/31/2017	County SHELBY	Section 6	Township 24N	Range 14E	Add'l Info.	Estimate No. A81700C417
Division BIRMINGHAM	District METRO-SOUTH	Town CALERA	UserID mtbryant	Created: 6/7/2017	Substation CALERA_DS X- 45192	Y- XA3587	MISSALL#	

NOTES:
 1) CUSTOMER: WES WYATT
 CONTACT NUMBER: [REDACTED]
 2) CUSTOMER NEEDS UG. SVC. TO A
 NEW PAVILLION
 3) APCO TO DIG, TRENCH, AND INSTALL
 CONDUIT.
 4) CUSTOMER TO PAY BEFORE WORK
 WILL BE PERFORMED.

VOLATAGE DROP: 3.61 %
 FLICKER: 2.98 %
 CURRENT TRANSFORMER
 LOAD: 3.1 KVA
 PROPOSED TRANSFORMER
 LOAD: 22.1 KVA

FAULT CURRENT ESTIMATE
 111 116 U L 16 16R
 0 0 0 112 0 1277

ENERGIZED LINE WORK
 Sub CALERA_DS
 OCB/OCR 45192 / XD8736
 Switch# XA3687
 Fuse Size 20A GA

Loc Transformer Loading

Voltage
 Pri 120 V
 Sec 240 V

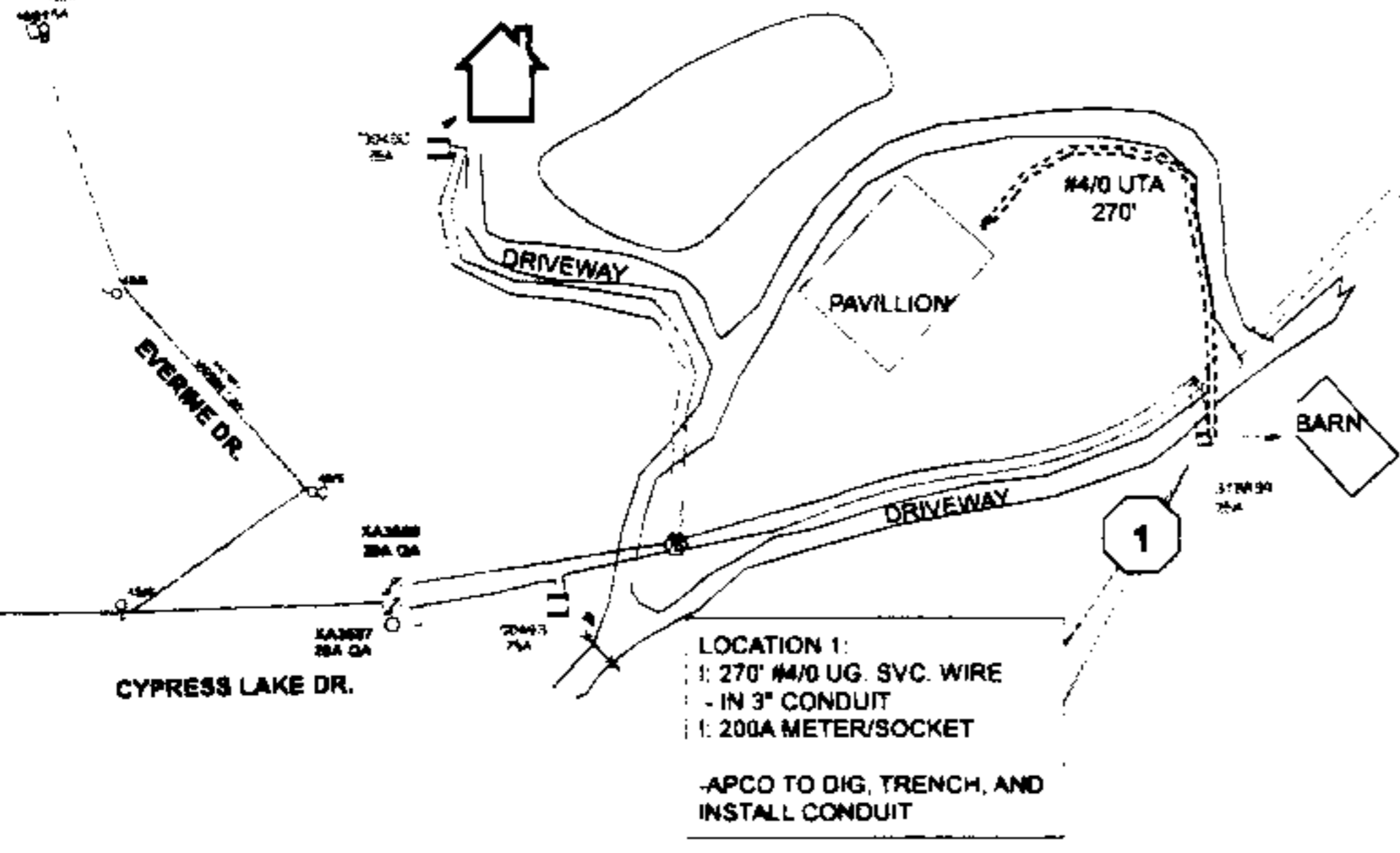

LOCATION 1:
 1: 270' #4/0 UG. SVC. WIRE
 - IN 3" CONDUIT
 1: 200A METER/SOCKET
 -APCO TO DIG, TRENCH, AND
 INSTALL CONDUIT

CABLE PULL

CONDUIT SIZE: 3"	
CABLE TYPE: 1 #1/0 & 2 #4/0 AL	
BENDS: 2 45° MIDDLE OF RUN & 2 90° AT XFMR'S.	
	MAX TENSION
VERTICAL SWEEP BEND DOWN -	75
HORIZONTAL STRAIGHT PULL -	283.57
HORIZONTAL BEND PULL -	382.13
HORIZONTAL BEND PULL -	553.95
HORIZONTAL STRAIGHT PULL -	681.70
VERTICAL SWEEP BEND UP -	837.51

Phone Co.	N
Cable Co.	N
Accessible	Y
Tree Crew	N
Rock Hole	N
Permits	
R/W	Y
CITY	N
COUNTY	N
STATE	N
OTHER	
NTS	

20170731000274540 2/2 \$19.50
 Shelby Cnty Judge of Probate, AL
 07/31/2017 02:18:54 PM FILED/CERT