

EASEMENT - UNDERGROUND

STATE OF ALABAMA

COUNTY OF SHELBY

W.E. No. A6170-00-E915

APCO Parcel No. 70275150

Transformer No. X617

This instrument prepared by: Dean Fritz

20160115000016510

01/15/2016 01:51:22 PM

ESMTAROW 1/2

KNOW ALL MEN BY THESE PRESENTS, That Jeremy D Sims, a married man and Jerry W Sims and wife, Patricia G Sims

as grantor(s), (the "Grantor", whether one or more) for and in consideration of One and No/100 Dollar (\$1.00) and other good and valuable consideration paid to Grantor in hand by Alabama Power Company, a corporation, the receipt and sufficiency of which are hereby acknowledged, does hereby grant to Alabama Power Company, its successors and assigns (the "Company"), the easements, rights and privileges described below.

The right from time to time to construct, install, operate and maintain upon, under and across the Property described below, all wires, cables, trans closures, transformers, conduits, fiber optics, communication lines and other facilities useful or necessary in connection therewith (collectively, the "Facilities"), for the underground transmission and distribution of electric power and communications, along a route selected by the Company which is generally shown on the Company's drawing attached hereto and made a part hereof and which is to be determined by the locations in which the Company's Facilities are installed, such drawing showing the general location of underground facilities in an area ten feet (10') in width and also the right to clear and keep clear a strip of land extending five feet (5') from each side of said Facilities. Grantor hereby grants to the Company all easements, rights and privileges necessary or convenient for the full enjoyment and use thereof, including without limitation the right of ingress and egress to and from the Facilities and the right to excavate for installation, replacement, repair and removal thereof; and also the right to cut, remove and otherwise keep clear any and all structures, obstructions or obstacles of whatever character, or under, adjacent to, and above said Facilities.

The easements, rights and privileges granted hereby shall apply to, and the word "Property" as used in this instrument shall mean, the following real property situated in Shelby County, Alabama (the "Property"): A part of a parcel of land located in the SE 1/4 of the NW 1/4 of Section 34, Township 20 South, Range 3 West, more particularly described in those certain instruments recorded in Instrument #20150313000078300, in the Office of the Judge of Probate of said County, Alabama.

In the event it becomes necessary or desirable for the Company from time to time to move any of the Facilities in connection with the construction or improvement of any public road or highway in proximity to the Facilities, Grantor hereby grants to the Company the right to relocate the Facilities and, as to such relocated Facilities, to exercise the rights granted above; provided, however, the Company shall not relocate the Facilities on the Property at a distance greater than ten feet (10') outside the boundary of the right of way of any such public road or highway as established or re-established from time to time. This grant and agreement shall be binding upon and shall inure to the benefit of Grantor, the Company and each of their respective heirs, personal representatives, successors and assigns and the words "Company" and "Grantor" as used in this instrument shall be deemed to include the heirs, personal representatives, successors and assigns of such parties.

TO HAVE AND TO HOLD the same to the said Company, its successors and assigns, forever.

IN WITNESS WHEREOF, the undersigned Grantor has executed this instrument on this the 2<sup>nd</sup> day of NOVEMBER 2015.

A. Barfield  
Witness

ALLIE BARFIELD  
Print Name

A. Barfield  
Witness

ALLIE BARFIELD  
Print Name

A. Barfield  
Witness

ALLIE BARFIELD  
Print Name

[Signature] (SEAL)  
(Grantor)

Jeremy Sims (SEAL)  
Print Name

[Signature] (SEAL)  
(Grantor)

JERRY SIMS (SEAL)  
Print Name

Patricia Sims (SEAL)  
(Grantor)

Patricia SIMS (SEAL)  
Print Name

All on Grantor

**1 inch = 56 feet**

**ALABAMA**  
**POWER**

Date Assigned 10-22-15

Date Cleared 11-2-15

Parcel # 70275750

Customer Jeremy Sims	Location 101 Lucas Ln	Cmtd. Svc Date December 23, 2015	County SHELBY	Section 34	Township 20S	Range 03W	Estimate No. A6170-00-E915	Missall No. _____ Work Date _____ Time _____ Update _____
Division Birmingham	District Metro South-Varnons	Town Helena	UserID fabrowne	Created: 10/27/2015	Substation Ballantree DS	X-____XD8728	Y-____L6535	

Customer: Jeremy Sims ~~XXXXXXXXXXXXXXXXXXXX~~

Customer required to pay UG CSP cost. APCO to inspect and approved trench and conduit installed by customer.

Customer notified previously installed 2" conduit and depth not sufficient for APCO specifications.

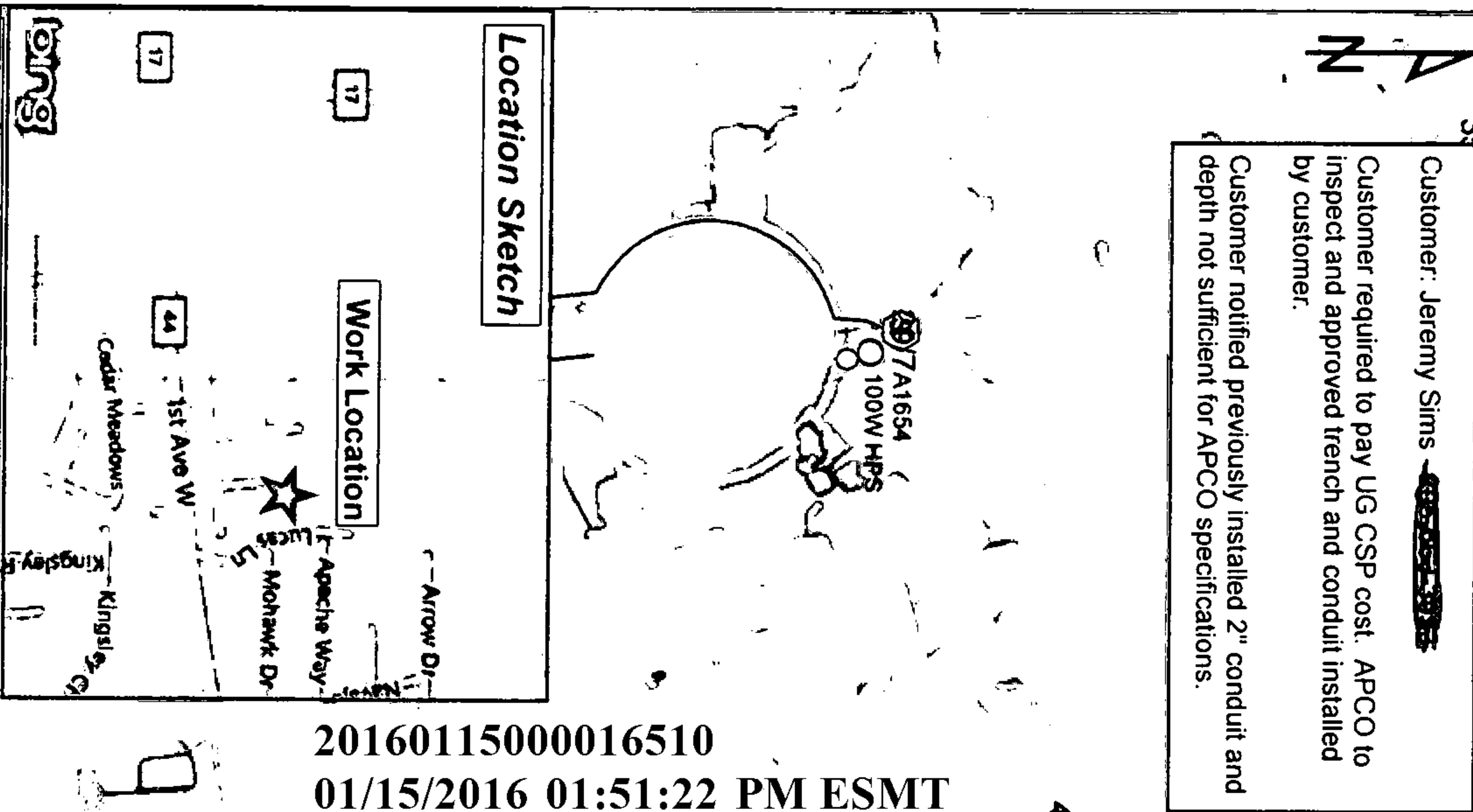

20160115000016510  
01/15/2016 01:51:22 PM ESMT

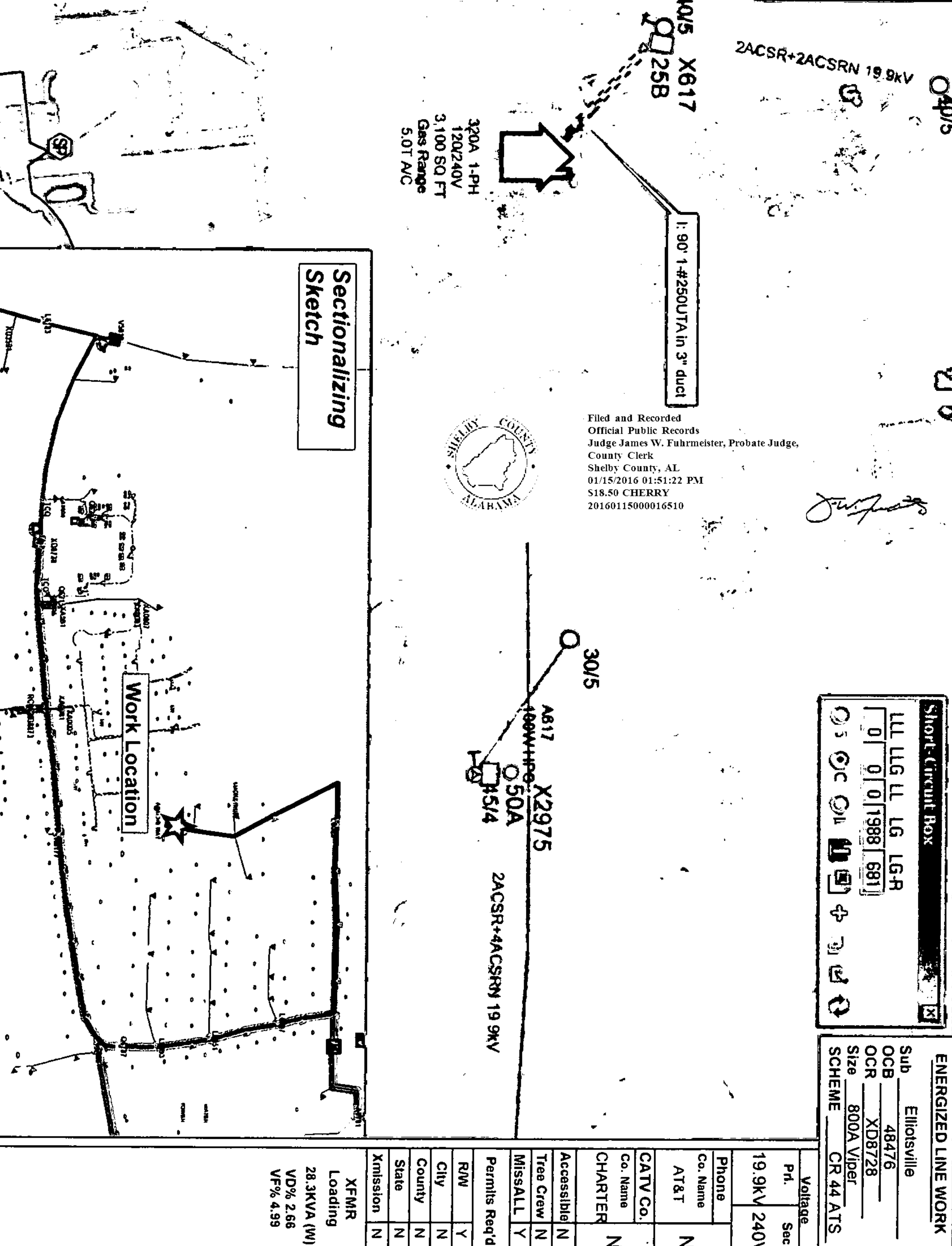

Filed and Recorded  
Official Public Records  
Judge James W. Fuhrmeister, Probate Judge,  
County Clerk  
Shelby County, AL  
01/15/2016 01:51:22 PM  
S18.50 CHERRY  
20160115000016510

**Short-Circuit Box**

L L	L G	L L	L G	L G-R
0	0	0	1988	681

O S O C O A U I V + R D E

ENERGIZED LINE WORK

Sub                      Elliottsville

OCB                    48476

OCR                    XD8728

Size                    800A Viper

SCHEME              CR 44 ATS

Foreman: \_\_\_\_\_

Cnst Completed By: \_\_\_\_\_

Date: \_\_\_\_\_

ENGINEER: FRANK BROWNE LINC: 10\*471