

Source of Title:

Deed Book 20041221000695240

20071009000470910

\$ 500.00

Shelby County, AL 03/22/2013
State of Alabama
Deed Tax: \$.50

EASEMENT – DISTRIBUTION FACILITIES

STATE OF ALABAMA

COUNTY OF Shelby

W.E. No. A6170-05-A213

APCO Parcel No. 70253348

Transformer No. S18323

This instrument prepared by: Larry D. Gravitt

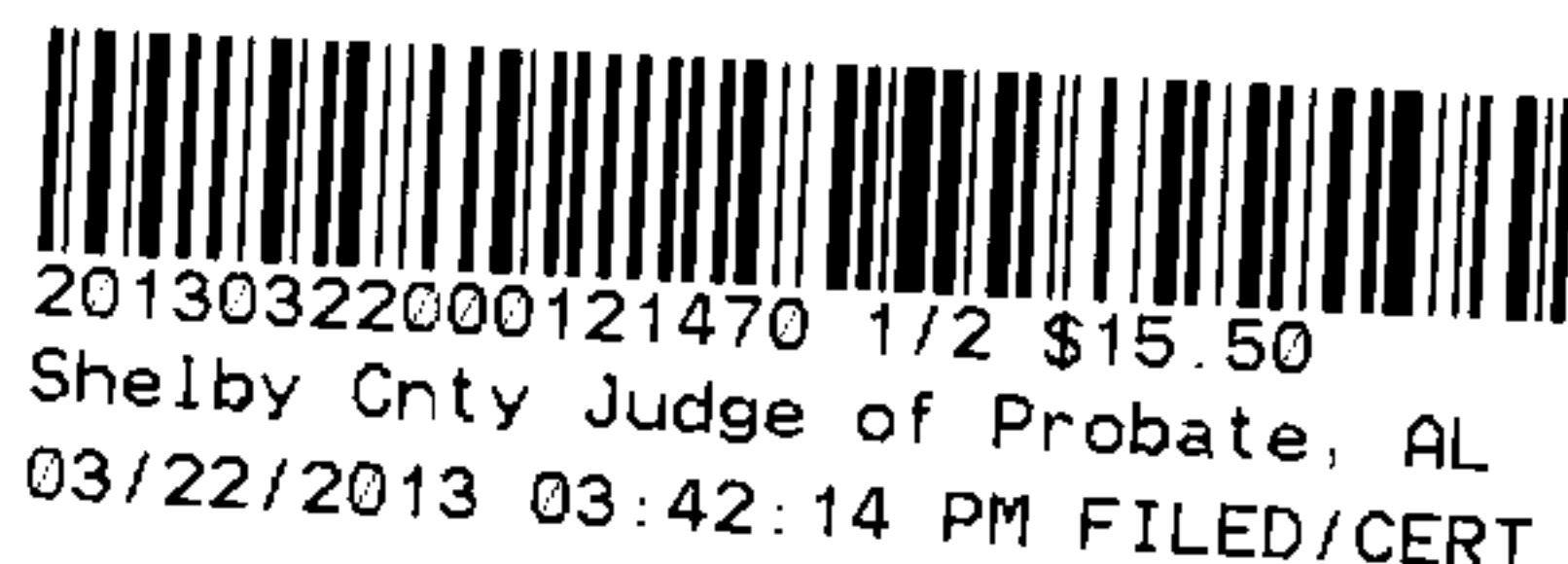

Alabama Power Company
P. O. Box 2641
Birmingham, Alabama 35291

KNOW ALL MEN BY THESE PRESENTS, That Edwin B. Lumpkin Jr.; a married man

as grantor(s), (the "Grantor", whether one or more) for and in consideration of One and No/100 Dollar (\$1.00) and other good and valuable consideration paid to Grantor in hand by Alabama Power Company, a corporation, the receipt and sufficiency of which are hereby acknowledged, does hereby grant to Alabama Power Company, its successors and assigns (the "Company"), the easements, rights and privileges below.

Overhead and/or Underground. The right from time to time to construct, install, operate and maintain, upon, over, under and across the Property described below, all poles, towers, wires, conduits, fiber optics, cables, communication lines, translosures, transformers, anchors, guy wires and other facilities useful or necessary in connection therewith (collectively, "Facilities"), for the overhead and/or underground transmission and distribution of electric power and communications, along a route selected by the Company, as generally shown on the Company's drawing attached hereto and made a part hereof, but which is to be determined by the actual location(s) in which the Company's facilities are installed. The width of the Company's easement will depend on whether the Facilities are underground or overhead: for underground, the easement will extend five (5) feet on each side of said Facilities as and where installed; for overhead Facilities, the easement will extend fifteen (15) feet on each side of the centerline of said Facilities as and where installed. The Company is granted the right to clear, and keep clear, all trees, undergrowth and other obstructions on a strip of land extending five (5) feet from each side of said underground Facilities, and to clear, and keep clear, all trees, undergrowth and other obstructions on a strip of land extending fifteen (15) feet from each side of the centerline of said overhead Facilities and the right in the future to install intermediate poles and facilities on said strip. Further, with respect to overhead Facilities, the Company is also granted the right to trim and cut, and keep trimmed and cut, all dead, weak, leaning or dangerous trees or limbs outside of the thirty (30) foot strip that, in the sole opinion of the Company, may now or hereafter endanger, interfere with, or fall upon any of said overhead Facilities.

Grantor hereby grants to the Company all easements, rights and privileges necessary or convenient for the full enjoyment and use thereof, including without limitation the right of ingress and egress to and from said Facilities, as applicable, and the right to excavate for installation, replacement, repair and removal thereof; and also the right to cut, remove and otherwise keep clear any and all structures, obstructions or obstacles of whatever character, on, under and above said Facilities, as applicable.

The easements, rights and privileges granted hereby shall apply to, and the word "Property" as used in this instrument shall mean, the following described real property situated in Shelby County, Alabama (the "Property"): a parcel of land located in the West 1/2 of the NW 1/4 of Section 28 and the NE 1/4 of Section 29, all being located in Township 21 South, Range 2 West, more particularly described in those certain instruments recorded, in Deed Record 20041221000695240 and 20071009000470910 in the office of the Judge of Probate of said County.

In the event it becomes necessary or desirable for the Company from time to time to move any of the Facilities in connection with the construction or improvement of any public road or highway in proximity to the Facilities, Grantor hereby grants to the Company the right to relocate the Facilities and, as to such relocated Facilities, to exercise the rights granted above; provided, however, the Company shall not relocate said Facilities on the Property at a distance greater than ten feet (10') outside the boundary of the right of way of any such public road or highway as established or re-established from time to time. This grant and agreement shall be binding upon and shall inure to the benefit of Grantor, the Company and each of their respective heirs, personal representatives, successors and assigns and the words "Company" and "Grantor" as used in this instrument shall be deemed to include the heirs, personal representatives, successors and assigns of such parties.

TO HAVE AND TO HOLD the same to the Company, its successors and assigns, forever.

IN WITNESS WHEREOF, the undersigned Grantor has executed this instrument on this the 8th day of January, 2013.

Wade Stubbbs
Witness Signature

Edwin B. Lumpkin, Jr. (SEAL)
(Grantor)

Print Name

Witness Signature

(Grantor)

Print Name

Customer WADE STUBBS	Location 2740 HIGHWAY 31 S	Cnted. Svc Date	County SHELBY	Section 28	Township 21S	Range 02W	Estimate No. A617005A213	Missall No. Work Date Time Update
Division BIRMINGHAM	District SOUTH VARNONS	Town CALERA	UserID japutti	Created: 12/27/2012	Substation LONGVIEW DS	X- 48836 Y- XA1801	ENERGIZED LINE WORK Sub _____ OCB/OCR _____ Switch# _____ Fuse Size _____	



I: 3 PASE OPEN DELTA 2 TX BANK
15KVA LIGHTING TX AND
15KVA POWER TX
I: SERVICE RISER
I: 70' QUADRAPLEX 1-1/0 & 3 -4/0 AL XLP
R: 270' HOT LEG

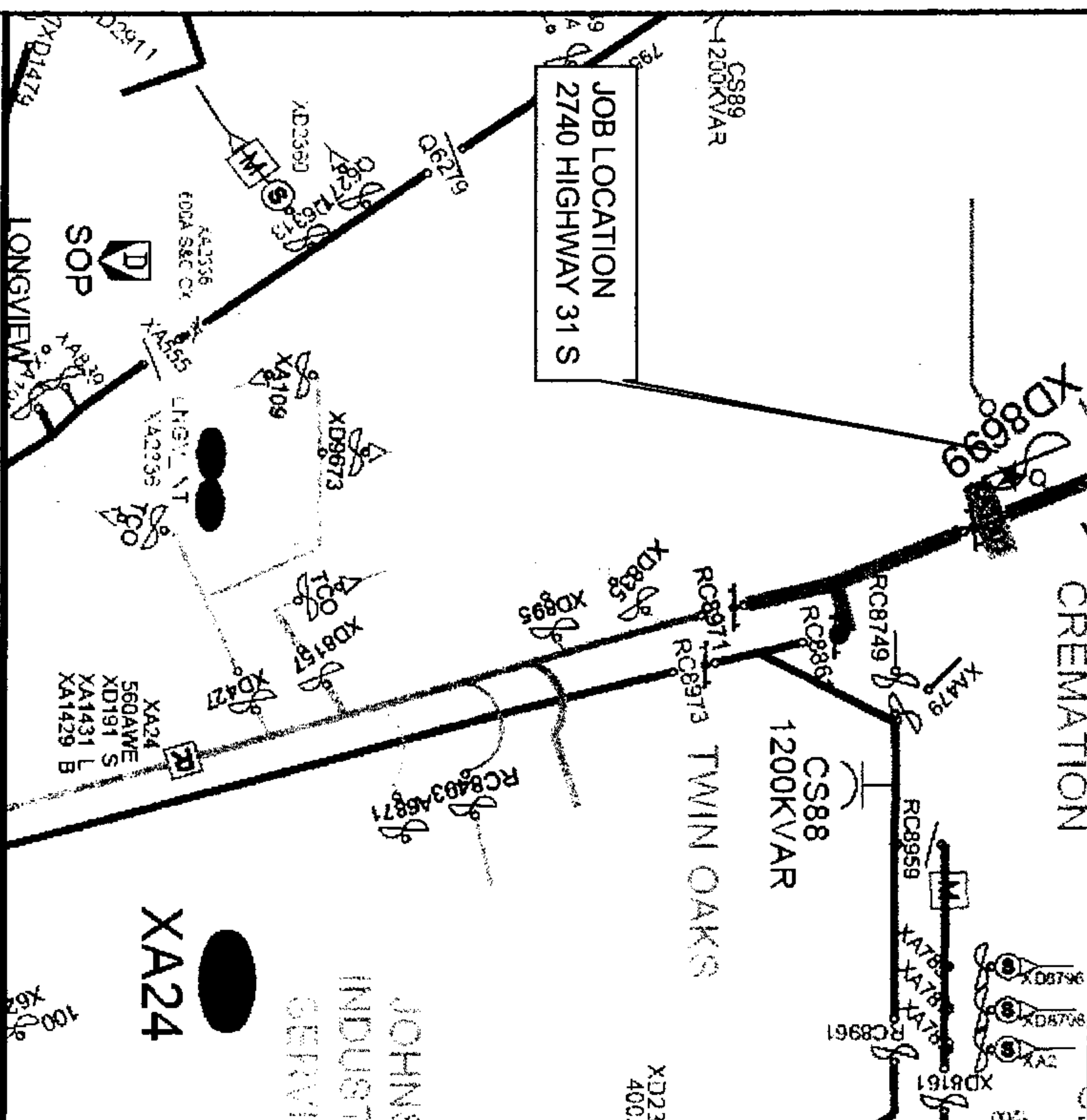

20130322000121470 2/2 \$15.50
Shelby Cnty Judge of Probate, AL
03/22/2013 03:42:14 PM FILED/CERT

Device No: XA1801	Voltage: 12 KV
Feeder: LONGVIEW_#1_DS_48836	
Equipment Type: 900_D	
LL: 4095	LR: 3056
LL: 3791	LR: 281
LL: 3516	

48836

XA24, 560A WE

XA1801, 900A GANG

JOB